

3/10/2023 10:18 AM
 C:\Users\jgibson\OneDrive\Documents\Drawings\CLD.dwg

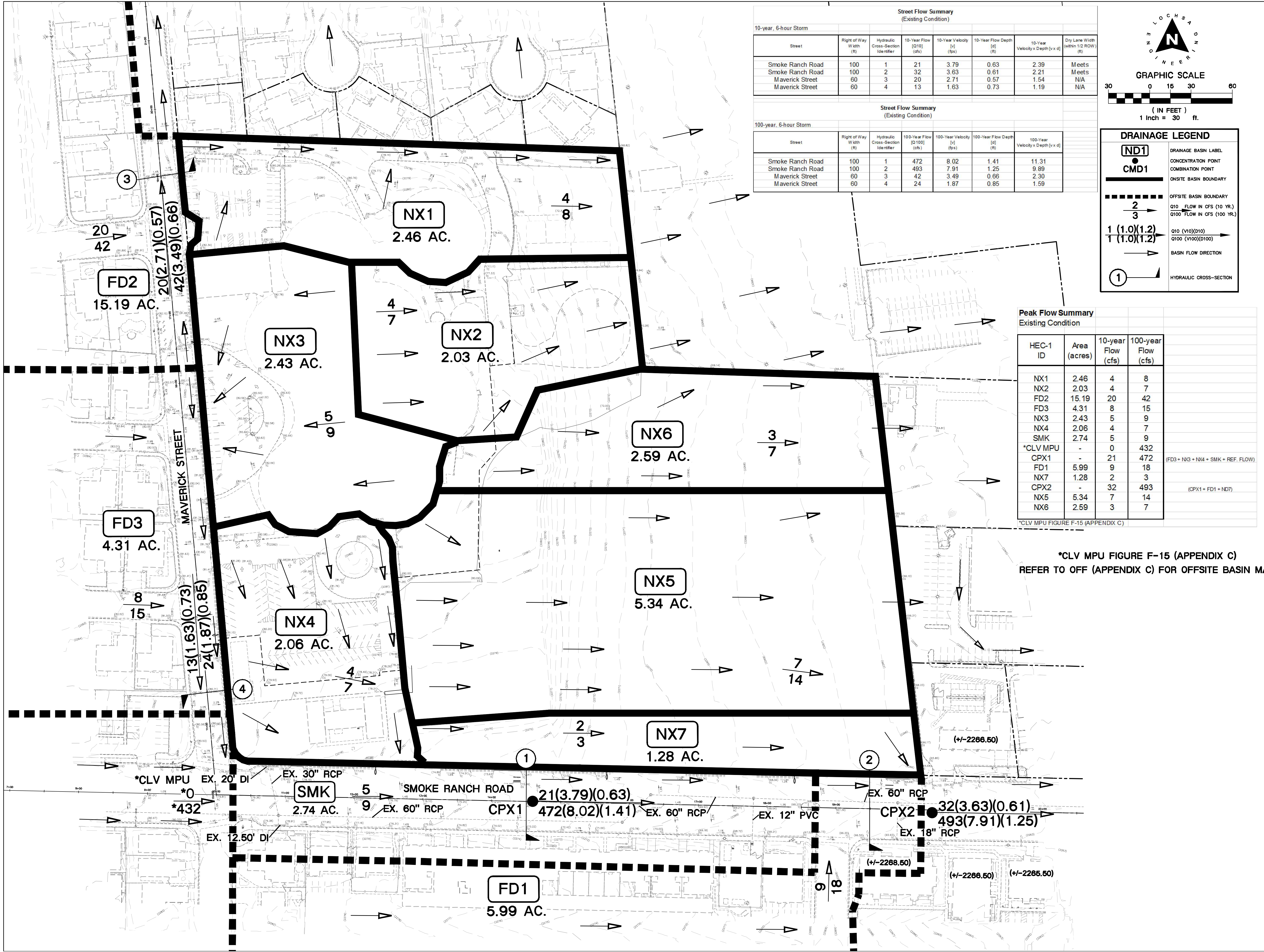

Street Flow Summary (Existing Condition)

10-year, 6-hour Storm

Street	Right of Way Width (ft)	Hydraulic Cross-Section Identifier	10-Year Flow [Q10] (cfs)	10-Year Velocity [V] (fps)	10-Year Flow Depth [d] (ft)	10-Year Velocity x Depth [v x d]	Dry Lane Width (Within 1/2 ROW) (ft)
Smoke Ranch Road	100	1	21	3.79	0.63	2.39	Meets
Smoke Ranch Road	100	2	32	3.63	0.61	2.21	Meets
Maverick Street	60	3	20	2.71	0.57	1.54	N/A
Maverick Street	60	4	13	1.63	0.73	1.19	N/A

Street Flow Summary (Existing Condition)

100-year, 6-hour Storm

Street	Right of Way Width (ft)	Hydraulic Cross-Section Identifier	100-Year Flow [Q100] (cfs)	100-Year Velocity [V] (fps)	100-Year Flow Depth [d] (ft)	100-Year Velocity x Depth [v x d]	Dry Lane Width (Within 1/2 ROW) (ft)
Smoke Ranch Road	100	1	472	8.02	1.41	11.31	
Smoke Ranch Road	100	2	493	7.91	1.25	9.89	
Maverick Street	60	3	42	3.49	0.66	2.30	
Maverick Street	60	4	24	1.87	0.85	1.59	

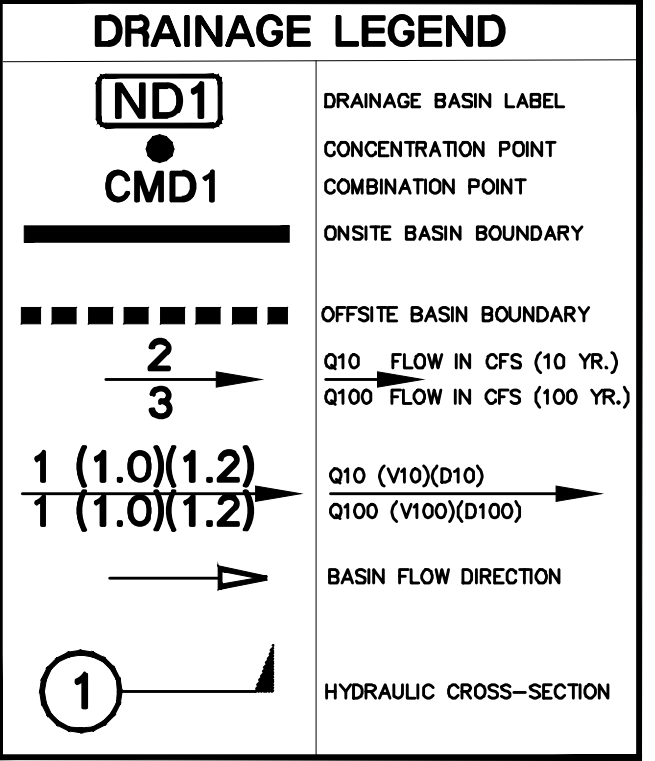
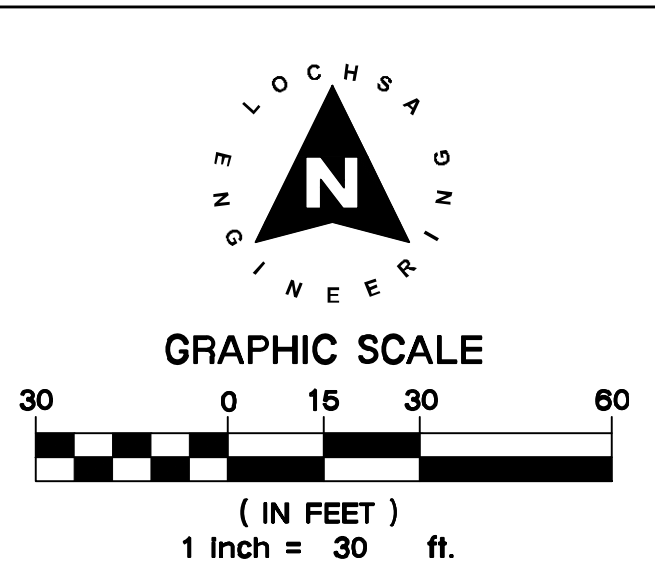

Peak Flow Summary Existing Condition

HEC-1 ID	Area (acres)	10-year Flow (cfs)	100-year Flow (cfs)
NX1	2.46	4	8
NX2	2.03	4	7
FD2	15.19	20	42
FD3	4.31	8	15
NX3	2.43	5	9
NX4	2.06	4	7
SMK	2.74	5	9
*CLV MPU	-	0	432
CPX1	-	21	472
FD1	5.99	9	18
NX7	1.28	2	3
CPX2	-	32	493
NX5	5.34	7	14
NX6	2.59	3	7

(FD3 + NX3 + NX4 + SMK + REF. FLOW)

(CPX1 + FD1 + ND7)

*CLV MPU FIGURE F-15 (APPENDIX C)

*CLV MPU FIGURE F-15 (APPENDIX C)
 REFER TO OFF (APPENDIX C) FOR OFFSITE BASIN MAP

REVISIONS:

REV.	DESCRIPTION	DATE

SEAL: 05/05/2023

DATE: 5.5.23

DRAWN BY: JQC

CHECKED BY: EL

95% PLANS CHECK SUBMITTAL

PROJECT NO. 22-017

CARPENTER SELLERS DEL GATTO ARCHITECTS

8882 SPANISH RIDGE AVENUE - LAS VEGAS, NV 89148
 (702) 251-8896 - FAX (702) 251-8876 - WWW.CSDARCHITECTURE.COM

Lochsa Engineering

6345 South Jones Blvd., Suite 100
 Las Vegas, NV 89118
 Phone (702) 365-9312
 Fax (702) 365-9317
 www.lochsa.com

CONSULTANT:

CONSTRUCTION MGMT: DATE:

COORDINATOR:

BUILDING DEPARTMENT:

ASBESTOS WORK IS:
 REQUIRED NOT REQUIRED

MPID: 0001643

CLARK COUNTY SCHOOL DISTRICT
 CONSTRUCTION MANAGEMENT 1180 MILITARY TRIBUTE PL HENDERSON NV 89074 PHONE: 702-799-8710

BRINLEY M.S. REPLACEMENT
 EXISTING DRAINAGE MAP

FACILITY & ADDRESS:
 2480 MAVERICK ST., LAS VEGAS, NV 89108

SHEET NO: DR1
 SHEET 1 OF 2