

Basement Plan - Mail Room

Scale: 1/4" = 1'-0"

Floor Plan Notes

- ① INFILL OPENING WITH THE FOLLOWING: 4" METAL STUDS AT 16" O.C. WITH 5/8" TYPE "X" GYPSUM BOARD EACH SIDE. TEXTURE TO MATCH ADJACENT SURFACE AND PAINT PT-1
- ② INSTALL MAIL SLOT (mailboxes.com - MODEL 2255 "MAIL DROP" COLOR ALUMINUM) - FINAL LOCATION TO BE DETERMINED IN THE FIELD WITH PRINT SHOP SUPERVISOR - PROVIDE LETTERING THAT STATES "MAIL"
- ③ INFILL AREA OF NEW DOOR WITH RESILIENT FLOOR TO MATCH

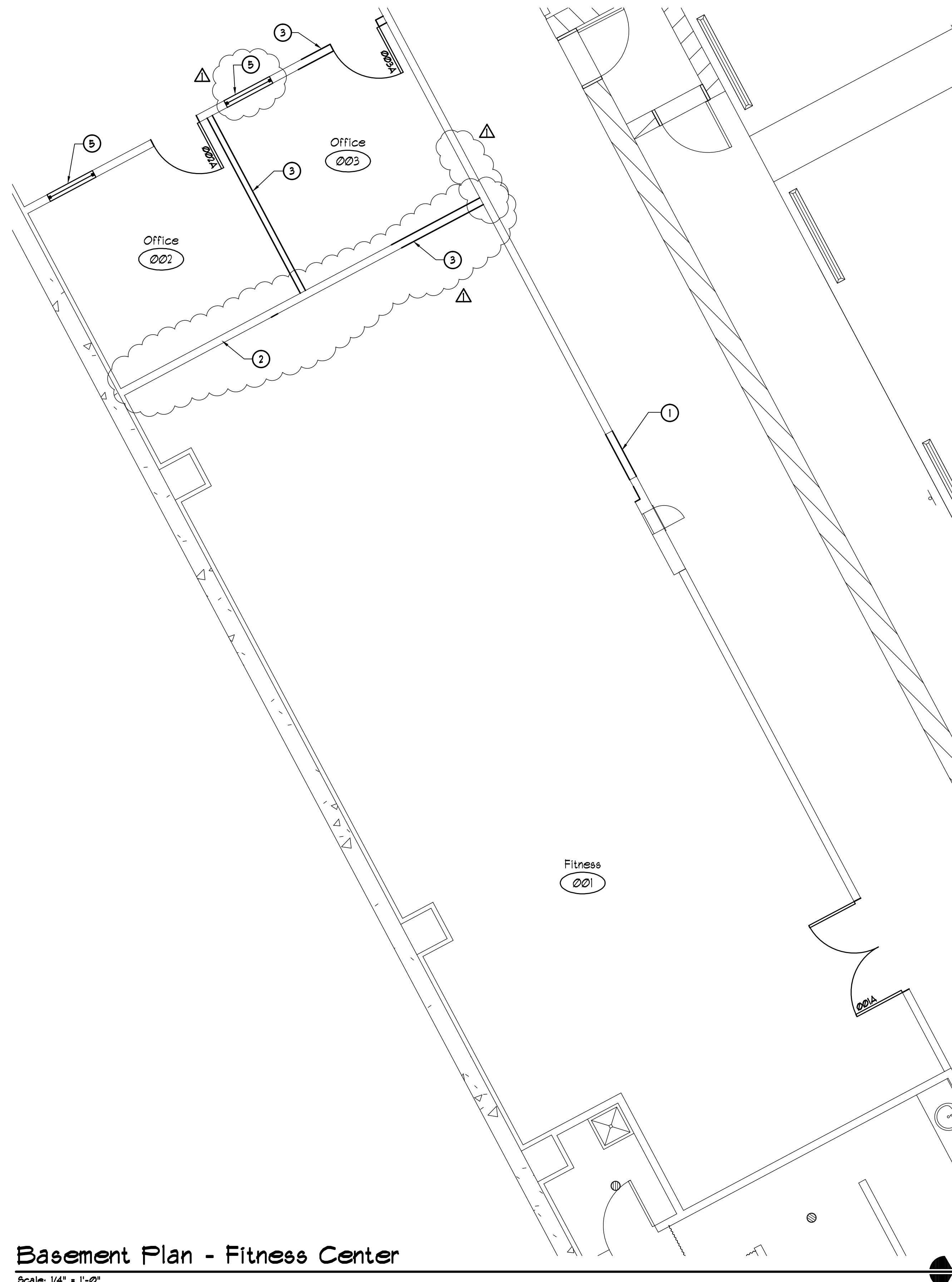

Basement Plan - Fitness Center

Scale: 1/4" = 1'-0"

Floor Plan Notes

- ① INFILL OPENING WITH THE FOLLOWING: 4" METAL STUDS AT 16" O.C. WITH 5/8" TYPE "X" GYPSUM BOARD EACH SIDE. TEXTURE TO MATCH ADJACENT SURFACE AND PAINT PT-1. PATCH EXISTING WALL PROTECTION AND EDGING ON HALLWAY SIDE
- ② REMOVE DRYWALL AS REQUIRED TO INSULATE EXISTING WALL, FULL HEIGHT
- ③ CONSTRUCT WALL AS FOLLOWS: 4" METAL STUDS AT 16" O.C. WITH 5/8" TYPE "X" GYPSUM BOARD EACH SIDE TO 4" ABOVE CEILING WITH SOUND BATT INSULATION FULL HEIGHT. SEE DETAIL-1A2
- ④ NOT USED
- ⑤ 3'-0" X 3'-0" WINDOW W/ 1/4" TEMPERED GLAZING AND ALUMINUM MULLIONS TO MATCH DOOR FRAMES. MOUNT BOTTOM OF SILL AT 3'-0" AFF.



REVISIONS

1	Owner Revision 10/31/12

CONSULTANT

Department of Operations and Maintenance
 City Hall Fitness Center
 495 South Main Street
 Floor Plans

OWNER: CITY OF LAS VEGAS
 Department of Operations & Maintenance

3104 East Bonanza Road
 LAS VEGAS, NEVADA 89101
 PHONE: (702) 229-6220
 FAX: (702) 382-0619
 TDD: (702) 386-9108

DRAWN: map

DATE: October 2012

SCALE:

PROJ NO: 521-298-FC

SHEET NO:

DRAWINGS AND INSTRUMENTS OF SERVICE ARE THE PROPERTY OF THE DESIGN PROFESSIONAL WHOSE STAMP OF CERTIFICATION APPEARS ON THE DRAWINGS AND SPECIFICATIONS. ANY USE OR REPRODUCTION IN WHOLE OR IN PART WITHOUT WRITTEN CONSENT IS STRICTLY PROHIBITED. SOURCE OF THE DRAWINGS AND SPECIFICATIONS REMAINS BY THE CLIENT. MAY BE USED ONLY FOR OCCUPANCY OF THE PROJECT FOR WHICH THEY WERE PREPARED AND NOT FOR THE CONSTRUCTION OF ANY OTHER PROJECT. N.E.C. 632.790