

Q VEGAS DRIVE

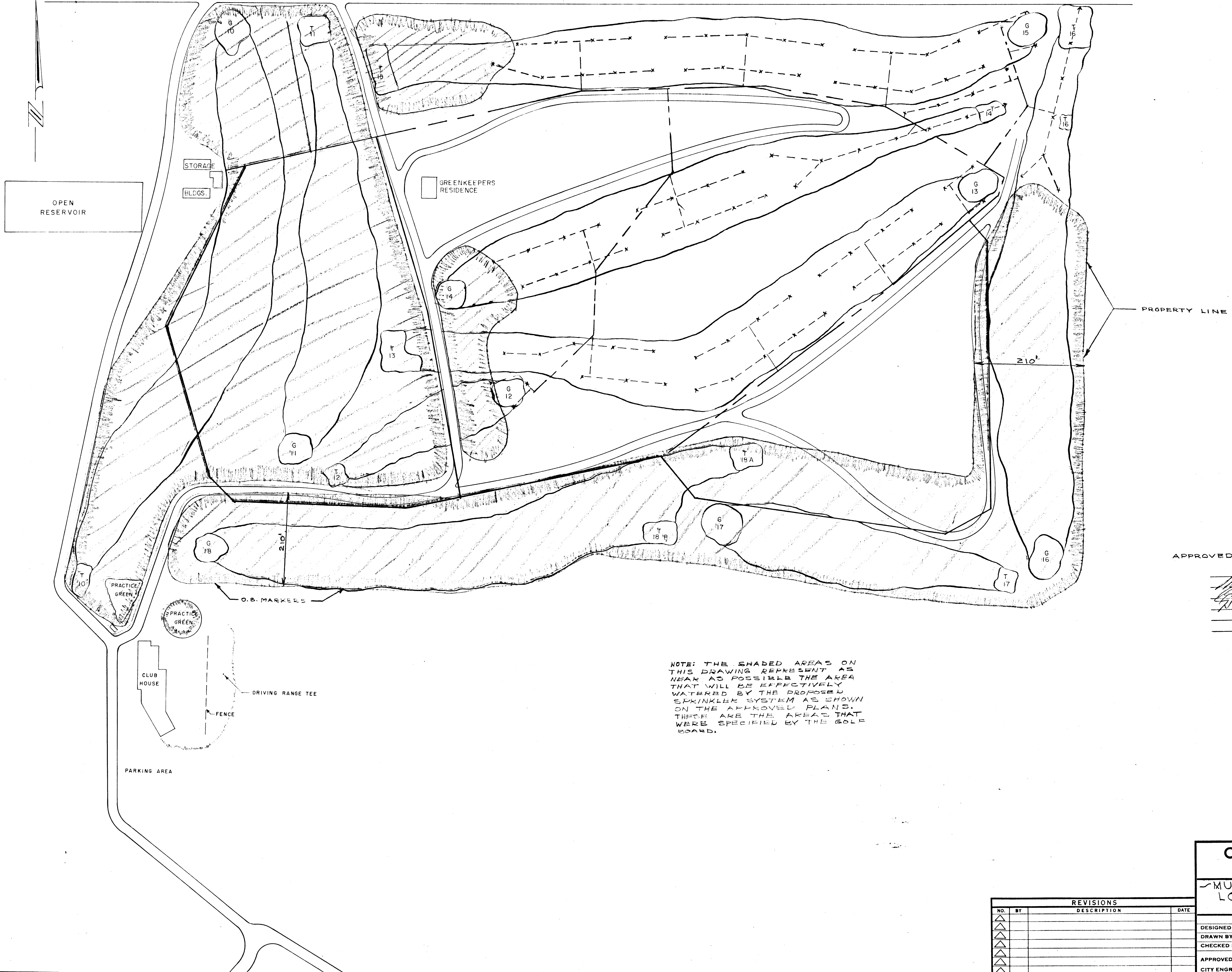

APPROVED: *A.M. Smith*
James Kinball
W.B. Hunt

NOTE: THE SHADED AREAS ON THIS DRAWING REPRESENT AS NEAR AS POSSIBLE THE AREA THAT WILL BE EFFECTIVELY WATERED BY THE PROPOSED SPRINKLER SYSTEM AS SHOWN ON THE APPROVED PLANS. THESE ARE THE AREAS THAT WERE SPECIFIED BY THE GOLF BOARD.

**CITY OF LAS VEGAS NEVADA
 ENGINEERING DEPT.**

MUNICIPAL GOLF COURSE
 LOCATION OF PROPOSED
 WATERED AREAS

NO.	BY	DESCRIPTION	DATE

DESIGNED BY KUDLIK
 DRAWN BY KUDLIK
 CHECKED BY
 APPROVED
 CITY ENGR.

SCALE 1" = 100'
 FIELD BOOK NO.
 WORK ORDER NO. 26-93
 DRAWING NO. 38
 660-V