

DS #: 4380

APN: 138-13-701-010;-011;-012 & -036

PROJECT: Aguilas CFC Church - update #2

SUBMITTAL: 5th

SCANNED BY/DATE: _____

CHECKED BY/DATE: _____

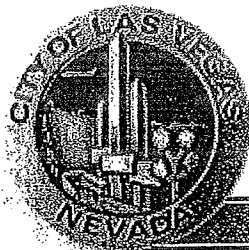

**CITY OF LAS VEGAS
INTER-OFFICE MEMORANDUM**

DATE:
December 8, 2011

TO:
Land Development Services
Department of Public Works

FROM:
Albert Sung, P.E.
Flood Control Project Engineer
Department of Public Works

SUBJECT: Drainage Study for:
Aguilas CFC Church – Update #2

COPIES TO:
Walker Engineering

Cross Streets: SEC of Madre Mesa Drive & Michael Way

Aguilas CFC Church

File Number: F:\Depot\DSMemos\DS4380E.doc

Bart Anderson, P.E., DevCo

Parcel Number: 138-13-701-010; -011; -012 & -036

CCDDS

Zoning Action: GPA-28505; ZON-28506; SDR-28517;
SDR-36787 & PMP-36474

FEMA Flood Zone YES NO **X**

Proposed Storm Drain YES **X** NO

HISTORY	DATE RECEIVED	DATE REVIEWED	COMMENTS	REVIEW FEES	FEES PAID Transaction #
1 st Submittal	11/23/2009	12/9/2009	Not Approved	\$400.00	133991: \$400
2 nd Submittal & Supplement	2/18/2010 & 3/8/2010	3/15/2010	Not Approved	\$400.00	139046: \$400
3 rd Submittal	4/22/2010	4/29/2010	Approved	\$400.00	143508: \$400
4 th Submittal	11/10/2010	11/24/2010	Approved	\$100.00	157313: \$100
5 th Submittal	12/6/2011	12/8/2011	See Comments Below	N/C	N/C
TOTAL FEES (LDDRS):				\$1,300.00	----

REMARKS:

5th Submittal: Update #2 to shift a beehive inlet within the County jurisdiction to avoid an existing private water line

4th Submittal: Update #1 to shift Phase Lines

The Drainage Study for the subject project has been reviewed and:

X	is approved subject to conformance to all City standards and the following conditions:
	must be resubmitted or supplemented including the following:
	is conditionally approved subject to Clark County Regional Flood Control District concurrence.
	is conditionally approved subject to Clark County Department of Development Services concurrence.

The following comments are repeated until they are complete:

1. Provide a cleanout at midway of the proposed 18" nuisance drain for future maintenance. Revise all pertinent plans accordingly.
2. Reversionary Map "PMP-36474" must be recorded prior to the final approval of the improvement plans.
3. An existing 10-public drainage easement (PM55, Page 62, Doc. 693177) must be vacated prior to the final approval of the improvement plans.

4. The proposed public drainage easements (privately maintained) must be granted by separate document and be recorded prior to the final approval of the improvement plans.
5. All onsite storm facilities (interim and future permanent) are privately owned and to be privately maintained.

NOTE: Any future changes to the proposed design (or design assumptions) as outlined in the approved drainage study and attached preliminary grading plan which affect drainage must be addressed in a Drainage Study Amendment and accepted by the *City of Las Vegas Flood Control Section*. Additionally, conditional acceptance of a drainage study is valid for a period of one (1) year. If the proposed construction has not been completed in that time period, the *City of Las Vegas* reserves the right to require additional conditions and/or submission and acceptance of a complete drainage study update prior to further construction of a project.

NOTE: Please be advised that all land surface area disturbances over 1 acre or any area adjacent to a water way must submit to the *Nevada Division of Environmental Protection* a "Notice of Intent" to discharge that certifies a stormwater pollution prevention plan has been developed and is maintained on site; for inclusion in the Stormwater General Permit No. NVR100000. A phased construction unit in a contiguous subdivision is considered under construction until all stripped or disturbed surface areas have been covered by paving, building construction or planting. For more information, including forms and applications see <http://ndep.nv.gov/bwpc/storm01.htm> or call (775) 687-9429.

END OF REMARKS
ays

T/R/S: T20S/R60E/13
AREA L-13

TRANSACTION REPORT

P. 01

DEC-08-2011 THU 11:02 AM

FOR: CITY OF LAS VEGAS

7023828551

SEND

DATE	START	RECEIVER	TX TIME	PAGES	TYPE	NOTE	M#	DP
DEC-08	11:01 AM	8735346	55"	2	FAX TX	OK	963	

TOTAL : 55S PAGES: 2

- The proposed public drainage easements (privately maintained) must be granted by separate document and be recorded prior to the final approval of the improvement plans.
- All onsite storm facilities (interim and future permanent) are privately owned and to be privately maintained.

NOTE: Any future changes to the proposed design (or design assumptions) as outlined in the approved drainage study and attached preliminary grading plan which affect drainage must be addressed in a Drainage Study Amendment and accepted by the *City of Las Vegas Flood Control Section*. Additionally, conditional acceptance of a drainage study is valid for a period of one (1) year. If the proposed construction has not been completed in that time period, the *City of Las Vegas* reserves the right to require additional conditions and/or submission and acceptance of a complete drainage study update prior to further construction of a project.

NOTE: Please be advised that all land surface area disturbances over 1 acre or any area adjacent to a water way must submit to the *Nevada Division of Environmental Protection* a "Notice of Intent" to discharge that certifies a stormwater pollution prevention plan has been developed and is maintained on site; for inclusion in the Stormwater General Permit No. NVR100000. A phased construction unit in a contiguous subdivision is considered under construction until all stripped or disturbed surface areas have been covered by paving, building construction or planting. For more information, including forms and applications see <http://ndep.nv.gov/bwpc/storm01.htm> or call (775) 687-9429.

END OF REMARKS
ays

T/R/S: T20S/R60E/13
AREA L-13

5765 South Rainbow Boulevard
Suite 101
Las Vegas, Nevada 89118
T: 702.873.5197
F: 702.873.5346
www.walker-eng.com

WALKER ENGINEERING, LLC

UPDATE #2
to the
TECHNICAL DRAINAGE STUDY
for

Rec'd: 12/6/11
DS 4380-2
L-13

AGUILAS CFC CHURCH
SEC OF MICHAEL WAY AND MADRE MESA DRIVE
APN's: 138-13-701-010, 012, 013, & 036
CLV DS4380, CC HTE# 10-6132

N/C



Prepared for:
CATALYST CONSULTING COMPANY
405 SE 52nd Avenue
Ocala, FL 34471
Tel: 352.458.1161
Fax: 800.761.5743

Date Prepared:
December 5, 2011

HYDROLOGIC CRITERIA AND DRAINAGE MANUAL
DRAINAGE STUDY INFORMATION FORM

Name of Development: AGUILAS CFC CHURCH Date: DECEMBER 5, 2011

Location of Development: a) Descriptive (Cross Streets) North/South: MICHAEL WAY
 East/West: MADRE MESA DRIVE

b) Section: 13 Township: 20 S Range: 60 E

c) APN : 138-13-701-010, 011, 012, & 036

Name of Owner: AGUILAS CFC

Telephone No.: 352.458.1161 Fax No.: 800.761.5743 E-Mail Address: matt@catalystconsultingcompany.com

Address: 405 SE 52nd AVENUE, OCALA, FL 34471

Contact Person-Name: TREASEA WOLF, P.E., LEED AP Telephone No.: 702.873.5197

* E-Mail Address: twolf@walker-eng.com Fax No.: 702.873.5346

Firm: WALKER ENGINEERING, LLC

Address: 5765 S. RAINBOW BLVD., SUITE 101 LAS VEGAS, NV 89118

Type of Land Development/Land Disturbance Process:

<input type="checkbox"/>	Rezoning	<input type="checkbox"/>	Subdivision Map	<input type="checkbox"/>	Clearing and Grading Only
<input type="checkbox"/>	Parcel Map	<input type="checkbox"/>	Planned Unit Development	<input checked="" type="checkbox"/>	Other (Please specify below)
<input type="checkbox"/>	Large Parcel Map	<input checked="" type="checkbox"/>	Building Permit		GRADING PERMIT

1. Total Owned Land Area: At Site: 11.18 ACRES Being Developed/Disturbed: 11.18 ACRES

2. Is a portion or all of the subject property located in a designated FEMA Flood Hazard Area? Yes** No

3. Is the property bordered or crossed by an existing or proposed Clark County Regional Flood Control District Master Planned Facility? Yes** No

4. Proposed type of development (Residential, Commercial, Etc.): COMMERCIAL-CHURCH

5. Approximate upstream land area which drains to the subject site: 144 ACRES

6. Has the site drainage been evaluated in the past? YES NO If yes, please identify documentation: _____

7. If known, please briefly identify the proposed discharge point(s) of runoff from the site:
SITE DISCHARGES NORTH INTO MADRE MESA DRIVE AND SOUTHEAST INTO ROBERTA LANE

8. Briefly describe your proposed schedule for the subject project: ASAP

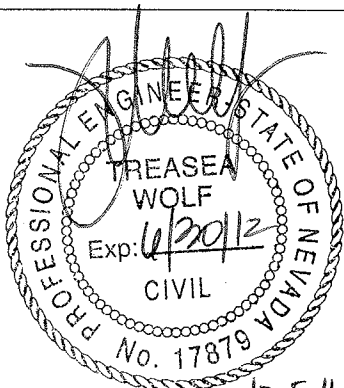

Engineer's Seal

Submit this form as part of the required drainage study to the local entity which has jurisdiction over the subject property. This form may provide sufficient information to serve as the Conceptual Drainage Study.

*New Required Field

**Review and concurrence of the Clark County Regional Flood Control District is required.

Revision	Date
ADD1	FEBRUARY 10, 2010
ADD2	APRIL 19, 2010
UPDATE 1	NOVEMBER 10, 2010

Local Entity File No. _____

REFERENCE:

STANDARD FORM 1
 UPDATE 2 DECEMBER 5, 2011



WALKER ENGINEERING, LLC

December 5, 2011
WE Job No. 1167.00

Albert Sung, P.E.
Flood Control Project Engineer
Department of Public Works
420 N Fourth Street
Las Vegas, Nevada 89101

**RE: Update #2 to the Drainage Study for Aguilas CFC Church
DS4380, CC HTE: 10-6132**

Dear Albert,

We are submitting the attached Update #2 to the Technical Drainage Study for Aguilas CFC Church for the proposed beehive shift at the NWC of the Michael and Alfred intersection. During construction, it was discovered that there is an existing private waterline that was constructed back in 1960 that is located exactly where the beehive inlet is proposed. The beehive inlet is required by Clark County for nuisance flows. The proposed beehive is on the west half of Michael Way which is Clark County jurisdiction.

We have met with Clark County to discuss this conflict and they have agreed to allow us to shift the beehive location closer to the edge of pavement. This revision does not affect the overall drainage for the project since the major flows are accepted through the site. The beehive shift affects the detail sheet, D1, Grading Plan, G3, Michael Plan & Profile Sheet, P1 and Storm Drain Plan & Profile Sheet, SD1. We have attached revised copies of these sheets for your files. We are currently submitting a revision to Land Development to update these sheets as well.

Please do not hesitate to contact me if you should have any questions or need additional information.

Sincerely,
WALKER ENGINEERING, LLC

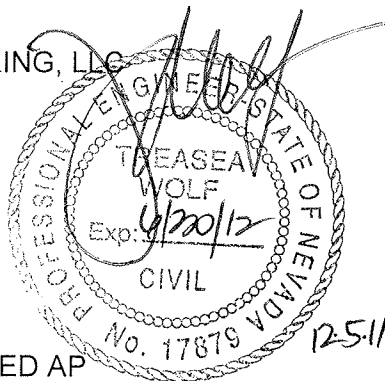

Treasea Wolf, PE, LEED AP
Project Manager

5765 South Rainbow Blvd.
Suite 101
Las Vegas, Nevada, 89118
Phone: 702.873.5197
Fax: 702.873.5346
www.walker-eng.com

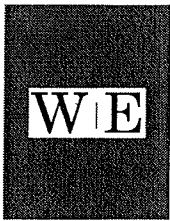

LETTER OF TRANSMITTAL

Date: December 6, 2011

To: **Albert Sung**
City of Las Vegas
Flood Control
731 S. Fourth St.
Las Vegas, NV 89101

WE Project: **Aguilas CFC Church**

CC: WE Project No.: 1167.00

Subject: **Drainage Study Update #2 (DS4380C)**

We are sending you the attached documents via:

Messenger, Hand Delivery, US Mail, Fed Ex (Overnight) Pick UP
for your use as checked below:

Urgent As requested For review For your files For your info.

Returning For approval Other:

<input checked="" type="checkbox"/> Please Reply
<input type="checkbox"/> No Reply Necessary

Items transmitted:

Doc Date	Copies	No. Pages	Description of Item
-	1	-	Update #2

Remarks:

Albert -

Per your request attached is the Update #2. This update is due to the existing private waterline conflict with the proposed beehive at the Michael/Alfred intersection on Clark County's jurisdiction. The proposed beehive is a Clark County requirement for nuisance flow. This revision does not affect the drainage for the project. Please let me know if you need anything else.

Sent by:

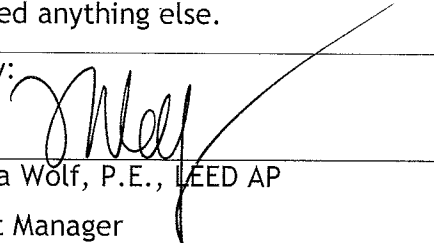

Treasea Wolf, P.E., LEED AP

Project Manager

Tel: 702.873.5197, Fax: 702.873.5346

Email: twolf@walker-eng.com

5765 S. Rainbow Blvd.
Suite 101
Las Vegas, NV 89118
Tel: 702.873.5197
Fax: 702.873.5346
www.walker-eng.com

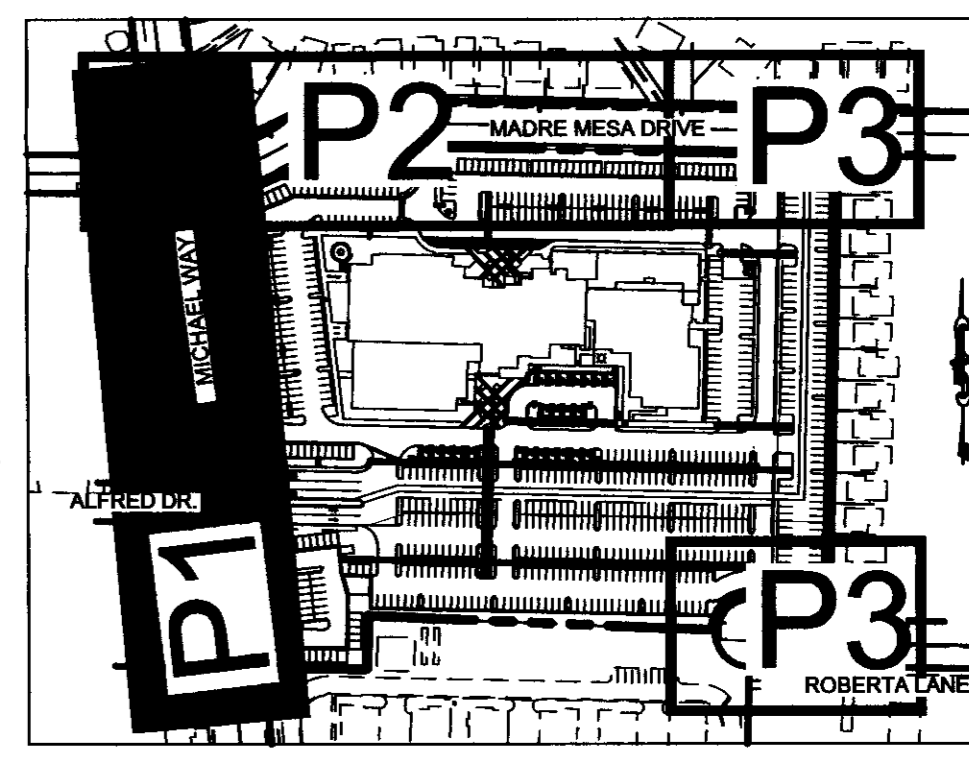
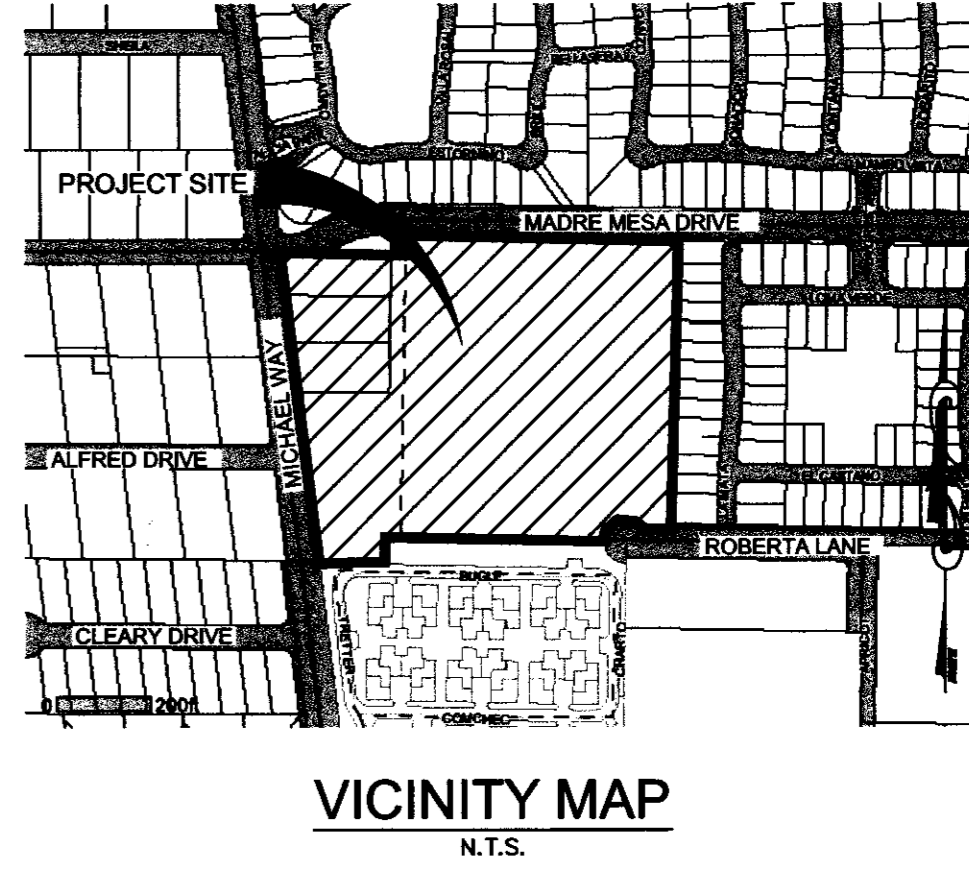
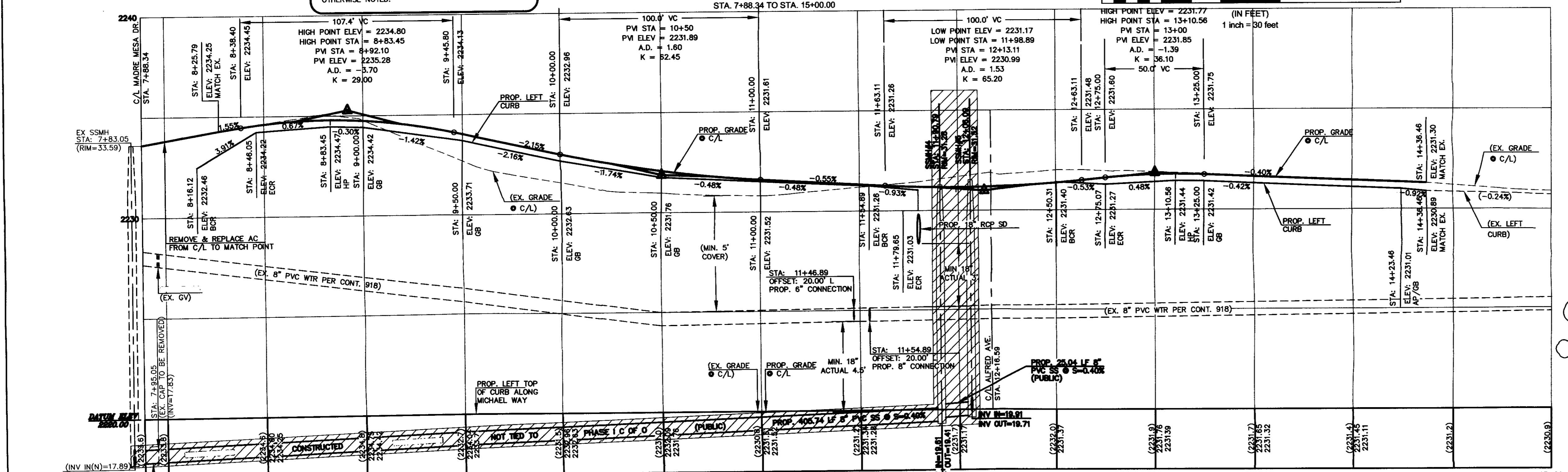
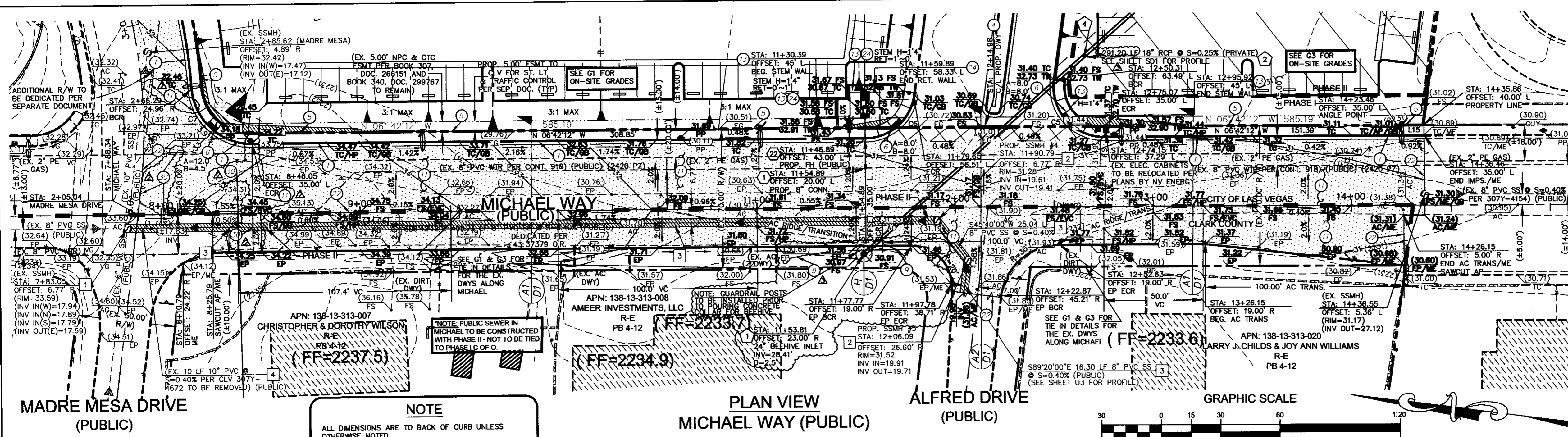

NO	ITEM
1	CONSTRUCT "L" TYPE CURB AND GUTTER PER STD DWG NO. 216.
2	CONSTRUCT "A" TYPE CURB PER STD. DWG. NO. 219.
3	CONSTRUCT 8" CONCRETE CROSS GUTTER PER STD DWG NO 228
4	CONSTRUCT COMMERCIAL DRIVEWAY PER STD DWG NO 222A & 225
5	CONSTRUCT 4" SIDEWALK PER STD DWG NO. 234.
6	CONSTRUCT ADA RAMP WITH ARMOR TILE TRUNCATED DOMES OR EQUIVALENT PER STD DWG NO 235, CASE 1
7	CONSTRUCT 2" WIDE SIDEWALK UNDERDRAIN PER STD DWG NO. 236
8	TRANSITION FROM 0" TO 4" CURB IN 10 FEET
9	INSTALL GUARDRAIL PER NDOT DETAILS R-8.1.1, R-8.1.2 & R-8.4.1
10	TYPE II GRAVEL
11	CONSTRUCT 3.5" MIN AC OVER 8" TYPE II AB
12	CONSTRUCT 8" WIDE CROSS GUTTER PER DETAIL 7 ON SHEET D1
13	CONSTRUCT 1 1/2" SOLID GROUTED STEWALL WITH TOP CAP & TOP BENT BY OTHERS. ARCHITECTURAL PLANS FOR DETAIL
14	CONSTRUCT 2" MIN AC OVER 8" TYPE II AGG. BASE PER SOILS REPORT BY JA CESARE. SEE DETAIL 1 ON SHEET D1
15	CONSTRUCT 2 1/2" MIN AC OVER 8" TYPE II AGG. BASE PER SOILS REPORT BY JA CESARE. SEE DETAIL 2 ON SHEET D1
16	CONSTRUCT 3" WIDE VALLEY GUTTER PER DETAIL 3 ON SHEET D1
17	CONSTRUCT ON-SITE RAMP PER DETAIL 4 ON SHEET D1.
18	CONSTRUCT ON-SITE RAMP PER DETAIL 5 ON SHEET D1.
19	CONSTRUCT TRASH ENCLOSURE PER ARCHITECTURAL PLAN (BY OTHERS)
20	CONSTRUCT 0" CURB
21	CONSTRUCT HALF OF CUL-DE-SAC PER STD DWG NO. 212
22	SAWCUT AND MATCH EXISTING PAVEMENT.
23	CONSTRUCT 2" WIDE CONCRETE FLUME PER DETAIL 6 ON SHEET D1
24	CONSTRUCT RETAINING WALL (H MAX=3'4") PER SEP. PERMIT BY OTHERS
25	CONSTRUCT SCREEN WALL PER SEP. PERMIT BY OTHERS

PROPERTY LINE	LINE	BEARING
L1	39.63	S0127°20'W
L2	52.99	S87°37'05"E

BACK OF CURB	LINE	LENGTH	BEARING
L3	26.99	N88°38'13"W	
L4	5.00	S0114°28'W	
L5	5.00	S0128°18'W	
L6	9.99	S82°41'13"E	
L7	18.81	S84°11'34"E	
L8	5.01	S70°21'54"E	
L9	5.00	S70°21'54"E	
L10	5.00	S0118°48'W	
L11	5.00	S0118°48'W	
L12	10.00	S86°35'51"E	
L13	15.32	S87°37'05"E	
L14	24.05	S87°37'05"E	
L15	10.00	N06°53'37"W	

CURVE	LENGTH	RADIUS	DELTA	TANGENT
C1	78.43	2980.00	15°38'22"	38.45
C2	37.49	25.00	85°55'09"	23.28
C3	115.12	45.50	144°57'54"	144.15
C4	13.91	14.50	54°57'54"	7.54

CURVE	LENGTH	RADIUS	DELTA	TANGENT
C5	42.77	25.00	98°01'00"	28.77
C6	35.77	25.00	81°59'00"	21.73
C7	44.99	30.00	85°55'09"	27.94
C8	73.29	275.00	15°18'11"	36.86
C9	39.23	25.00	89°54'17"	24.96
C10	39.27	25.00	90°00'00"	25.00
C11	36.27	25.00	90°00'00"	25.00
C12	39.25	25.00	89°57'33"	24.98
C13	18.71	25.00	54°57'54"	10.14
C14	0.05	40.50	0°4'26"	0.03
C15	25.01	40.50	35°23'14"	12.92
C16	87.27	40.50	123°27'51"	75.32

FLOODZONE
THIS PROJECT IS LOCATED IN (NON-SHADED) FLOOD ZONE X PER FEMA FLOOD INSURANCE MAP NUMBER 3200322155E, REVISED TO REFLECT LOW DATED DECEMBER 31, 2003. FLOOD ZONE X IS DEFINED AS AN AREA BEING OUTSIDE THE 0.2% ANNUAL CHANCE FLOODING, OR AN AREA OF 1% ANNUAL CHANCE FLOODING WITH AVERAGE DEPTHS OF LESS THAN 1 FOOT OR WITH DRAINAGE AREAS LESS THAN 1 SQUARE MILE.

BENCHMARK
THE ELEVATION DATA SHOWN HEREON ARE U.S. SURVEY FEET REFERENCED TO THE NORTH AMERICAN VERTICAL DATUM OF 1988, CLARK COUNTY VERTICAL CONTROL, v.2003, BASED UPON BENCHMARK No. 75, STATION "SLVDO 1356" BEING A CITY OF LAS VEGAS PIN AND PLATE IN THE TOP OF CURB AT THE NORTHWEST CORNER OF MICHAEL WAY AND CLEARLY COURT, NEAR THE PT OF MICHAEL WAY.

LEGAL DESCRIPTION
THAT PORTION OF THE NORTHWEST QUARTER (NW 1/4) OF THE SOUTHEAST QUARTER (SE 1/4) OF SECTION 13, TOWNSHIP 20 SOUTH, RANGE 60 EAST, M.D.M., CLARK COUNTY, NEVADA.

BASIS OF BEARINGS
THE BASIS OF BEARINGS FOR THIS RECORD OF SURVEY IS NORTH 06° 42' 12" WEST AS DEFINED BY THE MONUMENTS SHOWN HEREON, BEING THE NORTH-SOUTH CENTER SECTION LINE OF SECTION 13, TOWNSHIP 20 SOUTH, RANGE 60 EAST, MOUNT DIABLO MERIDIAN, CITY OF LAS VEGAS, CLARK COUNTY, NEVADA, ESTABLISHED BY STRAIGHT LINE INTERSECTION BETWEEN OPPOSING ONE-QUARTER CORNERS PER FILE 02, PAGE 23 OF SURVEYS, SAME BEING THE CONTROL LINE OF MICHAEL WAY AS DERIVED BY FILE 02, PAGE 23 OF SURVEYS.

SIGHT VISIBILITY ZONES NOTE
NO WALLS, FENCES, TREES, SHRUBS, UTILITY APPURTENANCES OR ANY OTHER OBJECT, OTHER THAN TRAFFIC CONTROL DEVICES AND STREET LIGHT POLES, MAY BE CONSTRUCTED OR INSTALLED WITHIN THE SIGHT VISIBILITY ZONE UNLESS SAID OBJECT IS MAINTAINED AT LESS THAN 24 INCHES IN HEIGHT, MEASURED FROM THE TOP OF CURB.

ENGINEER'S NOTES
1. ALL WORK SHALL CONFORM TO THE SOILS REPORT PREPARED BY JA CESARE DATED OCTOBER 13, 2009, PROJECT NO. 09.180, ADDENDUM DATED JUNE 22, 2010 & UPDATE DATED FEBRUARY 16, 2011.
2. ALL OFF-SITE IMPROVEMENT CONSTRUCTION SHALL CONFORM TO THE "UNIFORM STANDARD SPECIFICATIONS FOR PUBLIC WORKS CONSTRUCTION, OFF-SITE IMPROVEMENTS, CLARK COUNTY AREA, NEVADA", LATEST EDITION. (IF APPLICABLE)
3. FINAL ASPHALTIC CONCRETE (AC) PAVEMENT SURFACES SHALL BE ONE-HALF INCH ABOVE THE TOP OF THE GUTTER (INCLUDING OPEN GRADE).
4. SEE ARCHITECTS PLANS FOR ALL HANDICAP ACCESSIBILITY INFORMATION, RAMP DETAILS, TRANSFORMERS, AND TRASH ENCLOSURE DETAILS. VERIFY BUILDING LAYOUTS AND DIMENSIONS WITH ARCHITECTURAL PLANS.
5. CONTRACTOR IS RESPONSIBLE FOR DUST AND EROSION CONTROL DURING CONSTRUCTION.
6. SEE LANDSCAPE PLANS FOR LANDSCAPING AND ONSITE IRRIGATION.
7. THIS PLAN SHALL NOT, IN PART OR IN WHOLE, BE USED FOR CONSTRUCTION UNLESS APPROVED AND SIGNED BY ALL APPLICABLE GOVERNMENT AGENCIES.
8. ENGINEER TO BE NOTIFIED OF ANY DISCREPANCIES IMMEDIATELY.
9. ALL MATCH ELEVATIONS SHOWN TO BE VERIFIED BY CONTRACTOR PRIOR TO CONSTRUCTION.

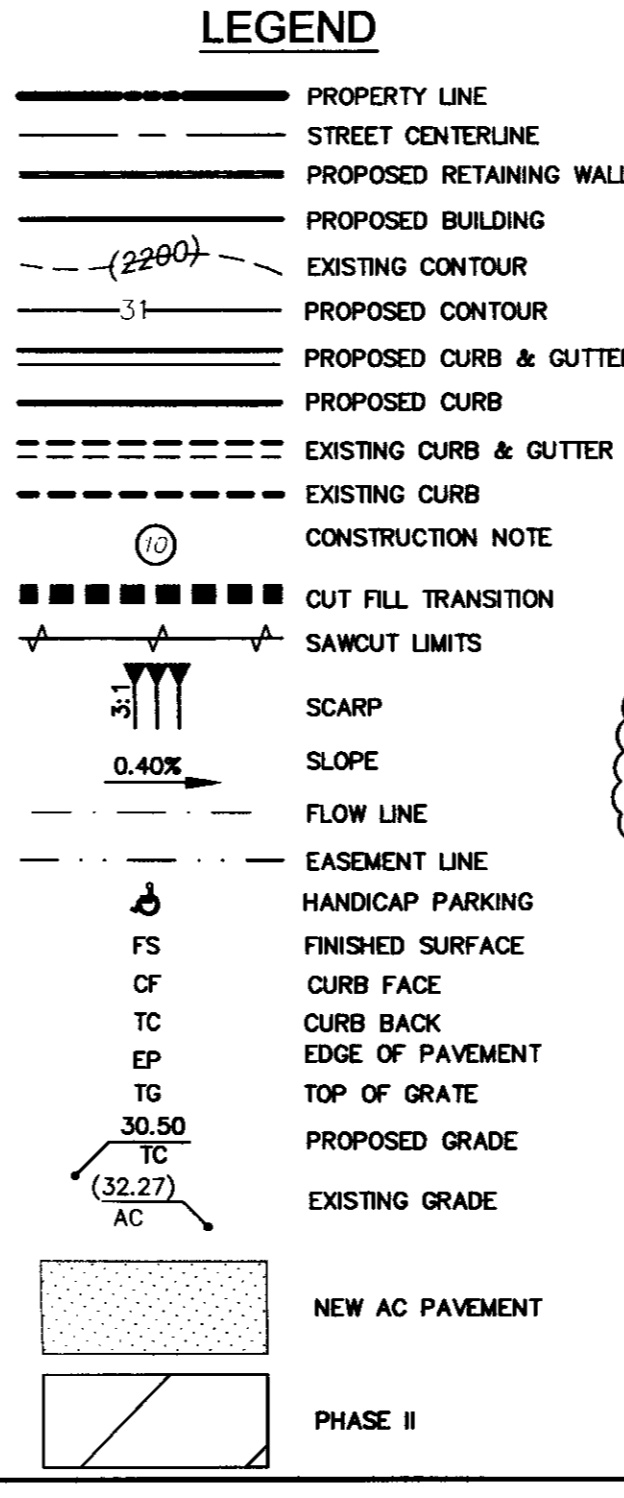

NO	ITEM
1	INSTALL 24" BEEHIVE INLET WITH CONCRETE APRON PER CC STD. DWG. NO. 418. SEE DETAIL 1 ON SHEET D2.
2	INSTALL 18" CLASS III RCP STORM DRAIN PIPE
3	INSTALL 18" RCP END SECTION PER NDOT DETAIL R-2.3.1. SEE DETAIL 2 ON SHEET D2.
4	INSTALL CLEAN OUT

NO	ITEM
1	INSTALL 1 1/2" SOLID GROUTED STEWALL WITH TOP CAP & TOP BENT BY OTHERS. ARCHITECTURAL PLANS FOR DETAIL
2	INSTALL FIRE HYDRANT AND 6" GATE VALVE PER UDACS PLATES 40

CONSTRUCTION NOTES
CONSTRUCT 3.5" MIN AC OVER EXISTING 8" MIN. TYPE II AGG. BASE PER LETTER BY JA CESARE DATED 8/26/11

CLARK COUNTY DEPARTMENT OF PUBLIC WORKS
ACCEPTANCE OF PLANS FOR FILING BY

ACCEPTANCE OF THESE PLANS FOR FILING SHALL NOT BE CONSIDERED TO BE A PERMIT FOR OR AN APPROVAL OF ANY VIOLATION OF ANY OF THE PROVISIONS OF THE STATE OR COUNTY LAWS AND/OR SPECIFICATIONS. CLARK COUNTY SHALL BE HELD FREE FROM DAMAGES WHICH MAY RESULT FROM CONSTRUCTION OF THE IMPROVEMENTS FROM THE ENGINEERING DESIGN DEPICTED HEREIN.

NOTE: POWER POLES AND/OR OTHER EXISTING FACILITIES NOT IN PROPER LOCATION BASED ON PROPOSED IMPROVEMENTS SHOWN HEREON WILL BE RELOCATED AT NO EXPENSE TO THE CLARK COUNTY.

NO	ITEM
1	CONTRACTOR TO VERIFY INVERT PRIOR TO CONSTRUCTION & MODIFY MANHOLE INVERT FOR 8" SS
2	INSTALL 48" DIA. PRE-CAST SEWER MANHOLE PER SD-1A & SD-1B
3	INSTALL 8" DIA PVC SDR-35 SEWER MAIN
4	REMOVE EXISTING 10" SS TO EX. SSMH

NOTE
OWNER RESPONSIBLE TO PROVIDE SURVEY MONUMENTATION AS SHOWN AND TO REPLACE ALL SURVEY MONUMENTATION DAMAGED, DISTURBED, DESTROYED, OR OBTUSCURED DURING CONSTRUCTION.

APPROVED FOR CONSTRUCTION
part of drainage study
#4380-2 which was received on 12/8/11 and approved on 12/8/11 Page 2 of 2

CLV DRAWING NO. 1167.00

WIE
WALKER ENGINEERING, LLC
5765 S. RAINBOW BLVD.
SUITE 101
LAS VEGAS, NV 89118
TEL: 702.873.5197
FAX: 702.873.5346

PROFESSIONAL SEAL OF NEVADA
JAMES W. WALKER
REGISTERED PROFESSIONAL ENGINEER
No. 17819
12.51

APPROVAL

APPROVAL	DATE	INITIALS

REVISIONS

NO	DESCRIPTION OF REVISION	DATE
1	SHIFT BEEHIVE CLOSER TO EP & ADD GUARDRAIL DUE TO EX. PRIVATE WATER CONFLICT	11/28/11
2	REVISE PAVEMENT SECTIONS FOR MICHAEL & MADRE MESA	9/7/11

CATALYST CONSULTING COMPANY
AGUILAS CFC CHURCH

MICHAEL WAY
PLAN & PROFILE
STA. 7+88.34 TO STA. 15+00.00
PHASE I

CC HTE: 10-10763
SUBMITTAL NO. FINAL
DATE: MARCH 22, 2011
WE PROJECT NO. 1167.00
AGENCY NO. CLV:37715
SHEET NO.: P1

9/11/11

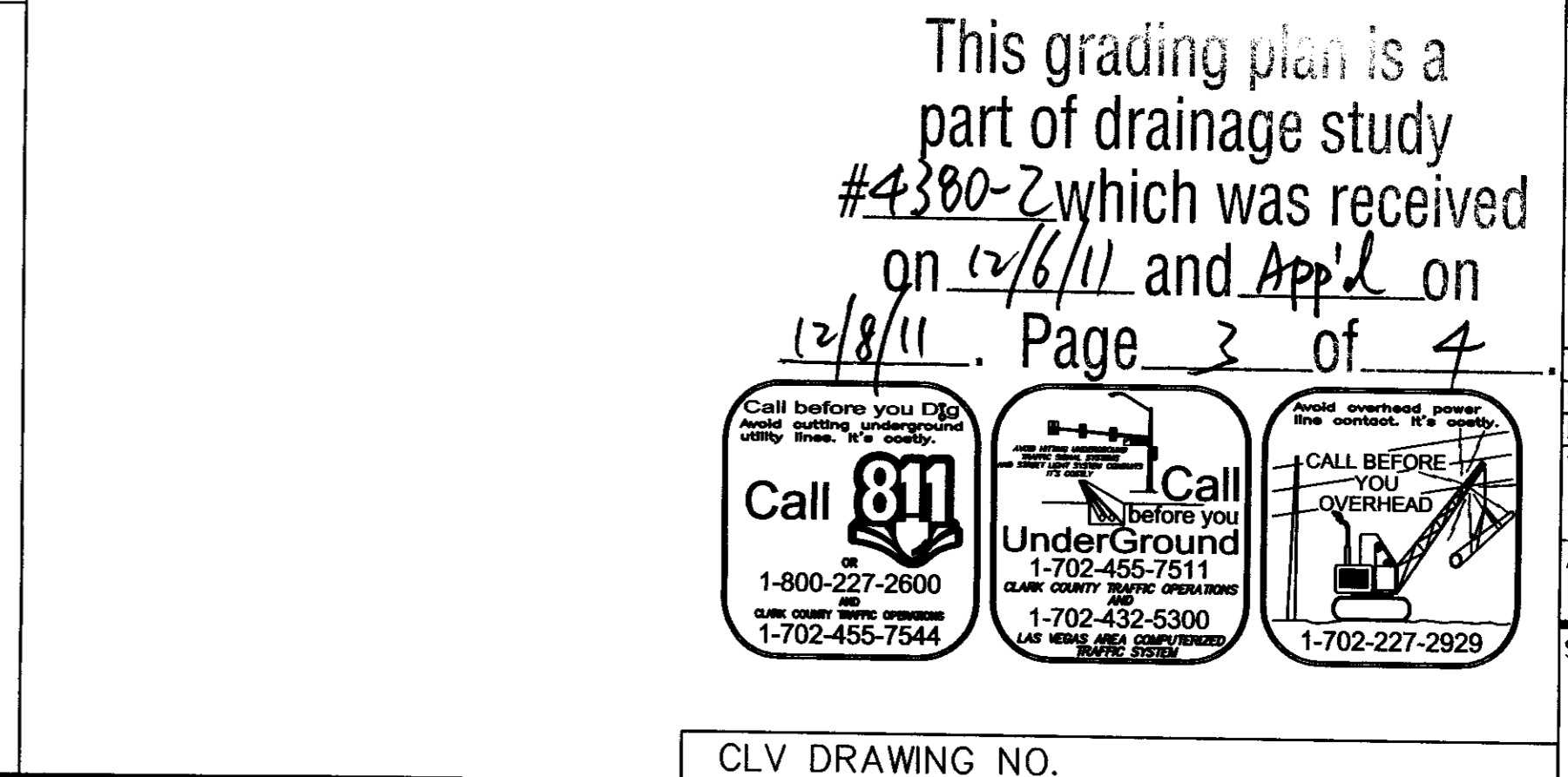
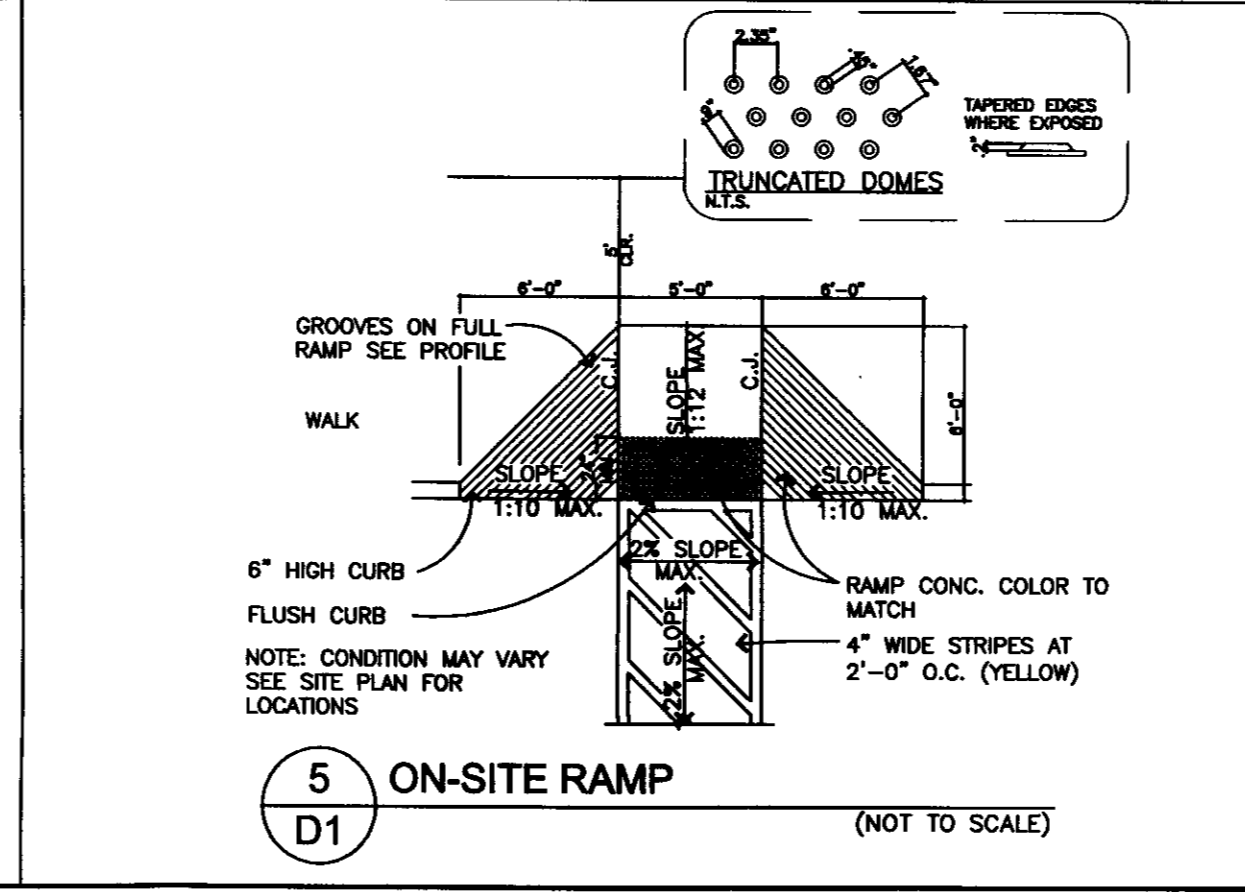
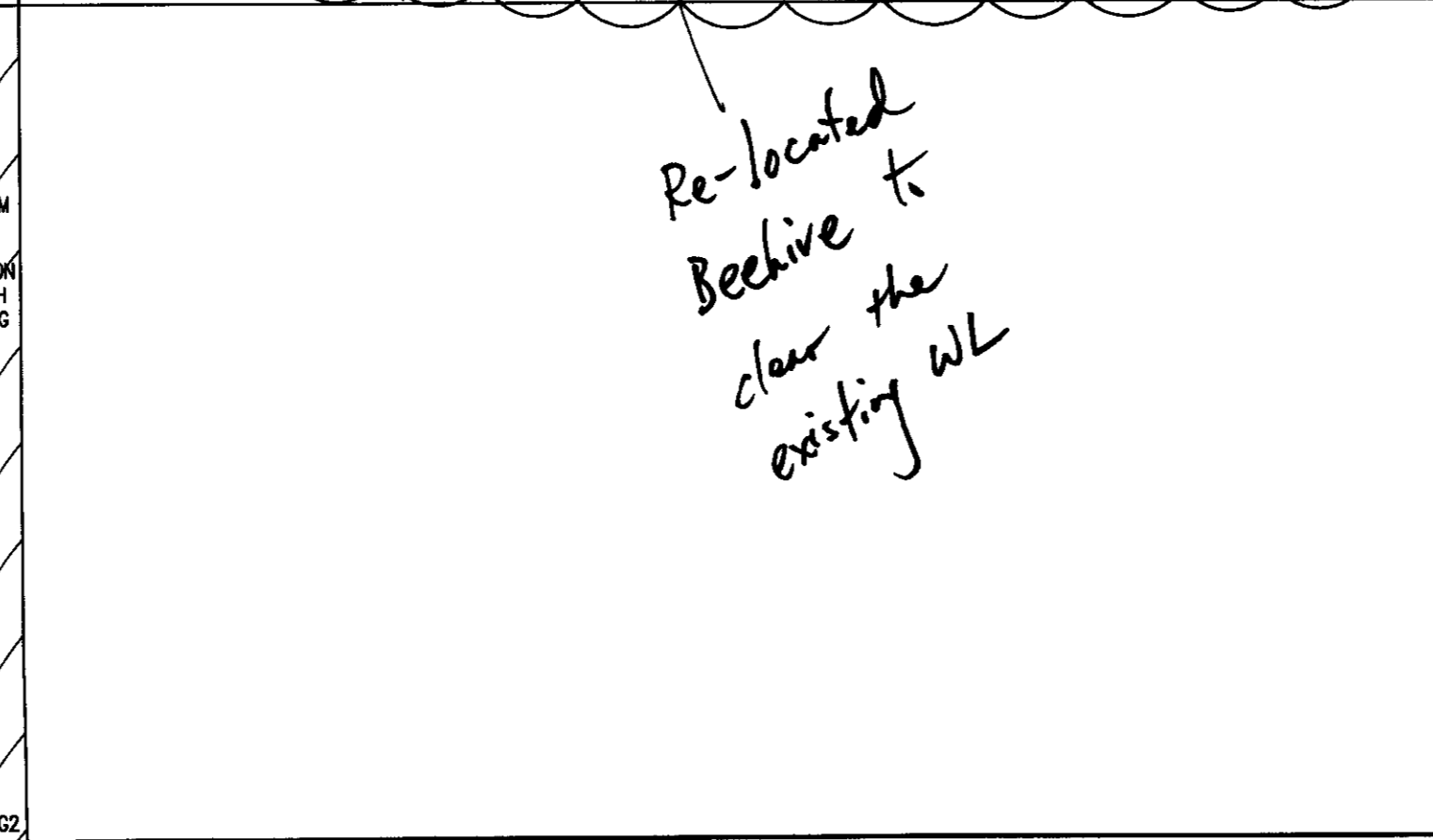
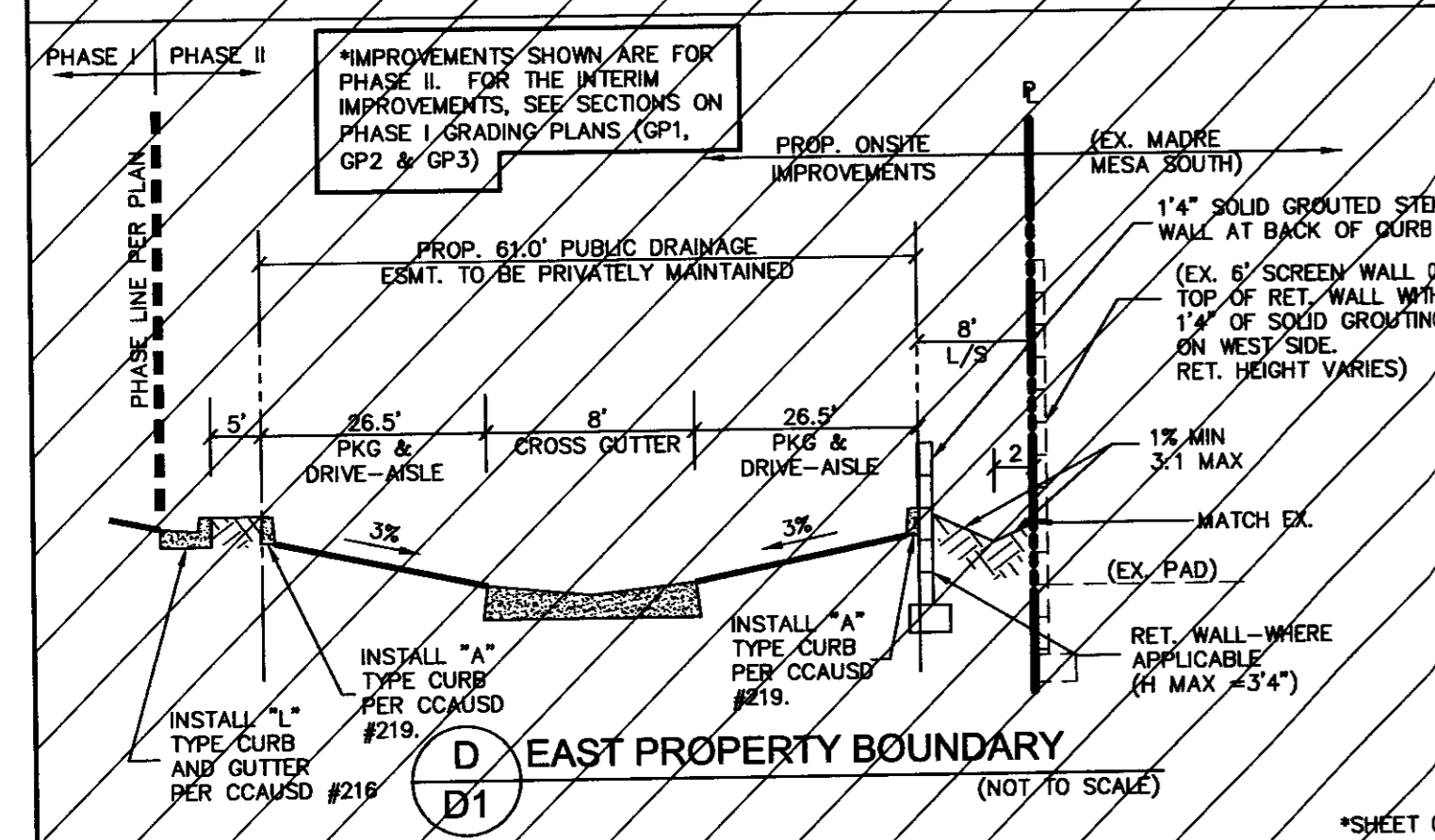
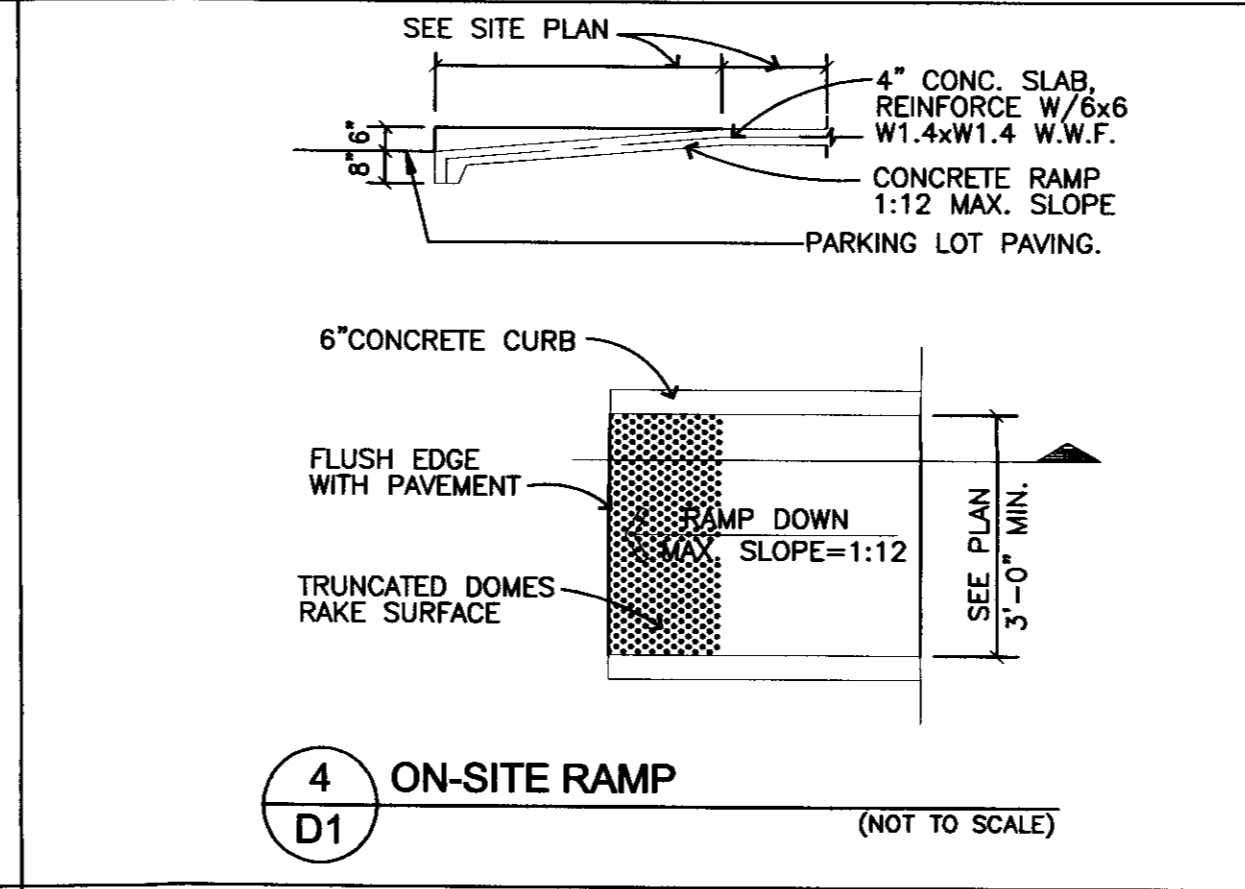
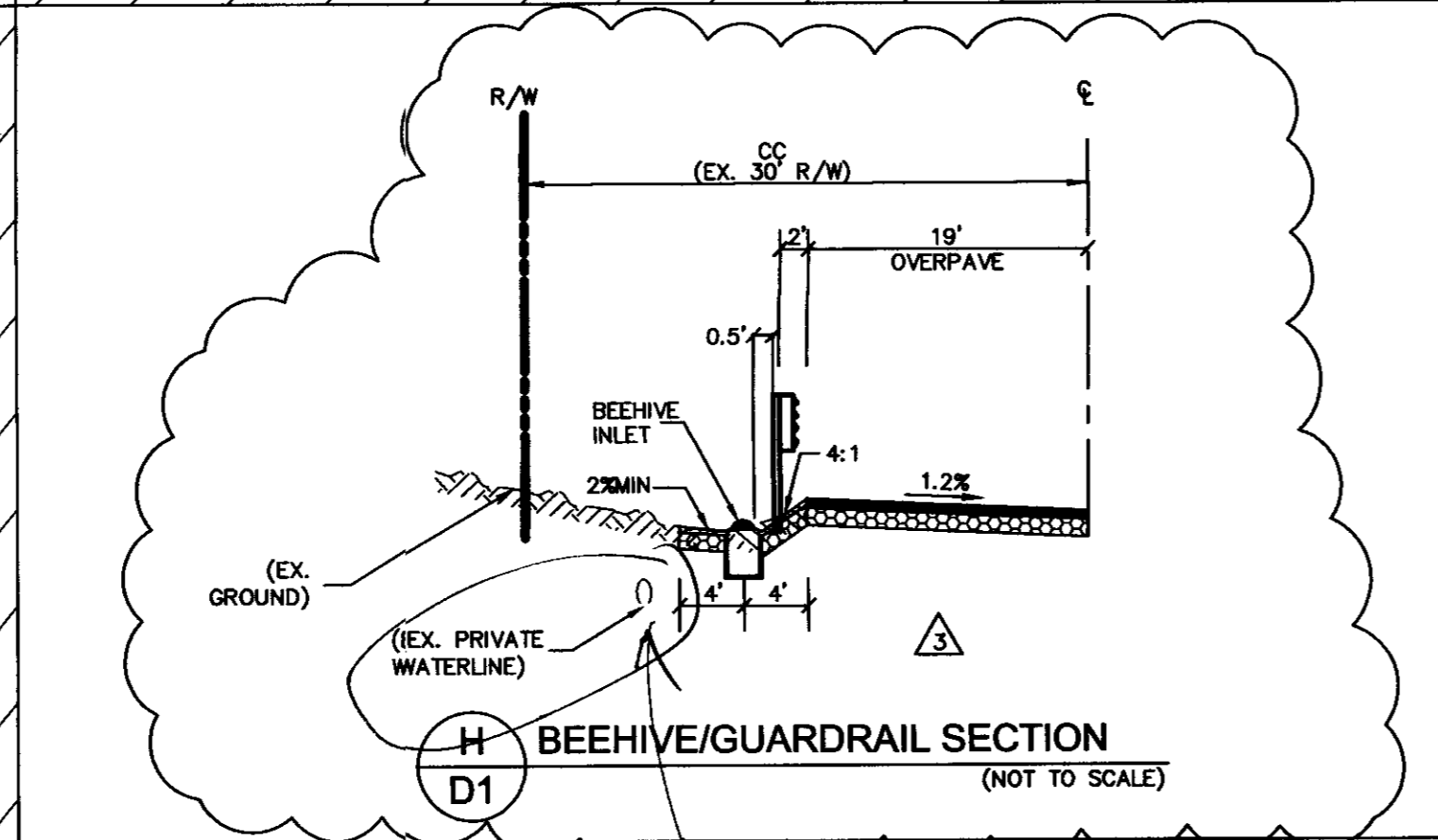
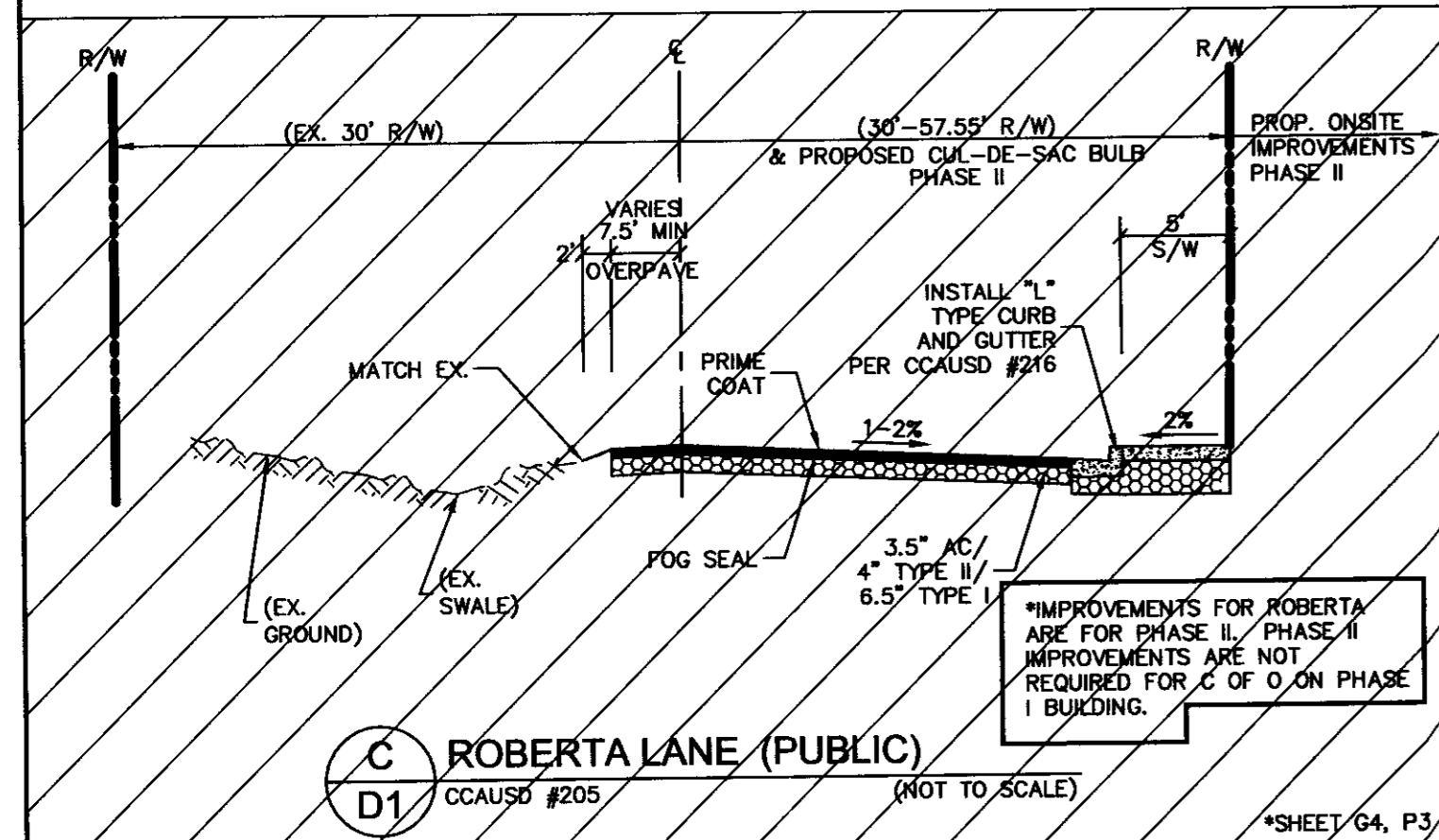
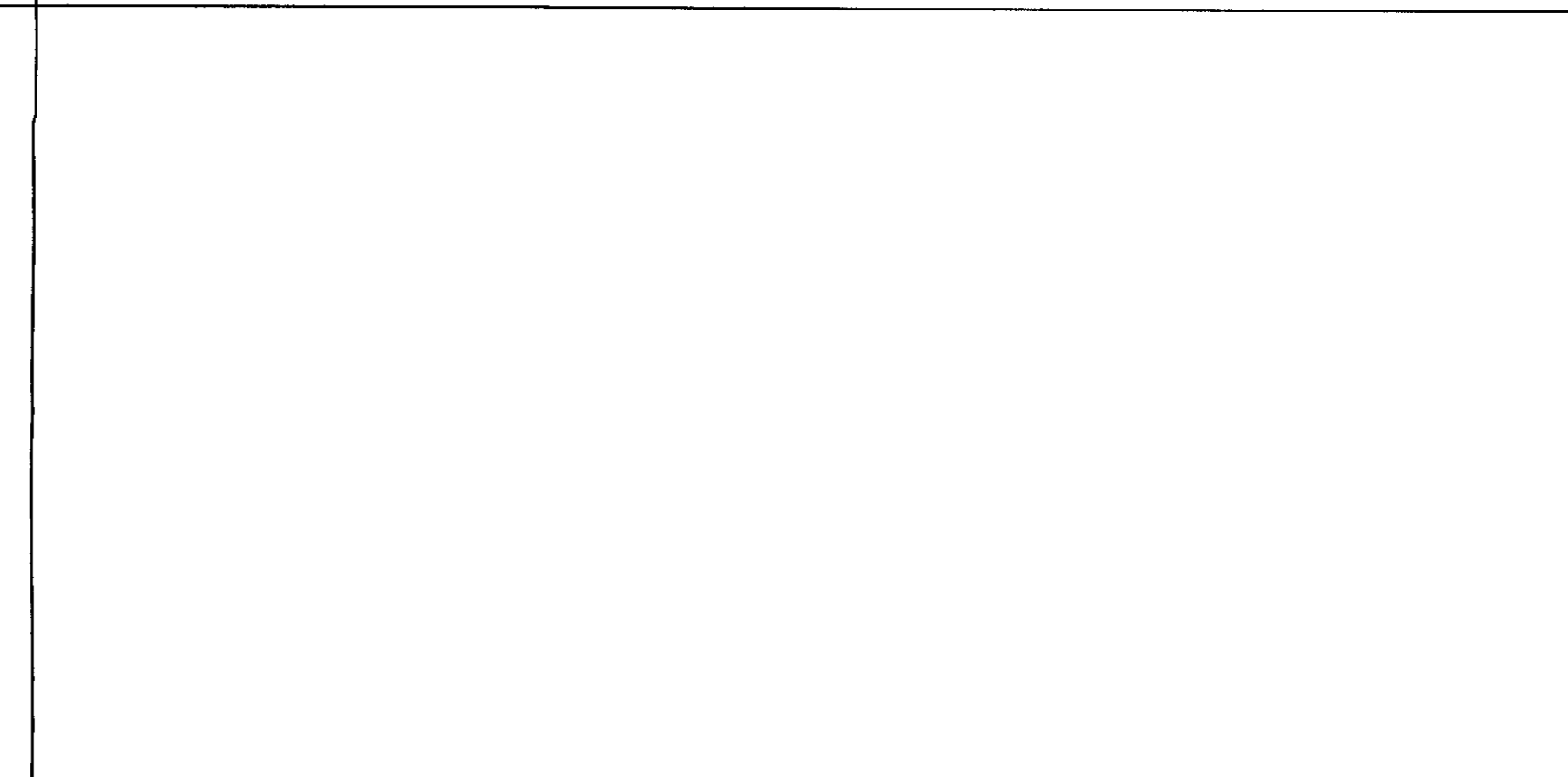
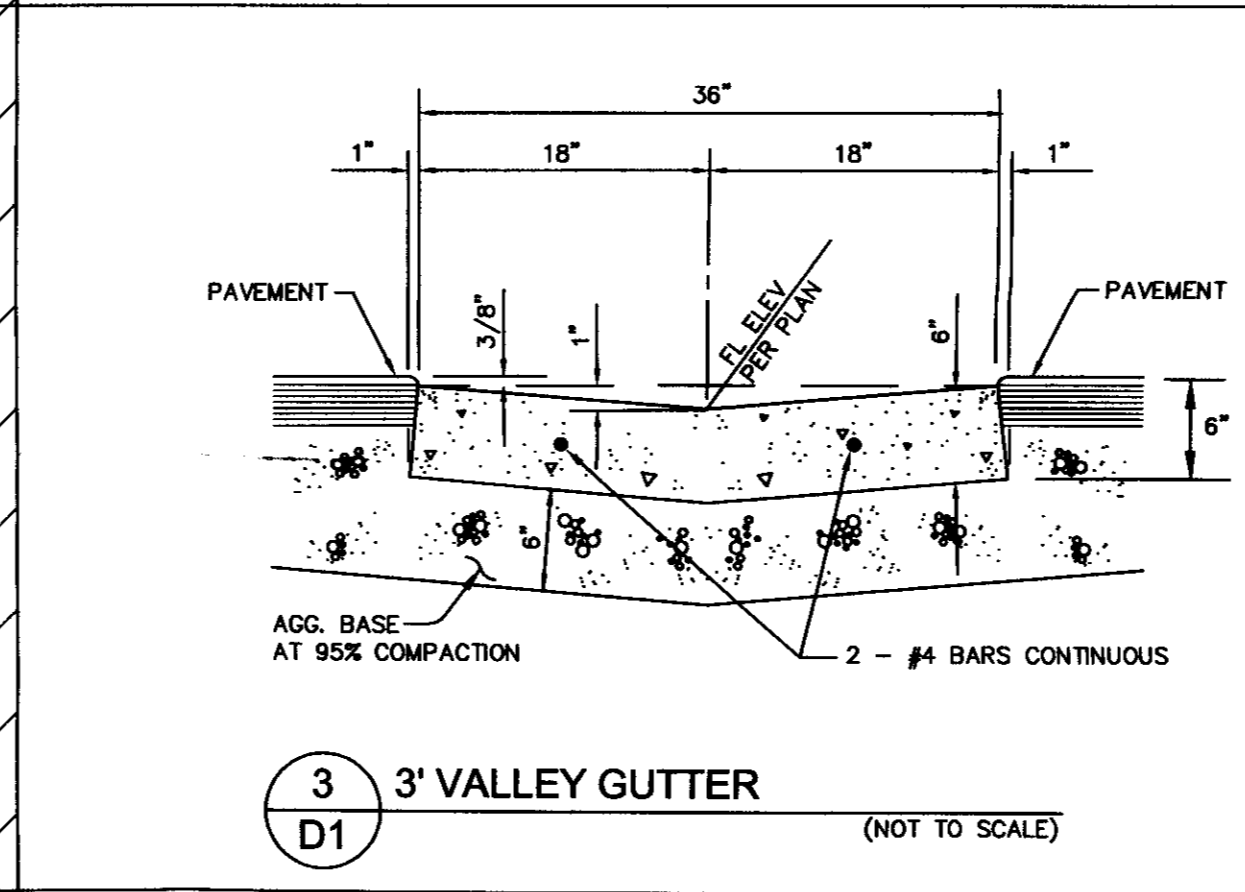
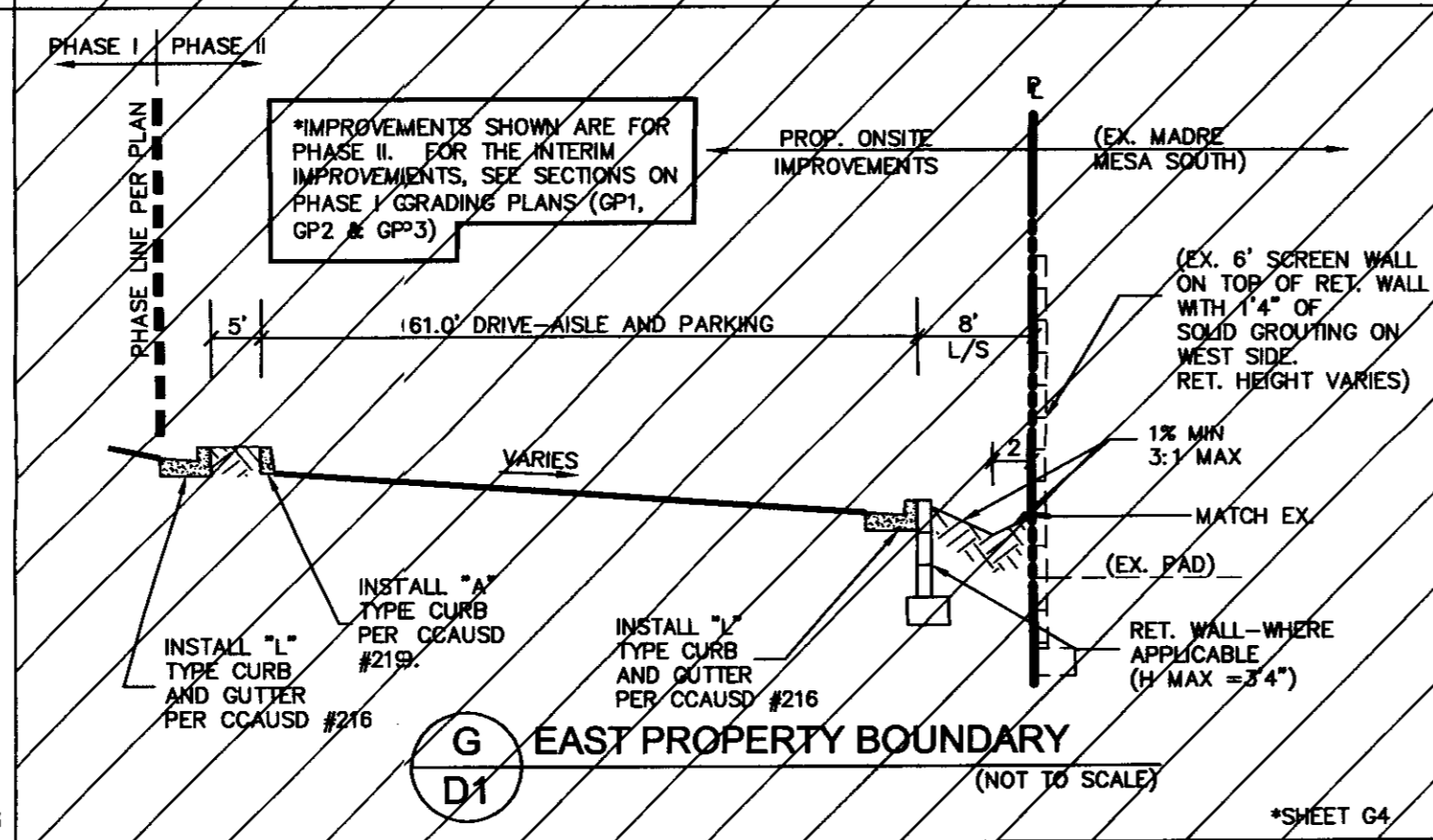
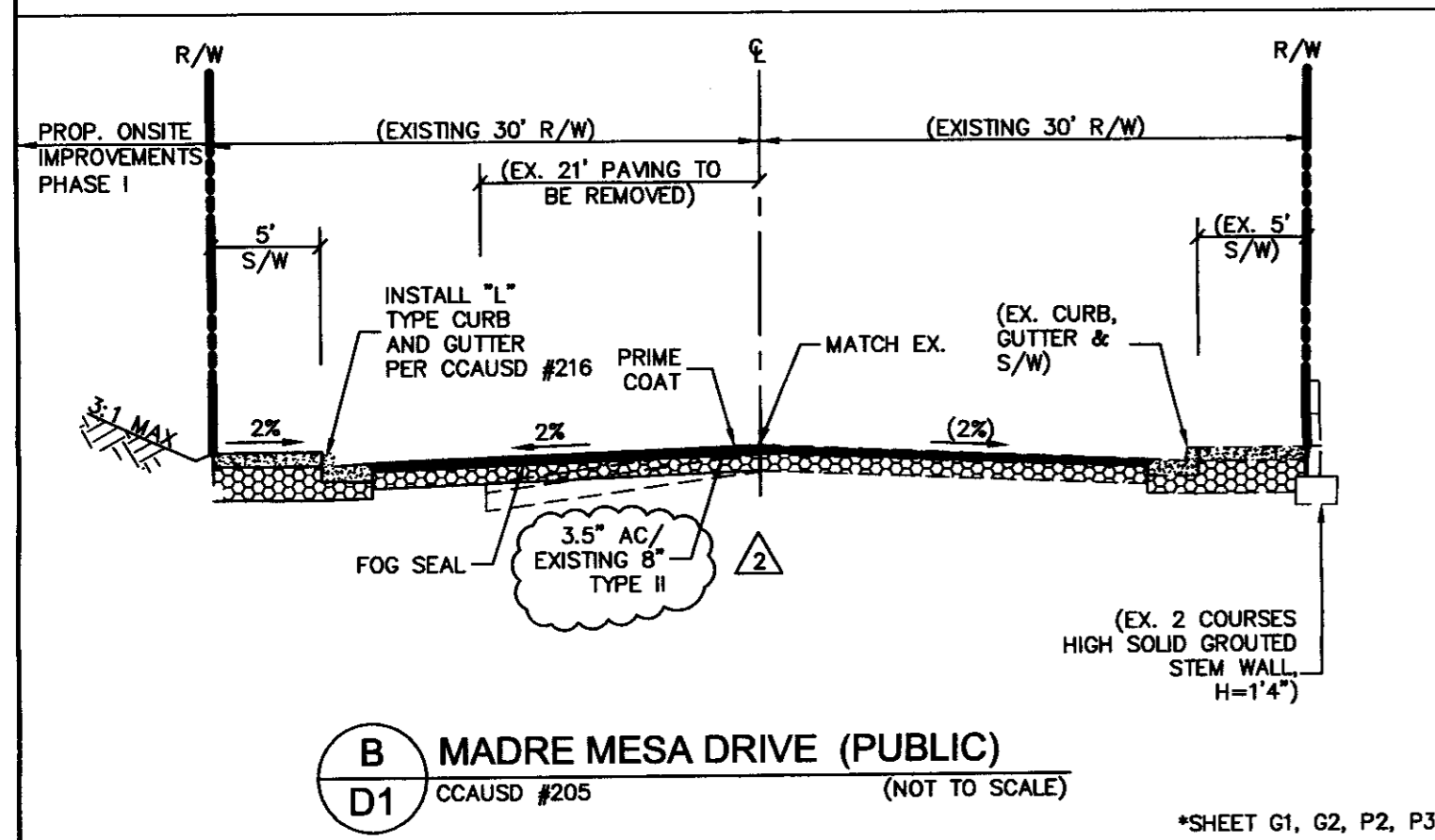
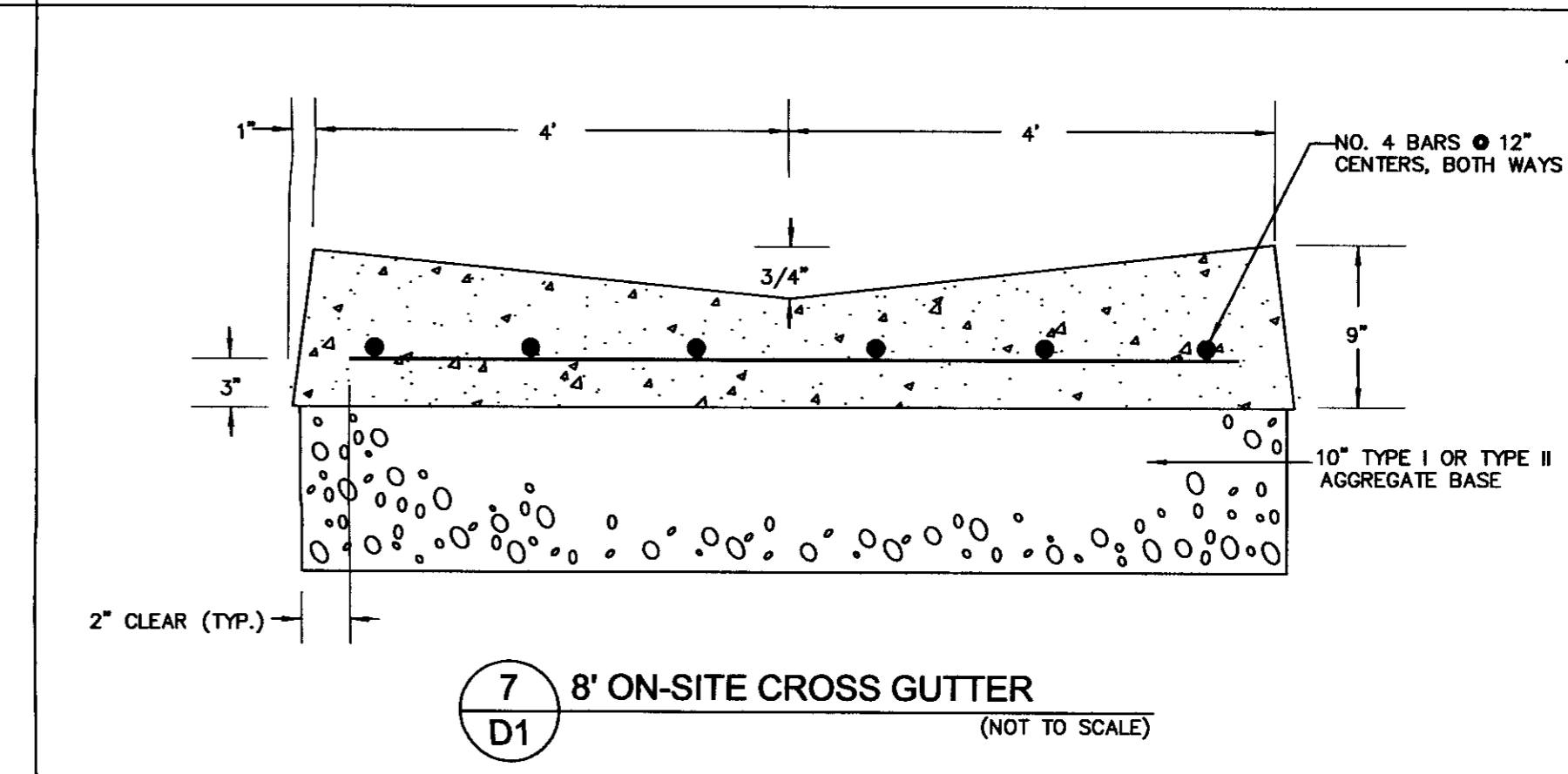
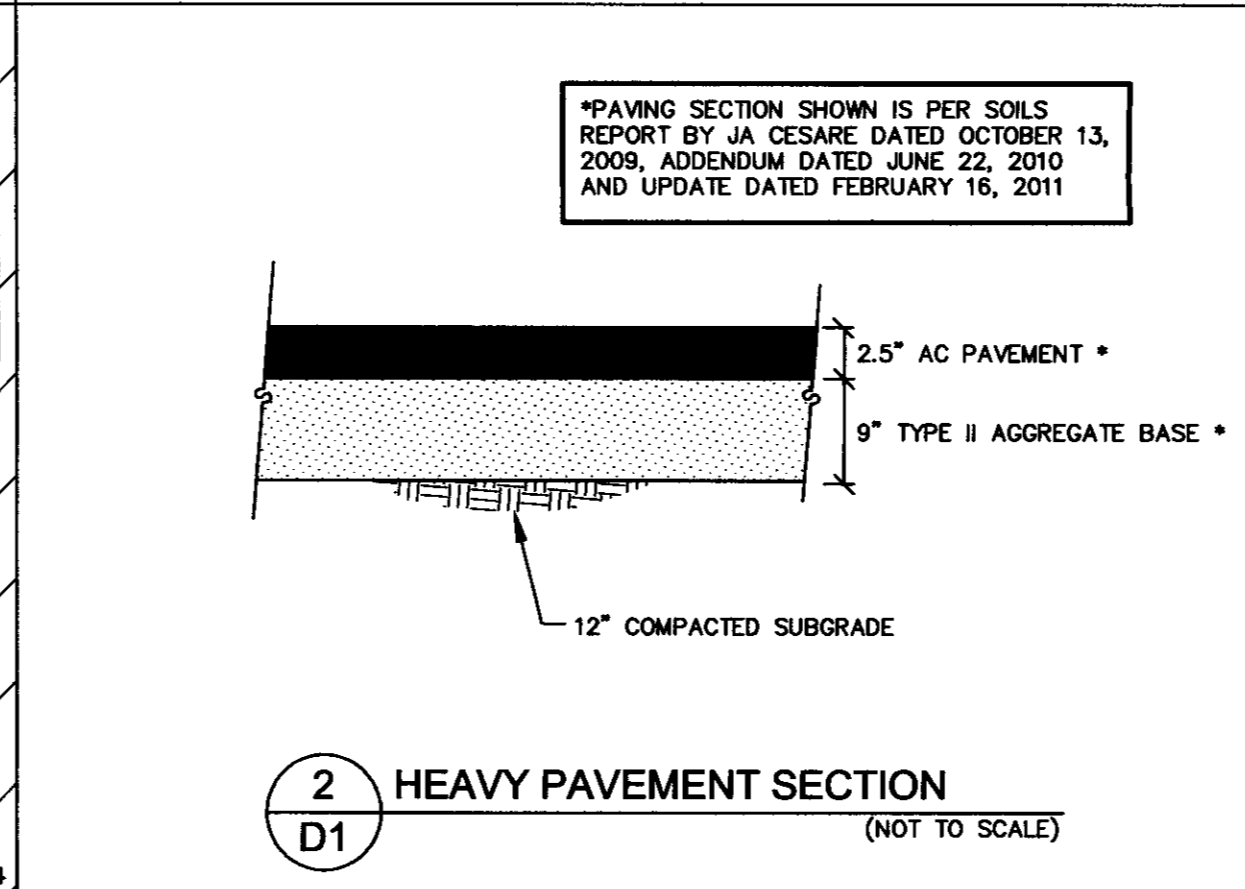
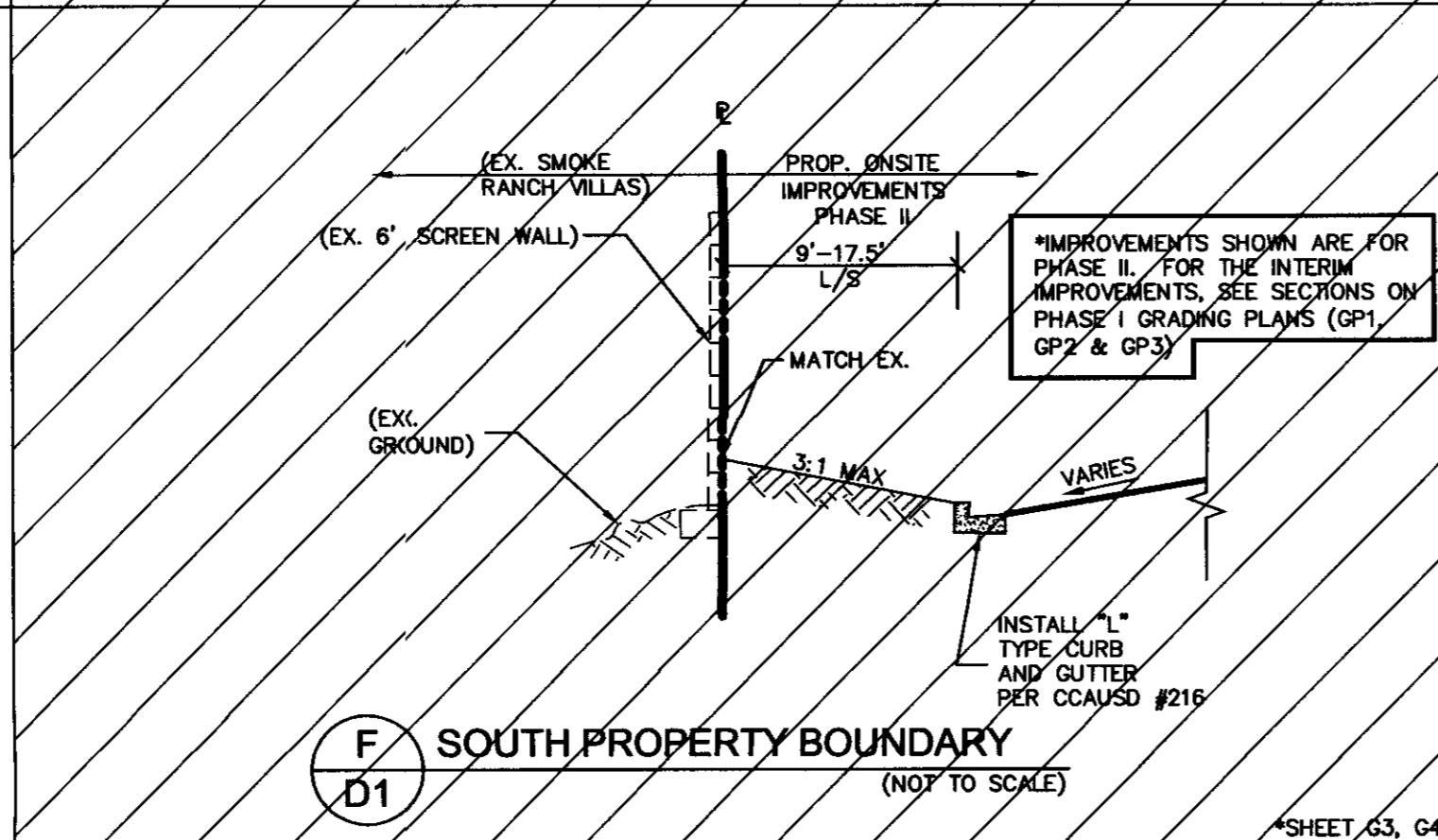
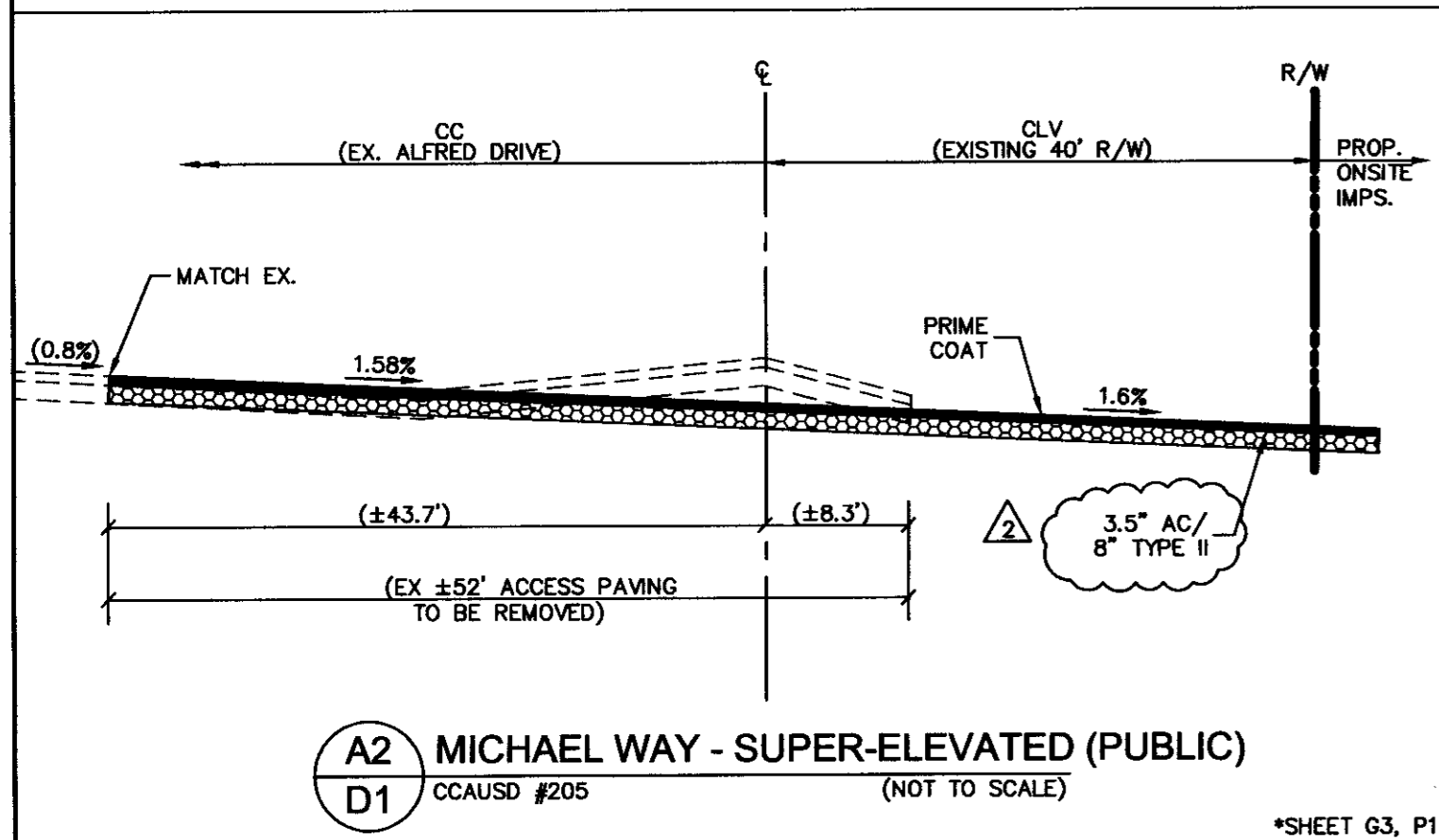
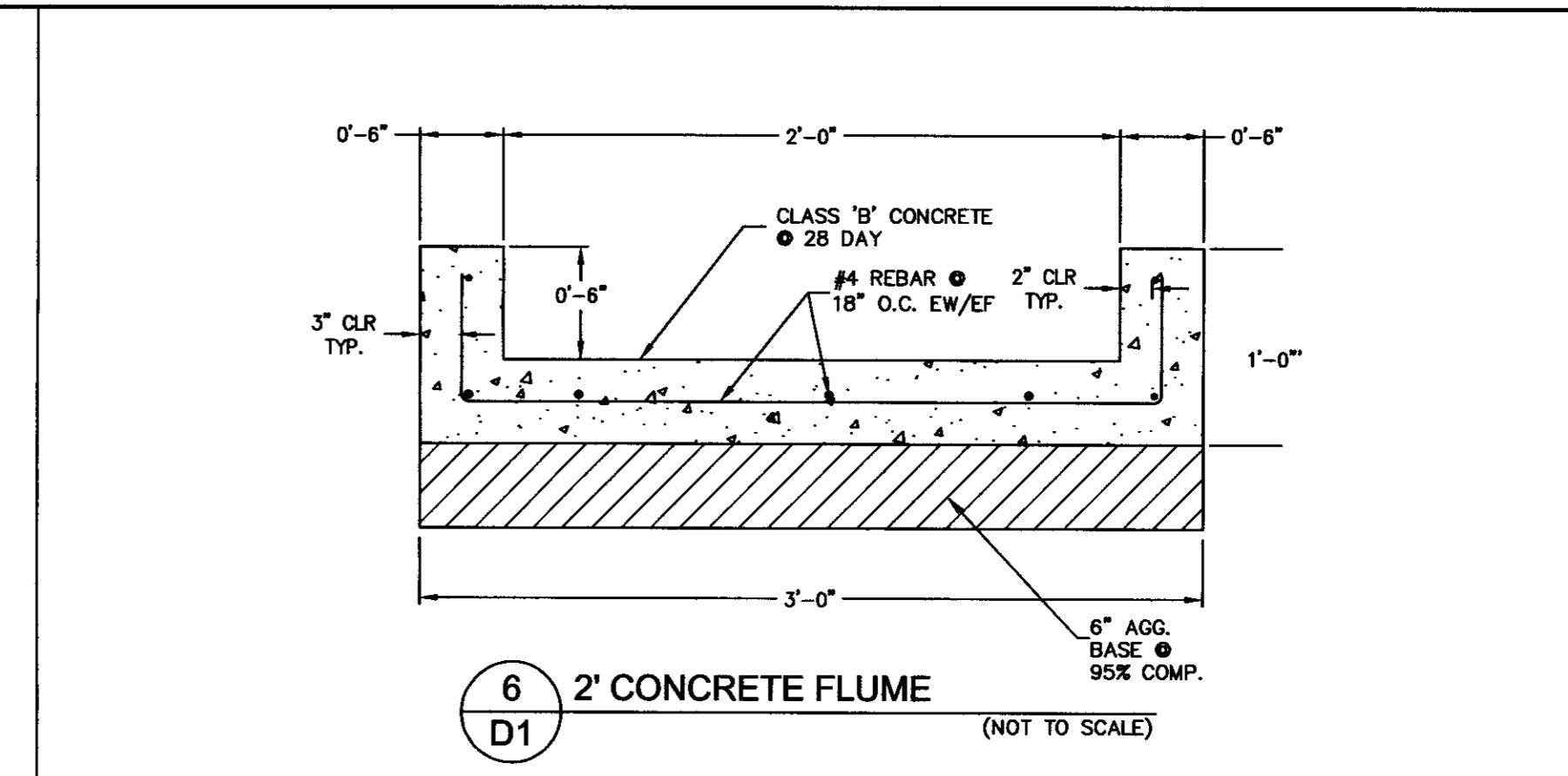
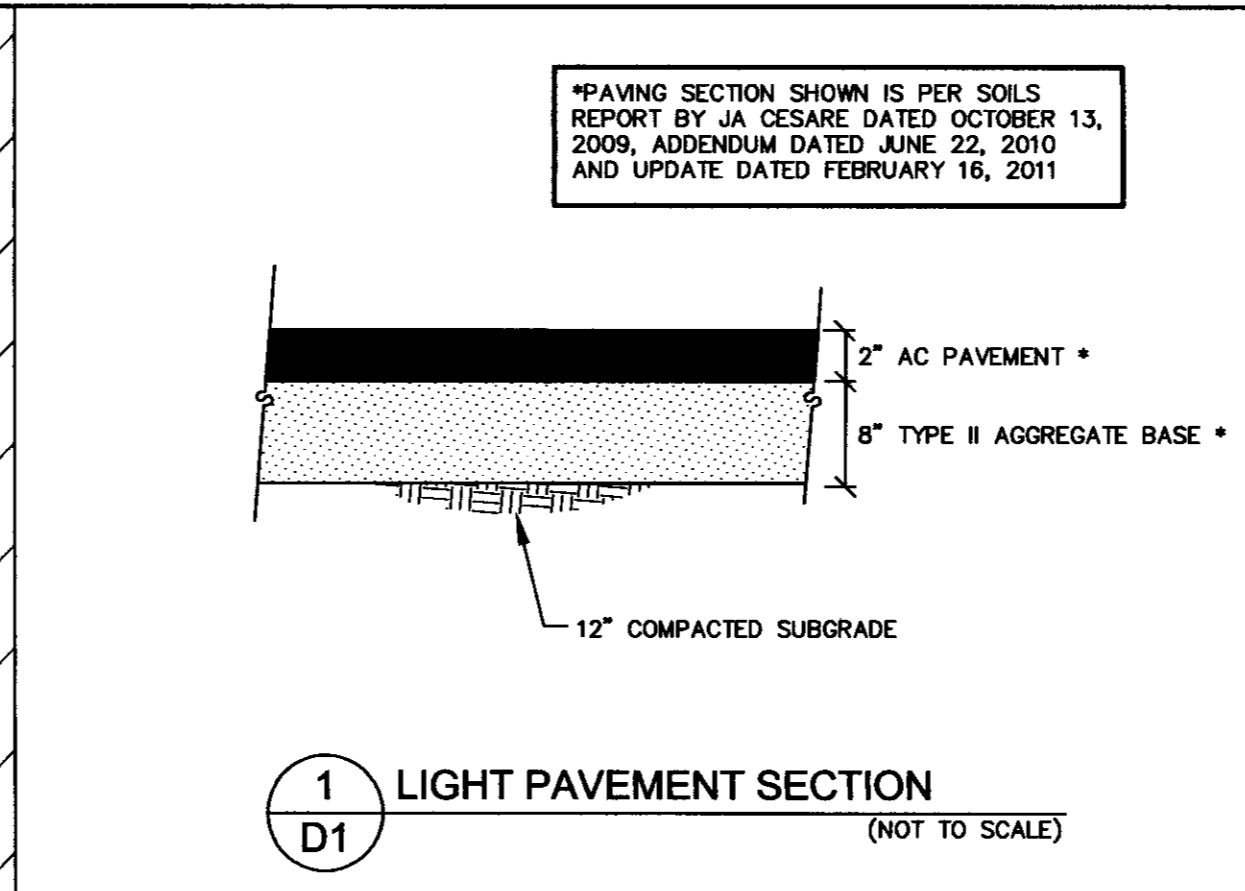
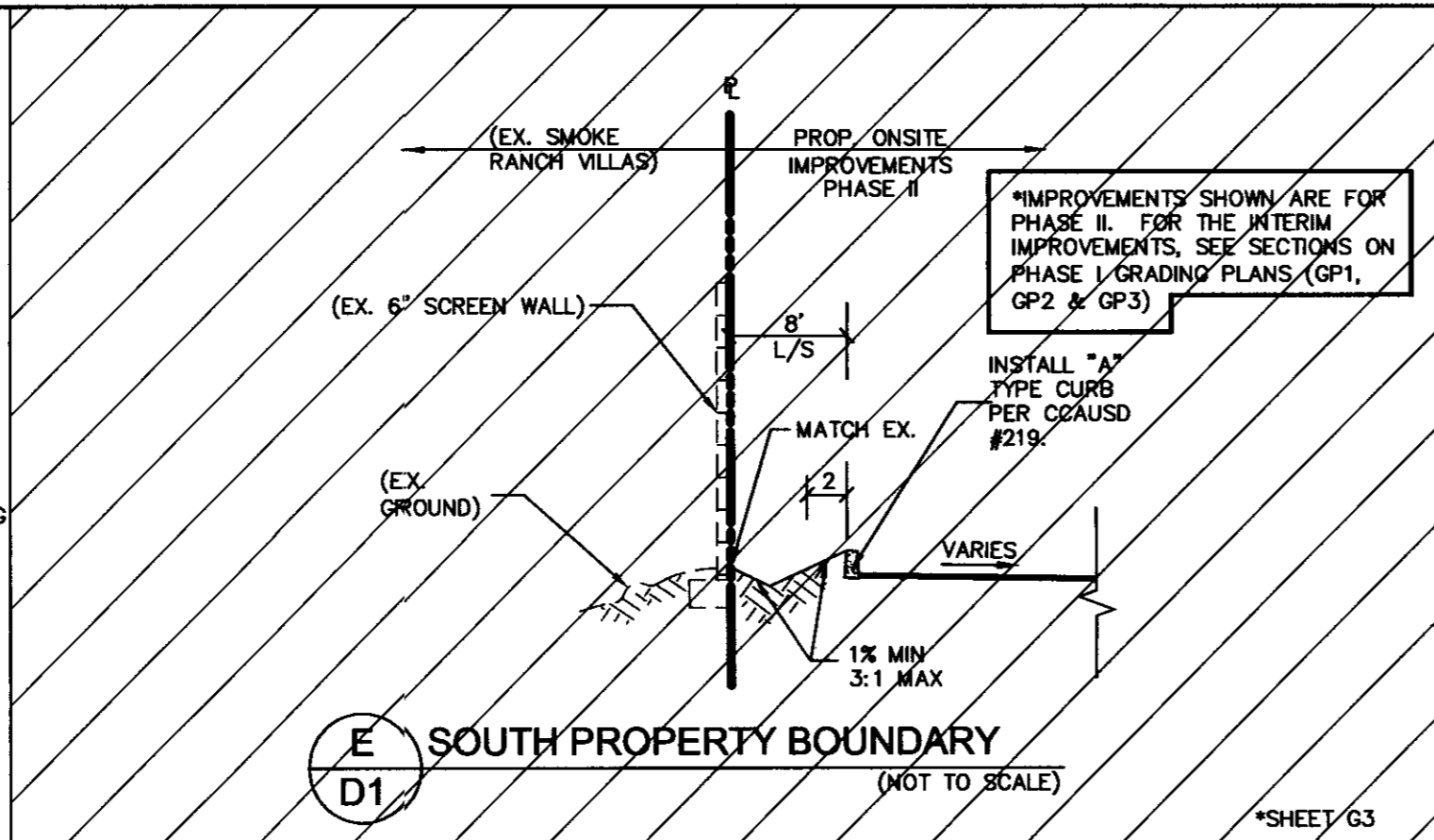
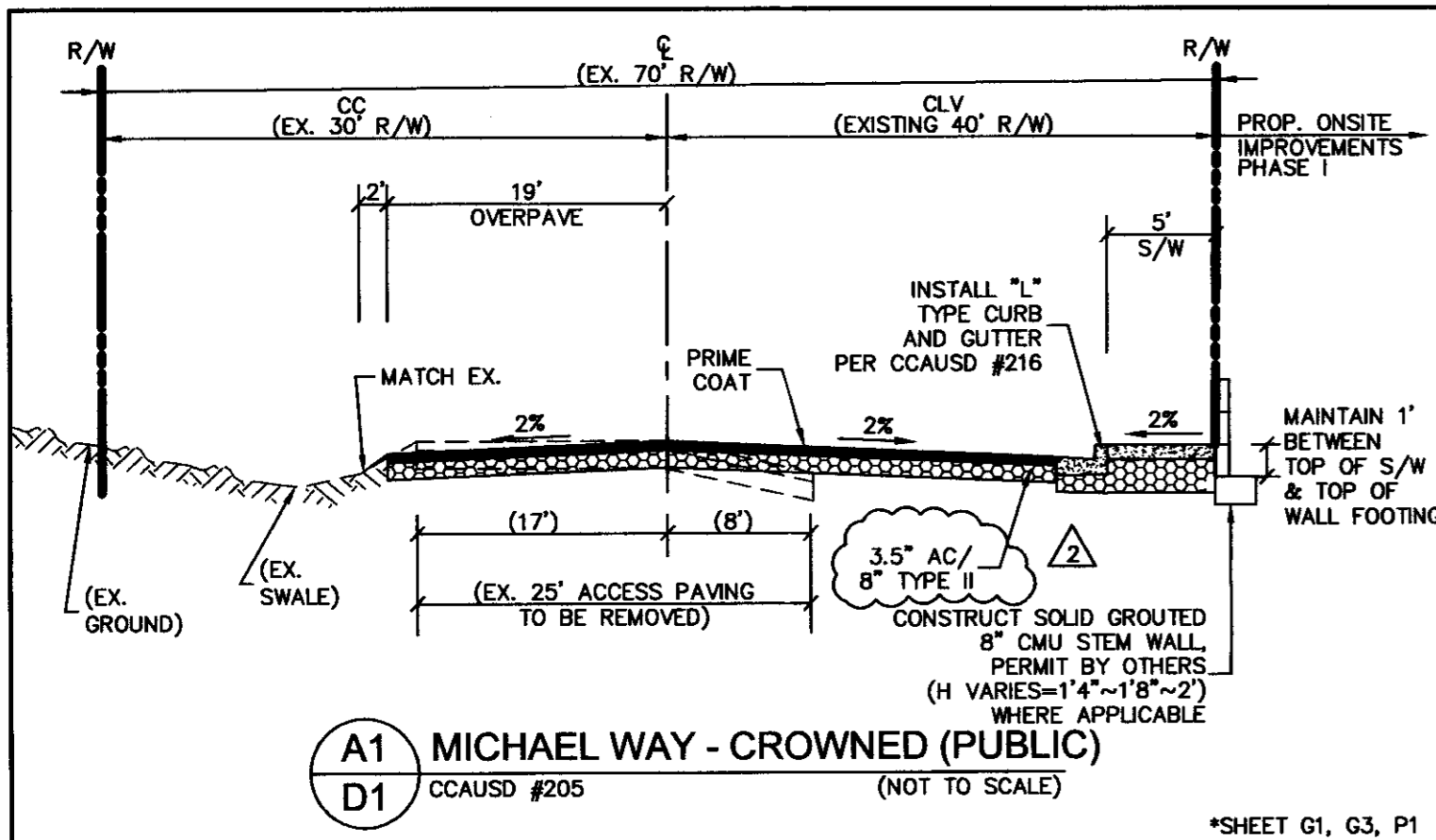

WIE
WALKER ENGINEERING, LLC
5765 S. RAINBOW BLVD.
SUITE 101
LAS VEGAS, NV 89118
TEL: 702.873.5197
FAX: 702.873.5346

STATE OF NEVADA
Professional Engineer
No. 17816
Exp. 12/31/11

NO.	DATE	DESCRIPTION OF REVISION	INITIALS
1	11/28/11	ADD BEEHIVE/GUARDRAIL DETAIL	
2	07/11	REVISE PAVEMENT SECTIONS FOR MICHAEL & MADRE MESA	

CATALYST CONSULTING COMPANY
AGUILAS CFC CHURCH

REVISIONS

DETAIL SHEET
SHEET 1 OF 2
PHASE I

CC HITE: 10-10763
SUBMITTAL NO. R3
DATE: NOVEMBER 28, 2011
WE PROJECT NO. 1167.00
AGENCY NO. CLV:37715
SHEET NO. D1
4 OF 27 SHEETS

This grading plan is a part of drainage study #4380-2 which was received on 12/6/11 and App'd on 12/8/11. Page 3 of 4

Call before you dig
1-800-227-2600
1-702-455-7511

Call before you dig
1-702-455-7511
1-702-432-5300

Call before you dig
1-702-227-2929

Re-located Beehive to clear the existing WL

