

X:\Projects\100022151_WashAve_Sheets\22151-5-S5 *6-05-13 02:34pm

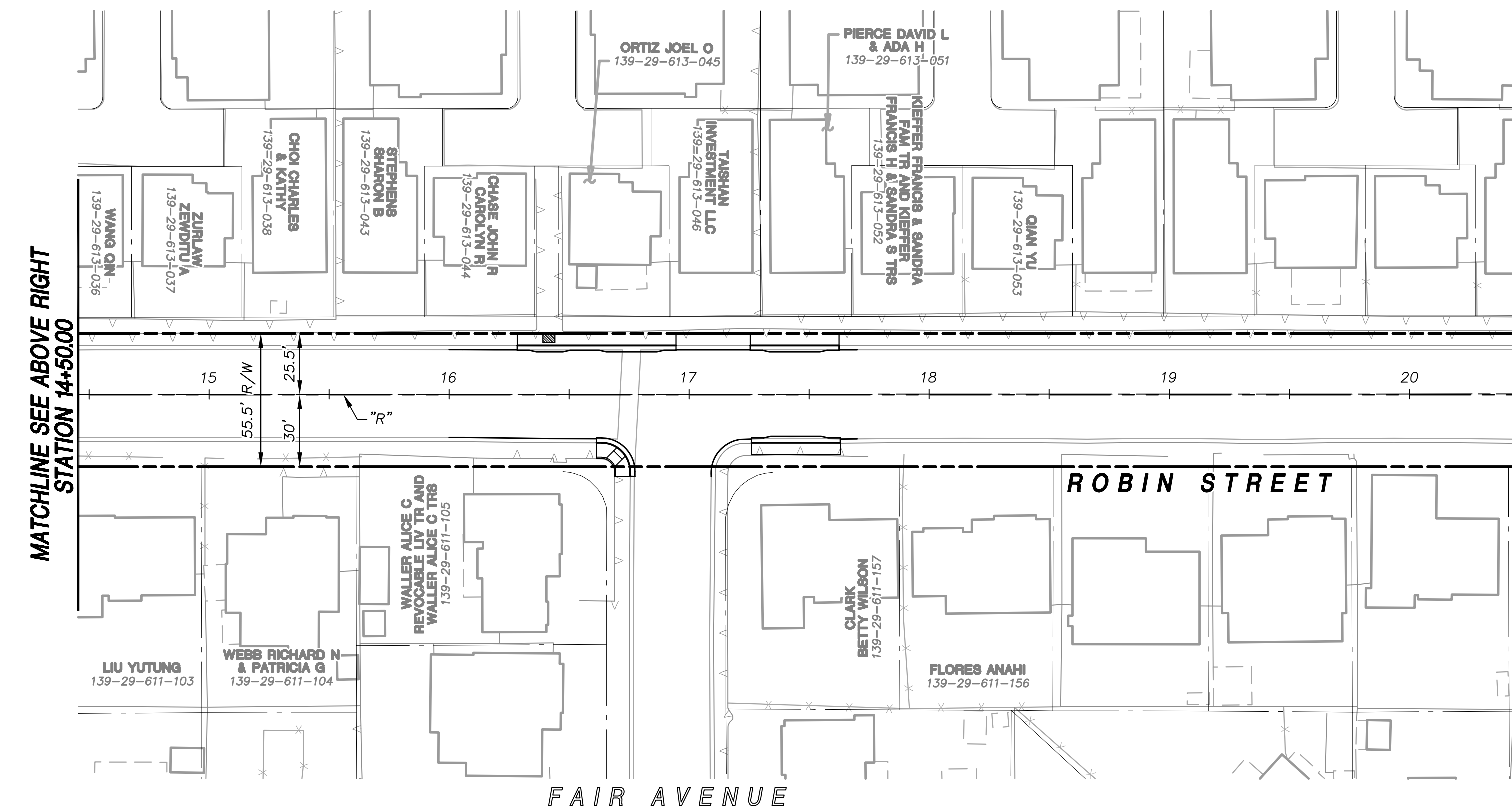
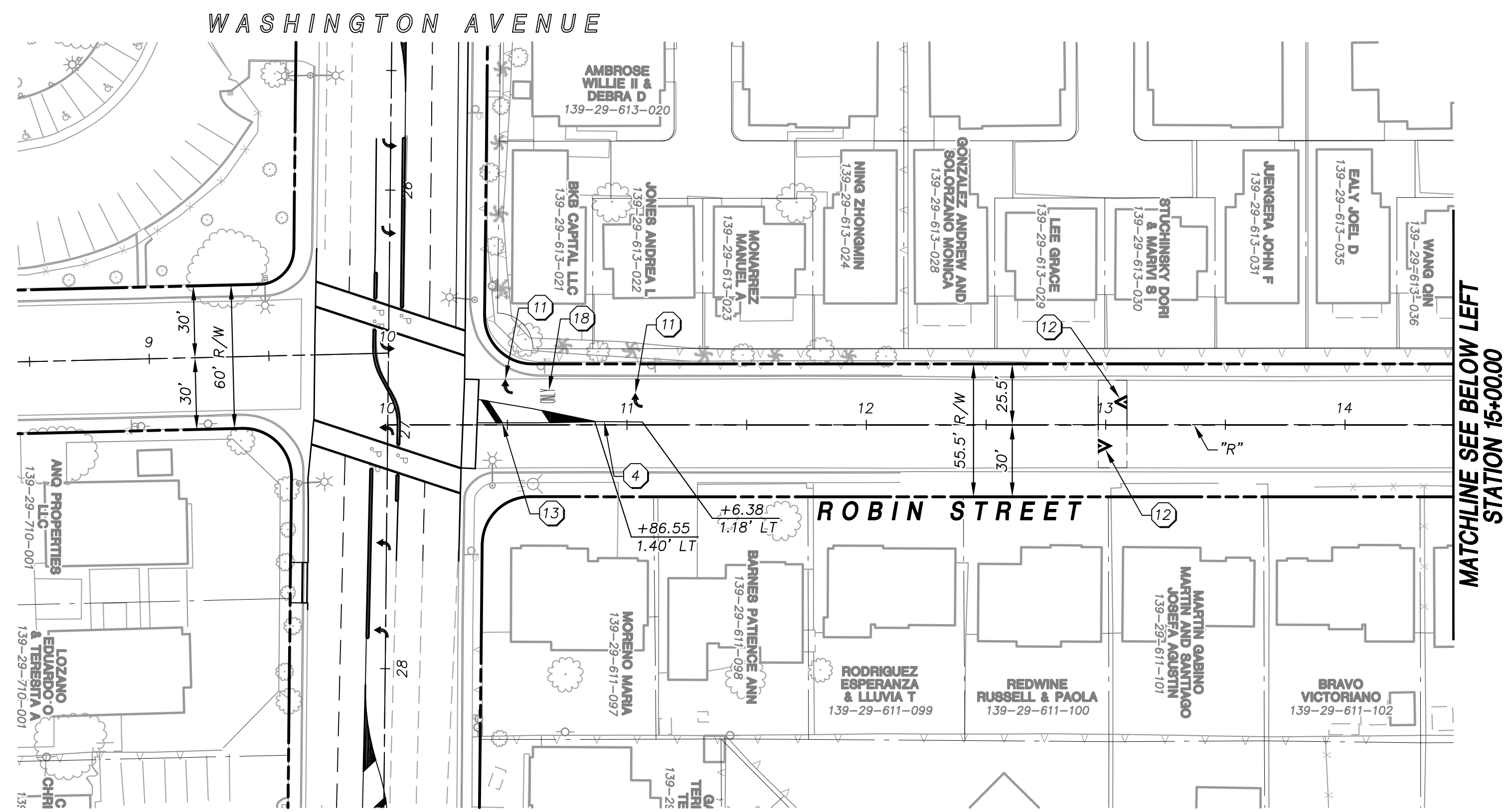

TRAFFIC NOTES

- 1 INSTALL TYPE 4 LANE LINE (RPM) PER USD #244.1
- 2 INSTALL 6" SOLID WHITE LINE (POLYUREA)
- 3 INSTALL STORAGE LANE LINE PER USD #246 (RPM)
- 4 INSTALL TYPE I CENTERLINE (RPM) PER USD #244
- 5 INSTALL TYPE II CENTERLINE (RPM) PER USD #244
- 6 INSTALL BIKE LANE SYMBOL WITH ARROW (TYPE II PMF) PER USD #244.9
- 7 INSTALL MEDIAN NOSE MARKINGS PER USD #248
- 8 INSTALL 24" STOP LINE PER USD #254
- 9 INSTALL CROSSWALK MARKINGS PER USD #254
- 10 INSTALL TYPE II CROSSWALK MARKING PER USD #254.1.S1
- 11 INSTALL WHITE TURN ARROW (TYPE II PMF)
- 12 INSTALL PAVEMENT MARKINGS FOR SPEED HUMP PER DETAIL 1/56
- 13 INSTALL TRANSITION PER USD #245 (2 OF 3) (RPM) (YELLOW)
- 14 REMOVE K71 FLEXIBLE MARKER POST
- 15 INSTALL K71 FLEXIBLE MARKER POST
- 16 REMOVE AND REPLACE EXISTING SIGNS(S)
- 17 EXISTING SIGN(S) TO BE REMAIN
- 18 INSTALL WHITE "ONLY" (TYPE II PMF)

APPROVED FOR CONSTRUCTION

Las Vegas Valley Water District Engineering Services Manager
Date _____ Project No. XXXXXX ESN 018

Call before you Dig
AVOID HITTING UNDERGROUND
UTILITY LINES. IT'S COSTLY.

Call
811

1-800-227-2600

FAST

Call
before you
UnderGround

1-702-432-5300

PREVENT AND AVOID
DISRUPTION OF TRANSPORTATION

AVOID HITTING OVERHEAD
POWER LINES. IT'S COSTLY.

**CALL BEFORE
YOU DO
OVERHEAD**

1-702-227-2929

GRAPHIC SCALE

(IN FEET)
HORIZ 1 inch = 40 ft.
VERTICAL 1 inch = 4 ft.

CAUTION:
EXISTING UTILITIES ARE LOCATED ON THE PLANS FROM A
SEARCH OF AVAILABLE RECORDS. CONTRACTOR TO
VERIFY LOCATIONS AND DEPTHS PRIOR TO CONSTRUCTION.

SHEET INDEX

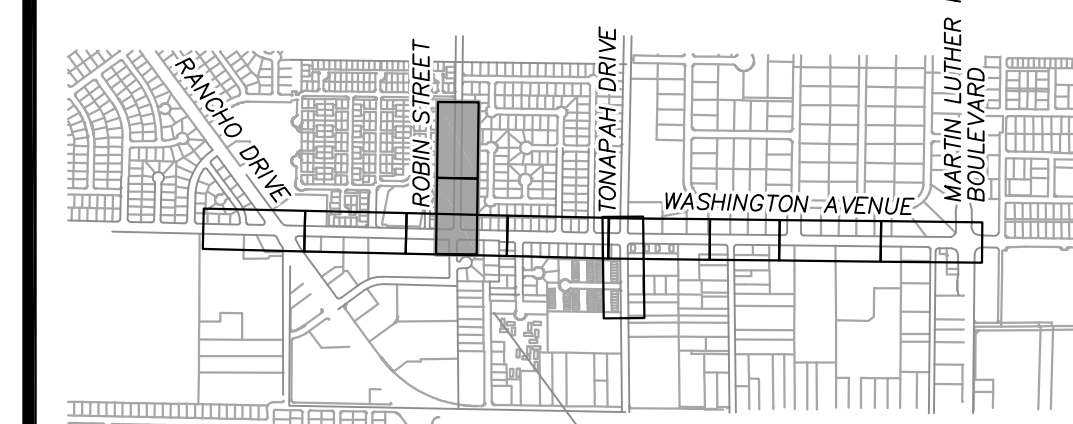

ATKINS

2270 Corporate Circle Suite
200 Henderson, Nevada
89074 Telephone:
702/263-7275
Fax: 702/263-7200

**DEPARTMENT OF PUBLIC WORKS
ENGINEERING DESIGN SECTION**

CITY ENGINEER: DAVID BOWERS, P.E., P.T.O.E.
CITY PROGRAM MANAGER: MARK SORESENSEN, P.E.
PROJECT MANAGER: MATT BAIRD, P.E.
DESIGN BY: SMB
CHECK BY: SCR
DRAWN BY: TKS
DATE: JUNE 2013

**TITLE:
FREEWAY CHANNEL - WASHINGTON
MLK BOULEVARD TO RANCHO DRIVE
(WASHINGTON AVE. STORM DRAIN)**

**SHEET:
STRIPING AND MARKING PLAN
ROBIN STREET
STA 8+50.00 TO STA 20+50.00**

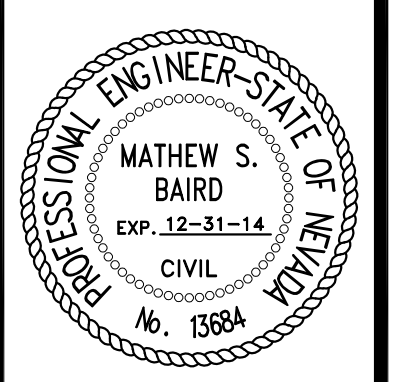

SHEET:
S5
#9 of 63
DRAWING#
731-90

NOT FOR CONSTRUCTION 70% SUBMITTAL