

WASHINGTON AVENUE

REFER TO DRAWING C2

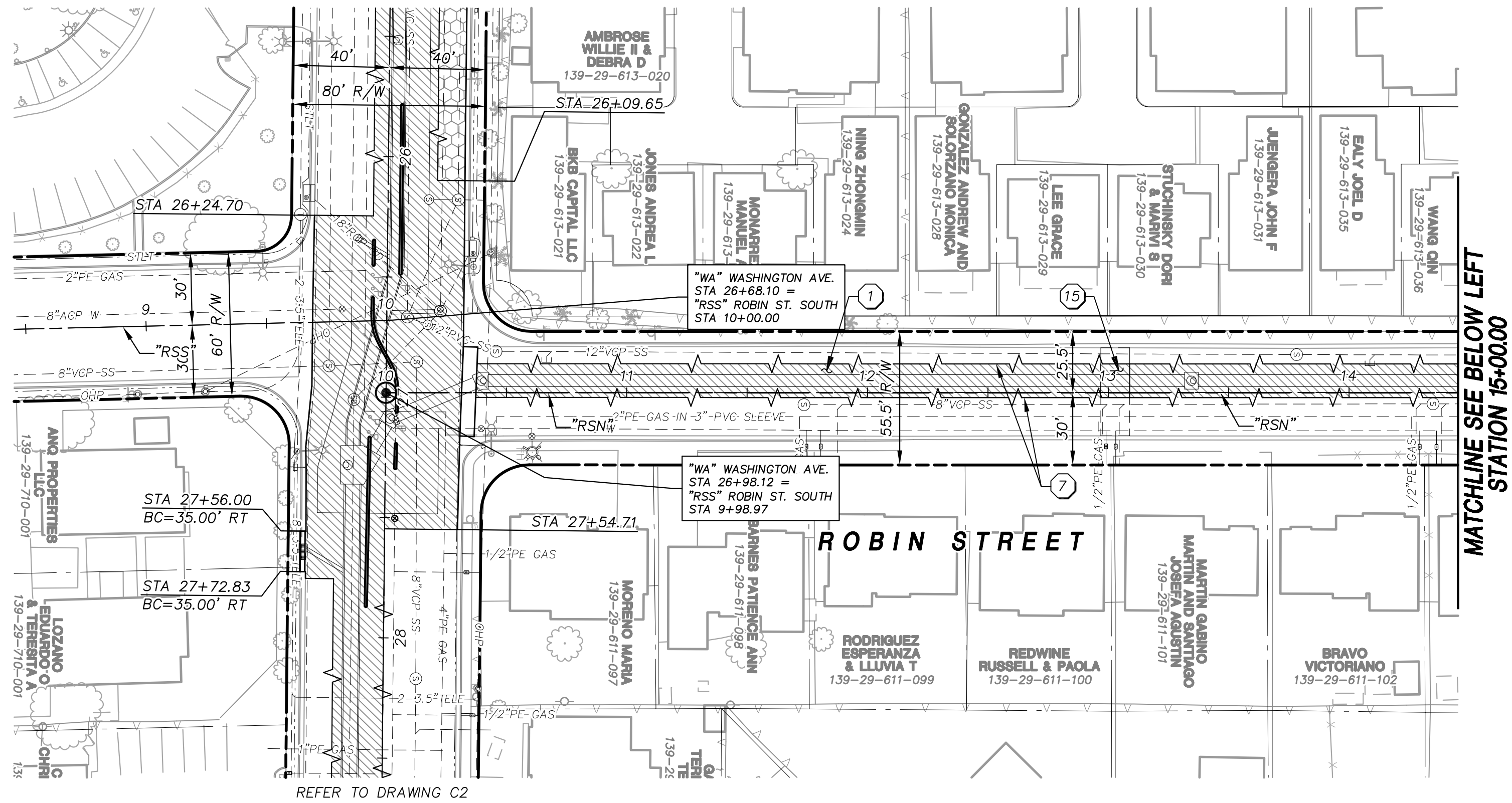

REFER TO DRAWING C2



ROADWAY CONSTRUCTION NOTES

- 1 CONSTRUCT PLANTMIX BITUMINOUS SURFACE WITH TYPE II AGGREGATE BASE (SEE DRAWING C8).
- 2 CONSTRUCT 1" OPEN GRADE SURFACE.
- 3 CONSTRUCT 1" UTACS SURFACE.
- 4 CONSTRUCT 2" PLANTMIX BITUMINOUS OVERLAY.
- 5 CONSTRUCT "L" TYPE CURB AND GUTTER PER USD #216.
- 6 CONSTRUCT CONCRETE SIDEWALK PER USD #234.
- 7 SAWCUT AND MATCH EXISTING (SEE GENERAL NOTE 13, DRAWING G01).
- 8 CONSTRUCT CONCRETE CROSS GUTTER PER USD #228 (6' WIDTH TO MATCH EXISTING) AND CONNECT TO EXISTING SPANDREL PER DETAIL 5, DRAWING C8.
- 9 CONSTRUCT TACK-ON MEDIAN PER USD #220.151, SEE DRAWING C7.
- 10 CONSTRUCT CONCRETE SIDEWALK RAMP PER USD #235 (CASE 1).
- 11 ADJUST EXISTING MANHOLE COVER TO FINISH GRADE PER USD #408.
- 12 ADJUST EXISTING WATER VALVE BOX COVER TO FINISH GRADE PER UDACS PLATE No. 39. (VALVE SHALL BE ACCESSIBLE AT ALL TIMES).
- 13 REMOVE AND REPLACE No. 3 1/2 PULLBOX PER USD #705 AND #327.
- 14 CONSTRUCT SIDEWALK DRAIN PER DETAIL 1, DRAWING C9.
- 15 CONSTRUCT AC SPEED BUMP TO MATCH EXISTING SPEED BUMP.
- 16 INSTALL 6' X 6' PREFORMED LOOP DETECTORS. SEE DETAIL 2, DRAWING C9 FOR INSTALLATION DETAILS.
- 17 EXISTING SURVEY MONUMENT, CONTRACTOR'S SURVEYOR TO INVENTORY AND LOCATE ALL EXISTING SURVEY MONUMENTS WITHIN THE CONSTRUCTION AREA. ANY MONUMENTS DISTURBED OR DESTROYED SHALL BE REPLACED BY THE CONTRACTOR'S SURVEYOR.

LEGEND

- PLANTMIX BITUMINOUS PAVEMENT
- 1" OPEN GRADE SURFACE
- 2" PLANTMIX BITUMINOUS OVERLAY
- REFER TO DRAWING HC1 FOR FOUND POINTS

APPROVED FOR CONSTRUCTION

Las Vegas Valley Water District Engineering Services Manager
Date _____ Project No. XXXXXX ESN 018

Call before you Dig
AVOID CUTTING UNDERGROUND UTILITY LINES UNNECESSARILY

811
Call
1-800-227-2600

FAST
Call before you UnderGround
1-702-432-5300
PREMIER UNDERGROUND UTILITY SERVICE

AVOID HITTING OVERHEAD POWER LINES UNNECESSARILY

CALL BEFORE YOU DO OVERHEAD
1-702-227-2929

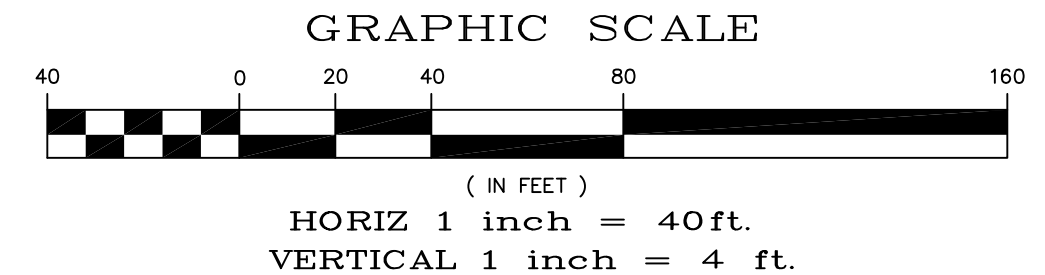

UTILITY NOTE:
ALL EXISTING UTILITY LOCATIONS SHOWN HEREON ARE APPROXIMATE ONLY. IT SHALL BE THE CONTRACTOR'S RESPONSIBILITY TO DETERMINE THE EXACT VERTICAL AND HORIZONTAL LOCATION OF ALL EXISTING UNDERGROUND UTILITIES PRIOR TO COMMENCING CONSTRUCTION.

NO REPRESENTATION IS MADE THAT ALL UTILITIES ARE SHOWN HEREON. THE ENGINEER ASSUMES NO RESPONSIBILITY FOR UTILITIES NOT SHOWN IN THEIR PROPER LOCATIONS.

THE DEPTH BELOW GRADE OF THE VARIOUS UTILITIES DEPICTED ON THE PLANS VARIES THROUGHOUT THE PROJECT AREA. THE CONTRACTOR SHALL EXERCISE EXTREME CARE WHEN EXCAVATING AND GRADING THE SUBBASE IN THE VICINITY TO AVOID DAMAGE TO THE LATTER.

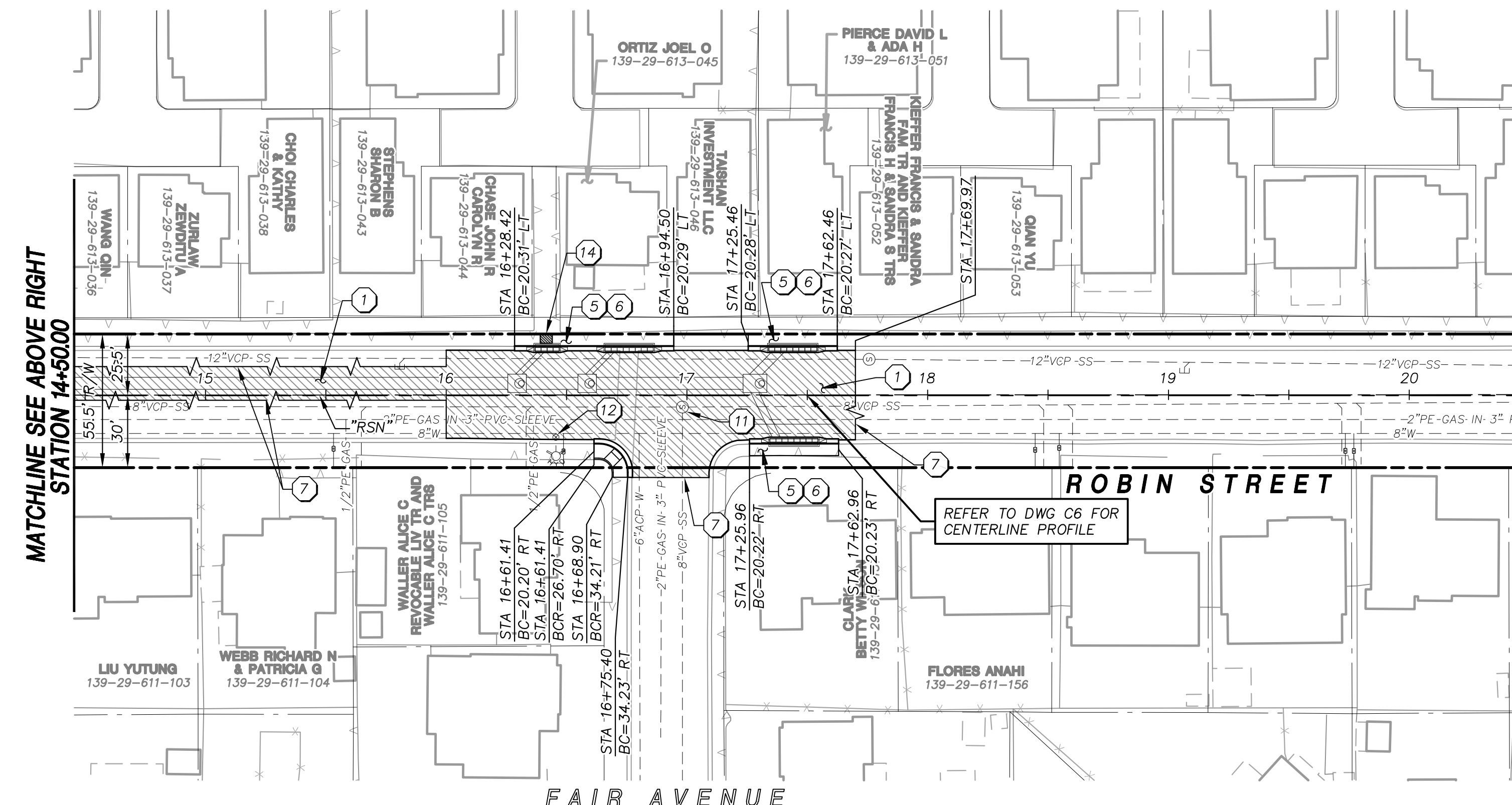

MATCHLINE SEE ABOVE RIGHT
STATION 14+50.00

REFER TO DWG C6 FOR CENTERLINE PROFILE



SHEET INDEX

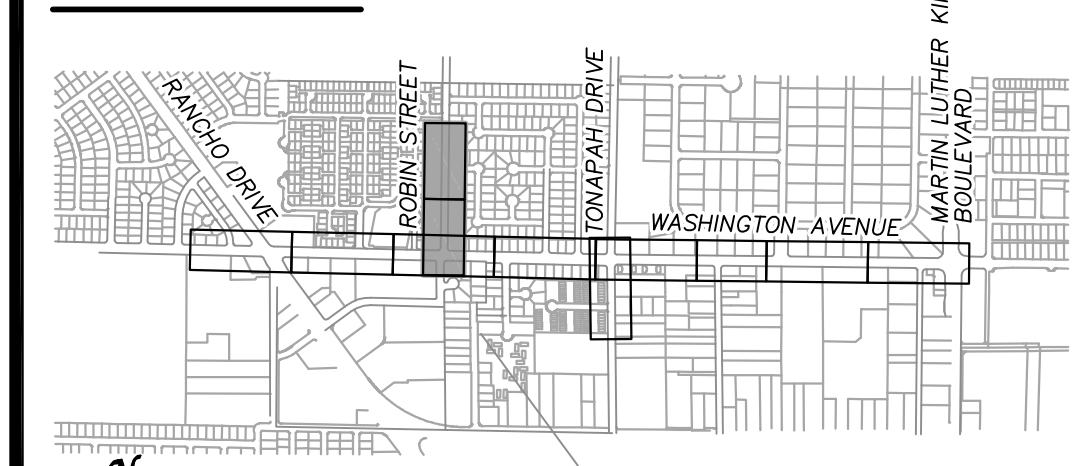

2270 Corporate Circle Suite
200 Henderson, Nevada
89074 Telephone:
702/263-7275
Fax: 702/263-7200

ATKINS

DEPARTMENT OF PUBLIC WORKS
ENGINEERING DESIGN SECTION

CITY ENGINEER: DAVID BOWERS, P.E., P.T.O.E.
CITY PROGRAM MANAGER: MARK SORENSEN, P.E.

PROJECT MANAGER: MATT BAIRD, P.E.
DESIGN BY: SMB
DRAWN BY: TKS

DATE: JUNE 2013

TITLE: FREEWAY CHANNEL - WASHINGTON
MLK BOULEVARD TO RANCHO DRIVE
(WASHINGTON AVE. STORM DRAIN)

SHEET: ROADWAY RE-CONSTRUCTION PLAN
ROBIN STREET
STA 8+50.00 TO STA 20+50.00

PROFESSIONAL ENGINEER-STATE OF NEVADA

MATHEW S. BAIRD
EXP. 12-31-14
CIVIL
No. 13684

SHEET: C5
of 63
DRAWING# 731-90

X:\Projects\100022151_WashAve_Sheets\22151-4-C5 *6-05-13 02:29pm