

DEMOLITION NOTES

- A EXISTING PAVEMENT SECTION TO BE REMOVED
- B EXISTING PAVEMENT TO BE MILLED 1"
- C EXISTING PAVEMENT TO BE MILLED 2"
- D EXISTING CURB AND GUTTER TO BE REMOVED
- E EXISTING CONCRETE SIDEWALK TO BE REMOVED
- F EXISTING MEDIAN ISLAND TO BE REMOVED
- G EXISTING CROSS GUTTER TO BE REMOVED
- H EXISTING WATERLINE TO BE REMOVED
- I EXISTING SANITARY SEWER TO BE REMOVED
- J EXISTING SANITARY SEWER MANHOLE TO BE REMOVED
- K EXISTING STORM DRAIN TO BE REMOVED
- L EXISTING STORM DRAIN MANHOLE TO BE REMOVED
- M EXISTING DROP INLET TO BE REMOVED
- N EXISTING STORM DRAIN/SANITARY SEWER TO BE ABANDONED-IN-PLACE.

NOTES

1. THE ACTUAL LOCATION OF SAWCUT LINES AND LIMITS OF MILLING SHALL BE DETERMINED IN THE FIELD BY THE RESIDENT PROJECT REPRESENTATIVE.
2. REFER TO C1 THRU C6 FOR ADDITIONAL INFORMATION FOR REMOVAL LIMITS.
3. FOR SIGNING AND STRIPING REMOVAL REFER TO DRAWINGS S1 THRU S6.
4. REFER TO DRAWINGS S51 THRU W3 FOR ADDITIONAL WATERLINE AND SEWERLINE REMOVAL LIMITS.

LEGEND

- EXISTING PAVEMENT SECTION TO BE REMOVED
- EXISTING PAVEMENT TO BE COLD MILLED 1"
- EXISTING PAVEMENT TO BE COLD MILLED 2"
- EXISTING CURB AND GUTTER TO BE REMOVED
- EXISTING MEDIAN ISLAND, SIDEWALK AND CROSS GUTTER TO BE REMOVED
- EXISTING UTILITY TO BE REMOVED
- EXISTING UTILITY TO BE ABANDONED

APPROVED FOR CONSTRUCTION

Las Vegas Valley Water District Engineering Services Manager
 Date _____ Project No. XXXXXX ESN 018

Call before you Dig
AVOID HITTING OVERHEAD POWER LINES. IT'S COBBLY.

 1-800-227-2600

FAST
Call before you UnderGround
 1-702-432-5300
FREQUENT AND ARTERIAL

AVOID HITTING OVERHEAD POWER LINES. IT'S COBBLY.
CALL BEFORE YOU DO OVERHEAD

 1-702-227-2929

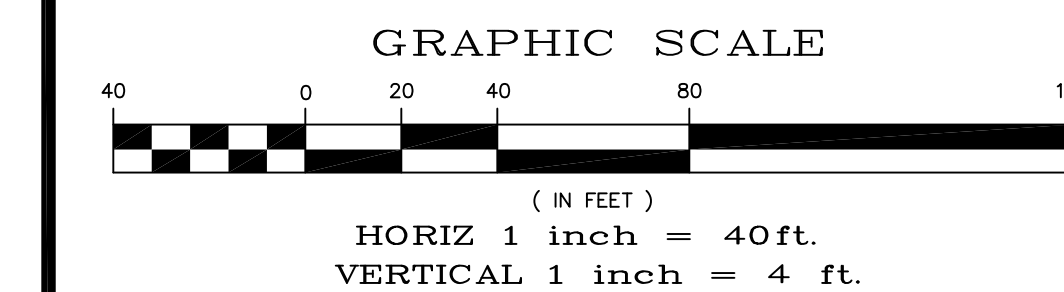

UTILITY NOTE:
 ALL EXISTING UTILITY LOCATIONS SHOWN HEREON ARE APPROXIMATE ONLY. IT SHALL BE THE CONTRACTORS RESPONSIBILITY TO DETERMINE THE EXACT VERTICAL AND HORIZONTAL LOCATION OF ALL EXISTING UNDERGROUND UTILITIES PRIOR TO COMMENCING CONSTRUCTION.
 NO REPRESENTATION IS MADE THAT ALL UTILITIES ARE SHOWN HEREON. THE ENGINEER ASSUMES NO RESPONSIBILITY FOR UTILITIES NOT SHOWN IN THEIR PROPER LOCATIONS.
 THE DEPTH BELOW GRADE OF THE VARIOUS UTILITIES DEPICTED ON THE PLANS VARIES THROUGHOUT THE PROJECT AREA. THE CONTRACTOR SHALL EXERCISE EXTREME CARE WHEN EXCAVATING AND GRADING THE SUBBASE IN THE VICINITY TO AVOID DAMAGE TO THE LATTER.

SHEET INDEX

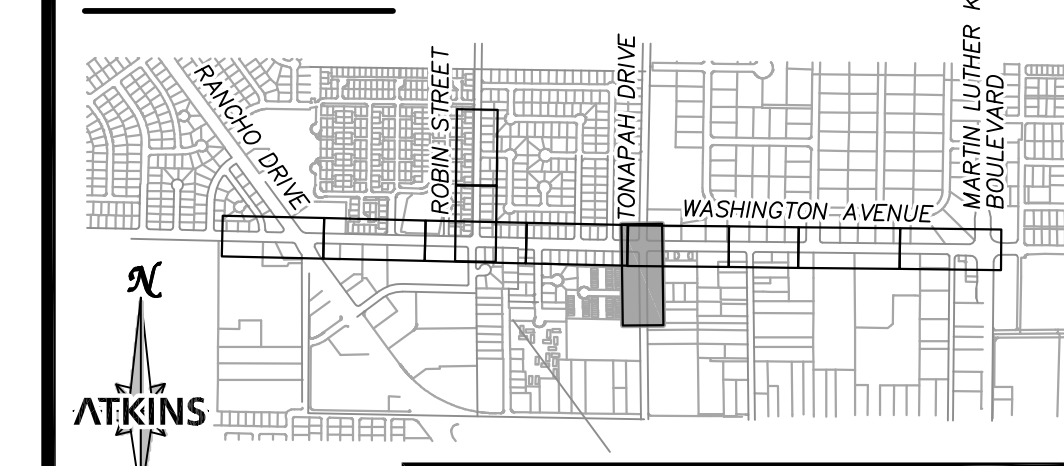

ATKINS 2270 Corporate Circle Suite
 200 Henderson, Nevada
 89074 Telephone: 702/263-7275
 Fax: 702/263-7200

DEPARTMENT OF PUBLIC WORKS
ENGINEERING DESIGN SECTION
 CITY ENGINEER: DAVID BOWERS, P.E., P.T.O.E.
 CITY PROGRAM MANAGER: MARK SORESENSEN, P.E.
 PROJECT MANAGER: MATT BAIRD, P.E.
 DESIGN BY: SMB
 CHECK BY: SCR
 DRAWN BY: DUE
 DATE: JUNE 2013

FREEWAY CHANNEL - WASHINGTON
MLK BOULEVARD TO RANCHO DRIVE
(WASHINGTON AVE. STORM DRAIN)
DEMOLITION PLAN
TONOPAH DRIVE
STA 8+50.00 TO STA 16+75.00

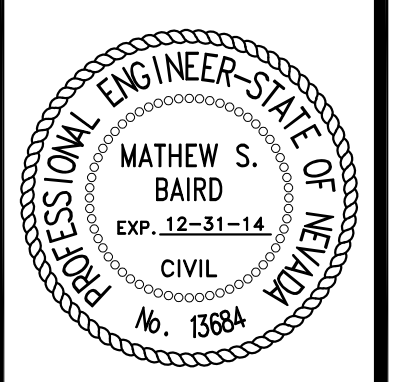

SHEET: **D6**
 13 of 63
 DRAWING# 731-90

NOT FOR CONSTRUCTION 70% SUBMITTAL

X:\Projects\100022151_WashAve_Sheets\22151-2-D6 *6-05-13 01:49pm