

AVOID HITTING OVERHEAD POWER LINES. IT'S COSTLY. CALL BEFORE YOU DIG OVERHEAD. 1-702-227-2929

AVOID HITTING UNDERGROUND TRAFFIC SIGNAL SYSTEMS AND STREET LIGHT SYSTEM CONDUITS. IT'S COSTLY. Call before you do Under Ground. 1-702-455-7511. 1-702-229-6611. 1-702-455-7544

Call before you Dig. 811. 1-800-227-2600. 1-702-455-7544

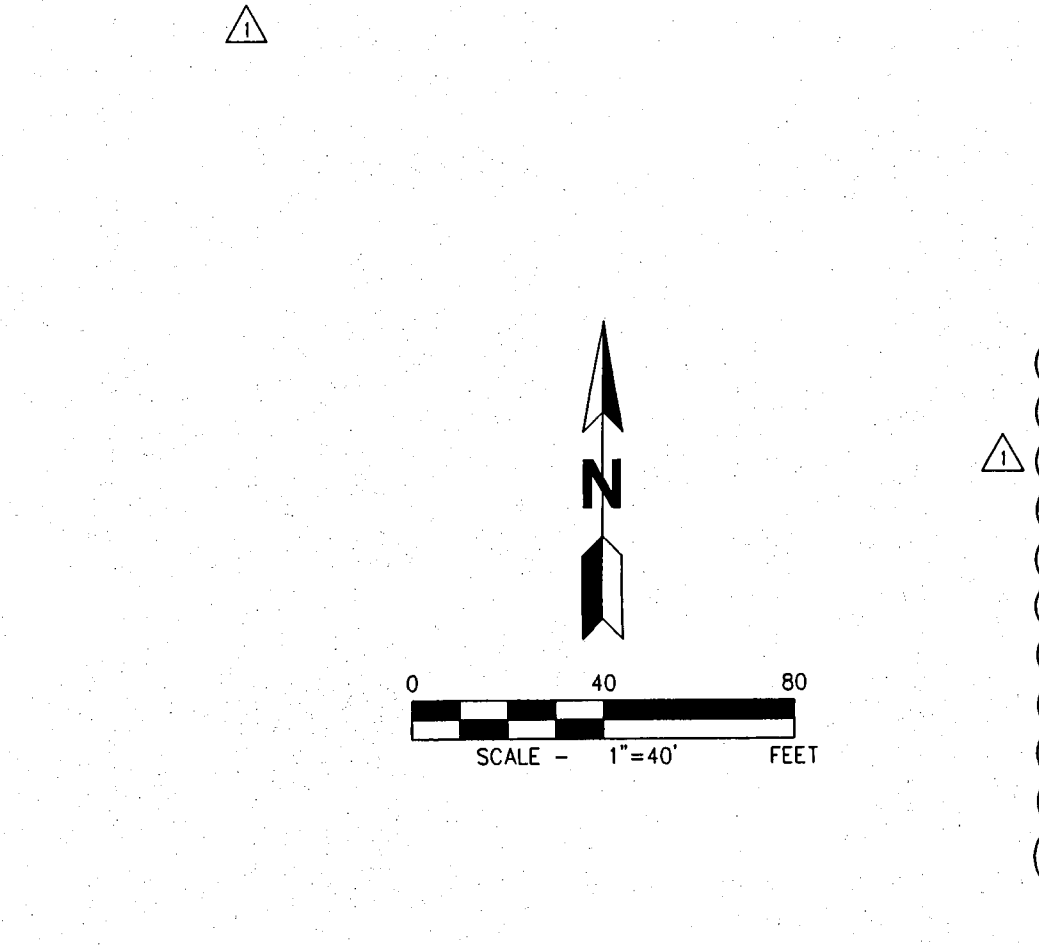
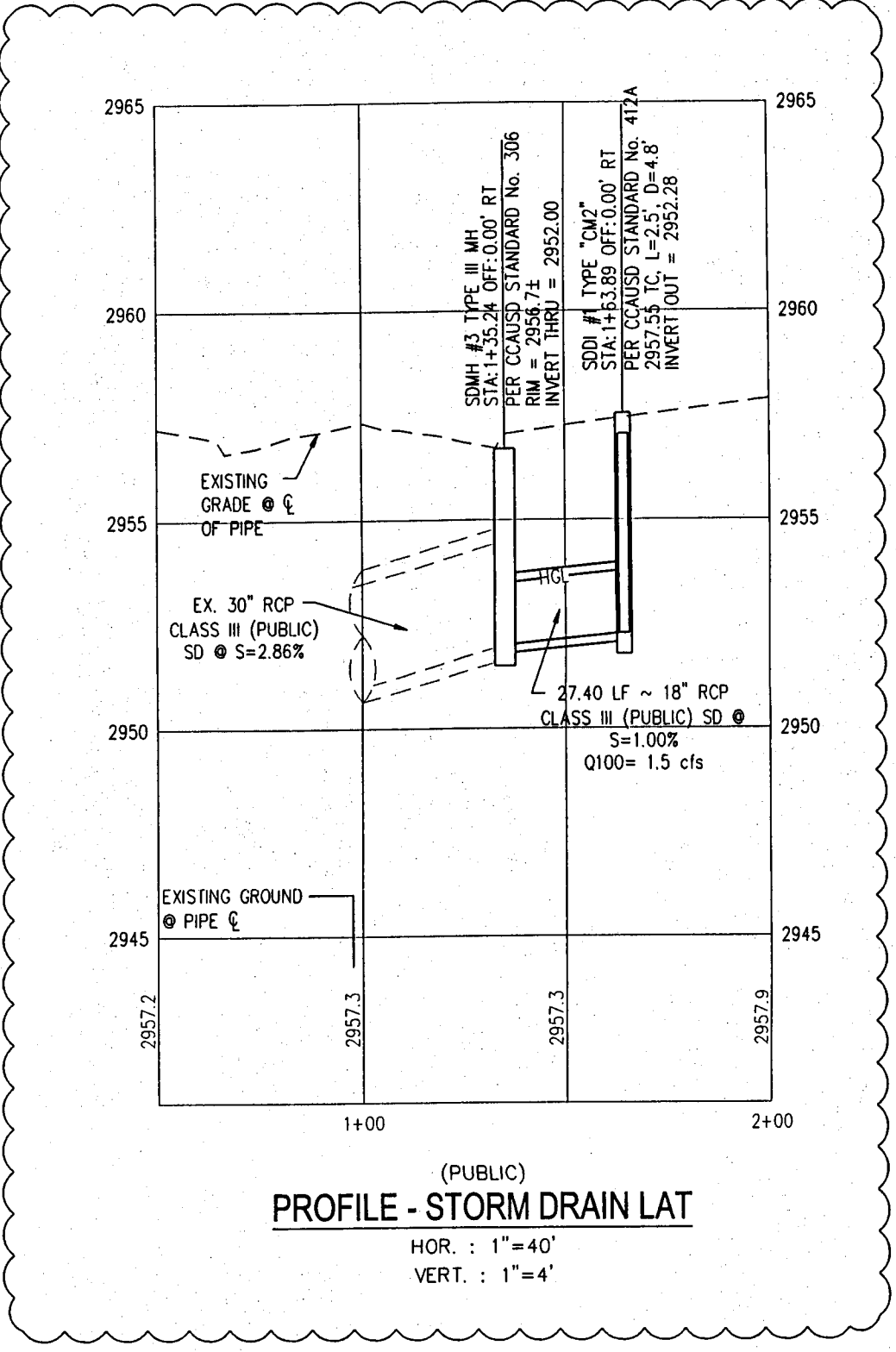
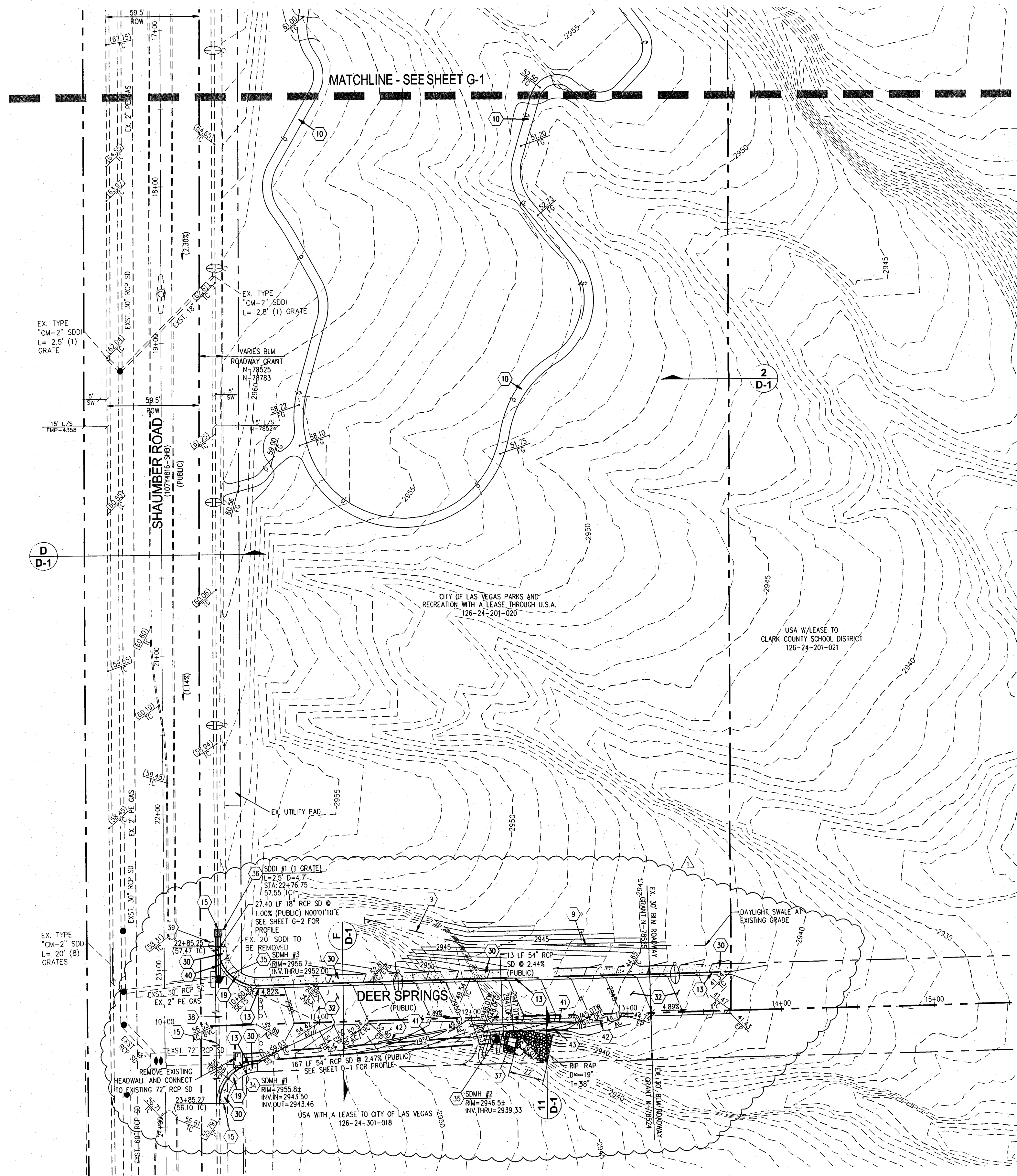

- ### CONSTRUCTION NOTES
- CONSTRUCT HANDICAPPED VEH ACCESSIBLE PARKING STALL IN ACCORDANCE WITH ADA STANDARDS.
 - CONSTRUCT 4" THICK CONCRETE SIDEWALK OVER 5" MIN TYPE II AGG. BASE. WIDTH PER PLAN. SEE LANDSCAPE PLAN FOR FINISH.
 - DOG-E-POT. SEE LANDSCAPE PLANS FOR DETAILS.
 - BASEBALL FIELD. SEE LANDSCAPE PLANS FOR CONSTRUCTION MATERIALS AND HORIZONTAL DIMENSIONS.
 - CHILD PLAY AREA. SEE LANDSCAPE PLANS FOR CONSTRUCTION MATERIALS AND HORIZONTAL DIMENSIONS.
 - DOG PARK. SEE LANDSCAPE PLANS FOR CONSTRUCTION MATERIALS AND HORIZONTAL DIMENSIONS.
 - SOCCER FIELD. SEE LANDSCAPE PLANS FOR HORIZONTAL DIMENSIONS AND STRIPING DETAILS.
 - CONSTRUCT AC PARKING AREA. SEE SOILS REPORT FOR SECTION.
 - CONSTRUCT SWALE AT A MINIMUM 1% SLOPE.
 - CONSTRUCT AGGREGATE WALK PATH AT EXISTING GRADE UNLESS SHOWN OTHERWISE. WIDTH PER PLAN. SEE LANDSCAPE PLAN FOR MATERIAL.
 - CONSTRUCT 90 LF OF 18" RCP SD @ 2.67%.
 - CONSTRUCT "A" TYPE CURB PER DETAIL 4, SHEET D-1
 - CONSTRUCT "L" TYPE CURB PER CCAUSD DWG No. 216
 - TURF EDGE LINE
 - SAW/CUT EXISTING IMPROVEMENTS AND MATCH ELEVATIONS WITH PROPOSED IMPROVEMENTS. EXISTING IMPROVEMENTS SHALL BE RECONSTRUCTED IN PLACE WITH LIKE KIND MATERIALS.
 - CONSTRUCT SIDEWALK UNDER DRAIN PER CCAUSD DWG No. 236
 - CONSTRUCT 6" HANDICAP RAMP IN CONFORMANCE WITH A.D.A. STANDARDS
 - CONSTRUCT 8" WIDE VALLEY GUTTER PER CCAUSD DWG No. 225
 - CONSTRUCT SIDEWALK RAMP USING ARMOR TILE TRUNCATED DOMES PER CCAUSD DWG No. 235 CASE I. A's AND B's = 8" UNLESS OTHERWISE NOTED
 - CONSTRUCT 10" LIP GUTTER AT RAMP PER CCAUSD DWG# 219
 - INSTALL BUMPER BLOCKS PER CCAUSD SWG No. 238
 - CONSTRUCT SIDEWALK RAMP USING ARMOR TILE TRUNCATED DOMES PER CCAUSD DWG No. 235 CASE II. A's AND B's = 8" UNLESS OTHERWISE NOTED
 - TRANSITION TO 0" CURB EXPOSURE
 - INSTALL WROUGHT IRON RAILING. SEE LANDSCAPE PLANS FOR CONSTRUCTION DETAILS.
 - CONSTRUCT 3' X 3' - 4" THICK CONCRETE TRASH RECEPTACLE PAD OVER 5" MIN TYPE II AGGREGATE BASE.
 - CONSTRUCT 2" DIAMETER CONCRETE DRINKING FOUNTAIN BASE PER DETAIL 9, SHEET D-1.
 - CONSTRUCT 6' X 2' - 4" THICK CONCRETE PARK BENCH PAD OVER 5" MIN TYPE II AGGREGATE BASE.
 - CONSTRUCT 3' X 3' - 4" THICK CONCRETE TRASH RECEPTACLE PAD OVER 5" MIN TYPE II AGGREGATE BASE.
 - CONSTRUCT 2" DIAMETER CONCRETE DRINKING FOUNTAIN BASE PER DETAIL 9, SHEET D-1.
 - SAW/CUT AND REMOVE EXISTING "L" TYPE CURB RETURN
 - CONSTRUCT 5' WIDE 4" THICK CONCRETE SIDEWALK OVER 5" MIN TYPE II AGG. BASE PER CCAUSD DWG No. 234
 - CONSTRUCT 1" TRANSITION FOR "A" TYPE CURB TO 0" EXPOSURE
 - CONSTRUCT AC PAVEMENT OVER TYPE II AGGREGATE BASE. SEE SOILS REPORT FOR SECTION.
 - TRENCH AND BACKFILL FOR UTILITY INSTALLATION PER CCAUSD DWG No. 244B
 - CONSTRUCT 60" TYPE III STORM DRAIN MANHOLE PER STANDARD DWG No. R-4.3.2
 - CONSTRUCT 60" TYPE III STORM DRAIN MANHOLE PER STANDARD DWG No. 408
 - CONSTRUCT 2.5" TYPE "CM2" DROP INLET PER CCAUSD DWG No. 412A
 - INSTALL NDOT RCP END SECTION PER NDOT STANDARD DWG No. R-2.3.1
 - CONTRACTOR TO REMOVE EXISTING CURB, GUTTER, AND SIDEWALK
 - CONTRACTOR TO REMOVE EXISTING STREETLIGHT AND BASE DURING CONSTRUCTION AND REPLACE IN THE SAME LOCATION ON A NEW BASE
 - CONTRACTOR TO COORDINATE WITH DRY UTILITY COMPANIES TO FACILITATE STORM DRAIN INSTALLATION BENEATH EXISTING SIDEWALK
 - INSTALL TEMPORARY PORTABLE PRECAST CONCRETE BARRIER RAIL PER NDOT STANDARD DWG No. R-8.7.1 OR APPROVED EQUAL
 - INSTALL PORTABLE PRECAST CONCRETE BARRIER END TRANSITION
 - CONSTRUCT RETAINING WALL PER DETAIL 12, SHEET D-1

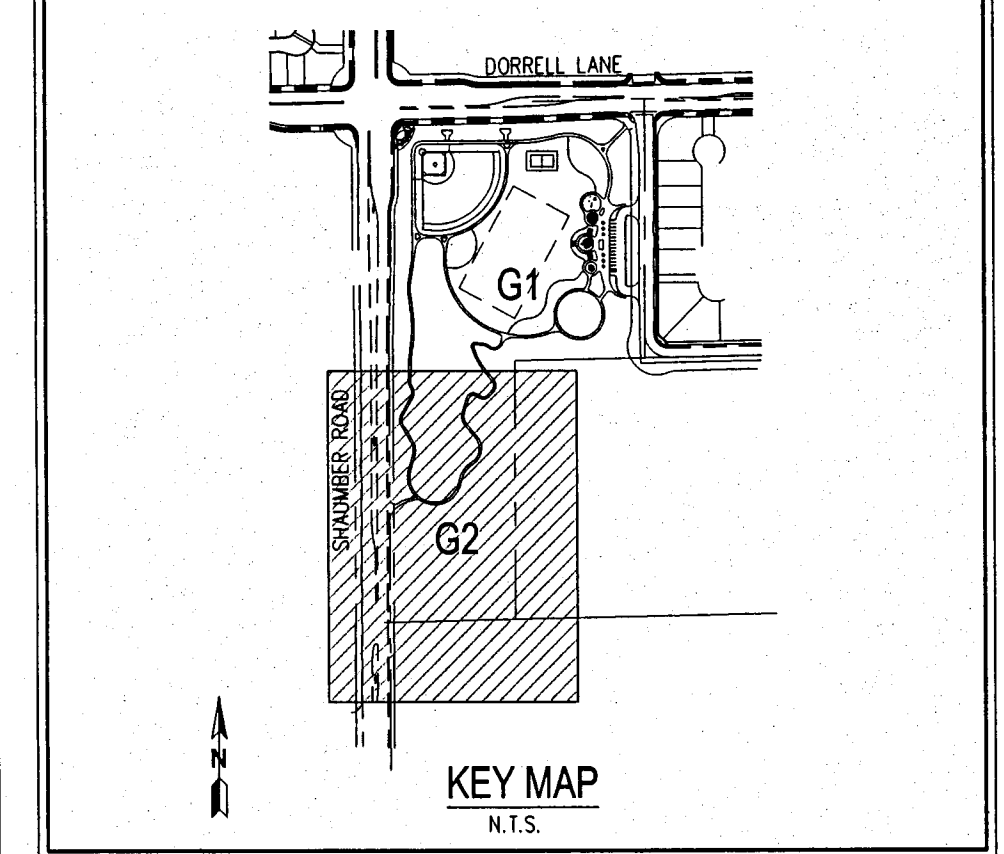

FEMA FLOOD ZONE DESIGNATION

THE PROJECT SITE IS LOCATED WITHIN A FEMA DESIGNATED ZONE X (AREA OUTSIDE THE 0.2% ANNUAL CHANCE FLOOD EVENT), PER FIRM PANEL 32003C1750E, DATED SEPTEMBER 27, 2002.

BASIS OF BEARING

NORTH 89°23'23" EAST BEING THE SOUTH LINE OF THE SOUTHEAST QUARTER (SE 1/4) OF THE NORTHEAST QUARTER (NE 1/4) OF SECTION 28, TOWNSHIP 22 SOUTH, RANGE 60 EAST, M.D.M., CLARK COUNTY, NEVADA, AS SHOWN ON RECORD OF SURVEY ON FILE IN BOOK 119 OF PLATS, PAGE 58 IN THE OFFICE OF THE COUNTY RECORDER OF CLARK COUNTY, NEVADA.

BENCHMARK

C.C.B.M. # BLV90 19CY RIVET & PLATE IN CONC. MONUMENT (ELECTRIC) +/- 200 FEET NW OF DEER SPRINGS AND FORT APACHE
ELEVATION = 832.7807 METERS (NAVD 88)
= 2732.22 US SURVEY FEET (CALCULATED)

DISCLAIMER NOTE

- EXISTING UTILITY LOCATIONS SHOWN HEREON ARE APPROXIMATE ONLY. IT SHALL BE THE CONTRACTOR'S RESPONSIBILITY TO DETERMINE THE EXACT VERTICAL AND HORIZONTAL LOCATION OF ALL EXISTING UNDERGROUND UTILITIES PRIOR TO COMMENCING CONSTRUCTION. NO REPRESENTATION IS MADE THAT ALL EXISTING UTILITIES ARE SHOWN HEREON. THE ENGINEER ASSUMES NO RESPONSIBILITY FOR UTILITIES NOT SHOWN IN THEIR PROPER LOCATION.
- FOR ROADWAY WIDENING AND HALF STREET IMPROVEMENTS THE CONTRACTOR SHALL VERIFY CROSS SLOPES FROM EXISTING PAVEMENT SAW/CUT LINE TO PROPOSED EDGE OF PAVEMENT OR PROJECTED LIP OF CURB PRIOR TO SUBGRADE PREPARATION AND CONSTRUCTION OF PROPOSED CURB LINE. IF MINIMUM OR MAXIMUM CROSS SLOPES DO NOT MEET AGENCY STANDARDS THE CONTRACTOR SHALL NOTIFY THE ENGINEER PRIOR TO THE PLACEMENT OF TYPE II AND CURB.

NOTES

- THE CONTRACTOR SHALL VERIFY ALL CONDITIONS OF EXISTING STRUCTURES INCLUDING LOCATION, ELEVATION, DIMENSIONS AND REPORT ALL DISCREPANCIES TO THE ENGINEER PRIOR TO CONSTRUCTION.
- ALL IMPROVEMENTS TO BE PROTECTED FROM EROSION DURING CONSTRUCTION THROUGH THE USE OF A STORM WATER POLLUTION PREVENTION PLAN (SWPPP).
- MAXIMUM/MINIMUM SLOPES AND MINIMUM STREET SECTIONS NOT TO EXCEED THAT SHOWN ON THE GEOTECH REPORT.
- SEE DETAIL SHEET D-1 FOR STREET SECTIONS AND DETAILS.
- SEE SHEET C-1 FOR LEGEND.
- ADD 2900 TO PLAN GRADES WITH THE EXCEPTION OF FINISHED FLOORS.
- CONTRACTOR TO VERIFY ALL HANDICAP ACCESSIBLE ROUTES AND PARKING STALLS ARE IN CONFORMANCE WITH A.D.A. ACCESSIBILITY GUIDELINES AND DO NOT EXCEED MAXIMUM SLOPES IN ANY DIRECTION PRIOR TO CONSTRUCTION. CONTRACTOR TO NOTIFY ENGINEER OF ANY DISCREPANCIES.
- CONSTRUCT A.D.A. ROUTE, HAND RAILS, PARKING, SIGNAGE & RAMPS TO COMPLY WITH ICC/ANSI A117.1-2003

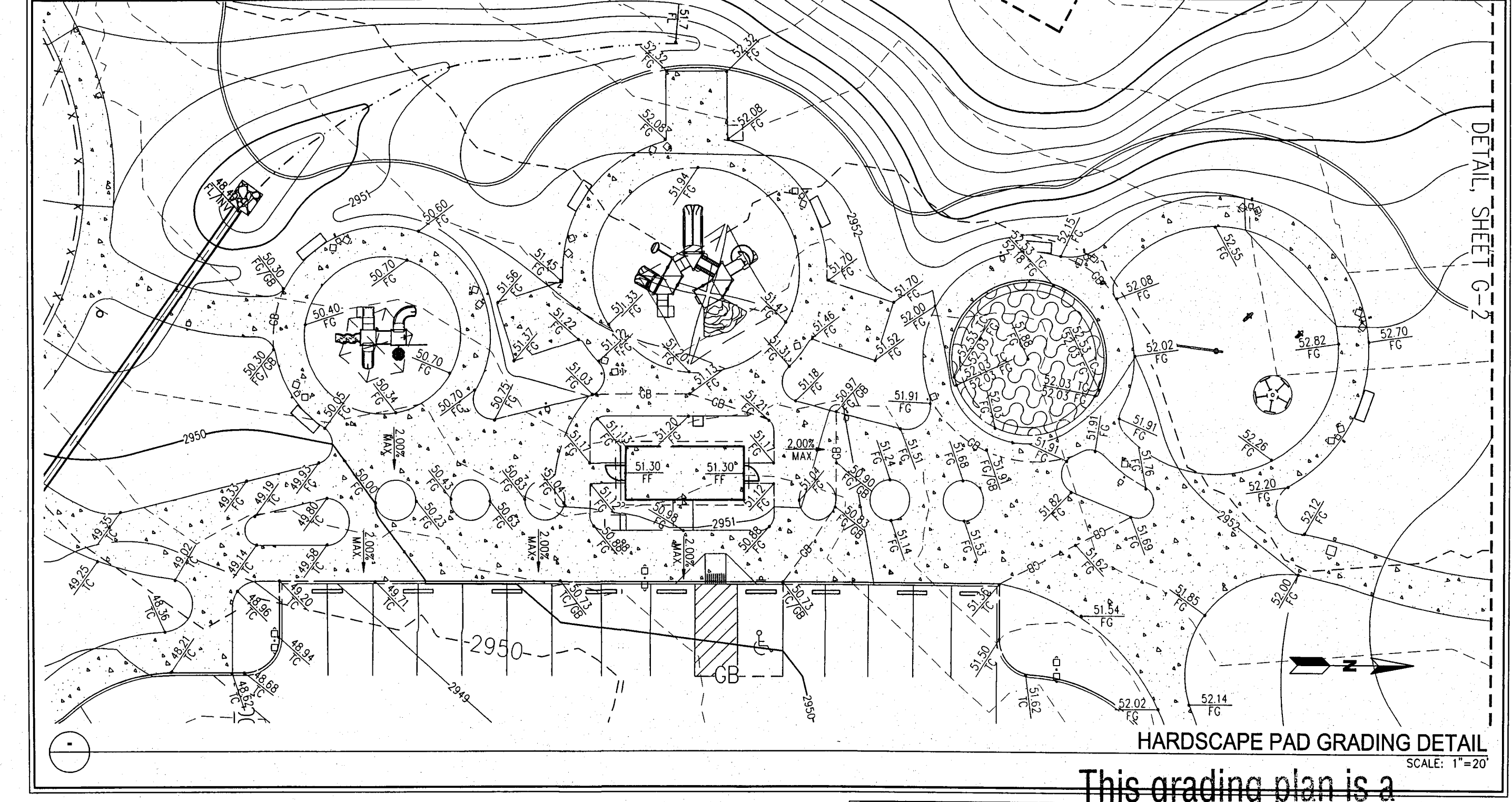

This grading plan is a part of drainage study #4425-2 which was received on 3/19/11 and approved on 3/28/11. Page 1 of 2

TRAVIS POECHMANN, P.E. 19277

SLATER HANIFAN GROUP
CONSULTING ENGINEERS & PLANNERS
5740 S. ARVILLE STREET #216, LAS VEGAS, NV 89118
PHONE (702) 284-5300 FAX (702) 284-5398

NO.	DATE	BY	APP.	DESCRIPTION

CITY OF LAS VEGAS, NV

SECTION: 24
TOWNSHIP: 19 SOUTH
RANGE: 59 EAST

DATE: 01/24/11

DRAFTER: TP

DESIGNER: PL

CHECKED: BP

PROJECT NO.
LTK1003-001

ENGINEER SEAL
TRAVIS J. POECHMANN
1/23/2011
CIVIL
No. 19277

3-10-11

G-2
SHEET 4 OF 11

PROVIDENCE MASTER HOMEOWNERS ASSOCIATION
KNICKERBOCKER PARK
GRADING PLAN II

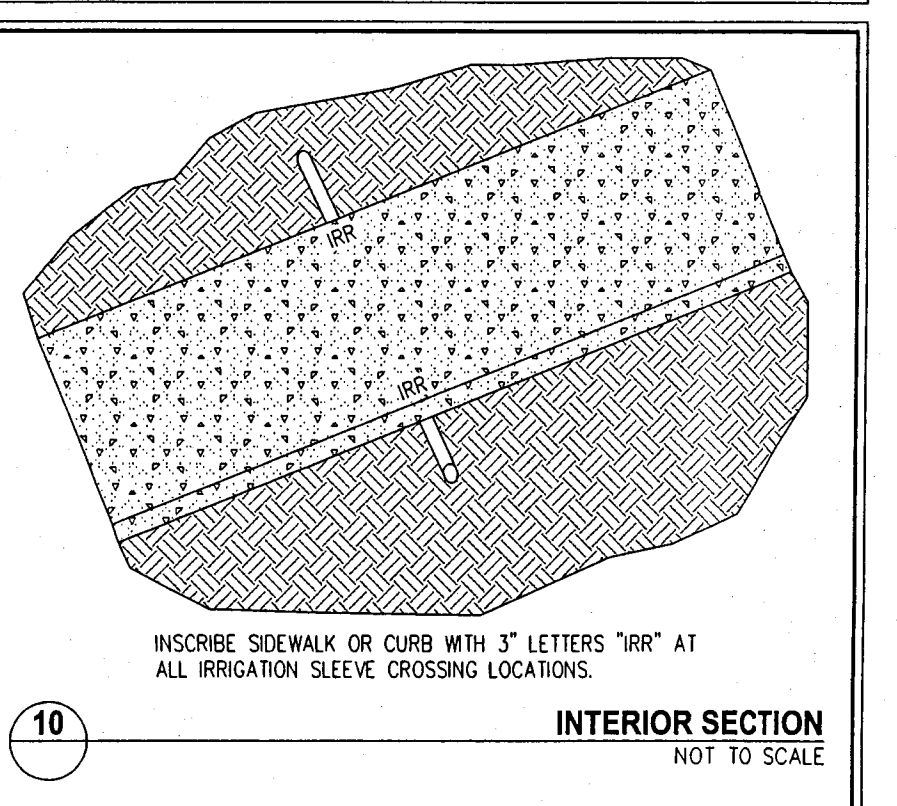
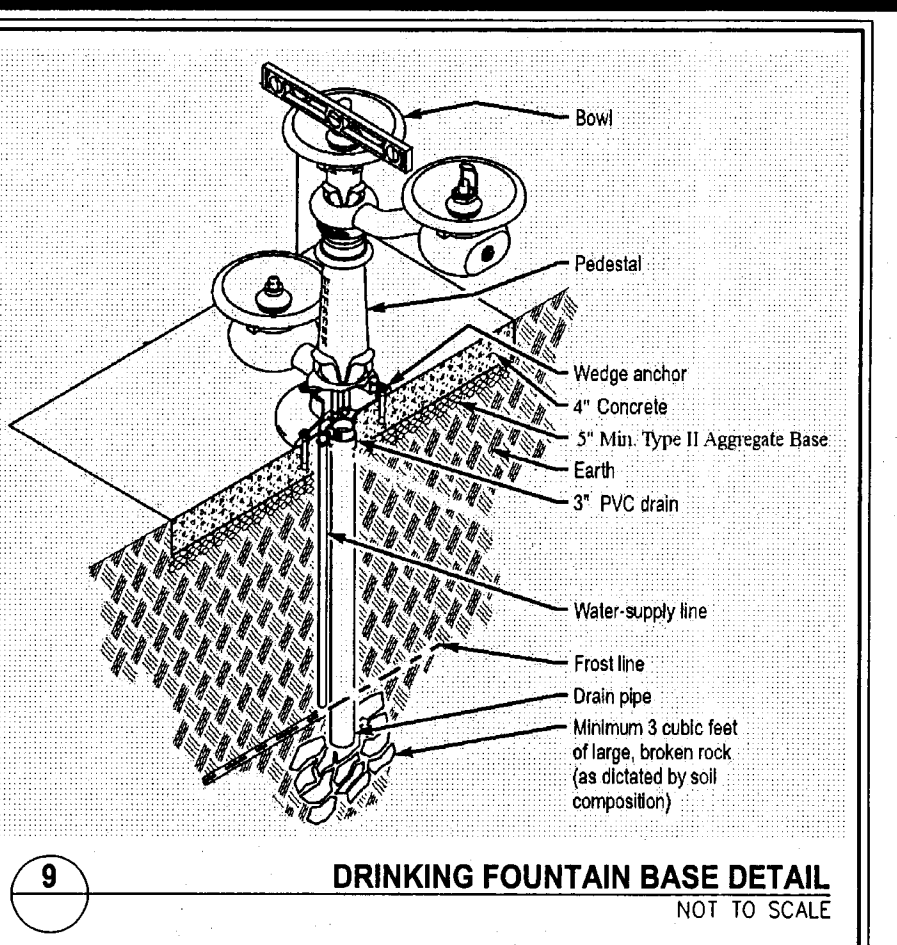
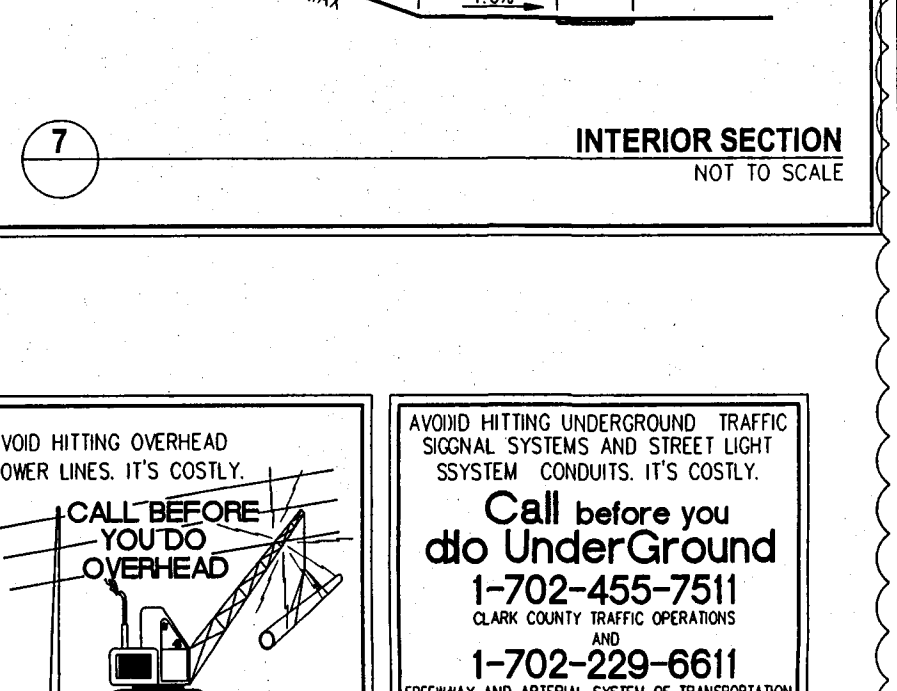
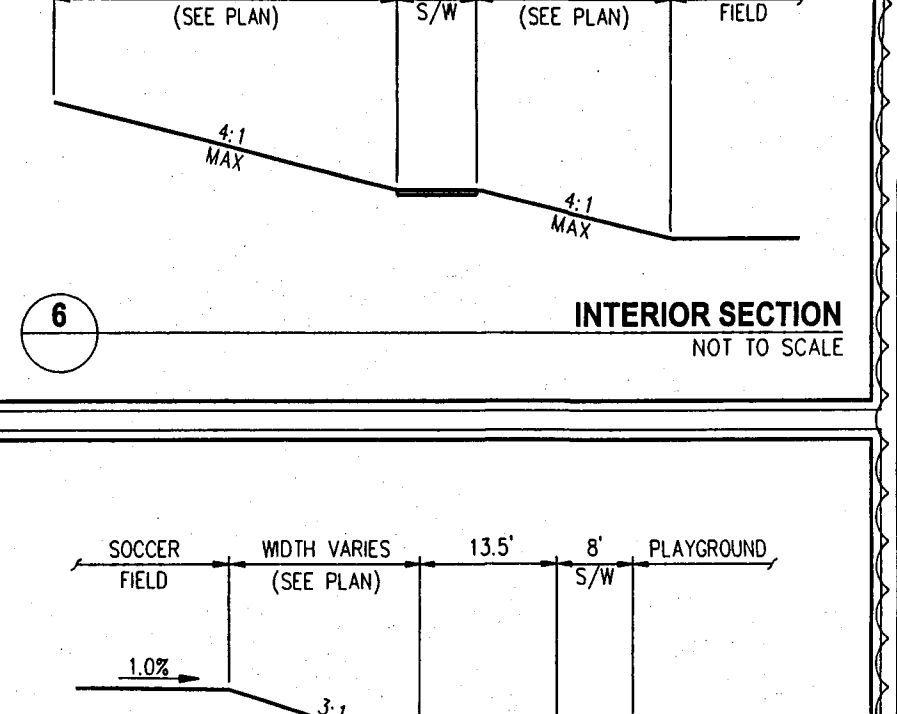
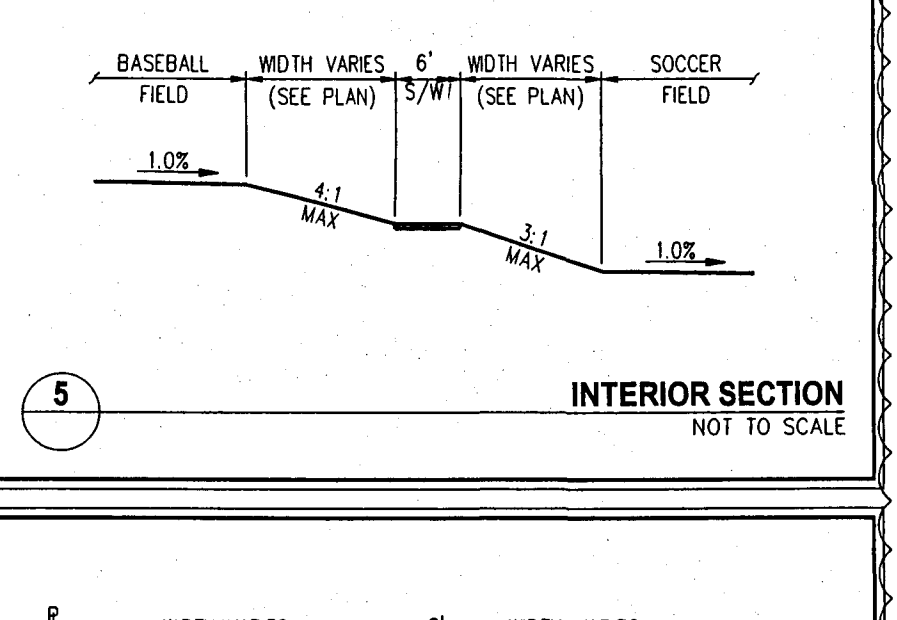
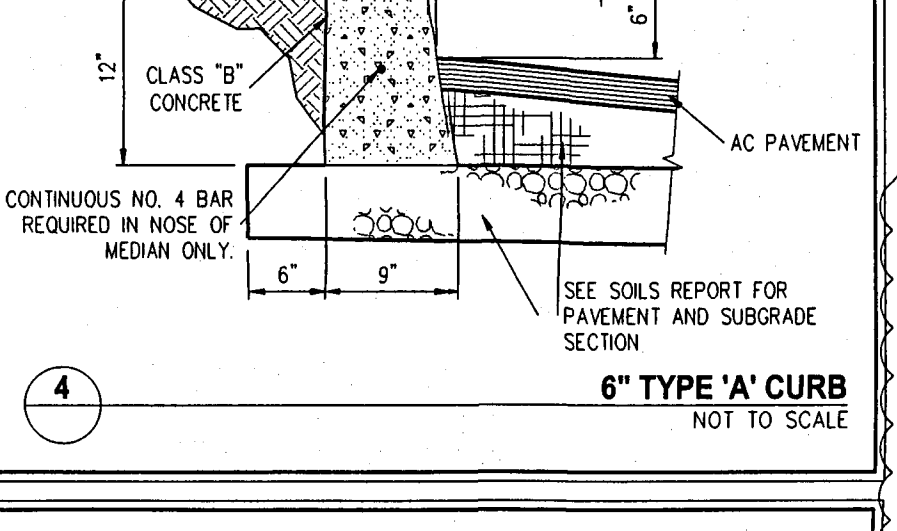
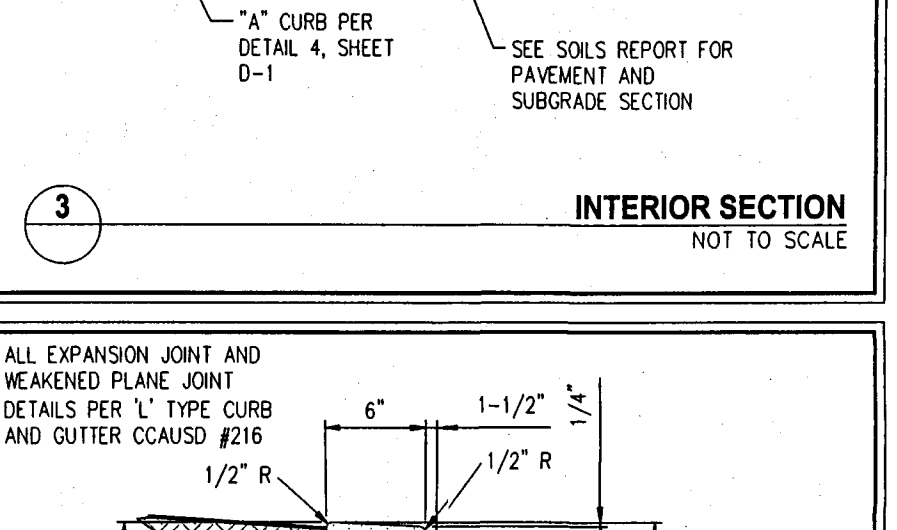
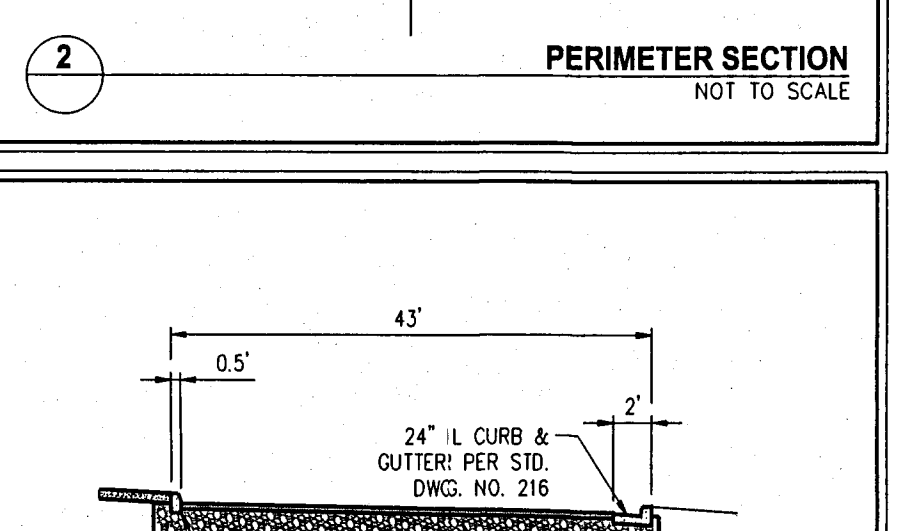
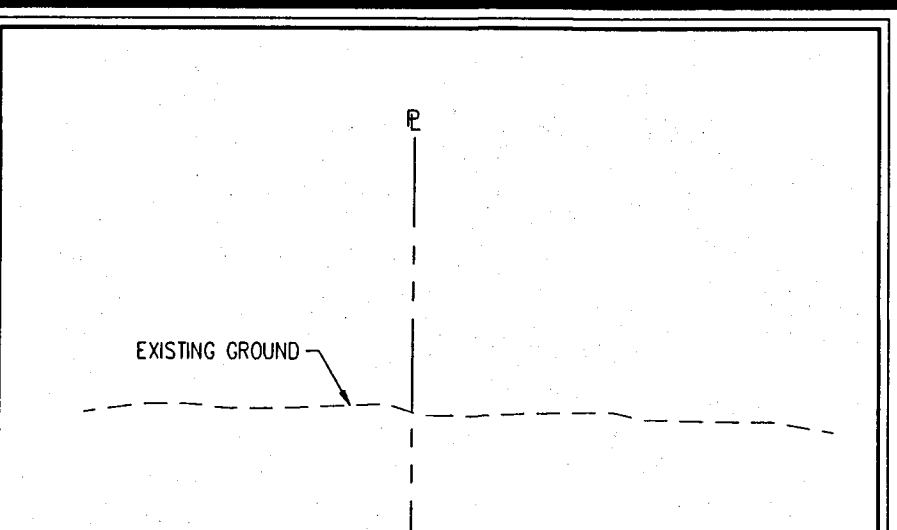
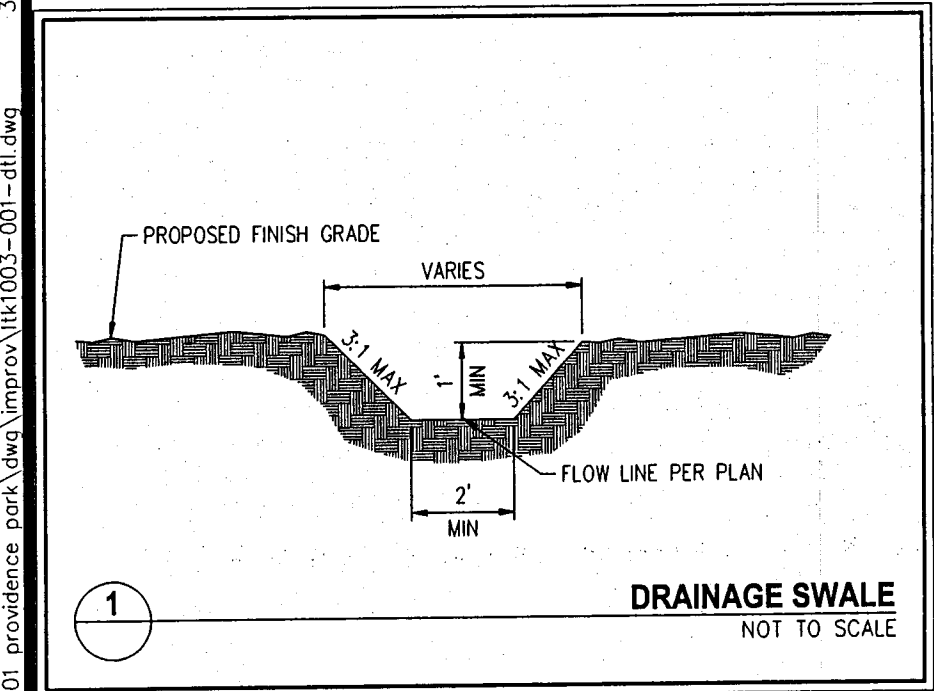
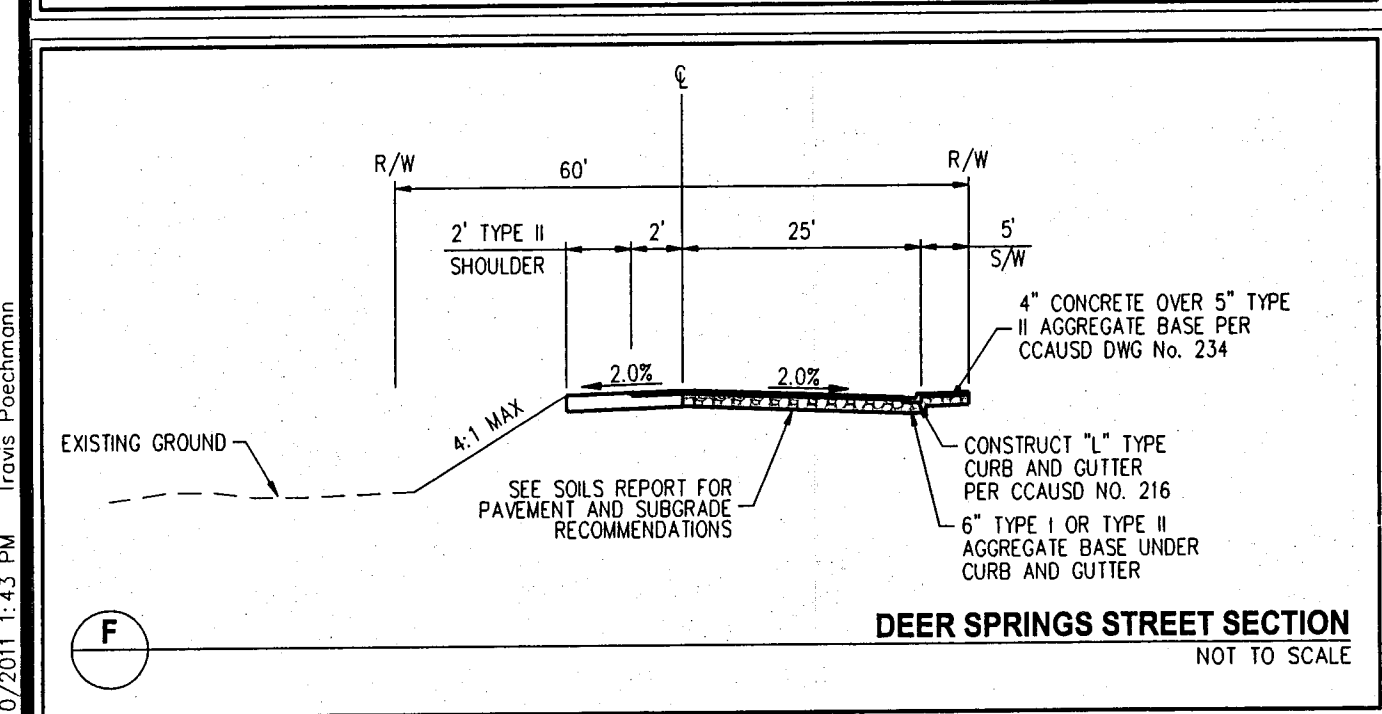
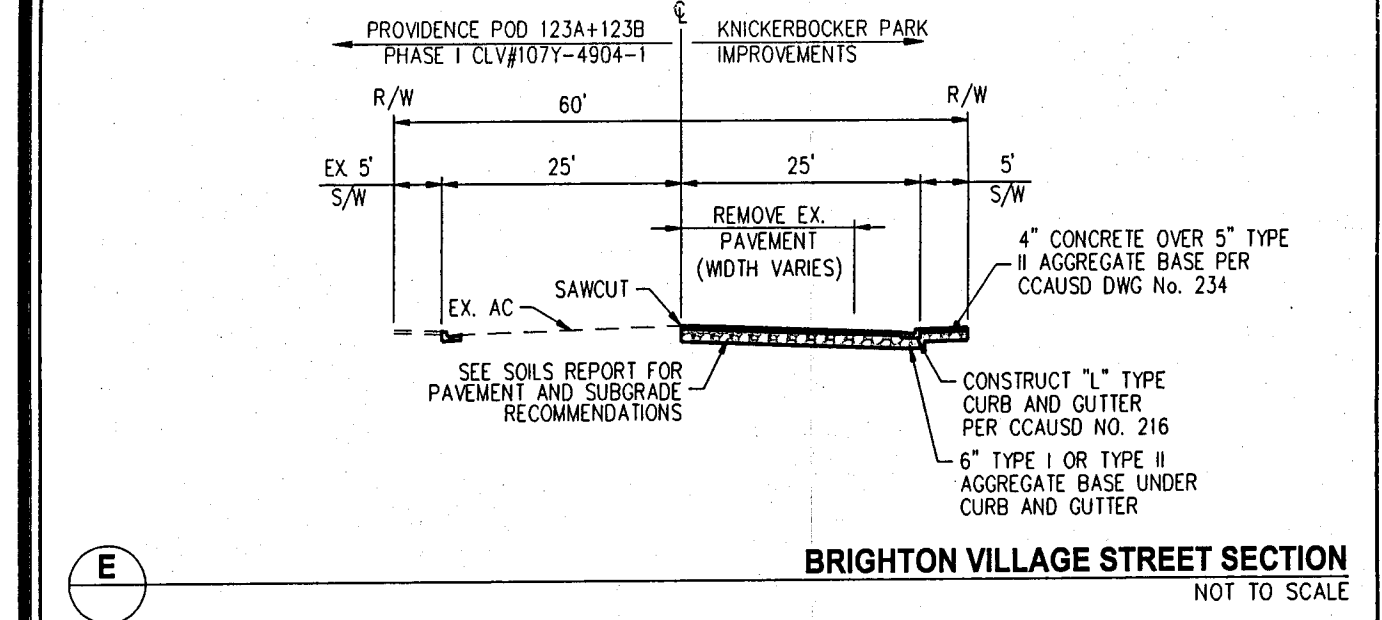
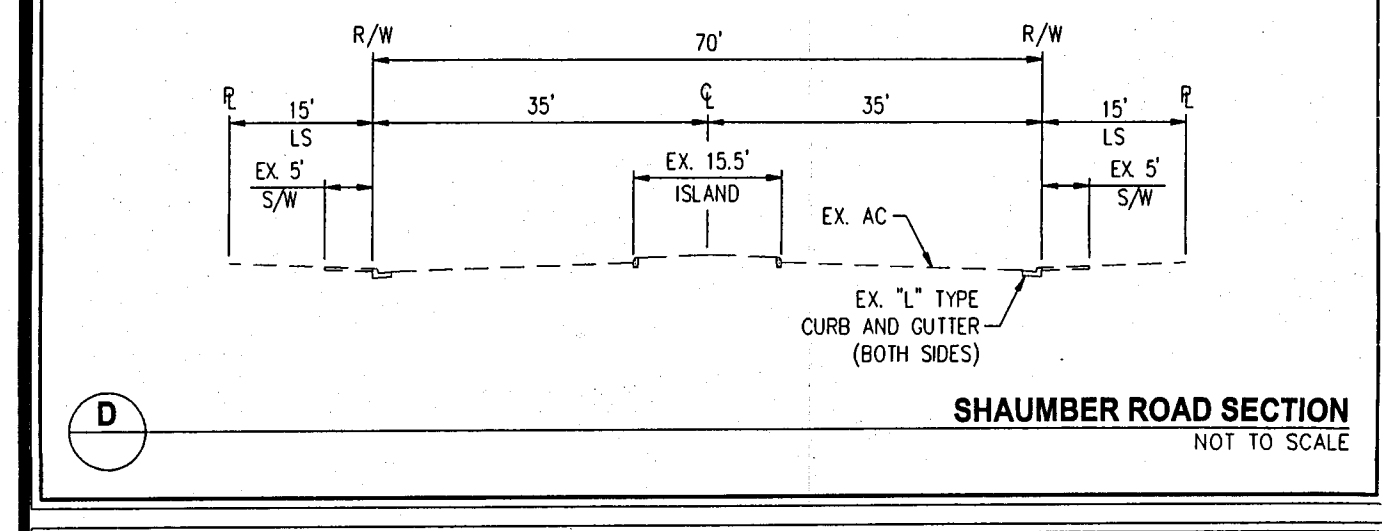
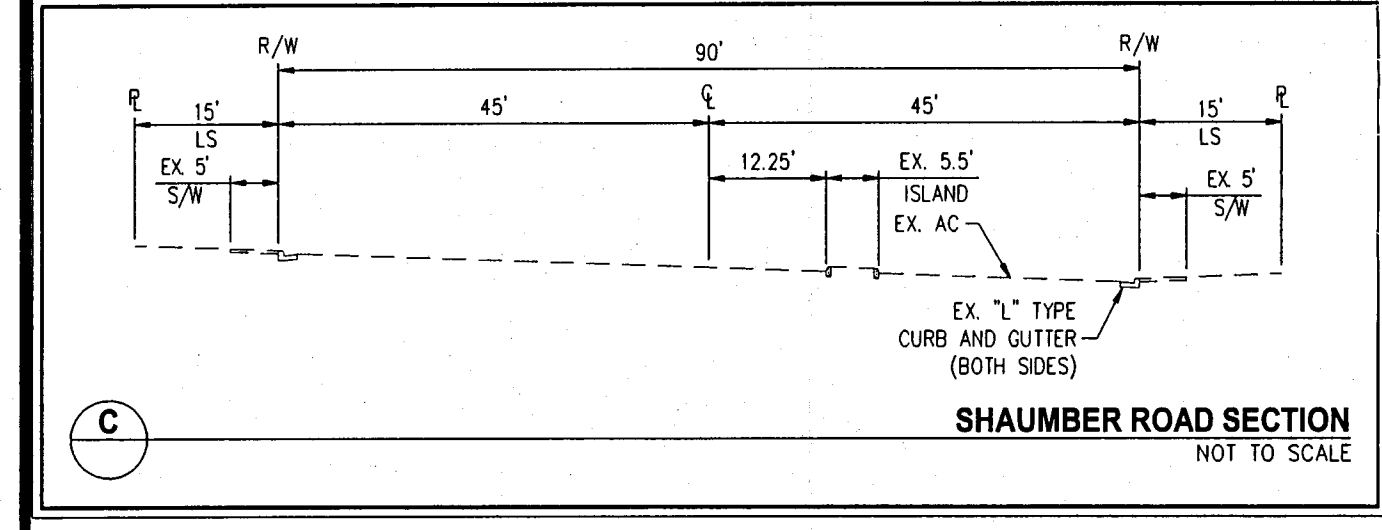
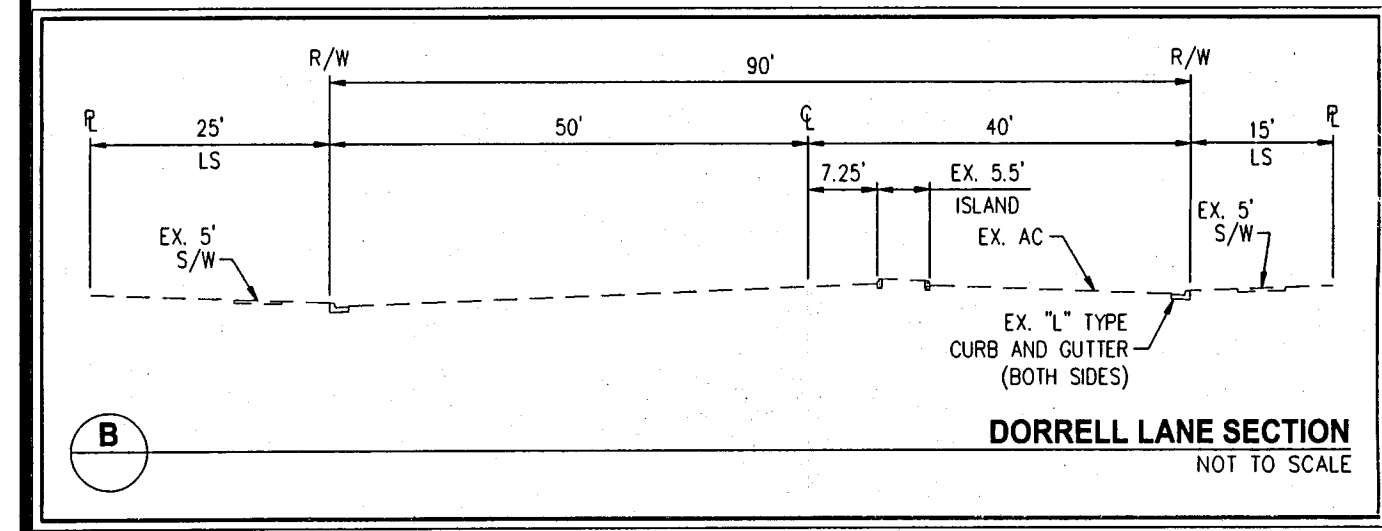
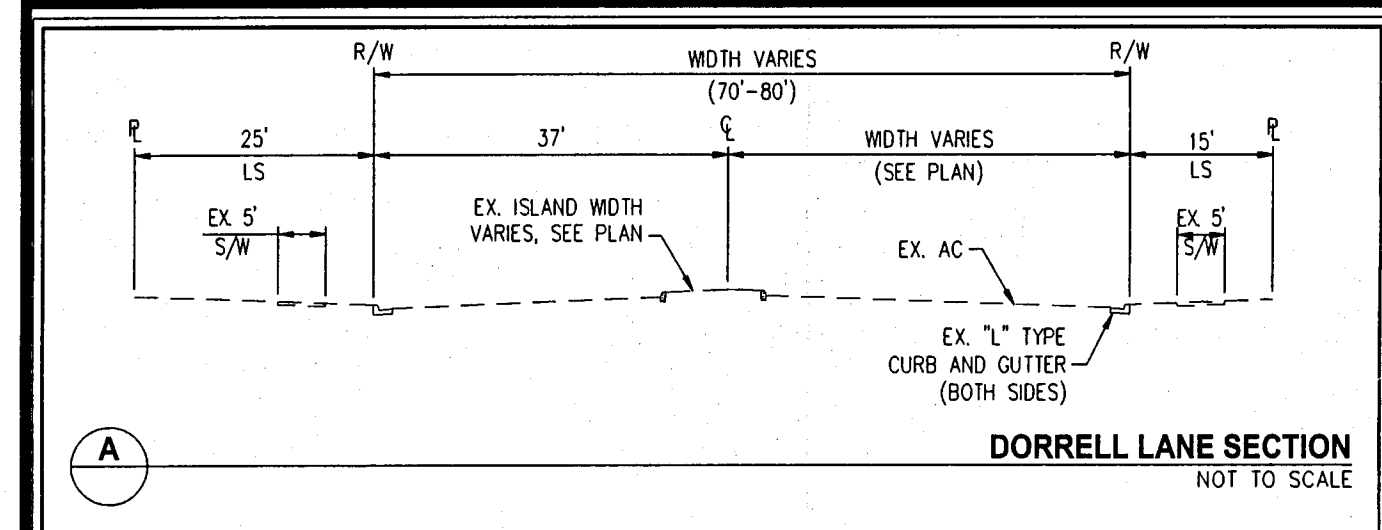

FEMA FLOOD ZONE DESIGNATION
THE PROJECT SITE IS LOCATED WITHIN A FEMA DESIGNATED ZONE X (AREA OUTSIDE THE 0.2% ANNUAL CHANCE FLOOD EVENT), PER FIRM PANEL 32003C1750E, DATED SEPTEMBER 27, 2002.

BASIS OF BEARING
NORTH 89°23'23\"/>

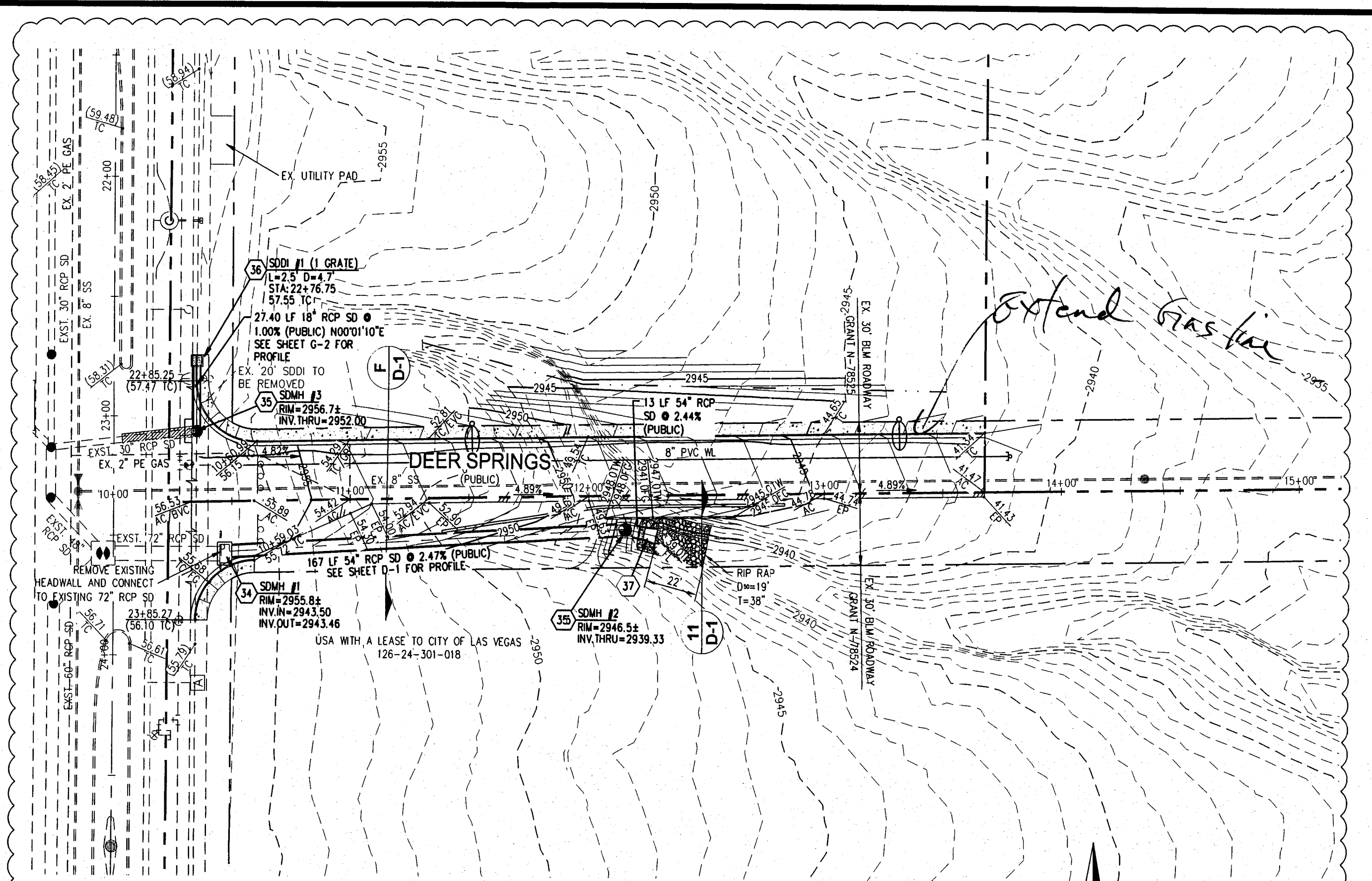
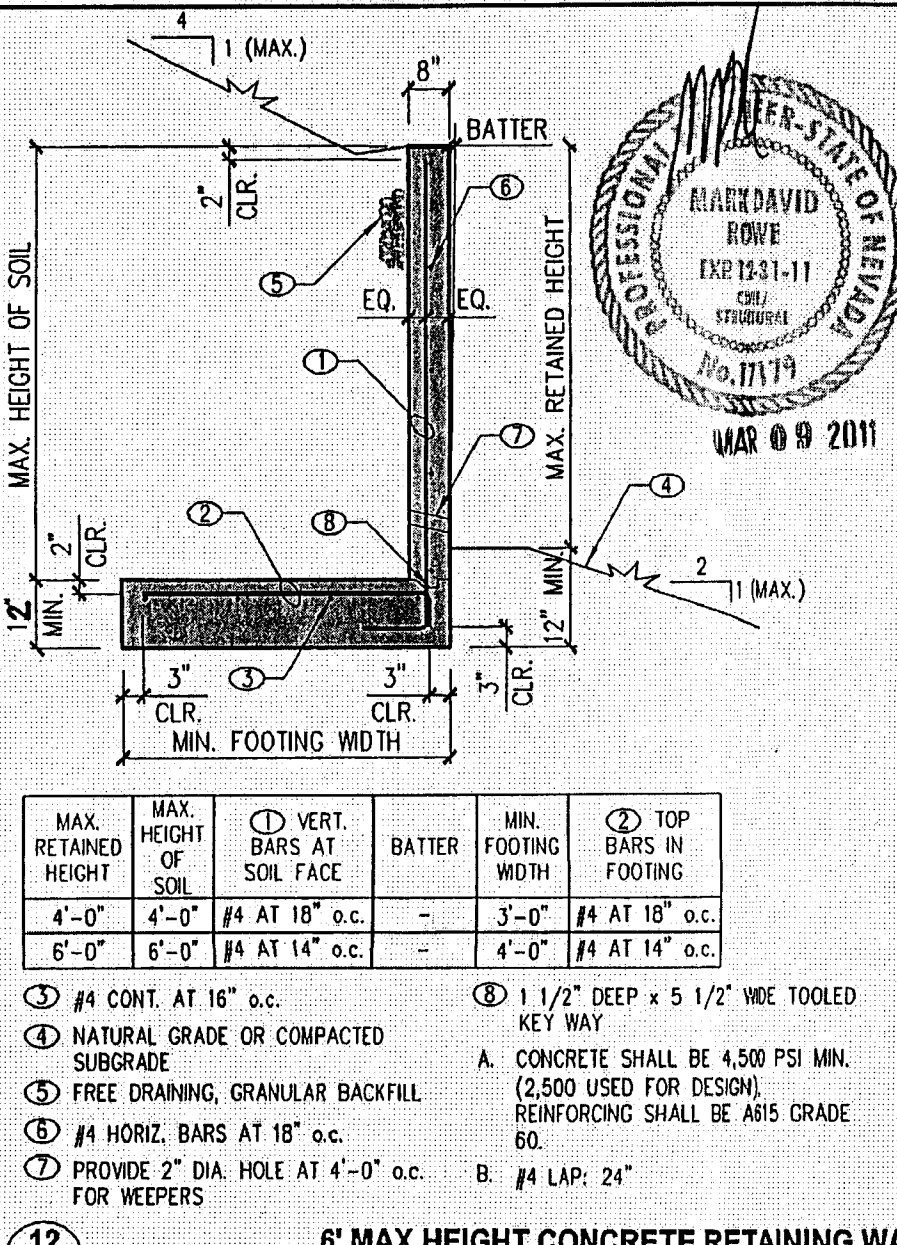
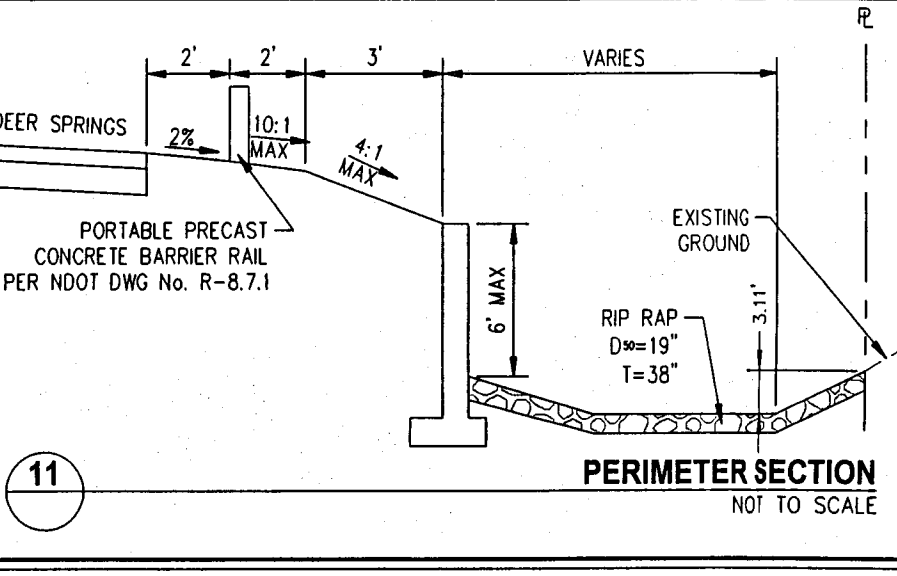

- CONSTRUCTION NOTES**
- (34) CONSTRUCT NOTOT TYPE IV STORM DRAIN MANHOLE PER STANDARD DWG No. R-4.3.2
 - (35) CONSTRUCT 60" TYPE III STORM DRAIN MANHOLE PER CCAUSD DWG No. 405
 - (36) CONSTRUCT 2.5" TYPE "CM2" DROP INLET PER CCAUSD DWG No. 412A W/ STORMWATER QUALITY STAMP PER CCAUSD DWG No. 421
 - (37) CONSTRUCT NOTOT RCP HEADWALL PER NOTOT STANDARD DWG No. R-2.5.2

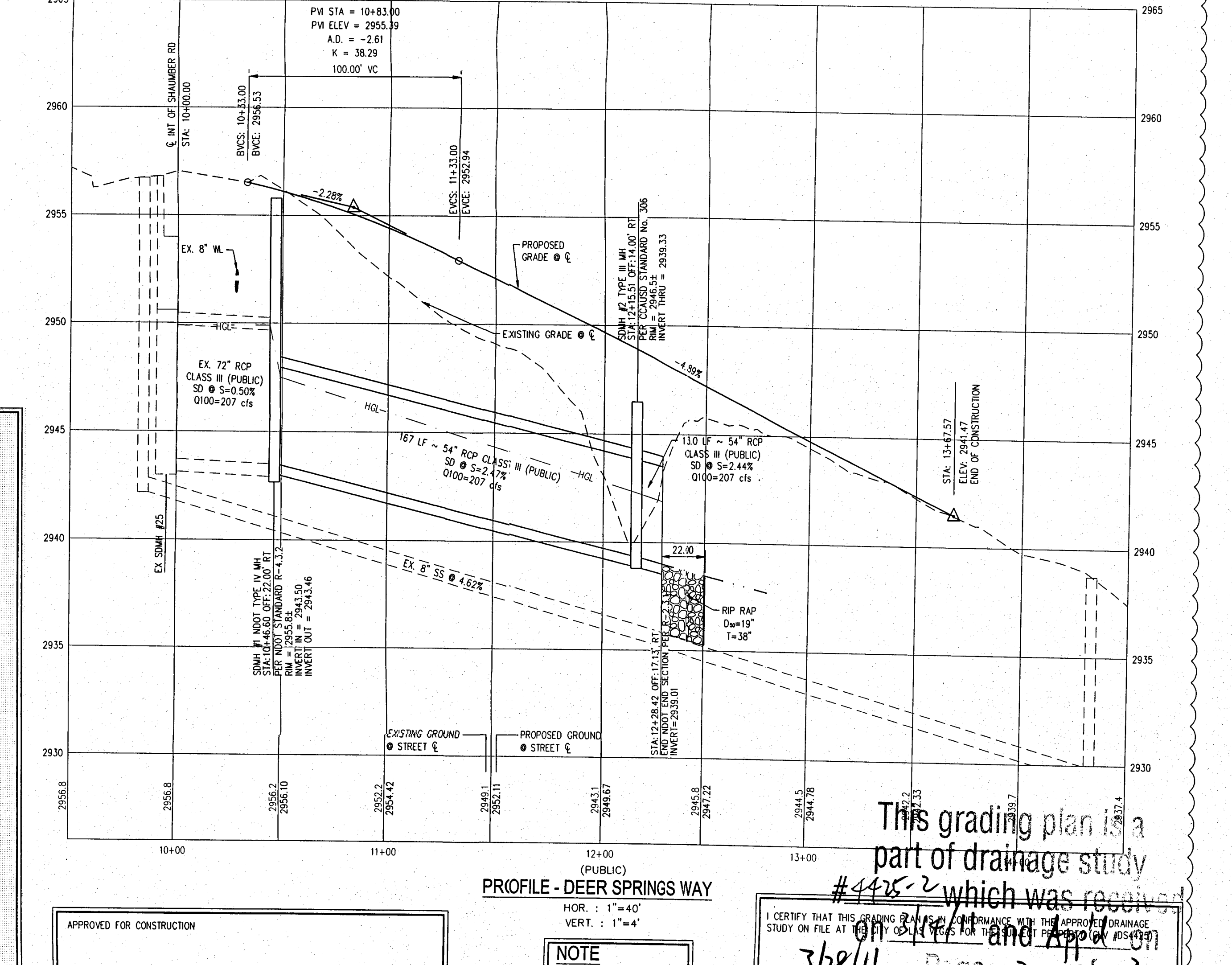

Call before you Dig
1-800-227-2800
CLARK COUNTY TRAFFIC OPERATIONS
1-702-455-7544

CALL BEFORE YOU DIG OVERHEAD
1-702-227-2929

Call before you do UnderGround
1-702-455-7511
1-702-229-6611
1-702-455-7544

SLATER HANIFAN GROUP
CONSULTING ENGINEERS & PLANNERS
5740 S. ARVILLE STREET #216, LAS VEGAS, NV 89118
PHONE (702) 284-5300 FAX (702) 284-5399

PROVIDENCE MASTER HOMEOWNERS ASSOCIATION
KNICKERBOCKER PARK
DETAIL SHEET

SECTION: 24 SOUTH RANGE: 95 EAST
DATE: 01/24/11
DRAFTER: TP
DESIGNER: PL
CHECKED: BP
PROJECT NO. LTK1003-001

DATE: 01/24/11
DRAFTER: TP
DESIGNER: PL
CHECKED: BP
PROJECT NO. LTK1003-001

TRAVIS POECHMANN, P.E. 19277
DATE: 3/8/11

D-1
SHEET 5 OF 11

DEERSPRINGS WAY ALIGNMENT

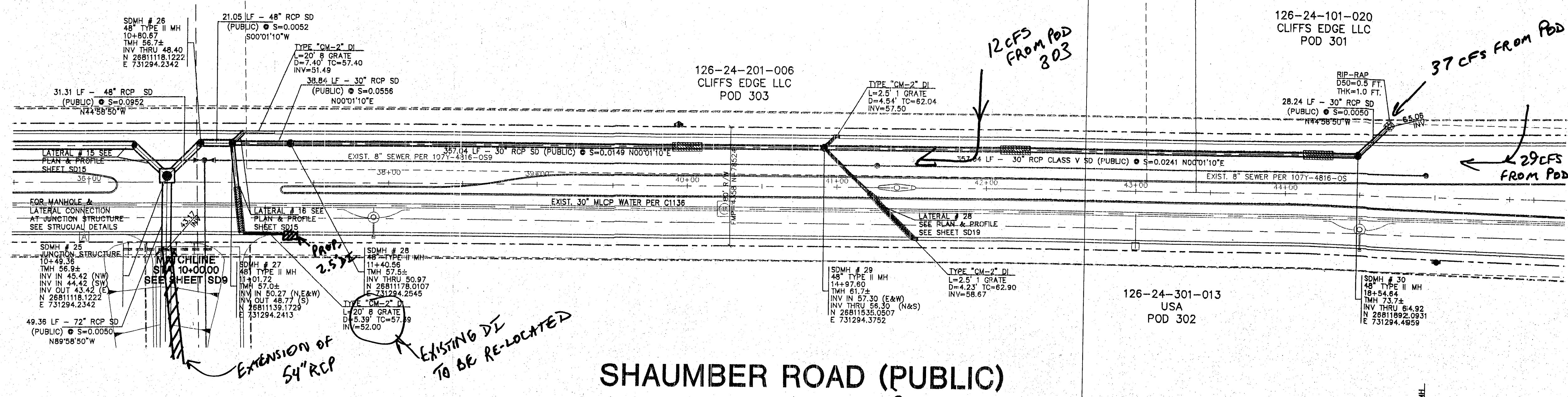

SHAUMBER ROAD (PUBLIC)

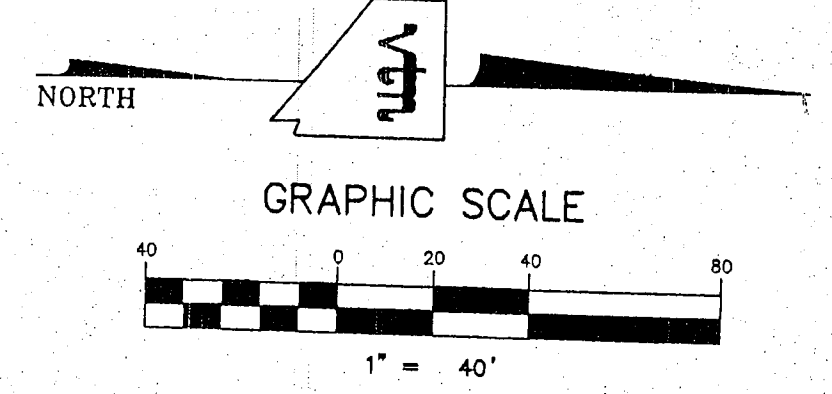
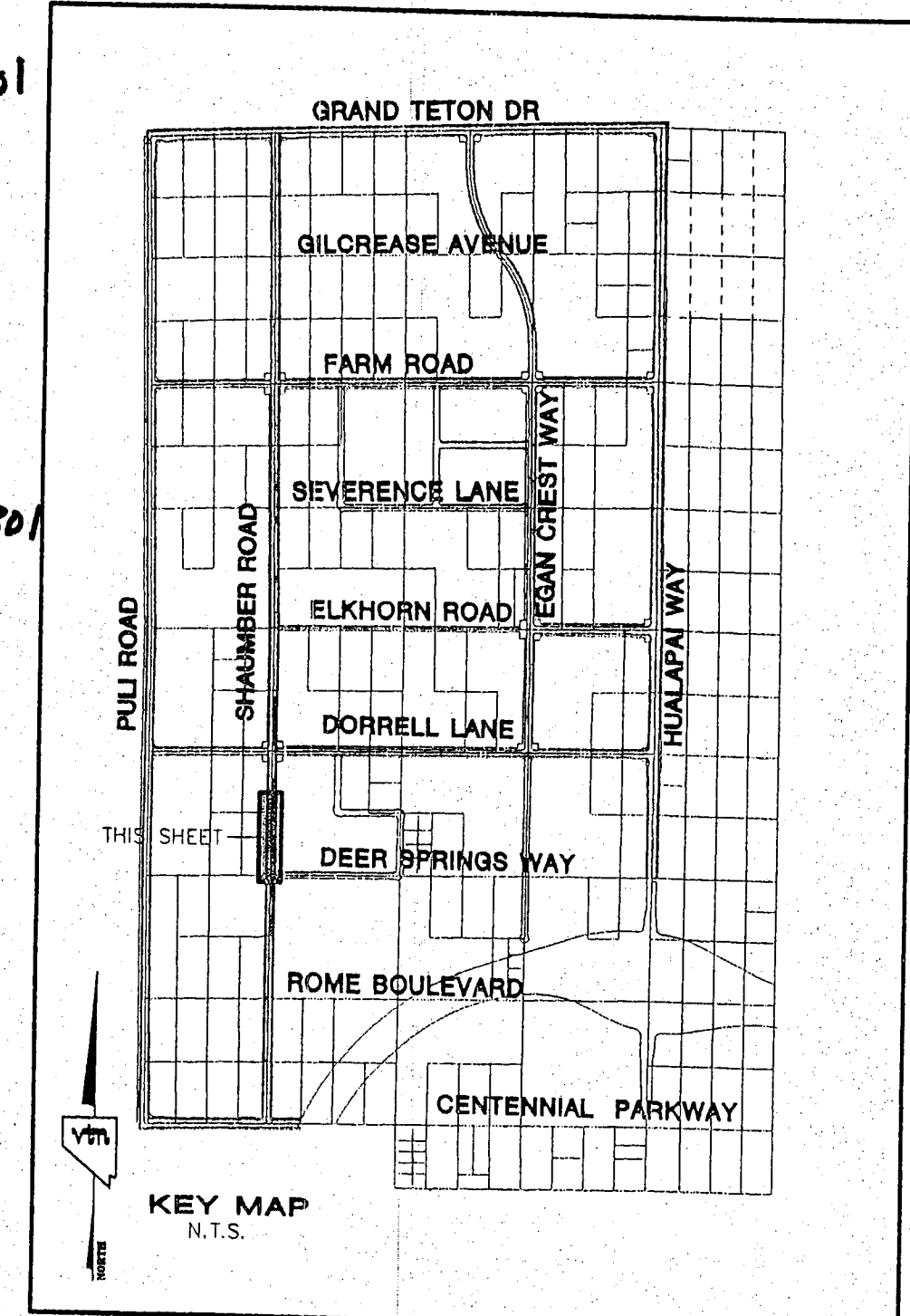
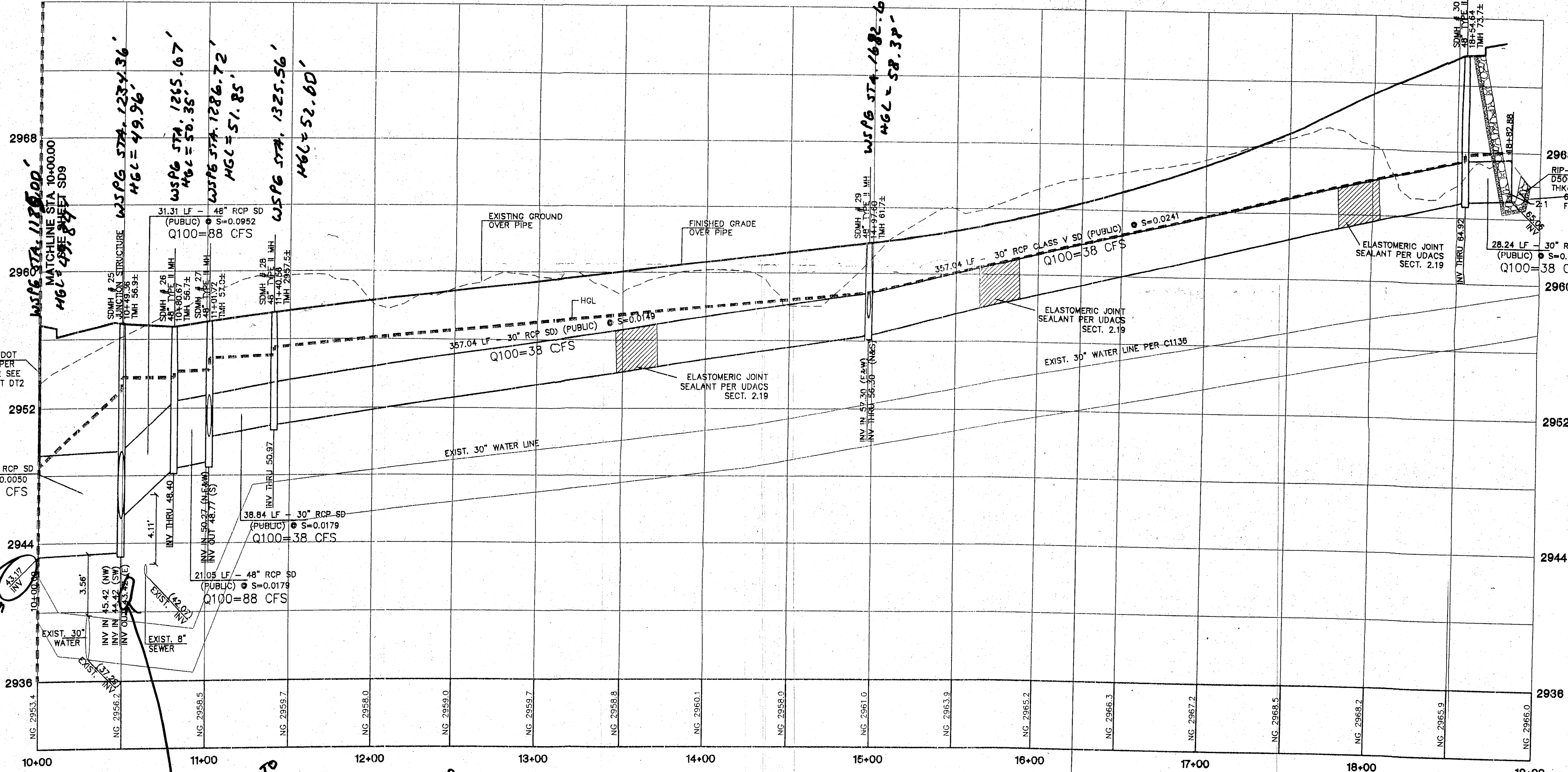

CONTRACTOR NOTE:
CONTRACTOR SHALL VERIFY HORIZONTAL AND VERTICAL LOCATION OF EXISTING UTILITIES AND NOTIFY THE DESIGN ENGINEER IMMEDIATELY OF ANY DISCREPANCIES PRIOR TO CONSTRUCTION.

Call before you Underground
1-702-455-7511
CLARK COUNTY TRAFFIC OPERATIONS
1-702-229-6611
FREEWAY AND ARTERIAL SYSTEM OF TRANSPORTATION

Call before you Overhead
1-702-227-2929

Call before you Dig
1-800-227-2600

BASIS OF BEARINGS
THE BASIS OF BEARINGS FOR THIS PROJECT IS NORTH 00°08'16" EAST BEING THE EAST LINE OF THE NORTHWEST QUARTER (NE 1/4) OF THE SECTION 24, TOWNSHIP 19 SOUTH, RANGE 59 EAST, M.D.M., CLARK COUNTY, NEVADA, AS SHOWN ON A RECORD OF SURVEY ON FILE IN THE CLARK COUNTY, NEVADA, RECORDER'S OFFICE IN FILE 123 AT PAGE 32.

PROJECT BENCHMARK
PROJECT DATUM: NORTH AMERICAN VERTICAL DATUM OF 1988 (NAV88)
CLARK COUNTY VERTICAL CONTROL: 1000-6N6
NAV88 ELEVATION: 787.794 METERS (2584.62 FEET)
RIVET AND SQUARE ALUMINUM PLATE IN A CONCRETE CYLINDER, LOCATED 25' SOUTH & 50' EAST OF GRAND CANYON DRIVE AND RED COACH AVENUE, 1' WEST OF ELECTRICAL MOUNT.

CITY OF LAS VEGAS BENCHMARK
DATUM: NORTH AMERICAN VERTICAL DATUM OF 1988 (NAV88)
CITY OF LAS VEGAS BENCHMARK: BLV99-135ES
NAV88 ELEVATION: 869.806 METERS (2853.03 FEET)
RIVET AND PLATE IN CONCRETE CYLINDER NW CORNER OF HUALAPAI AND ELKHORN

NOTE: ADD 0.34' TO ABOVE CITY OF LAS VEGAS BENCHMARK BLV99-135ES TO MATCH ORIGINAL PROJECT BENCHMARK, CLARK COUNTY BENCHMARK 1000-6N6 (2584.62 FEET) AS SHOWN ON RECORD OF SURVEY FILE 124 PAGE 94.

FIELD VERIFIED @ 43.50

ADJUSTED TO 43.75 TO CORRECT FOR SURVEY ELEVATION OF 43.50 @ OUTLET OF 72" RCP

7	6	5	4	3	2	1
DATE	BY	REV	DATE	BY	REV	DATE

CLIFFS EDGE LLC
3455 CLIFF SHADOWS PARKWAY, SUITE 200
LAS VEGAS, NEVADA 89129
(702) 777-1221

STORM DRAIN PLAN & PROFILE
SHAUMBER ROAD
STA. 10+00.00 TO 18+82.88

CLIFFS EDGE / PROVIDENCE
SHAUMBER ROAD
CENTENNIAL TO GRAND TETON

DRAWN BY: RM
DESIGNED BY: JH
CHECKED BY: LM
PROJECT NO.: 3889

SCALE: 1"=40' HORIZ.
1"=4' VERT.

EXPIRES 06-30-07

PROFESSIONAL ENGINEER STATE OF NEVADA
DANIEL J. HOOD
NO. 2811
VOLUNTARY JO

DATE: 6-30-07

SHEET NO. 21 OF 44 SHEETS
DRAWING NO. SD6

I CERTIFY THAT THIS PLAN IS IN CONFORMANCE WITH THE APPROVED DRAINAGE STUDY ON FILE AT CITY OF LAS VEGAS FOR THIS PROJECT. DS3617

DANIEL J. HOOD NO. 12811

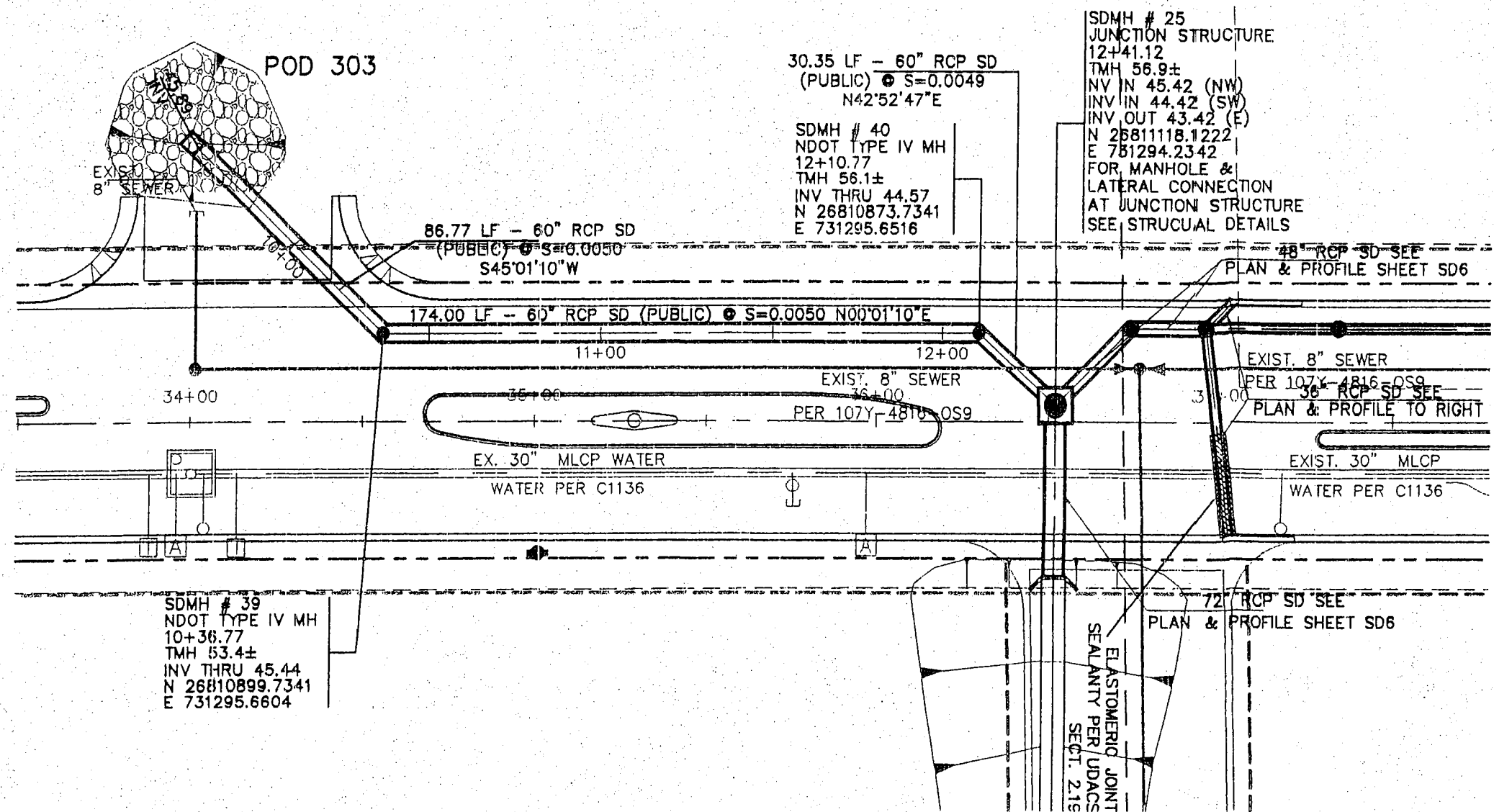

LATERAL # 15
SEE SD6

*WSPB STA. 1525.48 -
HGL = 51.99 -*

*WSPB STA. 1264.71 -
HGL = 50.45 -
WSPB STA. 1234.36 -
HGL = 50.22 -*

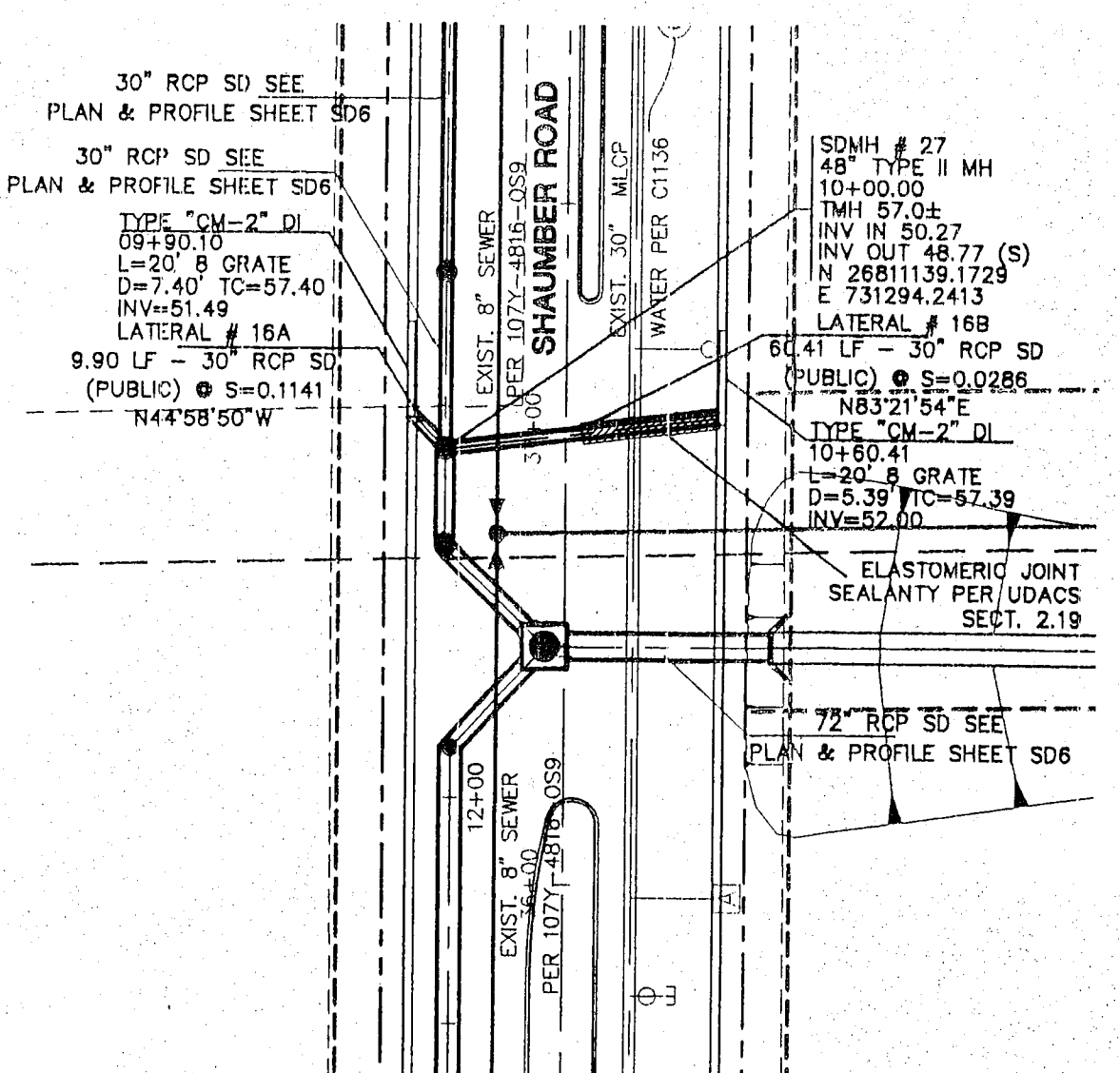

LATERAL # 16
SEE SD6

RELOCATED TO 2.5' DE

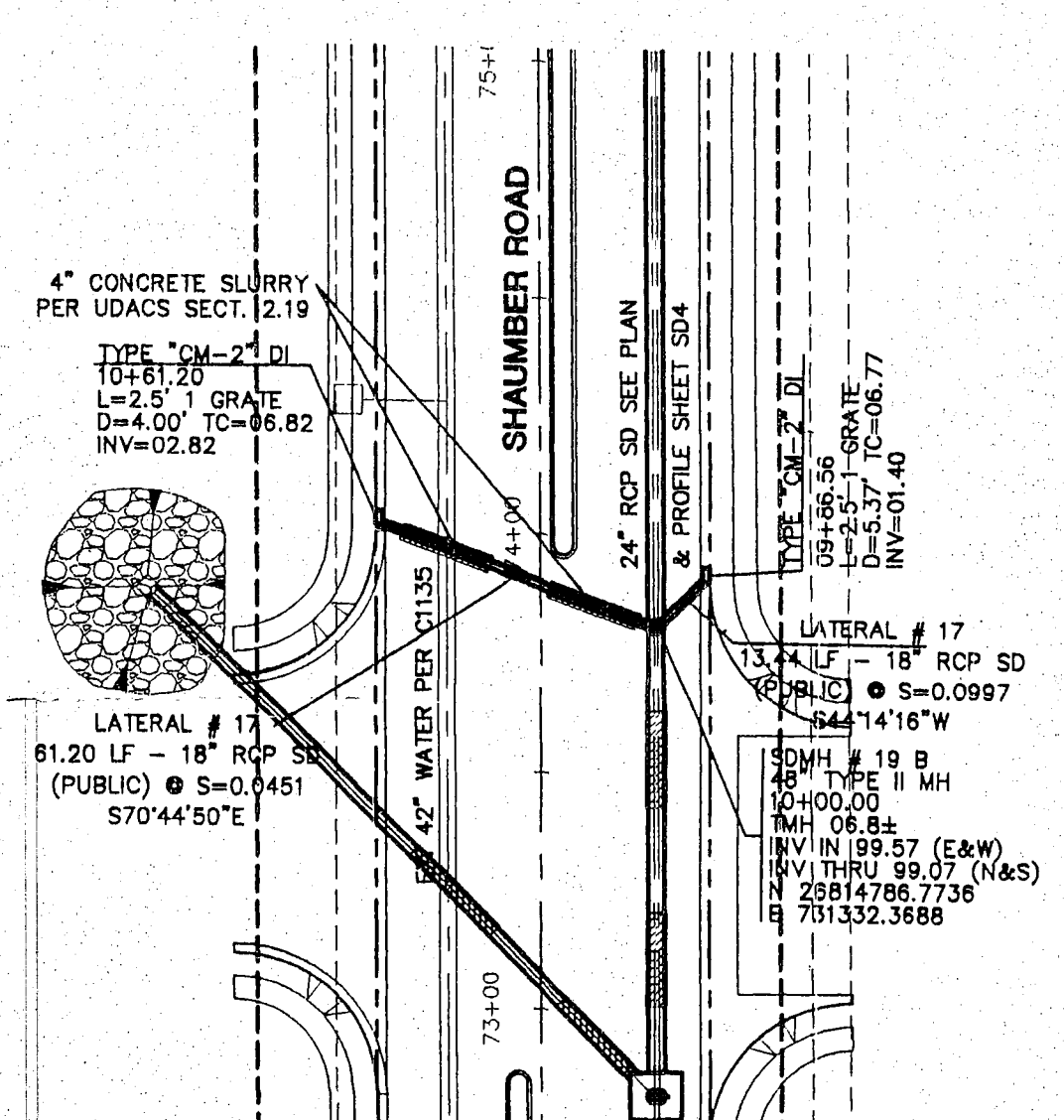
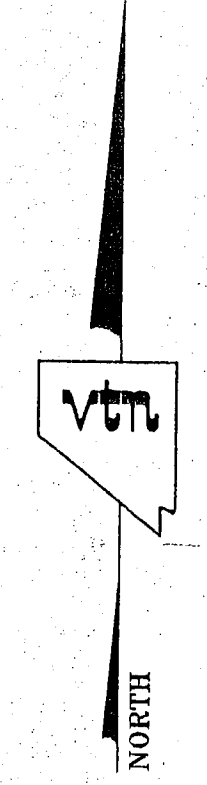

LATERAL # 17
SEE SD4

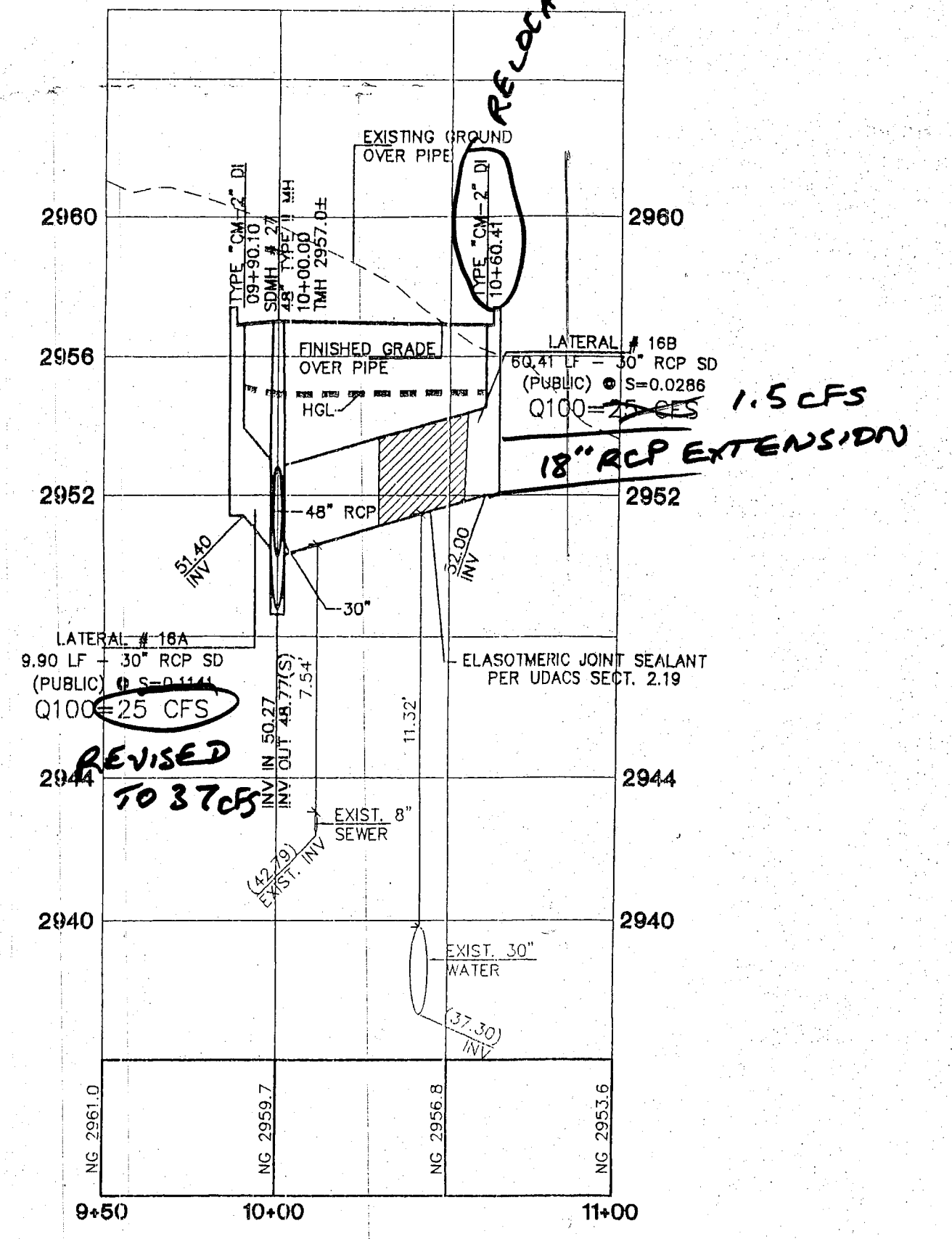
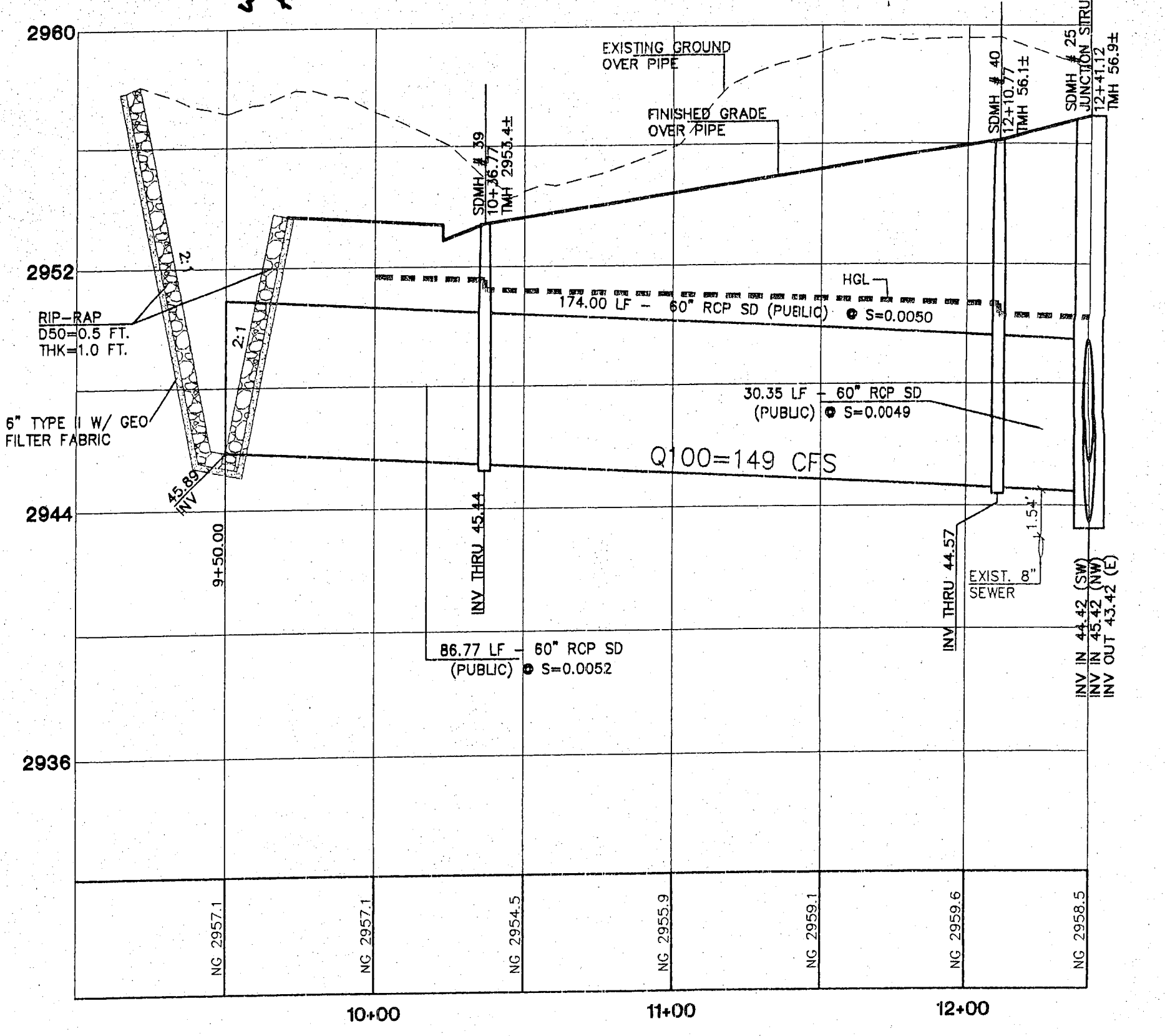
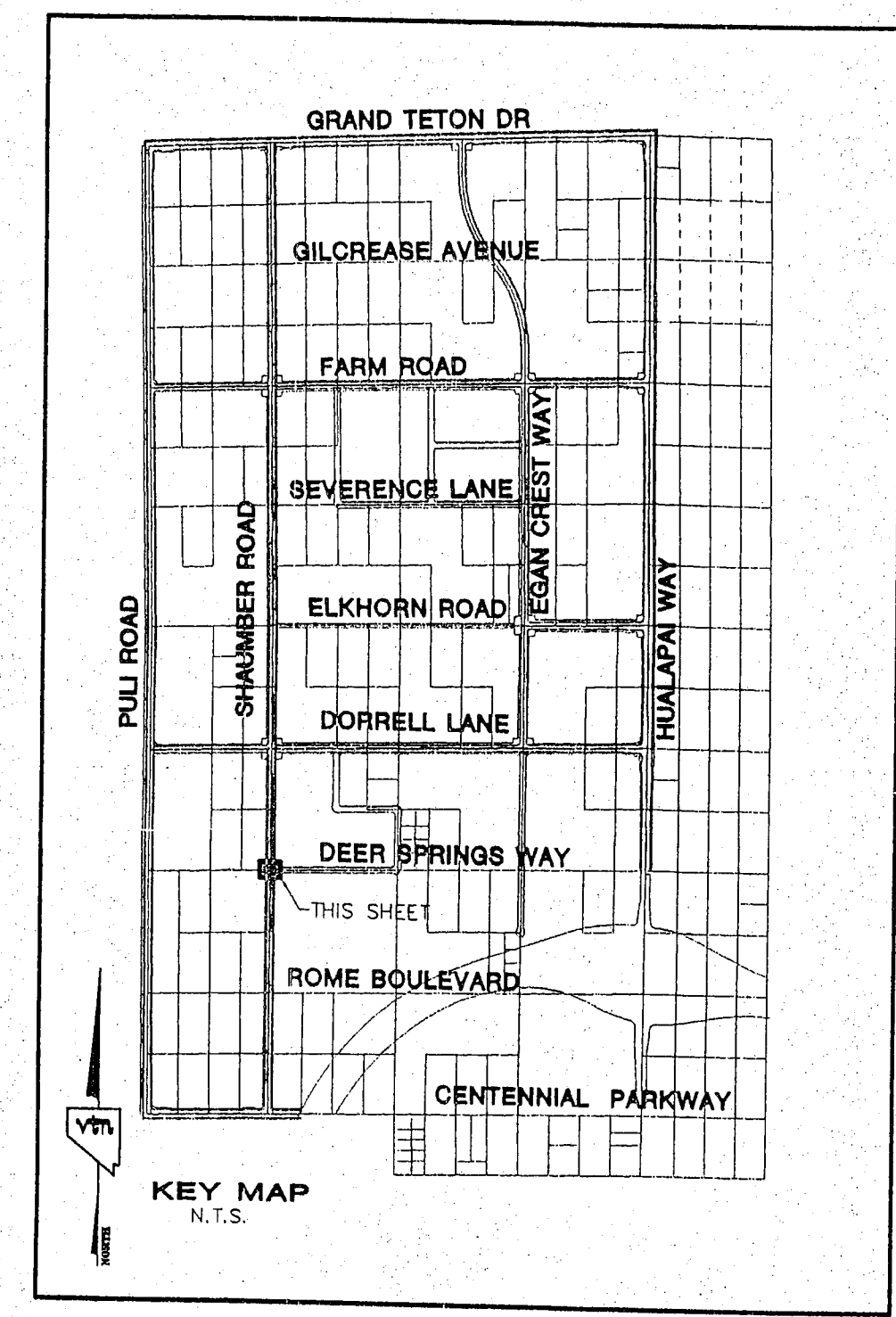

REVISED TO 37 CFS

*1.5 CFS
18" RCP EXTENSION*

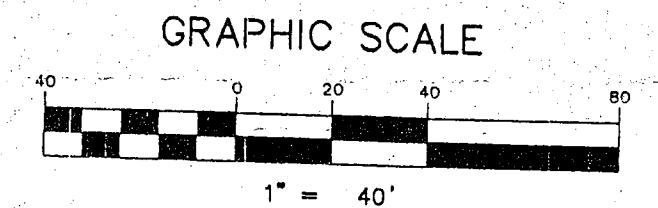
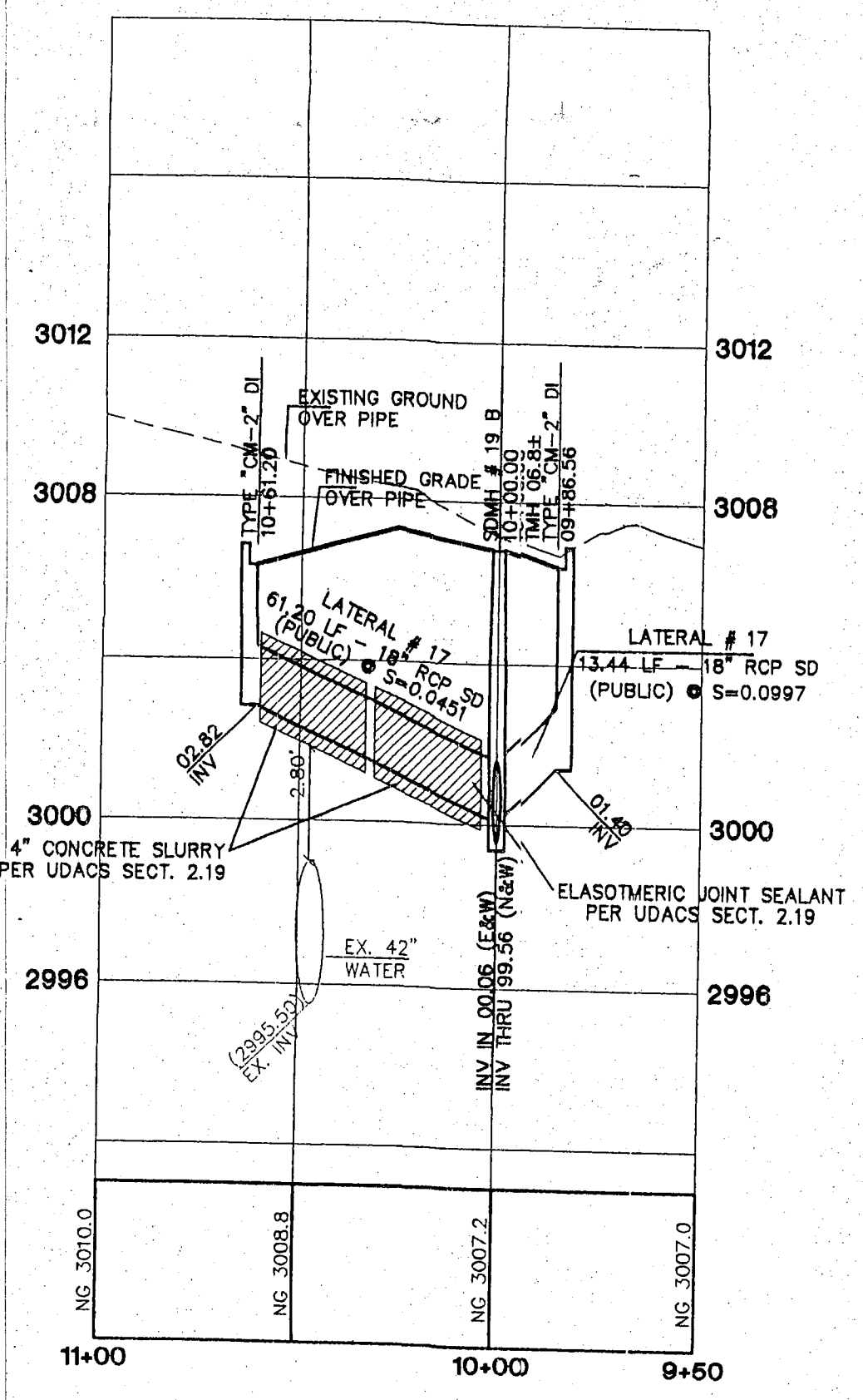

CONTRACTOR NOTE:
CONTRACTOR SHALL VERIFY HORIZONTAL AND VERTICAL LOCATION OF EXISTING UTILITIES AND NOTIFY THE DESIGN ENGINEER IMMEDIATELY OF ANY DISCREPANCIES PRIOR TO CONSTRUCTION.

Call before you Overhead
1-702-227-2929

Call before you Underground
1-702-455-7511
1-702-229-6611

Call before you Dig
1-800-227-2600

BASIS OF BEARINGS
THE BASIS OF BEARINGS FOR THIS PROJECT IS NORTH 00°08'16" EAST BEING THE EAST LINE OF THE NORTHWEST QUARTER (NE 1/4) OF THE SECTION 24, TOWNSHIP 19 SOUTH, RANGE 59 EAST, M.D.M., CLARK COUNTY, NEVADA, AS SHOWN ON A RECORD OF SURVEY ON FILE IN THE CLARK COUNTY, NEVADA, RECORDER'S OFFICE IN FILE 123 AT PAGE 32.

PROJECT BENCHMARK
PROJECT DATUM: NORTH AMERICAN VERTICAL DATUM OF 1988 (NAVD88)
CLARK COUNTY VERTICAL CONTROL: 1000-6N6
NAVD88 ELEVATION: 787.794 METERS (2584.62 FEET)

CITY OF LAS VEGAS BENCHMARK
DATUM: NORTH AMERICAN VERTICAL DATUM 1988 (NAVD88)
CITY OF LAS VEGAS BENCHMARK: BLV99-1353B
NAVD88 ELEVATION: 869.606 METERS (2853.03 FEET)

RIVET AND SQUARE ALUMINUM PLATE IN A CONCRETE CYLINDER, LOCATED 28' SOUTH & 50' EAST OF GRAND CANYON DRIVE AND RED COACH AVENUE, 1' WEST OF ELECTRICAL FAULT.

RIVET AND PLATE IN CONCRETE CYLINDER NW CORNER OF HUALAPAI AND ELKHORN

NOTE: ADD 0.34' TO ABOVE CITY OF LAS VEGAS BENCHMARK BLV99-1353ES TO MATCH ORIGINAL PROJECT BENCHMARK, CLARK COUNTY BENCHMARK 1000-6N6 (2584.62 FEET) AS SHOWN ON RECORD OF SURVEY FILE 124 PAGE 94.

I CERTIFY THAT THIS PLAN IS IN CONFORMANCE WITH THE APPROVED DRAINAGE STUDY ON FILE AT CITY OF LAS VEGAS FOR THIS PROJECT. DS3617
7.21.09
DANIEL J. HOOD NO. 12811 DATE

CLIFFS EDGE LLC
3455 CLIFF SHADOWS PARKWAY, SUITE 290
LAS VEGAS, NEVADA 89129
(702) 777-1221

CITY OF LAS VEGAS, NEVADA
2727 SOUTH RAINBOW BOULEVARD LAS VEGAS, NEVADA 89146-5148
PH. (702) 873-7500 FAX (702) 362-2997
nevada CONSULTING ENGINEERS & LAND SURVEYORS

STORM DRAIN PLAN & PROFILE
SHAUMBER ROAD
LATERAL # 15 THRU LATERAL # 17

CLIFFS EDGE / PROVIDENCE
SHAUMBER ROAD
CENTENNIAL TO GRAND TETON

REV.	DATE	BY	REVISION
7			
6			
5			
4			
3			
2			
1			

DRAWN BY: JRM
DESIGNED BY: JRM
CHECKED BY: JRM
PROJECT NO: 5889

SCALE: 1" = 40' HORIZ.
1" = 4' VERT.

EXPIRES 06-30-07

PROFESSIONAL ENGINEER STATE OF NEVADA
DANIEL J. HOOD
NO. 12811
CIVIL
7.21.09

SHEET
SD15
30 OF 44 SHEETS

DRAWING NO.