

1
2
3
4
5
6
7
8
9
10
11
12
13
14
15
16
17
18
19
20
21
22
23
24
25

BILL NO. 2015-17

ORDINANCE NO. _____

AN ORDINANCE TO EXTEND THE BOUNDARIES OF THE CITY, TO PARTICULARLY DESCRIBE THE LAND TO BE ANNEXED, TO MAKE ITS INHABITANTS SUBJECT TO THE LAWS, OBLIGATIONS AND BENEFITS OF THE CITY, AND TO PROVIDE FOR OTHER RELATED MATTERS. (ANX-57905)

Sponsored by: Councilman Ricki Y. Barlow Summary: Annexes property described as located at 3316 Valley Lane.

THE CITY COUNCIL OF THE CITY OF LAS VEGAS DOES HEREBY ORDAIN AS FOLLOWS:

SECTION 1: The corporate limits of the City of Las Vegas, Nevada, are hereby extended to annex, include, and make a part of the City of Las Vegas, Nevada, the following described real property:

That portion of the Southeast Quarter (SE 1/4) of the Northwest Quarter (NW 1/4) of the Southwest Quarter (SW 1/4) of Section 20, Township 20 South, Range 61 East, M.D.M., of Clark County Nevada, being the south 150.00 feet of School Block 12 of LAS VEGAS ACRES-TRACT No. 1 as described on TRUSTEE'S DEED UPON SALE recorded April 21, 2010 in Book 20100421 as Instrument Number 02814 of Clark County Nevada records, together with the adjoining 25.00 foot half street right of way of Valley Lane and the adjoining 15.00 foot half of vacated 30.00 foot alley as described by Order of Vacation VS-010-90 recorded April 23, 1993 as Instrument Number 01432 of Clark County Nevada records.

1 BASIS OF BEARINGS: South 89°48'21" West, being the south line of the
2 Southeast Quarter (SE 1/4) of the Northwest Quarter (NW 1/4) of the Southwest
3 Quarter (SW 1/4) of Section 20, Township 20 South, Range 61 East M.D.M., as
4 shown on Parcel Map in File 4, Page 77 of Clark County Nevada Records.

5 Prepared by:
6 Brian Yu, PLS
7 Dept. of Operations and Maintenance
8 Right-of-Way,
9 City of Las Vegas
10 333 N. Rancho Drive, 8th Floor
11 Las Vegas, NV 89106
12 byu@lasvegasnevada.gov

13 SECTION 2: The City Council hereby determines that the described territory
14 meets the requirements provided by law for annexation to the City for the following reasons:

15 A. The area to be annexed was contiguous to the City's boundaries at the time
16 the annexation proceedings were instituted;

17 B. More than one-eighth (1/8) of the aggregate external boundaries of the
18 area are contiguous to the City;

19 C. The territory proposed to be annexed is not included within the boundaries
20 of another incorporated city or within the boundaries of any unincorporated town as those
21 boundaries existed as of July 1, 1983;

22 D. The City is eligible to annex the described territory because the
23 landowners have signed a petition constituting one hundred percent (100%) of the owners of record
24 of individual lots or parcels of land within the annexation area.

25 SECTION 3: The City will provide police protection through the Las Vegas
Metropolitan Police Department, fire protection, street maintenance, and library services
immediately upon annexation. Garbage collection by the company franchised by the City will also
be provided immediately. The City sanitary sewer system will serve the proposed annexation area.
Any connection to or extension of this sewer line to serve the annexation area shall be at the
expense of the landowners. Other services, such as participation in the City's recreational

1 programs, special education classes and programs, public works planning, building inspections, and
2 other City services will also be available immediately. Utilities such as gas, electricity, telephone,
3 and water are provided by private utility companies and other services to the area will not be
4 affected by annexation. Street paving, curbs and gutters, sidewalks and street lights which are not
5 in place at the time of annexation will be installed in the presently developed areas upon the request
6 of the property owners and at their expense by means of special assessment districts. Such
7 improvements will be extended into the undeveloped areas as development takes place and the
8 need therefor arises, and will be located according to the needs of the area at that time. Such
9 installations will also be made at the expense of the property owners, either by means of special
10 assessment districts or as prerequisites to the approval of subdivision plats, building permits or
11 other land use or development applications.

12 SECTION 4: The annexation of the described territory shall become effective
13 on the 10th day of April, 2015, and on that date the City will have the funds appropriated in
14 sufficient amount to finance the extension into the described territory of police protection, fire
15 protection, street maintenance, street sweeping, and street lighting maintenance.

16 SECTION 5: The described territory, together with the inhabitants and property
17 thereof, shall, from and after the 10th day of April, 2015, be subject to all debts, laws, ordinances
18 and regulations in force in the City and shall be entitled to the same privileges and benefits as other
19 parts of the City, and shall be subject to municipal taxes levied by the City.

20 SECTION 6: The City Engineer is hereby instructed to cause to be prepared an
21 accurate map or plat of the described territory and to record the map or plat, together with a
22 certified copy of this ordinance, in the office of the County Recorder of Clark County, Nevada,
23 which recording shall be done prior to the 10th day of April, 2015.

24 SECTION 7: The described territory, which previously has been zoned R-E
25 (County of Clark classification), is hereby classified as R-E (City of Las Vegas classification),

1 The above and foregoing ordinance was first proposed and read by title to the City Council on the
2 ____ day of _____, 2015, and referred to a committee for recommendation, the
3 committee being composed of the following members _____
4 _____;
5 thereafter the said committee reported favorably on said ordinance on the ____ day of
6 _____, 2015, which was a _____ meeting of said Council;
7 that at said _____ meeting, the proposed ordinance was read by title to the
8 City Council as first introduced and adopted by the following vote:

9 VOTING "AYE": _____

10 VOTING "NAY": _____

11 ABSENT: _____

12 APPROVED:

13
14 By _____
CAROLYN G. GOODMAN, Mayor

15 ATTEST:

16 _____
17 LUANN D. HOLMES, MMC
Acting City Clerk

18
19
20
21
22
23
24
25

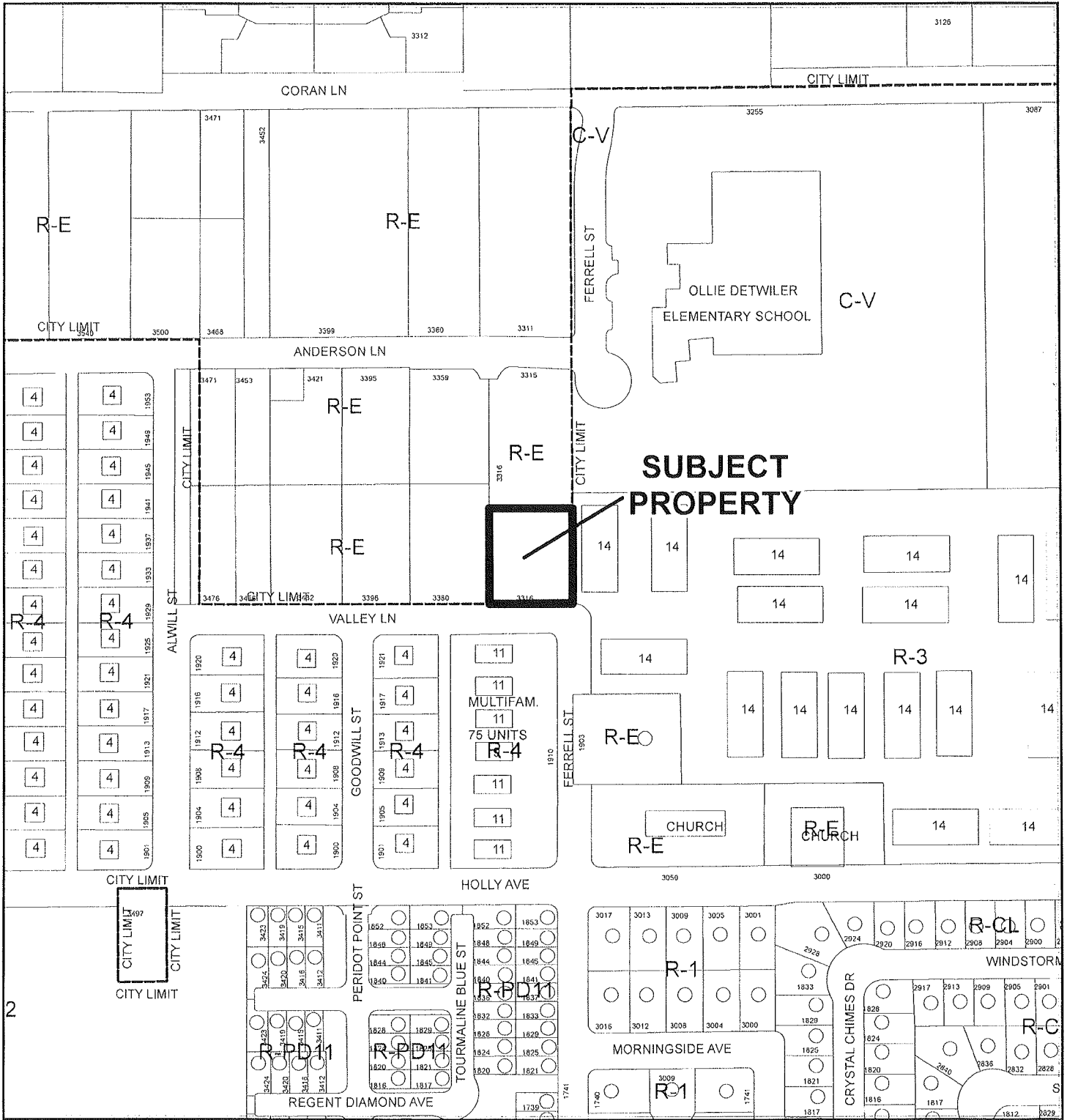

CASE: ANX-57905 (PRJ-57852)

