



DEPARTMENT OF PLANNING

STATEMENT OF FINANCIAL INTEREST

Case Number: **ZON-54561** APN: 162-03-311-003,004,005

Name of Property Owner: Santa Gold Realty LLC

Name of Applicant: Amy Pam

Name of Representative: Amy Pam

To the best of your knowledge, does the Mayor or any member of the City Council or Planning Commission have any financial interest in this or any other property with the property owner, applicant, the property owner or applicant's general or limited partners, or an officer of their corporation or limited liability company?

Yes

No

If yes, please indicate the member of the City Council or Planning Commission who is involved and list the name(s) of the person or persons with whom the City Official holds an interest. Also list the Assessor's Parcel Number if the property in which the interest is held is different from the case parcel.

City Official: _____

Partner(s): _____

APN: _____

Signature of Property Owner: *Amy Pam*

STATE OF NV
County of Clark

Print Name: Amy Pam

Subscribed and sworn before me

This 27th day of May, 2014 by Amy Pam

Danilyn Rubio
Notary Public in and for said County and State

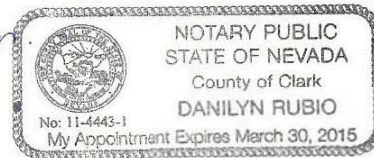

PRJ-54200

CLV Planning - Application Form

Application Number:	PRJ-54200
Application/Petition For:	Rezoning from R-4 (High Density Residential) and P-R (Professional Office and Parking) to C-1 (Limited Commercial) on three parcels located at 1704, 1710, and 1714 Santa Paula Drive.
ProjectAddress (Location):	1704, 1710, 1714 SANTA PAULA DRIVE
Project Name	REZONING R-4 AND P-R TO C-1
Assessors Parcel #(s):	16203311003, 16203311004, 16203311005
Ward #:	WARD 3 (BOB COFFIN)
Is the Application Information Correct:	Yes
If no, ...change what	
General Plan Designation: Proposed:	C
Zoning District: Proposed:	C-1 - Limited Commercial
Gross Acres:	0.68
Lots/Units:	1704/1710/1714 Santa Paula DR
Additional Information:	
Applicant First Name:	AMY
Applicant Last Name:	PAM
Applicant Address:	3309 BARNSTAPLE CT
Applicant City:	LAS VEGAS
Applicant State:	NV
Applicant Zip:	89129
Applicant Phone:	(702)686-3372
Applicant Fax:	
Applicant Email:	soybeanpan@hotmail.com
Rep First Name:	AMY
Rep Last Name:	PAM
Rep Address:	3309 BARNSTAPLE CT
Rep City:	LAS VEGAS
Rep State:	NV
Rep Zip:	89129
Rep Phone:	(702)686-3372
Rep Fax:	
Rep Email:	soybeanpan@hotmail.com

ZON-54561

CLV Planning - Application Form

<p>I certify that I am the applicant and that the information submitted with this application is true and accurate to the best of my knowledge and belief. I understand that the City is not responsible for inaccuracies in information presented, and that inaccuracies, false information or incomplete application may cause the application to be rejected. I further certify that I am the owner or purchaser (or option holder) of the property involved in this application, or the lessee or agent fully authorized by the owner to make this submission. I Accept:</p>	<p>Yes</p>
<p>Is the Owner Information Correct:</p>	<p>Yes</p>
<p>If no, ...change what</p>	

Owner(s)	ADDR1	ADDR2
SANTA GOLD REALTY L L C	3309 BARNSTAPLE CT	LAS VEGAS, NV 89129-6709

CLVEPLAN Applicant	Company	Title	Email
Amy Pan	Santa Gold Realty LLC	ms	soybeanpan@hotmail.com

ZON-54561

ZON-54561

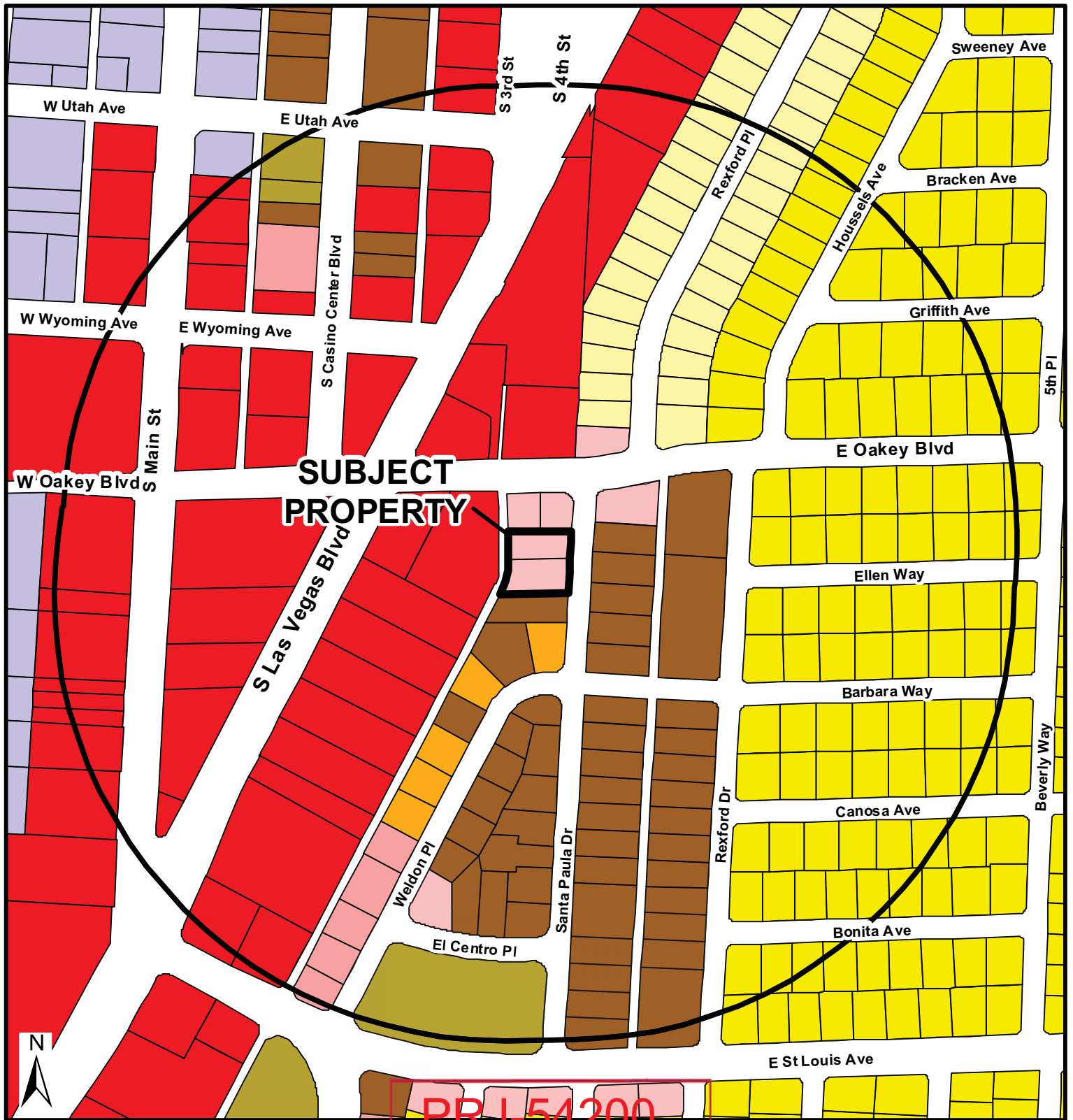

SUBJECT PROPERTY

PRJ 54200

07/16/14

FROM P-R TO C-1

Zoning

U - (GPAD Designation) Undeveloped	R-2 - Medium-Low Density Residential	P-O - Professional Office	C-M - Commercial/Industrial
R-A - Ranch Acres	R-3 - Medium Density Residential	N-S - Neighborhood Service	M - Industrial
R-E - Residential Estates	R-4 - High Density Residential	O - Office	C-V - Civic
R-D - Single-Family Residential-Restricted	R-5 - Apartment	C-D - Designed Commercial	P-C - Planned Community
R-PD - Residential Planned Development	R-MH - Mobile/Manufactured Home Residence	C-1 - Limited Commercial	T-D - Traditional Development
R-1 - Single Family Residential	R-MHP - Residential Mobile/Manufactured Home Park	C-2 - General Commercial	PD - Planned Development
R-CL - Single-Family Compact-Lot	P-R - Professional Offices and Parking	C-PB - Planned Business Park	T-C - Town Center

Subject Property

1000ft Buffer

City Limits



GIS maps are normally produced only to meet the needs of the City. Due to continuous development activity this map is for reference only.
Geographic Information System
 Planning & Development Dept.
 702-229-6301

Date: Monday, June 30, 2014