



PLANNING & DEVELOPMENT DEPARTMENT

STATEMENT OF FINANCIAL INTEREST

Case Number: ROC-33625 APN: 139-34-510-043, 034

Name of Property Owner: Plug It Inn II, LLC

Name of Applicant: The Siegel Group

Name of Representative: APTUS Architecture

To the best of your knowledge, does the Mayor or any member of the City Council or Planning Commission have any financial interest in this or any other property with the property owner, applicant, the property owner or applicant's general or limited partners, or an officer of their corporation or limited liability company?

Yes

No

If yes, please indicate the member of the City Council or Planning Commission who is involved and list the name(s) of the person or persons with whom the City Official holds an interest. Also list the Assessor's Parcel Number if the property in which the interest is held is different from the case parcel.

City Official: _____

Partner(s): _____

APN: _____

Signature of Property Owner: 
Print Name: Stephen Siegel

Subscribed and sworn before me

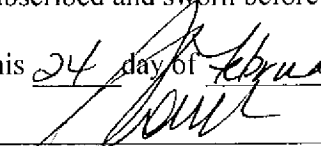
This 24 day of February, 2009

Notary Public in and for said County and State

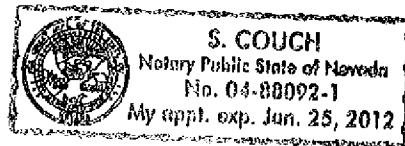



PLANNING & DEVELOPMENT DEPARTMENT

STATEMENT OF FINANCIAL INTEREST

Case Number: Roc-33625 APN: 139-34-501-013, 014, 015

Name of Property Owner: Gold Spike Holdings, LLC

Name of Applicant: The Siegel Group

Name of Representative: APTUS Architecture

To the best of your knowledge, does the Mayor or any member of the City Council or Planning Commission have any financial interest in this or any other property with the property owner, applicant, the property owner or applicant's general or limited partners, or an officer of their corporation or limited liability company?

Yes

No

If yes, please indicate the member of the City Council or Planning Commission who is involved and list the name(s) of the person or persons with whom the City Official holds an interest. Also list the Assessor's Parcel Number if the property in which the interest is held is different from the case parcel.

City Official: _____

Partner(s): _____

APN: _____

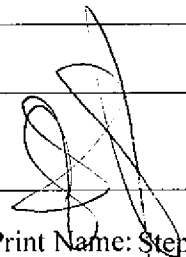
Signature of Property Owner: 
Print Name: Stephen Siegel

Subscribed and sworn before me

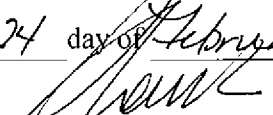
This 24 day of February, 20 09

Notary Public in and for said County and State

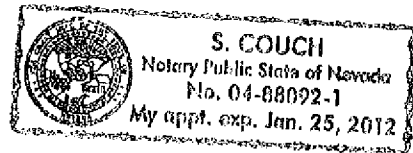

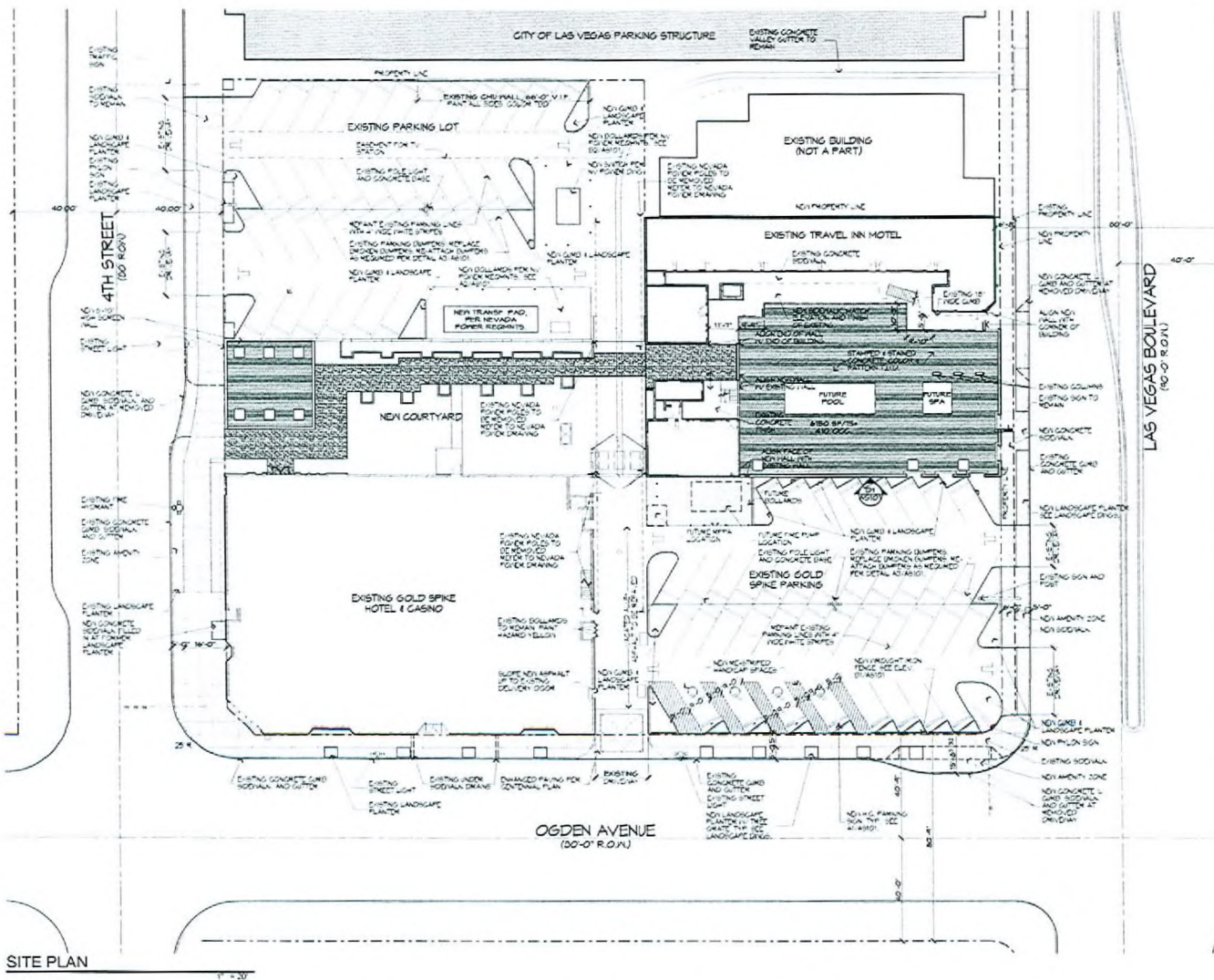

VICINITY & LOCATION MAPS

Site and Project Information

SITE DATA		
PARCEL NUMBER		09-34-501-014 09-34-510-014 09-34-511-013 09-34-512-015 09-34-518-040
JURISDICTION		CITY OF LAS VEGAS - 8191
EXISTING GENERAL PLAN		CC
EXISTING ZONING		C2
PROPOSED USE		CASINO/HOTEL
SITE AREA		52.128 ACRES 1.44 NET ACRES
SETBACKS (BUILDING)		
FRONT	REQUIRED 0' 0"	PROVIDED 0' 0"
REAR	REQUIRED 0' 0"	PROVIDED 0' 0"
MAX HEIGHT		
ACTUAL HEIGHT		82' 0"
LOT COVERAGE ALLOWED		
ACTUAL LOT COVERAGE		26%
BUILDING INFORMATION		
BUILDING AREAS		57,827 SF
HOTEL ROOMS (GOLD SPIKE FLOORS 2-7, TRAVEL INN 1-3)		13,966 SF
CASINO (EXISTING)		8,331 SF
POOL COURTYARD		4,488 SF
RECREATIONAL DECK/FITNESS		8,752 SF
TOTAL SQUARE FOOTAGE		35,547 SF
PARKING AREA		
BUILDING AREA		PROVIDED
HOTEL ROOMS	REQUIRED PARKING 178 ROOMS @ 1.1 ROOM = 195	
CASINO	13,966 SF @ 1.180 SF = 155	
STANDARD PARKING SPACES PROVIDED		350
HANDICAPPED SPACES PROVIDED		4
TOTAL PARKING		354

SITE PLAN 1" = 20'

Copyright © 2009 by APTUS Architecture
APTUS Architecture
 1380 South 4th Street
 Suite 200
 Las Vegas, Nevada 89104
 P 702.251.1200
 F 702.251.1211



Gold Spike Hotel & Casino
 Review of Condition
 400 E. Ogden Avenue
 Las Vegas, Nevada 89101

ROC-33625
04/09/09 PC

RECEIVED
 FEB 25 2009

Review of Condition Submittal 03.25.09

SITE PLAN
AS100

01.178 Gold Spike Hotel & Casino

TREE LEGEND

BOTANICAL NAME	COMMON NAME	SIZE
	EXISTING TREE	N/A
	EXISTING PALMS	3.74
	WASHINGTONIA ROBUSTA	HOOGAN FAN PALM
	GUEROUS FUSIFORMIS	TEXAS LIVE OAK
	TRINUS LANCEA	AFRICAN SUMAC
	CALEDONIA DECIPENS	JAPANESE BLUEBERRY

SHRUB PLANT LEGEND

BOTANICAL NAME	COMMON NAME	SIZE
	BANKSIA	15 GAL.
	HYMENOCAS ACHALE	ANGELITA BABY
	PITTIOSPORUM TOBIER	MOCK ORANGE
	CASSIA NODIPHILA	DESERT CASSIA
	MILLENBERGIA RIGIDA	DEER GRASS
	LEUCOPHYLLUM FRUCTICOSUM	TEXAS RANGER
	ROSA BANKSIAE	LADY BANKS ROSE
	LANTANA X	LANTANA
	ARTIFICIAL TURF	
	TREE GRATE W/ ROOT BARRIER	HOOGAN FAN PALM, 3.74

4TH STREET
(50'-0" R.O.W.)

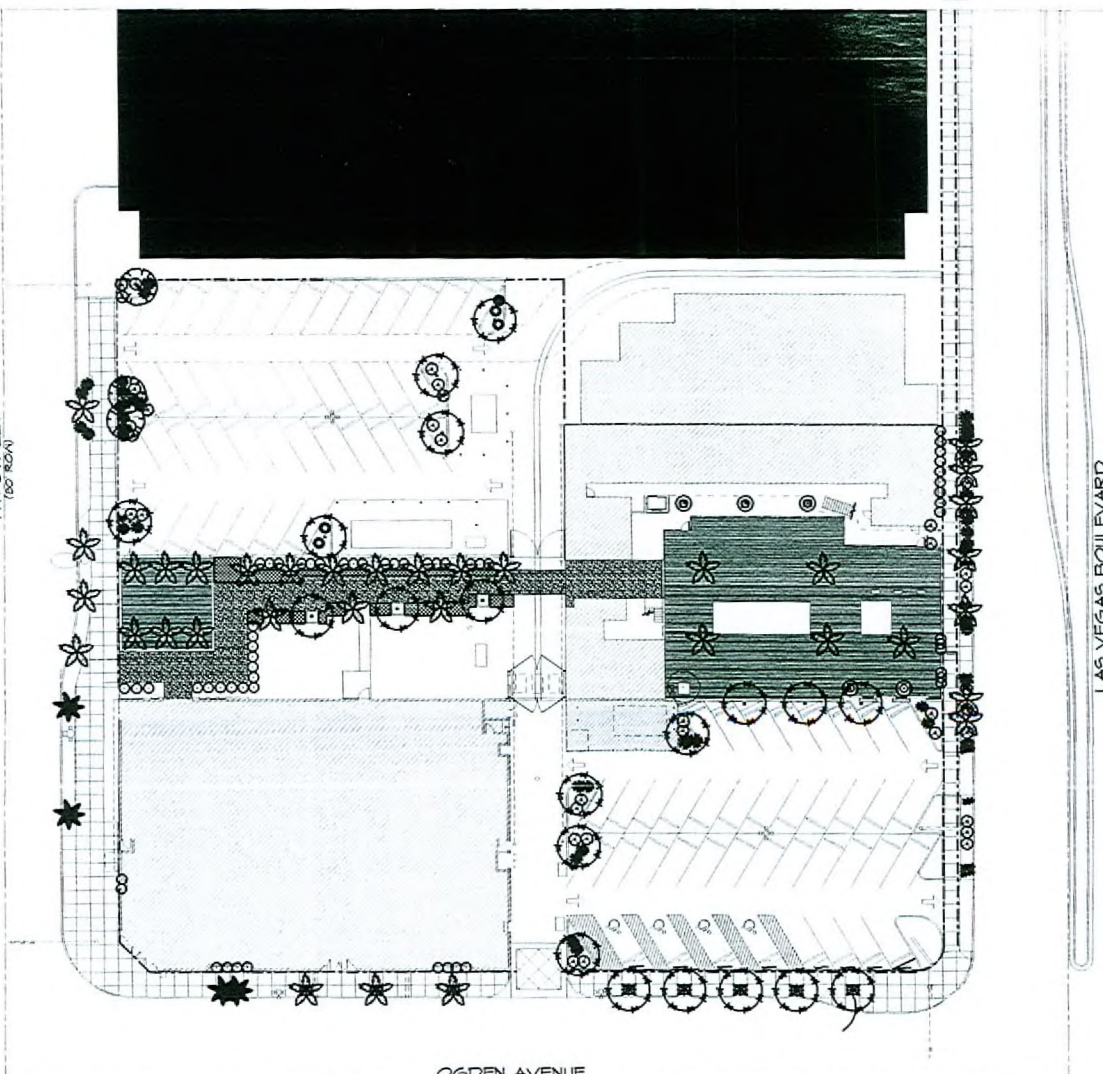

OGDEN AVENUE
(50'-0" R.O.W.)

LAS VEGAS BOULEVARD
(50'-0" R.O.W.)



MOON-SUN LANDSCAPES
2020 E. TROPICANA AVENUE
SUITE 100-205
LAS VEGAS, NV 89119
702-735-1111
702-735-1112

ARTIST & DESIGNER
**GOLDSPIKE CASINO
LAS VEGAS AND OGDEN**

CLIENT
**LANDSCAPE PLAN
SIEGEL GROUP**

DATE
AJM

SCALE
1" = 20'-0"

PROJECT #
C-5469

SHEET #
1 OF 1

DATE
02.25.09

REV
0

CADD FILE: GOLDSPIKE TRAVEL INN

ROC-33625
04/09/09 PC

RECEIVED

FEB 25 2009