



**PLANNING & DEVELOPMENT DEPARTMENT**

**STATEMENT OF FINANCIAL INTEREST**

Case Number: **SUP-32816** APN: 163-04-405-003

Name of Property Owner: Robbie Auto

Name of Applicant: Clearwire US, LLC

Name of Representative: WFI, Kim Wood

To the best of your knowledge, does the Mayor or any member of the City Council or Planning Commission have any financial interest in this or any other property with the property owner, applicant, the property owner or applicant's general or limited partners, or an officer of their corporation or limited liability company?

Yes

No

If yes, please indicate the member of the City Council or Planning Commission who is involved and list the name(s) of the person or persons with whom the City Official holds an interest. Also list the Assessor's Parcel Number if the property in which the interest is held is different from the case parcel.

City Official: \_\_\_\_\_

Partner(s): \_\_\_\_\_

APN: \_\_\_\_\_

Signature of Property Owner: [Handwritten Signature]

Print Name: Robert Handal

Subscribed and sworn before me

This 23rd day of December, 20 08

[Handwritten Signature]

Notary Public in and for said County and State  
Clark Nevada

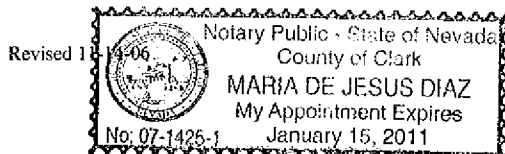

# clearwire® U.S., LLC

## NV-LSV102i AUTO TECH

8550 WEST SAHARA AVE.  
LAS VEGAS, NEVADA 89117  
APN#163-044-05-003

RECEIVED  
DEC 30 2008

clearwire®  
U.S. LLC  
1051 MARY CREST RD.  
SUITE K HENDERSON, NV  
89074

NV-LSV102i

8550 WEST SAHARA AVE.  
LAS VEGAS, NEVADA 89117  
JURISDICTION: CITY OF LAS VEGAS

PROPERTY PROFILE  
1041 E. CARLISE RD.  
PHOENIX, AZ, 85086  
OFFICE: 623-455-9675

### CONSULTANT TEAM

**CLIENT:**  
CLEARWIRE US LLC  
4400 CARLSON POINT  
KOROLAND, WA 98033

**APPLICANT REPRESENTATIVE**  
WIRELESS FACILITIES INCORPORATED  
7030 SMOKE RANCH RD. SUITE B  
LAS VEGAS, NV 89128  
CONTACT: KIM WOOD  
EMAIL: KIM.WOOD@WFNET.COM  
PHONE: 505-250-8237

**DESIGN SERVICES:**  
PROPERTY PROFILE  
1041 EAST CARLISE RD.  
PHOENIX, AZ, 85086  
CONTACT: KIM WOOD  
EMAIL: KIM.WOOD@WFNET.COM  
PHONE: (623) 455-9675 CELL: (602) 821-7220

**ELECTRICAL:**  
APEX CONSULTING  
8000 SOUTH EASTERN AVE SUITE 80  
LAS VEGAS, NV 89119  
CONTACT: KAREN FAYTARA  
PHONE: (702) 968-8221 FAX: (702) 851-7588

**CONSTRUCTION MANAGER:**  
7030 SMOKE RANCH RD. SUITE B  
LAS VEGAS, NV 89128  
CONTACT: BOB BRON  
E-MAIL: BOB.BRON@clearwire.com  
PHONE: (702) 588-2901

**POWER:**  
NEVADA POWER COMPANY  
(702) 957-4300

### SCALE

THE SCALES SHOWN WITHIN OR ON EACH DRAWING ARE FOR A FULL  
SIZE DRAWING ONLY (11x17). IF PLOTTED SMALLER OR LARGER  
PLEASE USE THE BAR SCALE AS THE REFERENCE

### APPROVED FABRICATOR

THE FABRICATED STEEL COMPONENTS SHOWN IN DETAILS ARE  
MANUFACTURED BY ANDREW CORPORATION.  
ANDREW CORPORATION IS AN AISC CERTIFIED FABRICATOR FOR  
STANDARD STEEL BUILDING STRUCTURES

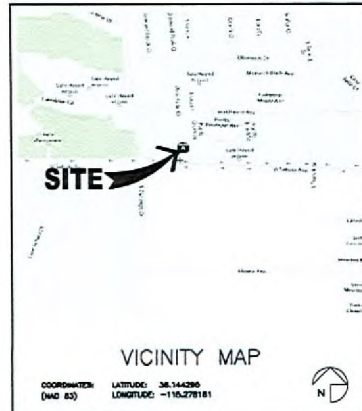

### DRIVING DIRECTIONS

FROM OUR OFFICE LOCATED AT 1051 MARY CREST ROAD SUITE K, HENDERSON, NEVADA 89074, GO EAST ON MARY CREST RD TOWARD W GIBSON RD, TURN RIGHT ONTO W GIBSON RD, TURN RIGHT ONTO W-215 W, TAKE EXIT #155/RAINBOW BLVD, TURN NORTH ON RAINBOW BLVD, TURN LEFT ON WEST SAHARA AVE, ARRIVE AT 8550 WEST SAHARA AVE, LAS VEGAS, 89117

### ACCESSIBILITY DISCLAIMER

THIS PROPOSED PROJECT IS AN UNOCCUPIED TELECOMMUNICATIONS FACILITY AND IS NOT TO BE ACCESSIBLE BY THE GENERAL PUBLIC. THIS FACILITY IS DESIGNED FROM DISABLED ACCESS REQUIREMENTS FOR IBC 1103.3.1 LISTED AS AN EQUIPMENT SPACE.

### PROJECT SUMMARY

**SITE NAME:** AUTO TECH  
**SITE NUMBER:** NV-LSV102i  
**SITE ADDRESS:** 8550 WEST SAHARA AVE, LAS VEGAS, NEVADA 89147

**APPLICANT:** CLEARWIRE US LLC  
4400 CARLSON POINT  
KOROLAND, WA 98033  
CONTACT: KIM WOOD  
EMAIL: KIM.WOOD@WFNET.COM  
PHONE: 505-250-8237

**TOWER OWNER:** CLEARWIRE US LLC  
CONTACT: ALEX F. BLASSCHKE  
PHONE: 702-273-0800

**PROJECT DESCRIPTION SUMMARY:**  
-THE INSTALLATION OF NEW OUTDOOR BTS CABINET LOCATED ON A CONCRETE PAD AND 7' FLAGPOLE (DESIGNED BY OTHERS) AT GRADE.  
-INSTALLATION OF ANTENNAS, DAP HEADS AND MICROWAVE DISHES ATOP STRUCTURE INSIDE POLE.  
-INSTALLATION OF 1 GPS ANTENNA.

**LAND USE DATA:**  
**ASSESSORS PARCEL NUMBER:** 163-044-05-003  
**CURRENT ZONING:** LIMITED COMMERCIAL (C-1)  
**BUILDING CLASSIFICATION:**  
**PROPOSED AREA OF CONSTRUCTION:** 10x16= 160 SQ. FT.  
**PROJECT OCCUPANCY:** U-POLE  
**TYPE OF CONSTRUCTION:** ISB  
**POWER COMPANY:** NEVADA POWER  
**DESCRIPTION:** TO (C) POWER POLE AT STREET

### SPECIAL INSPECTIONS

THE INSTALLATION OF AXES HIGH STRENGTH BOLTS, NUTS & WASHERS SHALL BE PERIODICALLY INSPECTED IN ACCORDANCE WITH AISC SPECIFICATIONS AS REQUIRED BY THE 2005 IBC, SECTION 1704.3.3  
BOLTS ARE REQUIRED TO BE TIGHTENED TO A "SHAG-TIGHT" CONDITION  
FABRICATOR CERTIFICATE FOR ANTENNA HARDWARE

### SHEET SCHEDULE

SHT NO.	SHEET DESCRIPTION	REV.
Z-1	TITLE SHEET	0
Z-2	SITE PLAN AND ELEVATION	0

### APPLICABLE CODES

JURISDICTION: CITY OF LAS VEGAS  
INTERNATIONAL BUILDING CODE (IBC) 2006 EDITION  
WITH NEVADA STATE AMENDMENTS  
NATIONAL ELECTRIC CODE (NEC) 2008 EDITION  
UNIFORM MECHANICAL CODE (UMC) 2008 EDITION  
UNIFORM PLUMBING CODE (UPC) 2008 EDITION  
UNIFORM FIRE CODE (UFC) 2006 EDITION  
ANSI/TIA-222-F STANDARDS FOR BROADCAST STRUCTURES  
LOCAL CODES AND ORDINANCES  
IN THE EVENT OF A CONFLICT, THE MOST RESTRICTIVE CODE SHALL PREVAIL

### APPROVALS

PROPERTY OWNER/LANDLORD	DATE
ZONING	DATE
CLEARWIRE R.F. ENGINEER	DATE
CLEARWIRE INTER CONNECT	DATE
CLEARWIRE CONSTRUCTION	DATE
CLEARWIRE BACKHAUL	DATE

### SCHEDULE OF REVISIONS

NO.	DATE	DESCRIPTION OF CHANGES
7	--	--
6	--	--
5	--	--
4	--	--
3	--	--
2	--	--
1	--	--

06/23/08 ZONING DRAWINGS  
DATE DESCRIPTION OF CHANGES  
DRAWN BY: RH    CHECKED BY: RH  
SCALE: SEE SHEET

### ENGINEERING SEAL:

### ZONING DRAWINGS

THIS INFORMATION CONTAINED WITHIN THIS SET OF DOCUMENTS/DRAWINGS IS PROPRIETARY TO CLEARWIRE. ANY USE OR DISCLOSURE OTHER THAN THAT WHICH RELATES TO THE CLIENT SHALL BE STRICTLY PROHIBITED

### DRAWING TITLE:

### TITLE SHEET

### DRAWING SHEET:

# Z-1

SUP-32816  
02/12/09 PC

