

Summary

Land	18.73 AC	815,323 SF
Building Area		211,606 SF
20% Open Space Req'd		163,000 SF
Open Space Provided		163,573 SF
Plaza Area Req'd		950 SF
Plaza Area Provided		990 SF
Land-to-Bldg Ratio		3.88/1
Coverage		25.87%
Retail Shops 'A-E'		65,293 SF
Sportman Warehouse		55,465 SF
24 Hr Fitness Center		44,933 SF
Fresh & Easy Market		13,915 SF
Sub Total Shopping Ctr		179,606 SF
Existing Office		32,000 SF
Total Building Area		211,606 SF

PARKING BY CODE REQUIREMENTS:

CODE REQUIRED:			
SHOPPING CENTER	174,800sf	1/250	711 SPACES
EXISTING OFFICE	32,000sf	1/300	106 SPACES
TOTAL REQUIRED			817 SPACES

PARKING BY USE:

EXISTING OFFICE	32,000sf	1/300	106 SPACES
24 HR FITNESS	44,933sf	1/200	224 SPACES
SPORTSMAN P.H.	55,465sf	1/250	222 SPACES
FRESH & EASY MARKET	13,915sf	1/250	56 SPACES
RETAIL 'A'	12,427sf	1/250	50 SPACES
RETAIL 'B'	15,871sf	1/250	63 SPACES
RETAIL 'C'	3,419sf	1/250	14 SPACES
RETAIL 'D'	25,294sf	1/250	101 SPACES
RETAIL 'E'	3,041sf	1/250	12 SPACES
TOTAL REQUIRED			567 SPACES
TOTAL PROVIDED:			880
H.G. REQUIRED (2%)			20 (4 VAN)
H.G. PROVIDED			24 (6 VAN)



Vicinity Map
 Not to Scale
 ALL NEIGHBORHOODS, THEIR OCCUPANTS AND THE USES AS SHOWN ON THIS PLAN ARE PRESUMED AND SUBJECT TO MODIFICATION AT THE OWNER'S DISCRETION WITHOUT NOTICE.
 THE PRELIMINARY SITE PLAN IS BASED ON REPRESENTATIONS PROVIDED TO TERRITORY ARCHITECTS INCORPORATED, LLP AND IS SUBJECT TO VERIFICATION BY LEGAL, SURVEY AND ENGINEERING AGENCIES ETC. THIS PLAN IS NOT NEARLY AS A REPRESENTATION AS TO EXISTENCE, TYPE, SIZE, LOCATION, TIME OR OCCUPANCY OF ANY BUILDING WITHIN THE DISTRICT.

SITE PLAN
CENTENNIAL GATEWAY phase II
LAS VEGAS, NEVADA

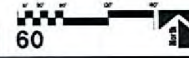

DATE: JANUARY 24, 2009
 MADEL J02 -
 MADEL ARCHITECTS RETAIL, LLP
 7700 S. DEAN MARTIN DR., SUITE 600
 LAS VEGAS, NV 89119
 T.702.258.3000 F.702.258.7170
 WWW.MADELARCH.COM



SUP-33491
04/09/09 PC

RECEIVED
FEB 17 2009

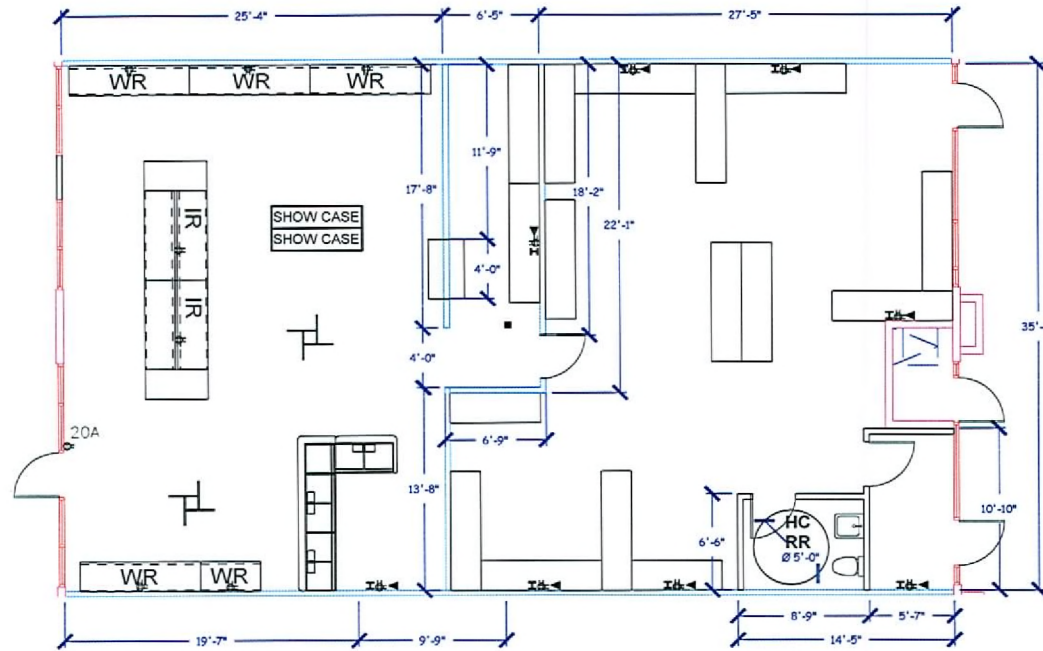

RECEIVED
FEB 17 2009

H

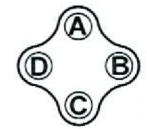

FIXTURE LAYOUT
Scale: 1/8" = 1'-0"

- I = Internet Jack
 - ☎ = Telephone Jack
 - ⊞ = Quad Electrical Jack
 - ⊞ = Duplex Electrical Jack
- 20A



Laptop X change # LX10004
Duluth, MN
Michael Smith

designed environments, inc.
421 benson ave SE
willmar mn 56201
320.235.0852
320.235.3321 fax

Designer: Derrick Cruze
Drawn By: DAC

Date: 2.5.09
Store # 1004

Revised
Revised

F1

SUP-33491
04/09/09 PC