



**PLANNING & DEVELOPMENT DEPARTMENT**

**STATEMENT OF FINANCIAL INTEREST**

Case Number: SDR-29787 APN: 138-12-110-015

Name of Property Owner: Larry D. & Nerissa L. Thomas

Name of Applicant: Nerissa L. Thomas

Name of Representative: \_\_\_\_\_

To the best of your knowledge, does the Mayor or any member of the City Council or Planning Commission have any financial interest in this or any other property with the property owner, applicant, the property owner or applicant's general or limited partners, or an officer of their corporation or limited liability company?

Yes

No

If yes, please indicate the member of the City Council or Planning Commission who is involved and list the name(s) of the person or persons with whom the City Official holds an interest. Also list the Assessor's Parcel Number if the property in which the interest is held is different from the case parcel.

City Official: \_\_\_\_\_

Partner(s): \_\_\_\_\_

APN: \_\_\_\_\_

Signature of Property Owner: Nerissa L. Thomas

Print Name: Nerissa L. Thomas

Subscribed and sworn before me

This 2 day of September, 2008

Katherine E. Brann  
Notary Public in and for said County and State



# THOMAS AUTOMOTIVE INC.

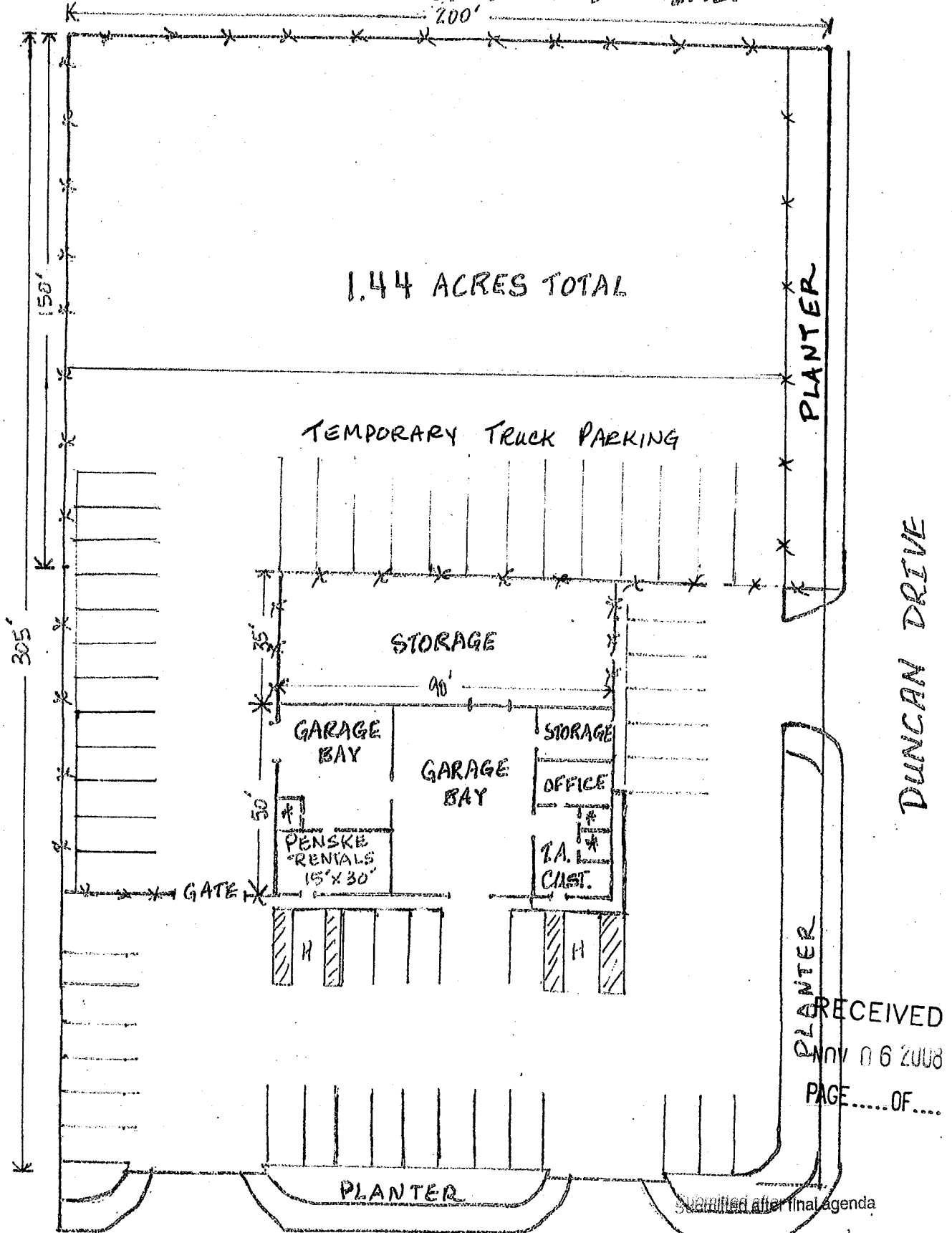

SDR-29787  
REVISED  
11/20/08 PC

RANCHO DRIVE

Submitted after final agenda  
Date 11/20/08 Item 27+28  
\* RESTROOMS  
SCALE: 1" = 36'

RECEIVED  
NOV 16 2008  
PAGE.....OF.....

# Thomas Automotive Inc.





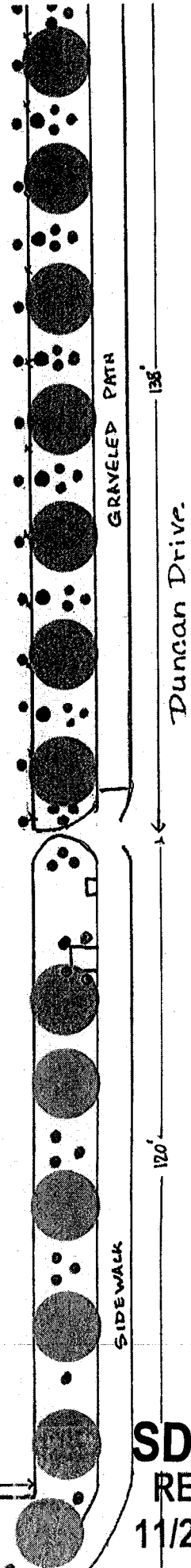

## Landscaping Proposal

11/06/08

1. Install new drip irrigation
2. Plant 12 more 24" box trees (18 total) and 65 more plants (72 total)
3. All planter beds to receive 2" deep of 3/4" decorative rock.
4. Move chainlink fence on Duncan to NW side of new planter.
5. Remove all native plants and grasses from unimproved portion (sidewalk area) of Duncan, grade and level, install 1/2" - 3/4" rock 2" deep for path, install curbing on street side of path.



### Trees:

-  1. Pinus Elderica (Mondale Pine)
-  2. Quercus Virginiana (Heritage Oak)
-  3. Curve Leaf Yucca
-  4. Oleander
-  5. Dwarf Oleander (15gal.)
-  6. Red Yucca (5gal.)
-  7. Cat's Claw vine (5gal.)

Scale: 1" =  $\frac{24'}{15'}$   
 (only interior of planter is to scale)

Landscaper: Daryl Driscoll  
 Alliance Landscaping

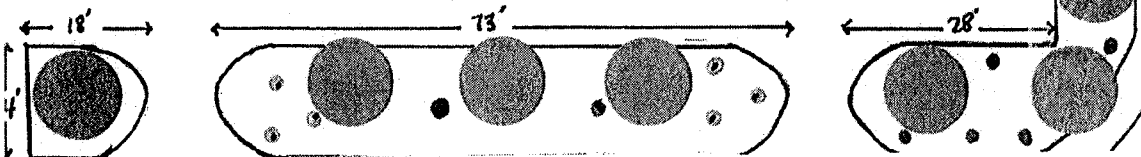

RECEIVED  
 NOV 06 2008  
 PAGE.....OF.....

**SDR-29787**  
 REVISED  
 11/20/08 PC

# SDR-29787

Pursuant to Title 19.10, the following parking standards apply:

Parking Requirement							
Use	Gross Floor Area or Number of Units	Parking Ratio	Required		Provided		Compliance
			Parking		Parking		
			Regular	Handi-capped	Regular	Handi-capped	
Automotive Repair Major	3,600 SF	5 spaces and 1 space per 200 SF	18	1	18	1	Y
Truck Rental	900 SF and 11 Trucks	1 per rental truck and 1 per 250 SF	16	1	20	1	Y
<b>SubTotal</b>			34	2	38	2	Y
<b>TOTAL</b> (including handicap)			36		40		Y

**RECEIVED**  
NOV 20 2008

Submitted after final agenda

Date 11/20/08 Item 28