



**PLANNING & DEVELOPMENT DEPARTMENT**

**STATEMENT OF FINANCIAL INTEREST**

Case Number: **RQR-30358** APN: 162-08-110-001

Name of Property Owner: Teddy Enterprises & Associates

Name of Applicant: Lamar Outdoor Advertising

Name of Representative: Same as applicant

To the best of your knowledge, does the Mayor or any member of the City Council or Planning Commission have any financial interest in this or any other property with the property owner, applicant, the property owner or applicant's general or limited partners, or an officer of their corporation or limited liability company?

Yes

No

If yes, please indicate the member of the City Council or Planning Commission who is involved and list the name(s) of the person or persons with whom the City Official holds an interest. Also list the Assessor's Parcel Number if the property in which the interest is held is different from the case parcel.

City Official: \_\_\_\_\_

Partner(s): \_\_\_\_\_

APN: \_\_\_\_\_

Signature of Property Owner: *Stephen A. Wong*

Print Name: Stephen A. Wong, General Manager

Subscribed and sworn before me

This 30<sup>th</sup> day of September, 2008

*[Signature]*  
Notary Public in and for said County and State





APN 162-05-402-009  
(ZONED C-1)

APN 162-05-402-010  
(ZONED C-1)

APN 162-05-402-011  
(ZONED C-1)

SAHARA AVE.

centerline

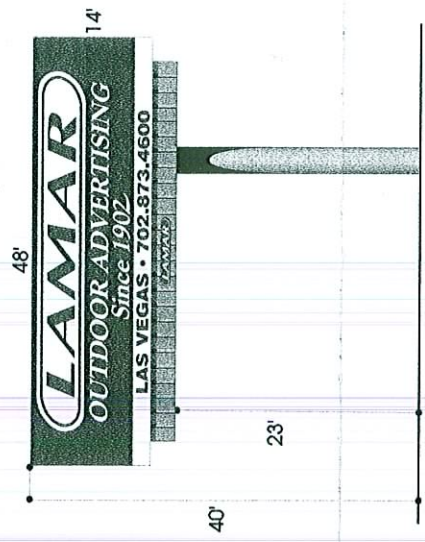
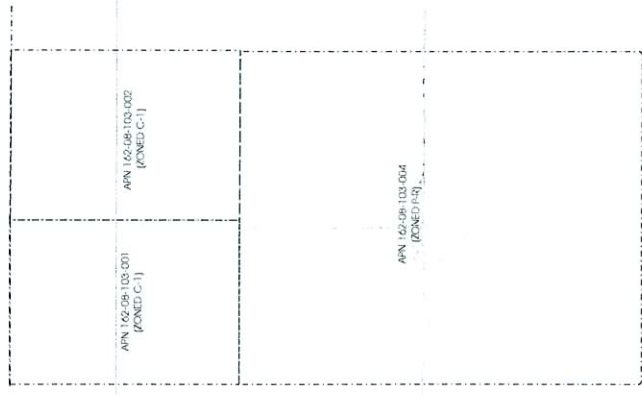
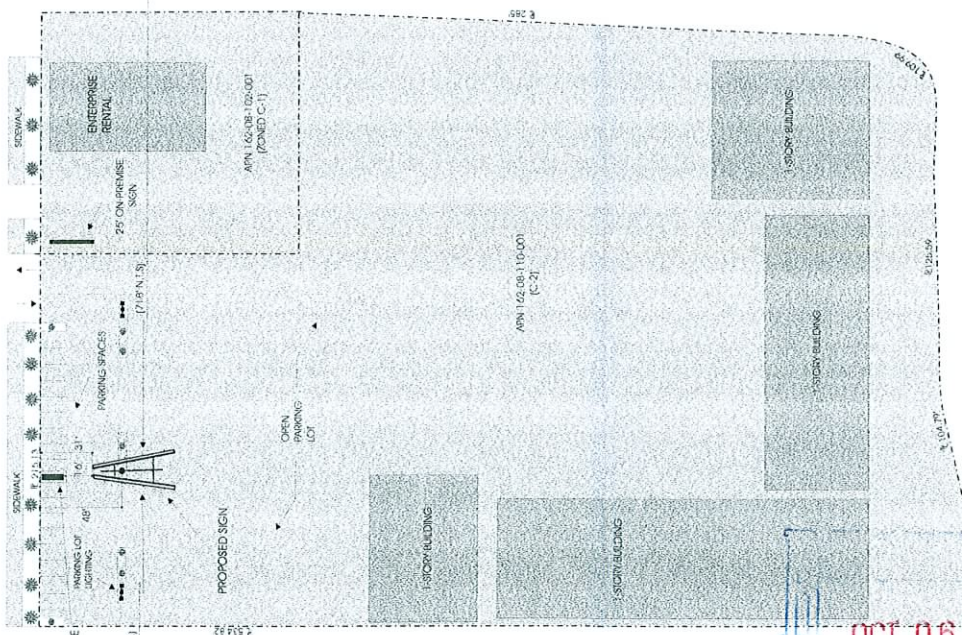

ELEVATION (NO SCALE)

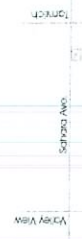
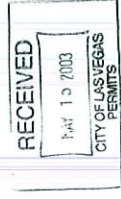

VICINITY MAP (NO SCALE)

**RQR-30358**

**11/20/08 PC**

LAMAR OUTDOOR ADVERTISING

SCALE: 1" = 50" DATE: 11/22/02 DRAWN BY: S. NAFTZGER

TEDDY ENTERPRISES, WEST SAHARA

APN 162-08-110-001 DRAWING NUMBER: 3421SAHARA

1 2293 03

APPROVED  
 BY: *Bill Howard*  
 CURREY PLANNING DIVISION  
 CITY OF LAS VEGAS

**DECLARATION**

NO OFF-PREMISE SIGN WITHIN 300'  
 NOT WITHIN 300' OF RESIDENTIAL USE  
 NOT WITHIN 100' OF ON-PREMISE SIGN ON ADJACENT PROPERTY

6002 9 0 100