



**PLANNING & DEVELOPMENT DEPARTMENT**

**STATEMENT OF FINANCIAL INTEREST**

Case Number: **EOT-31320** APN: 125-28-713-006

Name of Property Owner: Centennial Center LLC

Name of Applicant: Territory Inc

Name of Representative: Jeanna Gaitan

To the best of your knowledge, does the Mayor or any member of the City Council or Planning Commission have any financial interest in this or any other property with the property owner, applicant, the property owner or applicant's general or limited partners, or an officer of their corporation or limited liability company?

Yes

No

If yes, please indicate the member of the City Council or Planning Commission who is involved and list the name(s) of the person or persons with whom the City Official holds an interest. Also list the Assessor's Parcel Number if the property in which the interest is held is different from the case parcel.

City Official: \_\_\_\_\_

Partner(s): \_\_\_\_\_

APN: \_\_\_\_\_

Signature of Property Owner: \_\_\_\_\_

Print Name: ROLAND V. STURM

Subscribed and sworn before me

This 21<sup>st</sup> day of OCTOBER, 2008

Kathleen P. Burns  
CLERK

Notary Public in and for said County and State of NEVADA

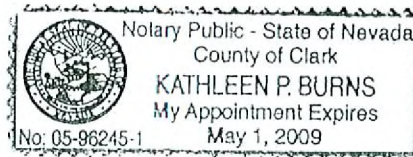

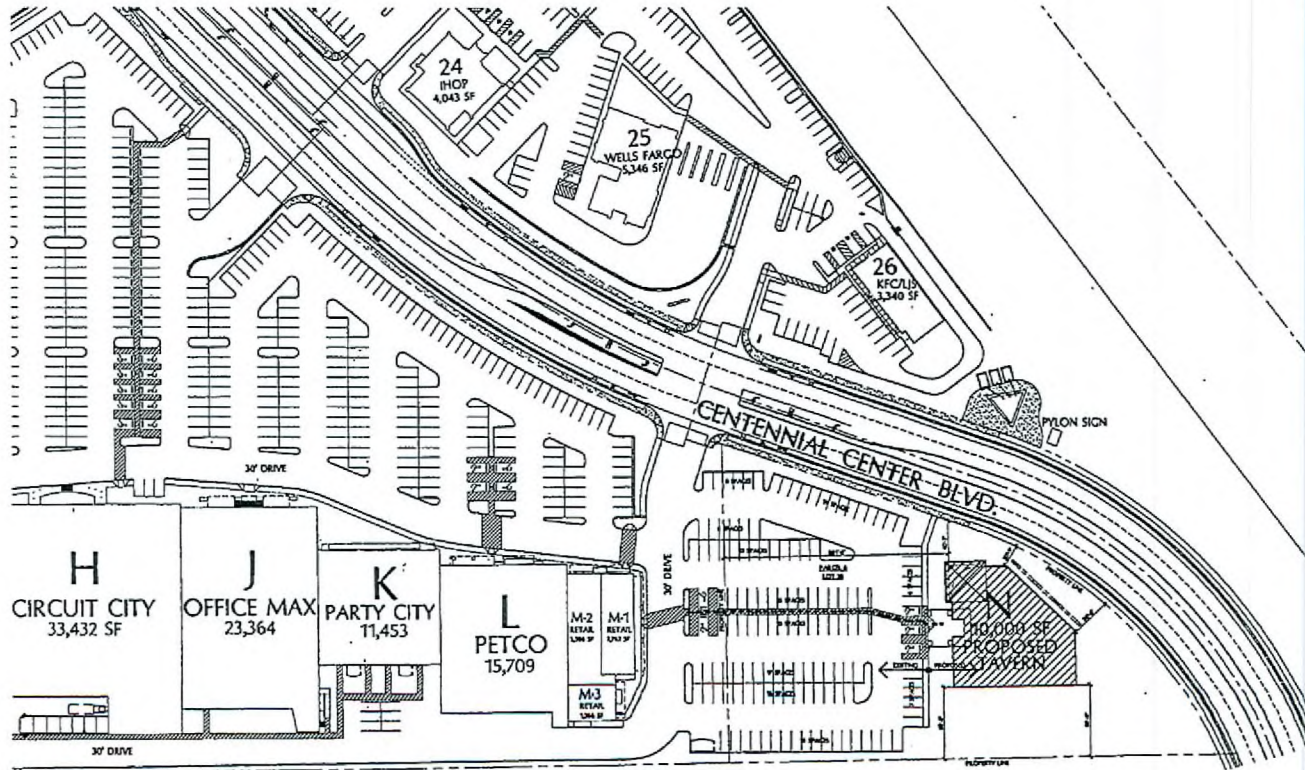

GENERAL DATA	
ZONING:	M-3 COMMERCIAL
PARCEL NUMBER:	8
LOT:	99
LAND AREA:	1.81 ACRES
REQUIREMENTS:	REQUIRED: 8,000 SF PUBLIC AREA (100 - 100 SPACES) 2,000 SF RETAIL (100 - 20 SPACES) TOTAL: 10,000 SF (100 - 120 SPACES) PROVIDED: 133 SPACES 8 HANDICAPPED SPACES



FUTURE RECREATIONAL SITE

DATE: 10/1/08  
 800 JOB #: 08-001-01  
 DATE: 10/23/08

© 2008 ARCHITECT'S NEW ALL RIGHTS RESERVED  
 NOTE: This document is prepared to submit work to submit to the City of Las Vegas for review and approval. It is not to be used for any other purpose without the written consent of the architect.

SITE PLAN

Scale: 1" = 40'-0"



THIS INFORMATION IS CONFIDENTIAL AND IS SUBJECT TO AGREEMENTS REGARDING FUTURE DEVELOPMENT AND IS NOT TO BE DISCLOSED TO ANY OTHER PARTY WITHOUT THE WRITTEN CONSENT OF THE ARCHITECT.

CENTENNIAL CENTRE - PAD 'N'

HIGHWAY 95 & TROPICAL PARKWAY  
 LAS VEGAS, NEVADA  
 A PROJECT FOR:  
 CENTENNIAL CENTRE, LLC  
 7448 WEST SAHARA AVENUE  
 LAS VEGAS, NEVADA 89117  
 702.222.1402

RECEIVED  
 OCT 21 2008  
 City of Las Vegas, Nevada 89119  
 Planning Department 257 702.251.8990  
 Project # 1001000001



EOT-31320  
 12-03-08 CC



