



PLANNING & DEVELOPMENT DEPARTMENT

STATEMENT OF FINANCIAL INTEREST

Case Number: EOT-31316 APN: 125-28-713-006

Name of Property Owner: Centennial Center LLC

Name of Applicant: Territory Inc

Name of Representative: Jeanna Gaitan

To the best of your knowledge, does the Mayor or any member of the City Council or Planning Commission have any financial interest in this or any other property with the property owner, applicant, the property owner or applicant's general or limited partners, or an officer of their corporation or limited liability company?

Yes

No

If yes, please indicate the member of the City Council or Planning Commission who is involved and list the name(s) of the person or persons with whom the City Official holds an interest. Also list the Assessor's Parcel Number if the property in which the interest is held is different from the case parcel.

City Official: _____

Partner(s): _____

APN: _____

Signature of Property Owner: [Handwritten Signature]

Print Name: ROLAND V. STURM

Subscribed and sworn before me

This 21st day of OCTOBER, 2008

Kathleen P Burns
CLARK

Notary Public in and for said County and State of NEVADA.



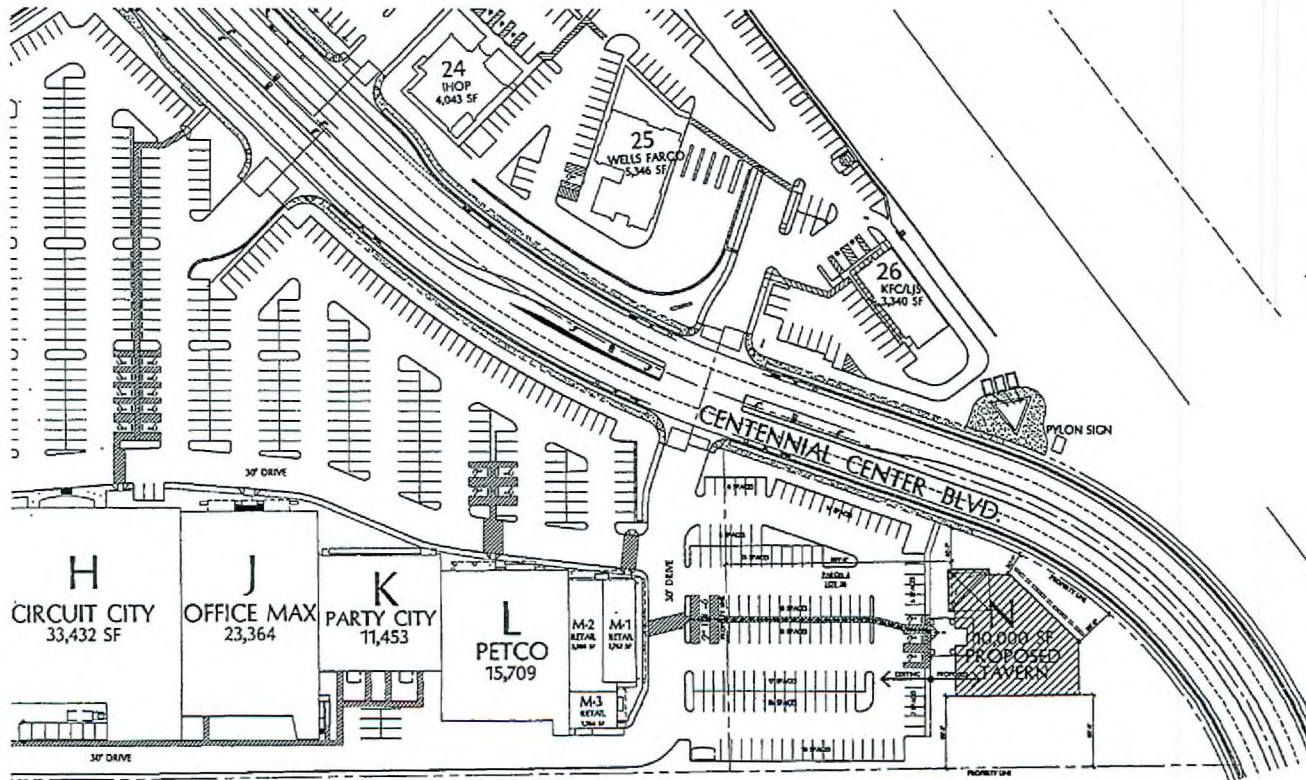

GENERAL DATA

ZONING: U-3 COMMERCIAL

PARCEL NUMBER: 4

USE: PS

LAND AREA: 1.31 ACRES

REQUIREMENTS:
 8,000 SF PUBLIC AREA / 100 = 100 SPACES
 8,000 SF REMAINING / 225 = 35 SPACES
TOTAL: 135 SPACES & 8 HANDICAPPED
PROPOSED:
 135 SPACES
 8 HANDICAPPED SPACES



FUTURE RECREATIONAL SITE

CENTENNIAL CENTRE - PAD 'N'

DATE: 10/1/05
 MCO JOB #: 04 858 01
 DATE: REVISIONS

SITE PLAN

Scale: 1" = 40'-0"



THIS INFORMATION IS CONCEPTUAL AND IS SUBJECT TO ALL APPLICABLE FEDERAL, STATE, COUNTY AND LOCAL REGULATIONS AND ORDINANCES. THE ARCHITECT ASSUMES NO LIABILITY FOR ANY ERRORS OR OMISSIONS OR FOR ANY CONSEQUENCES ARISING FROM THE USE OF THIS INFORMATION.

© 2005 ARCHITECTS BUCKLE. ALL RIGHTS RESERVED. THIS DRAWING IS THE PROPERTY OF ARCHITECTS BUCKLE AND IS NOT TO BE REPRODUCED OR TRANSMITTED IN ANY FORM OR BY ANY MEANS, ELECTRONIC OR MECHANICAL, INCLUDING PHOTOCOPYING, RECORDING, OR BY ANY INFORMATION STORAGE AND RETRIEVAL SYSTEM, WITHOUT THE WRITTEN PERMISSION OF ARCHITECTS BUCKLE.

HIGHWAY 95 & TROPICAL PARKWAY
 LAS VEGAS, NEVADA
 A PROJECT FOR:
CENTENNIAL CENTRE, LLC
 7448 WEST SAHARA AVENUE
 LAS VEGAS, NEVADA 89117
 702.222.1402

205 East Warm Springs Road, Suite 100
 Las Vegas, Nevada 89118
 © 702.731.8582 © 702.731.8558
 mcg@archibuckle.com

EOT-31316
12-03-08 CC



