

5310 W SAHARA AVE  
LAS VEGAS NV 89146

BUILDING SETBACKS

22 ft. from W. Sahara Ave.  
69 ft. from Potosi St.

PARKING

- 57 Available Spaces
- 48 Standard
  - 9 Customers Only
  - 0 Compact
  - 0 Handicap

ACCESSIBILITY

- 1 Handicap Ramp  
(In front of Suite D)

ADJACENT LAND USE

North:

- Athletic Club Parking
- Ronald McDonald House
- Residential
- O'Bannon Drive

South:

- W. Sahara Avenue
- Saturn of West Sahara

East:

- Potosi Street
- Las Vegas Athletic Club

West:

- Dental and Chiropractic  
Offices
- Mohawk Street

**RECEIVED**  
NOV - 4 2008

**SUP-31747**  
**12/18/08 PC**



5310 W SAHARA AVE STE A  
LAS VEGAS NV 89146

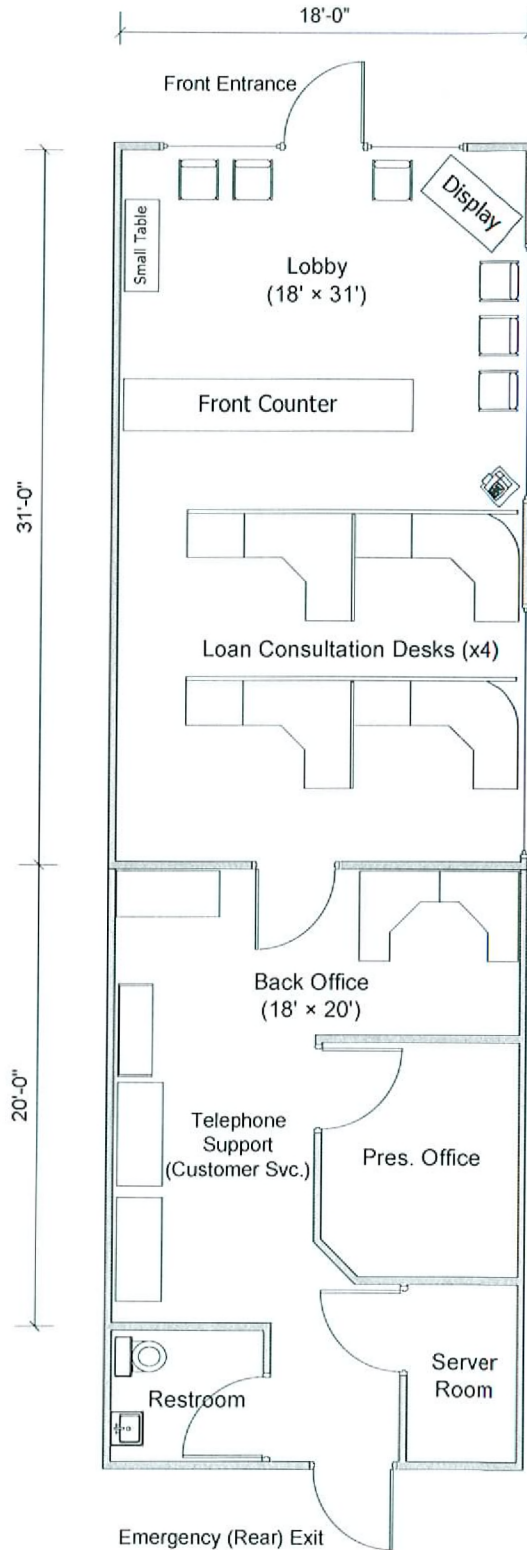

**RECEIVED**  
NOV - 4 2008

**SUP-31747**  
**12/18/08 PC**