

**CONSTRUCTION NOTES:**

- 1) INSTALL "L" TYPE CURB & GUTTER  
DWG. NO. 218, PAGE NO. 27
- 2) INSTALL "A" TYPE ISLAND CURB  
DWG. NO. 219, PAGE NO. 25
- 3) INSTALL "C" CROSS GUTTER  
DWG. NO. 228, PAGE NO. 34
- 4) INSTALL 2" WIDE SIDEWALK DRAIN  
DWG. 236, PAGE NO. 42
- 5) CONSTRUCT PAVEMENT SECTION  
2" AC PAVEMENT, OVER 4" TYPE B  
SEE DETAIL (1) (2) (3) (4) (5)
- 6) PAINT STRIPE
- 7) INSTALL 6" THICK 3" WIDE  
CONCRETE GUTTER  
SEE DETAIL (2) (3) (4) (5)
- 8) INSTALL 6" THICK 4" WIDE  
CONCRETE GUTTER  
SEE DETAIL (2) (3) (4) (5)
- 9) CONSTRUCT 6" THICK CONCRETE SIDEWALK  
SEE PLAN FOR WIDTH
- 10) INSTALL SIDEWALK RAMP (EASE IN)  
DWG. 236, PAGE NO. 41 TO 41C,  
(DIMENSION 4'-8" IS 6'-6.5")
- 11) INSTALL PRECAST BUNNER BLOCK  
DWG. 236, PAGE NO. 44

NOTES:  
1. DIMENSIONS ARE TO BACK OF CURB OR TO CENTER OF PAINT.  
2. ADD 2000 FEET TO ALL PROPOSED SPOT SHOTS.

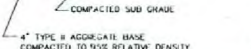

**EARTHWORK VOLUMES**  
 CUT 2,300 cu. yds.  
 FILL 150 cu. yds.

NOTE: THIS ESTIMATE OF EARTHWORK VOLUMES IS PROVIDED FOR INFORMATION ONLY AND SHOULD NOT BE USED FOR BIDDING PURPOSES. THESE TOTALS ARE RAW AND DO NOT ACCOUNT FOR SHRINKAGE AND SETTLEMENT.

**BENCH MARK**  
 CITY OF LAS VEGAS BENCH MARK IS 1/2 INCH 1/4" PLATE IN TOP OF CURB AT SOUTHEAST CORNER OF SHADOW LANE & PALMING STAMPPED 11/01/35/00  
 NAD83 DATUM METER: 6206.313  
 NAD83 DATUM FEET: 2054.83

**BASIS OF BEARING**  
 THE BASIS OF BEARINGS, S. 89°05'27" W., FOR THIS PROJECT WAS DETERMINED BY STATIC GLOBAL POSITIONING SYSTEM OBSERVATIONS REFERENCED TO THE WORLD GEODETIC REFERENCE SYSTEM OF 1984 (WGS 84) NORTH AMERICAN DATUM OF 1983 (NAD 83) SEE SHEET C-3 FOR STATION COORDINATES.

**RQR-32084**  
**12/18/08 PC**

I CERTIFY THAT THIS GRADING PLAN CONFORMS TO APPROVED DRAINAGE STUDY ON FILE WITH THE CITY OF LAS VEGAS

NAME: *Patrick Samuels* P.C. NO. 09383 EXP. DATE 6/30/09 DATE 6/18/08

Call before you dig  
 Call before you OVERHEAD

1-800-277-3600  
 1-702-593-8111

USE OF DOCUMENTS

NO.	DATE	BY	REVISION
1			
2			
3			
4			
5			
6			
7			
8			
9			
10			
11			
12			
13			
14			
15			
16			
17			
18			
19			
20			
21			
22			
23			
24			
25			
26			
27			
28			
29			
30			
31			
32			
33			
34			
35			
36			
37			
38			
39			
40			
41			
42			
43			
44			
45			
46			
47			
48			
49			
50			

REVISIONS

DESIGNED BY: [ ]  
 CHECKED BY: [ ]  
 DRAWN BY: [ ]  
 IN CHARGE: [ ]

PROJECT: Kennedy/Jenks Consultants  
 645 One Drive, Suite 300  
 Las Vegas, NV 89101  
 Phone: 702-270-3611, Fax: 702-270-3611

PREPARED FOR: LEO A. DALY  
 LAS VEGAS, NEVADA

UNIVERSITY MEDICAL CENTER  
 VALERIE STREET PARKING LOT - PHASE 2  
 GRADING PLAN

NO. C-7  
 12/18/08  
 DATE: JUN 2008  
 SHEET: C-7

**UMC  
TEMPORARY  
EMPLOYEE PARKING  
AT VALERIE STREET**

UNIVERSITY MEDICAL CENTER  
1830 CHARLESTON BLVD.  
LAS VEGAS, NEVADA 89102

**LEO A DALY**

3760 Flamingo Highway Parkway, Suite 603  
Las Vegas, Nevada 89109 USA  
Tel: 702.369.3267 Fax: 702.367.2262  
www.leoadaly.com

CIVIL:  
KENNEDY / JENAS Consultants, Inc.  
840 Glen Drive, Suite 300  
Las Vegas, Nevada 89119 USA  
Tel: 702.770.3910 Fax: 702.270.3611

REVISIONS

NO.	DATE	DESCRIPTION
1	5.5.03	PLANNING DEPARTMENT SUBMISSION
2	11.19.03	CIVIL REVIEW
3	02.14.04	ARCHITECTURAL SUBMITTAL

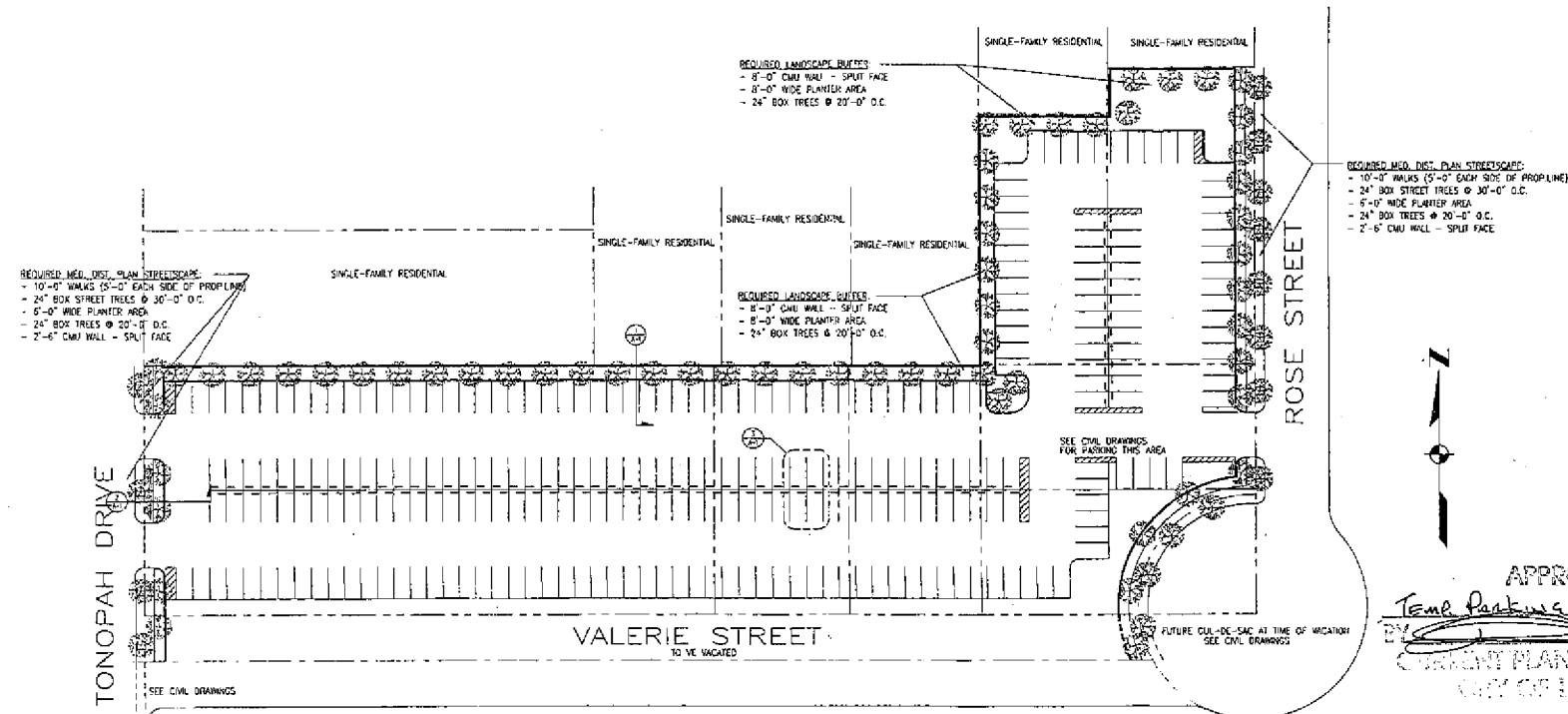

APPROVED  
Temp Parking not  
BY [Signature] 8/27/04  
CURRENT PLANNING DIVISION  
CITY OF LAS VEGAS

CAR COUNT  
APPROX. 268 CARS SHOWN  
ALL SPACES = 8'x18'  
ALL DRIVE ANGLES = 25'-0"

- NOTES:
- NO ACCESSIBLE PARKING PROVIDED
  - ASSESSOR'S PARCEL MAP: 135-33-3
  - LOT SIZE: APPROX. 2.4 ACRES
  - SEE LANDSCAPE DRAWINGS FOR PLANTING INFORMATION
  - PARKING LOT LIGHTING TO BE PER MEDICAL DISTRICT GUIDELINES (SHIELDED, SHOULDER BOX STYLE ON 20'-0" MAX POLES)
  - ADA ACCESSIBLE PARKING TO BE PROVIDED ADJACENT TO BUILDINGS THEY SERVE WITHIN THE OVERALL CAMPUS PARKING PLAN

APPROVED  
BY [Signature] 8/27/04  
CURRENT PLANNING DIVISION  
CITY OF LAS VEGAS

**PROPOSED SITE PLAN**  
SCALE: 1" = 30'-0"

APPROVED LANDSCAPING PLAN

[Signature] 8/27/04  
Planning & Development Department



Box No: 020802-01 Date: FEB. 18, 2005

PROPOSED SITE PLAN

A01

**RQR-32084  
12/18/08 PC**

DATA SUPPLIED BY LEO A DALY, INC. DATE: 11/18/08