



PLANNING & DEVELOPMENT DEPARTMENT

STATEMENT OF FINANCIAL INTEREST

Case Number: **VAR-29447** APN: 139-34-410-245

Name of Property Owner: Clark County Legal Services Program, Inc.

Name of Applicant: Clark County Legal Services Program, Inc.

Name of Representative: TERRY R. BRATTON

To the best of your knowledge, does the Mayor or any member of the City Council or Planning Commission have any financial interest in this or any other property with the property owner, applicant, the property owner or applicant's general or limited partners, or an officer of their corporation or limited liability company?

 Yes No

If yes, please indicate the member of the City Council or Planning Commission who is involved and list the name(s) of the person or persons with whom the City Official holds an interest. Also list the Assessor's Parcel Number if the property in which the interest is held is different from the case parcel.

City Official: _____

Partner(s): _____

APN: _____

Signature of Property Owner: [Signature]

Print Name: BARBARA BUCKLEY

Subscribed and sworn before me

This 8th day of August, 2008

[Signature]

Notary Public in and for said County and State



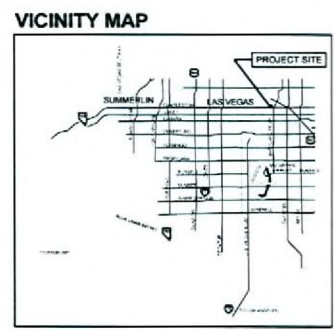
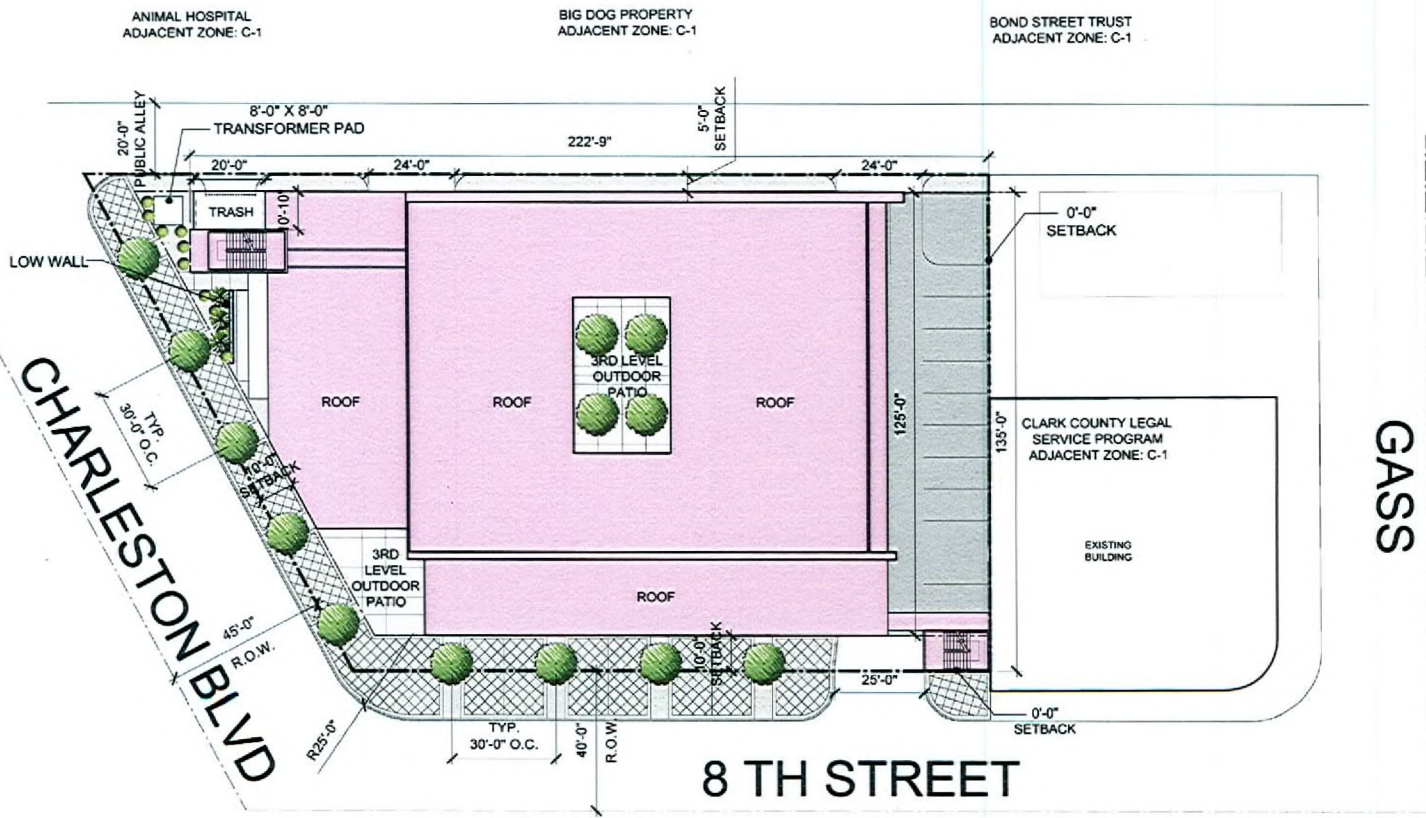

LANDSCAPE LEGEND

	NAME	SIZE	QUANTITY
	LANTANA MONTEVIDENSIS PURPLE TRAILING LANTANA	5 GAL	10
	DEGLLET-MOOR DATE PALM TREE	25 FT	3
	SOUTHERN LIVE OAK SHADE TREES	36" POT	15

SITE ANALYSIS:

SITE ACREAGE:	0.69 ACRES (PUD) 1.1 ACRES (C-1000)
A.P.N. #	136-34-410-245
CURRENT ZONING:	C-1
F.A.R. (FLOOR AREA RATIO)	0.81
LOT COVERAGE:	83%
BUILDING DATA:	
TOTAL GROSS BUILDING AREA:	38,000 SF
PARKING ANALYSIS:	
PARKING REQUIREMENT (CITY OF LAS VEGAS)	
OFFICE	
TOTAL PARKING REQUIRED (1 SPACE PER 300 SF @ 38,000 SF)	130 SPACES
TOTAL PARKING PROVIDED W/ 35.3% REDUCTION (INCLUDING 4 HANDICAP PARKING SPACES) (INCLUDING 25 COMPACT PARKING SPACES)	84 SPACES

RECEIVED
AUG 28 2008



Design
10150 Covington Cross Drive
Las Vegas, NV 89144
702.731.2033

CLARK COUNTY LEGAL SERVICES
Project #200707358
CITY OF LAS VEGAS

Site/ Landscape Plan DR-01

VAR-29446 VAR-29447
SDR-29445 REVISED
09/25/08 PC
NORTH
SCALE: 1/16" = 1'-0"