

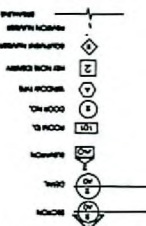

# outdoors @ at casino center & charleston

general notes

symbols



1. The building shall be constructed in accordance with the International Building Code, 2003 Edition, as amended, and all applicable local codes and ordinances. The building shall be designed to resist wind loads in accordance with ASCE 7-02, Minimum Design Loads and Associated Criteria for Buildings and Other Structures. The building shall be designed to resist seismic loads in accordance with ASCE 7-02, Minimum Design Loads and Associated Criteria for Buildings and Other Structures. The building shall be designed to resist snow loads in accordance with ASCE 7-02, Minimum Design Loads and Associated Criteria for Buildings and Other Structures. The building shall be designed to resist dead loads in accordance with ASCE 7-02, Minimum Design Loads and Associated Criteria for Buildings and Other Structures. The building shall be designed to resist live loads in accordance with ASCE 7-02, Minimum Design Loads and Associated Criteria for Buildings and Other Structures. The building shall be designed to resist wind loads in accordance with ASCE 7-02, Minimum Design Loads and Associated Criteria for Buildings and Other Structures. The building shall be designed to resist seismic loads in accordance with ASCE 7-02, Minimum Design Loads and Associated Criteria for Buildings and Other Structures. The building shall be designed to resist snow loads in accordance with ASCE 7-02, Minimum Design Loads and Associated Criteria for Buildings and Other Structures. The building shall be designed to resist dead loads in accordance with ASCE 7-02, Minimum Design Loads and Associated Criteria for Buildings and Other Structures. The building shall be designed to resist live loads in accordance with ASCE 7-02, Minimum Design Loads and Associated Criteria for Buildings and Other Structures.

## contents

project data  
building area  
parking required  
parking spaces

EOT-29994  
11-05-08 CC

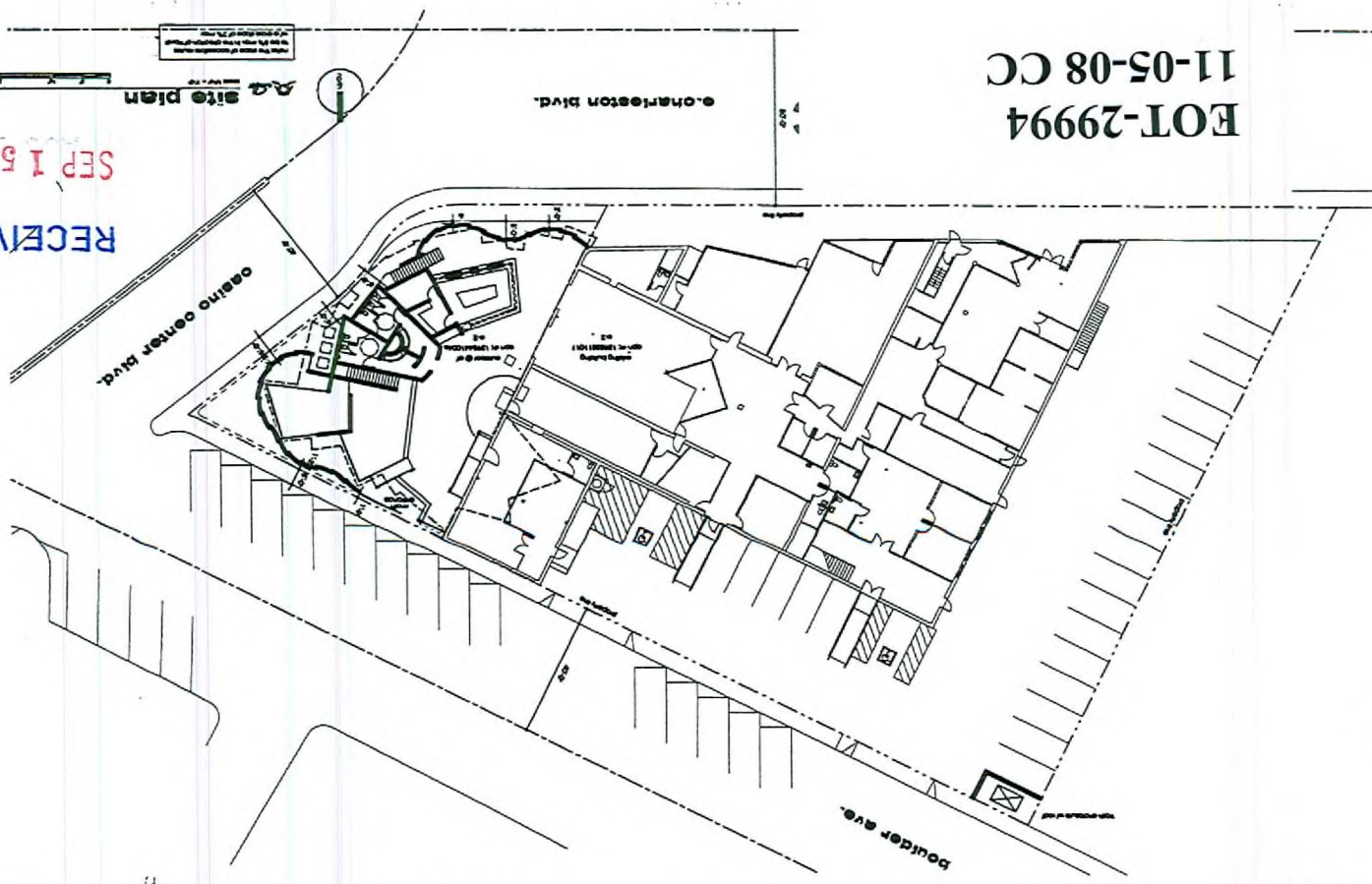

RECEIVED  
SEP 15 2008

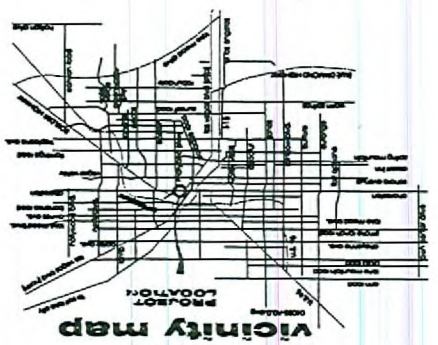

D2 enclosure elevation

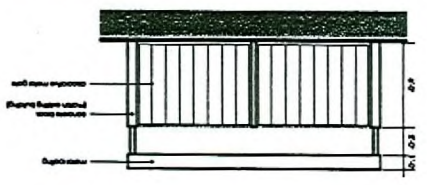

20.0  
04081  
08.23.08

outdoors @ at  
casino center & charleston  
100 E. CHARLESTON BLVD., DENVER, CO



100 E. CHARLESTON BLVD. 100  
DENVER, CO 80202  
TEL: 702.698.1723  
FAX: 702.698.1724  
www.outdoors.com





studio

architecture

interior design

100 E. Charleston Blvd. 100

Las Vegas, NV 89104

Tel. 702.696.1723

Fax. 702.696.1724

info@jowastudio.com

www.jowastudio.com

© 2008 Jowa Studio, Inc.

All rights reserved. No part of this publication may be reproduced, stored in a retrieval system, or transmitted, in any form or by any means, electronic, mechanical, photocopying, recording, or by any information storage and retrieval system, without the prior written permission of Jowa Studio, Inc.

© Copyright 2008, Jowa Studio, Inc.

01

02

03

04

05

06

07

08

09

10

11

12

13

14

15

16

17

18

19

20

21

22

23

24

25

26

27

28

29

30

31

32

33

34

35

36

37

38

39

40

41

42

43

44

45

46

47

48

49

50

51

52

53

54

55

56

57

58

59

60

61

62

63

64

65

66

67

68

69

70

71

72

73

74

75

76

77

78

79

80

81

82

83

84

85

86

87

88

89

90

91

92

93

94

95

96

97

98

99

100

101

102

103

104

105

106

107

108

109

110

111

112

113

114

115

116

117

118

119

120

121

122

123

124

125

126

127

128

129

130

131

132

133

134

135

136

137

138

139

140

141

142

143

144

145

146

147

148

149

150

151

152

153

154

155

156

157

158

159

160

161

162

163

164

165

166

167

168

169

170

171

172

173

174

175

176

177

178

179

180

181

182

183

184

185

186

187

188

189

190

191

192

193

194

195

196

197

198

199

200

201

202

203

204

205

206

207

208

209

210

211

212

213

214

215

216

217

218

219

220

221

222

223

224

225

226

227

228

229

230

231

232

233

234

235

236

237

238

239

240

241

242

243

244

245

246

247

248

249

250

251

252

253

254

255

256

257

258

259

260

261

262

263

264

265

266

267

268

269

270

271

272

273

274

275

276

277

278

279

280

281

282

283

284

285

286

287

288

289

290

291

292

293

294

295

296

297

298

299

300

301

302

303

304

305

306

307

308

309

310

311

312

313

314

315

316

317