

CASE: EOT-29856

ZONING OF SUBJECT PROPERTY:
 R-E (RESIDENCE ESTATES) ZONE [POPOSED R-PD5 (RESIDENTIAL PLANNED DEVELOPMENT - 5 UNITS PER ACRE)]

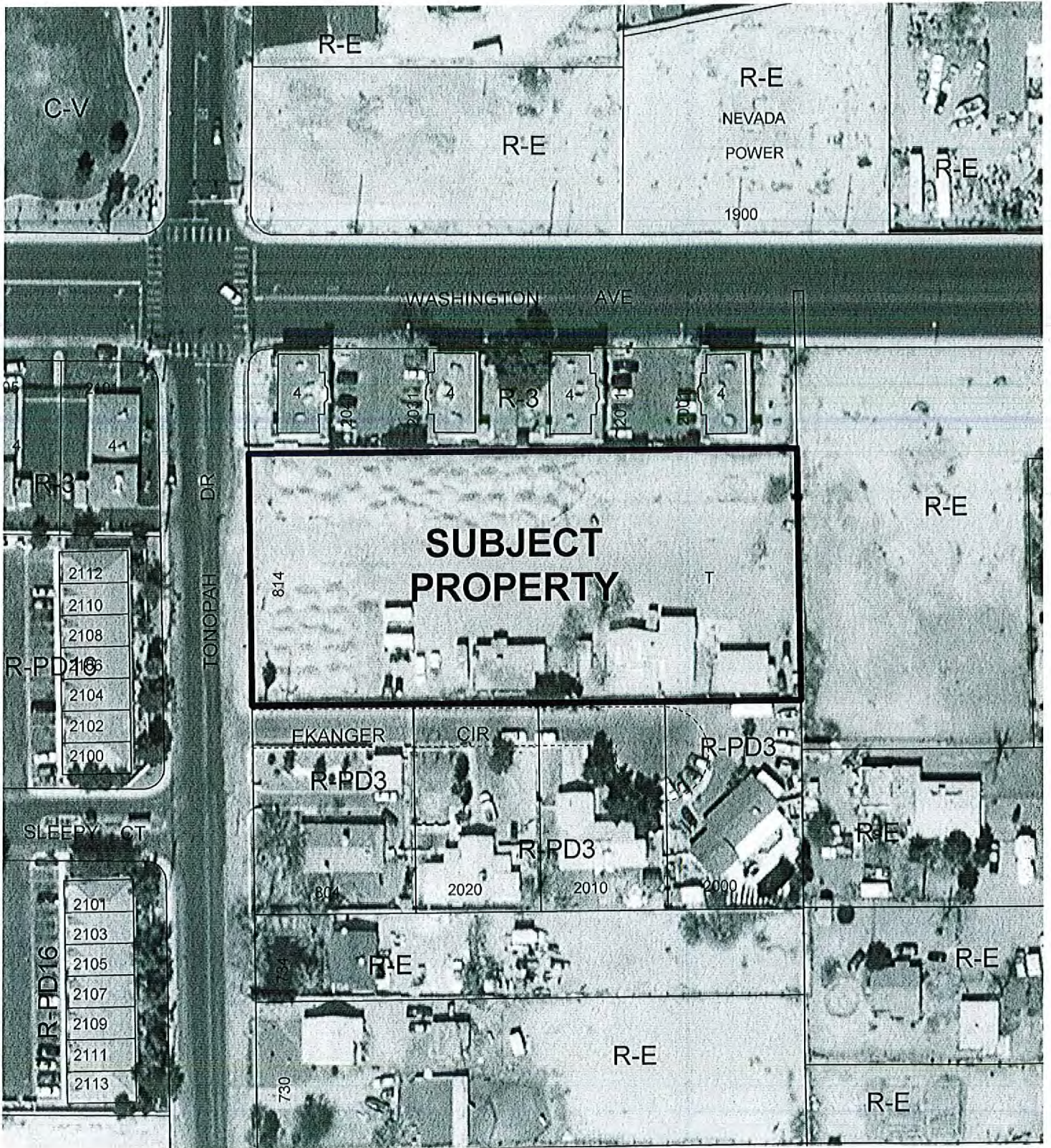



CASE: EOT-29856

ZONING OF SUBJECT PROPERTY:
 R-E (RESIDENCE ESTATES) ZONE [POPOSED R-PD5 (RESIDENTIAL PLANNED DEVELOPMENT - 5 UNITS PER ACRE)]

