

PLANNING & DEVELOPMENT DEPARTMENT

STATEMENT OF FINANCIAL INTEREST

Case Number: **SUP-29230** APN: 139-34-513-002

Name of Property Owner: ~~Las Vegas~~ FAEC Holdings Wirrulla, LLC

Name of Applicant: Wet Ultra Lounge & Bar Inc.

Name of Representative: Matthew Meagher

To the best of your knowledge, does the Mayor or any member of the City Council or Planning Commission have any financial interest in this or any other property with the property owner, applicant, the property owner or applicant's general or limited partners, or an officer of their corporation or limited liability company?

 Yes No

If yes, please indicate the member of the City Council or Planning Commission who is involved and list the name(s) of the person or persons with whom the City Official holds an interest. Also list the Assessor's Parcel Number if the property in which the interest is held is different from the case parcel.

City Official: n/a

Partner(s): n/a n/a

APN: n/a

Signature of Property Owner: 

Print Name: Dharmesh Bhangbhai

Subscribed and sworn before me

This 29 day of July, 2008

Notary Public in and for said County and State

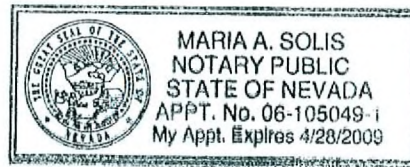

WE1 ULTRA LOUNGE OCCUPANCY LOAD CALCULATION

OCCUPANCY CLASSIFICATION: A-2
OCCUPANT LOAD ANALYSIS

DESCRIPTION	SQ/FT/OCC	LOAD	OCCUPANTS
ASSEMBLY	1420/15	=	485
WAITING AREA	502/70	=	24
SERVICE AREAS	1338/250	=	7
STORAGE AREAS	99/300	=	1
CIGAR	864/30	=	33
RESTROOMS	636/100	=	7
HALLWAYS/CORRIDORS	285/100	=	3
OFFICE	306/100	=	3
EMPLOYEE BREAKROOM	170/75	=	12
TOTAL	508/75	=	595 occupants

PLUMBING ANALYSIS:

Minimum number of plumbing fixtures per IRC 2006 Table 2502.1
Occupant load is 595 = 298 males & 297 females
Water closet requirements for Group A-2 is 1 per 40 male & 1 per 40 female
required water closets for males: 8
required water closets for females: 8
Lavatory requirements for Group A-2 is 1 per 75 male & 1 per 75 female
required lavatories for males: 4
required lavatories for females: 4
Drinking Fountain requirements for Group A-2 is 1 per 500 occupants
required drinking fountains: 2
Required Service Sinks: 1

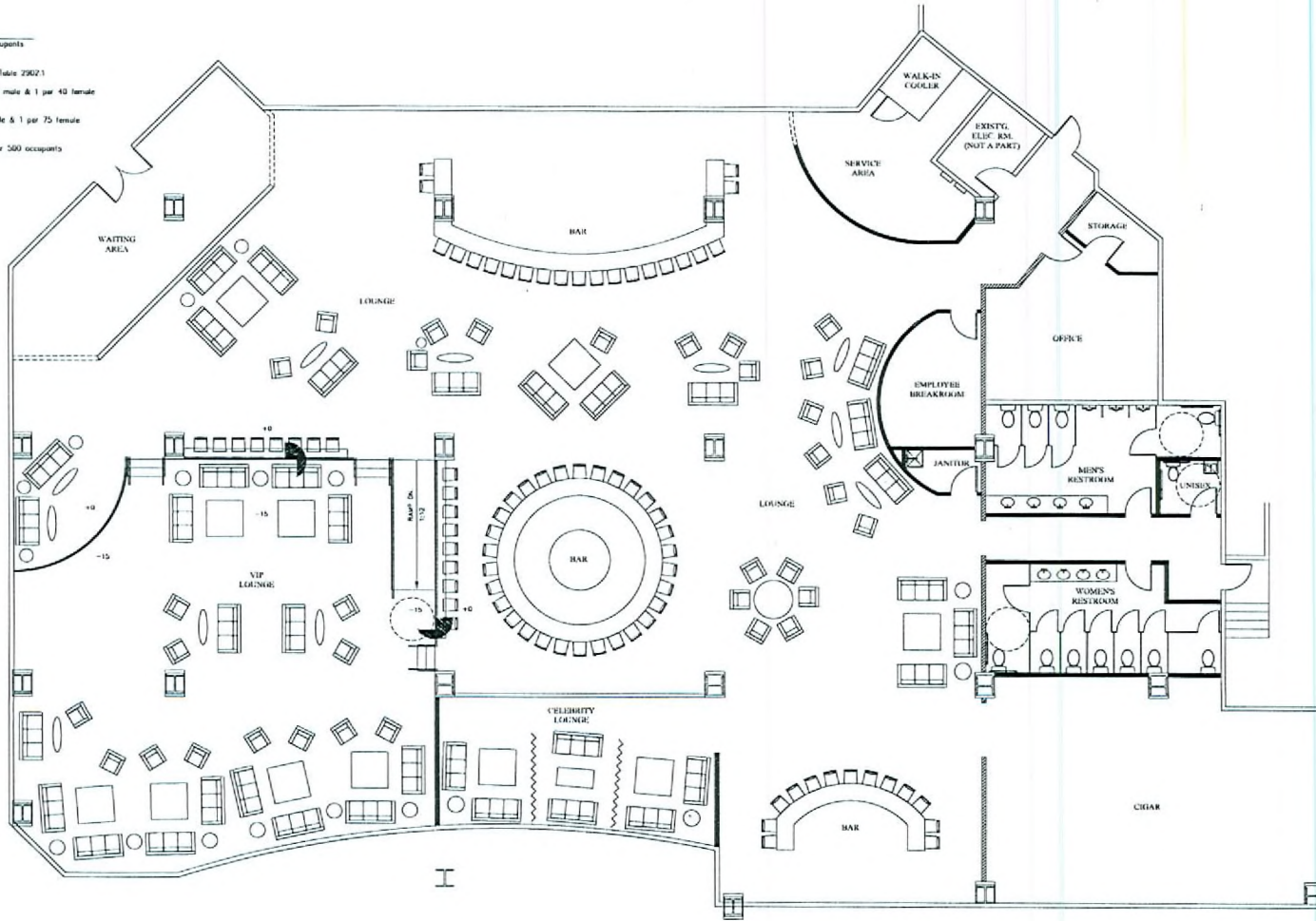

1 Floor Plan
SCALE: 1/8"=1'-0"



RECEIVED

JUL 29 2008

NO.	REVISED
1	Δ
2	Δ
3	Δ
4	Δ
5	Δ

QUALITY CHOICE CONSTRUCTION
2755 S. NELLS BLVD., STE 10
LAS VEGAS, NEVADA 89121
Ph.: (702) 641-2400
Fax.: (702) 641-2401
LICENSE # 44184



SIGNATURE

ALL WORK SHALL BE DONE IN ACCORDANCE WITH THE 2006 INTERNATIONAL BUILDING CODE (IBC) AND THE 2006 INTERNATIONAL PLUMBING CODE (IPC). THE CONTRACTOR SHALL BE RESPONSIBLE FOR OBTAINING ALL NECESSARY PERMITS AND FOR COMPLYING WITH ALL APPLICABLE REGULATIONS AND ORDINANCES. THE CONTRACTOR SHALL BE RESPONSIBLE FOR OBTAINING ALL NECESSARY PERMITS AND FOR COMPLYING WITH ALL APPLICABLE REGULATIONS AND ORDINANCES.

Wet Ultra Lounge
@ Neonopolis
Las Vegas, NV 89148

PRELIMINARY LAYOUT

DATE: 07/29/2008	DRAWN BY: RWR
SCALE: AS NOTED	
SHEET	

SUP-29230
09/11/08 PC

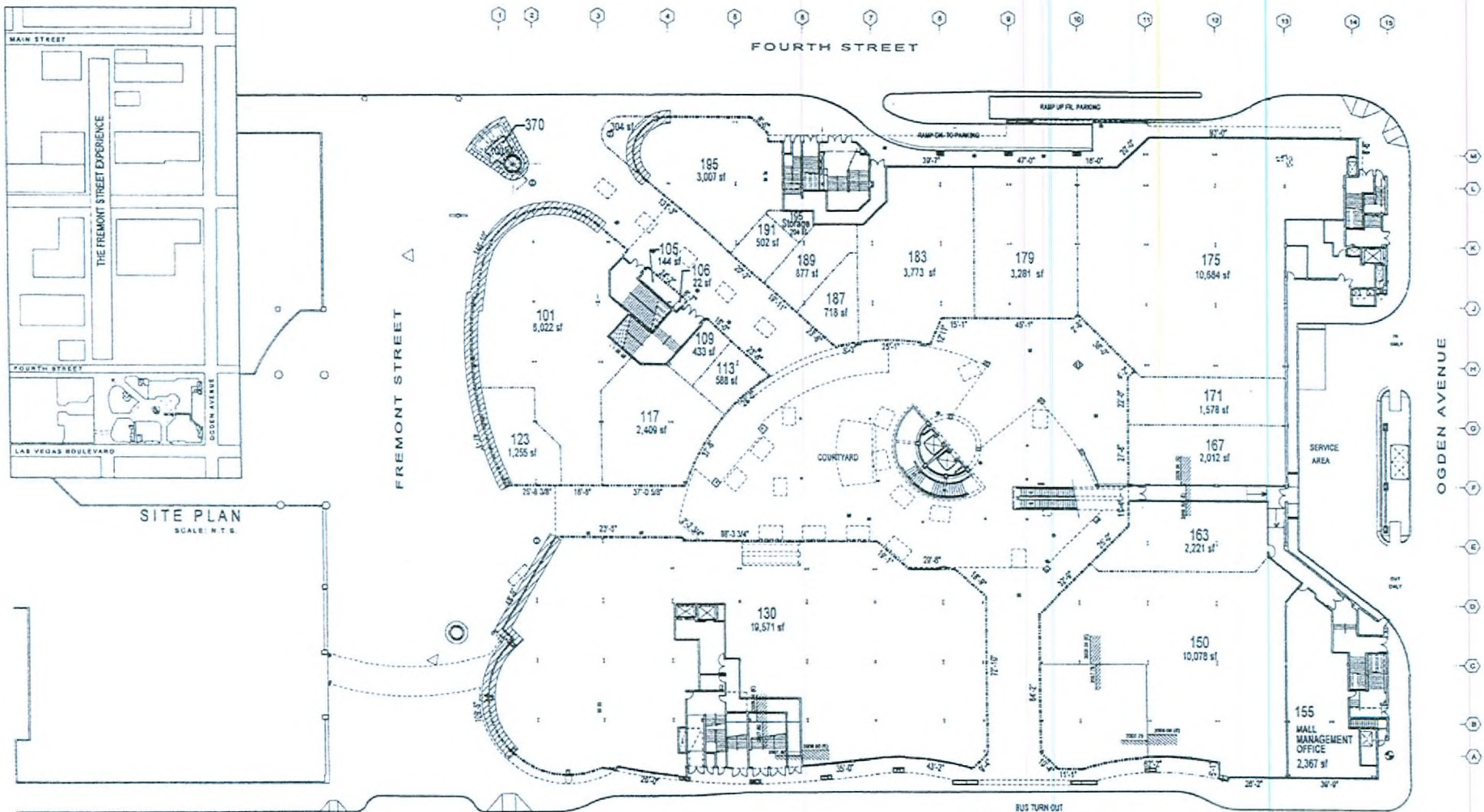

SITE PLAN
SCALE: N.T.S.

NOTE:

THIS IS A PRELIMINARY LEASE PLAN INTENDED FOR DISCUSSION PURPOSES ONLY.

THE LANDLORD RESERVES THE RIGHT TO MAKE ANY CHANGES TO THE PLAN INCLUDING, WITHOUT LIMITATION, BUILDING AND STORE SIZES AND CONFIGURATIONS, ENTRANCES AND CONFIGURATION.

THE LANDLORD MAKES NO WARRANTIES OR REPRESENTATIONS CONCERNING ANY MATTER CONTAINED ON THIS PLAN, NOR SHALL TENANT RELY UPON THE SAME.



EXTERNAL LIGHTING & ILLUMINATED SIGNS & GRAPHICS TO HAVE SEPARATE FREMONT STREET EXPERIENCE CONTROLS TO TURN OFF POWER FOR FSE SHOWS.

LAS VEGAS BOULEVARD

RECEIVED

JUL 29 2008

LEVEL ONE LEASE PLAN

SUP-29230

09/11/08 PC

NEONOPOLIS



at Fremont Street Experience

LEASING AGENT

JSS ADVISORS
P.O. BOX 1538
LAS VEGAS, NV 89128
P: 702.477.5470
F: 702.871.0092
CHARDELL STEVES

DEVELOPER

WORLD ENTERTAINMENT
CENTERS
P.O. BOX 1839
LAS VEGAS, NV 89126
P: 702.477.8478
F: 702.871.0892

ARCHITECT

RTKL NEVADA CORP
333 SOUTH HOPE STREET
LOS ANGELES, CA 90071
P: 213.827.7373
F: 213.827.9818
REGGIE YEE
NORMAN GARDEN



SCALE: 1" = 30' - 0"

