



**PLANNING & DEVELOPMENT DEPARTMENT**

**STATEMENT OF FINANCIAL INTEREST**

Case Number: **VAC-28548** APN: 125-17-601-010, 007+013

Name of Property Owner: LINDA TIVORSAK

Name of Applicant: Rapinder Chima

Name of Representative: Rapinder Chima

To the best of your knowledge, does the Mayor or any member of the City Council or Planning Commission have any financial interest in this or any other property with the property owner, applicant, the property owner or applicant's general or limited partners, or an officer of their corporation or limited liability company?

           Yes

  X   No

If yes, please indicate the member of the City Council or Planning Commission who is involved and list the name(s) of the person or persons with whom the City Official holds an interest. Also list the Assessor's Parcel Number if the property in which the interest is held is different from the case parcel.

City Official: \_\_\_\_\_

Partner(s): \_\_\_\_\_

APN: \_\_\_\_\_

Signature of Property Owner: [Handwritten Signature]

Print Name: LINDA TIVORSAK

Subscribed and sworn before me

This 21st day of May, 2008

[Handwritten Signature]  
Notary Public in and for said County and State







## PLANNING & DEVELOPMENT DEPARTMENT

### STATEMENT OF FINANCIAL INTEREST

Case Number: **VAC-28548** APN: 125-17-601-010, 007+013

Name of Property Owner: Alan Tivorsak

Name of Applicant: Rapinder Chima

Name of Representative: Rapinder Chima

To the best of your knowledge, does the Mayor or any member of the City Council or Planning Commission have any financial interest in this or any other property with the property owner, applicant, the property owner or applicant's general or limited partners, or an officer of their corporation or limited liability company?

Yes

No

If yes, please indicate the member of the City Council or Planning Commission who is involved and list the name(s) of the person or persons with whom the City Official holds an interest. Also list the Assessor's Parcel Number if the property in which the interest is held is different from the case parcel.

City Official: \_\_\_\_\_

Partner(s): \_\_\_\_\_

APN: \_\_\_\_\_

Signature of Property Owner: [Signature]

Print Name: Alan Tivorsak

Subscribed and sworn before me

This 21 day of MAY, 2008

[Signature]  
Notary Public in and for said County and State





PLANNING & DEVELOPMENT DEPARTMENT

STATEMENT OF FINANCIAL INTEREST

Case Number: VAC-28548 APN: 125-17-601-010,007+013
Name of Property Owner: Pallop and Ampai Siripipat
Name of Applicant: Rapinder Chima
Name of Representative: Rapinder Chima

To the best of your knowledge, does the Mayor or any member of the City Council or Planning Commission have any financial interest in this or any other property with the property owner, applicant, the property owner or applicant's general or limited partners, or an officer of their corporation or limited liability company?

Yes No (X)

If yes, please indicate the member of the City Council or Planning Commission who is involved and list the name(s) of the person or persons with whom the City Official holds an interest. Also list the Assessor's Parcel Number if the property in which the interest is held is different from the case parcel.

City Official:
Partner(s):
APN:

Signature of Property Owner: [Handwritten Signature]

Print Name: Pallop Siripipat

Subscribed and sworn before me Ampai Siripipat

This 22nd day of May, 2008

[Handwritten Signature]
Notary Public in and for said County and State

whatcom / Washington

Notary Public
State of Washington
DEANNA K. SWARTZ
MY COMMISSION EXPIRES
December 12, 2010





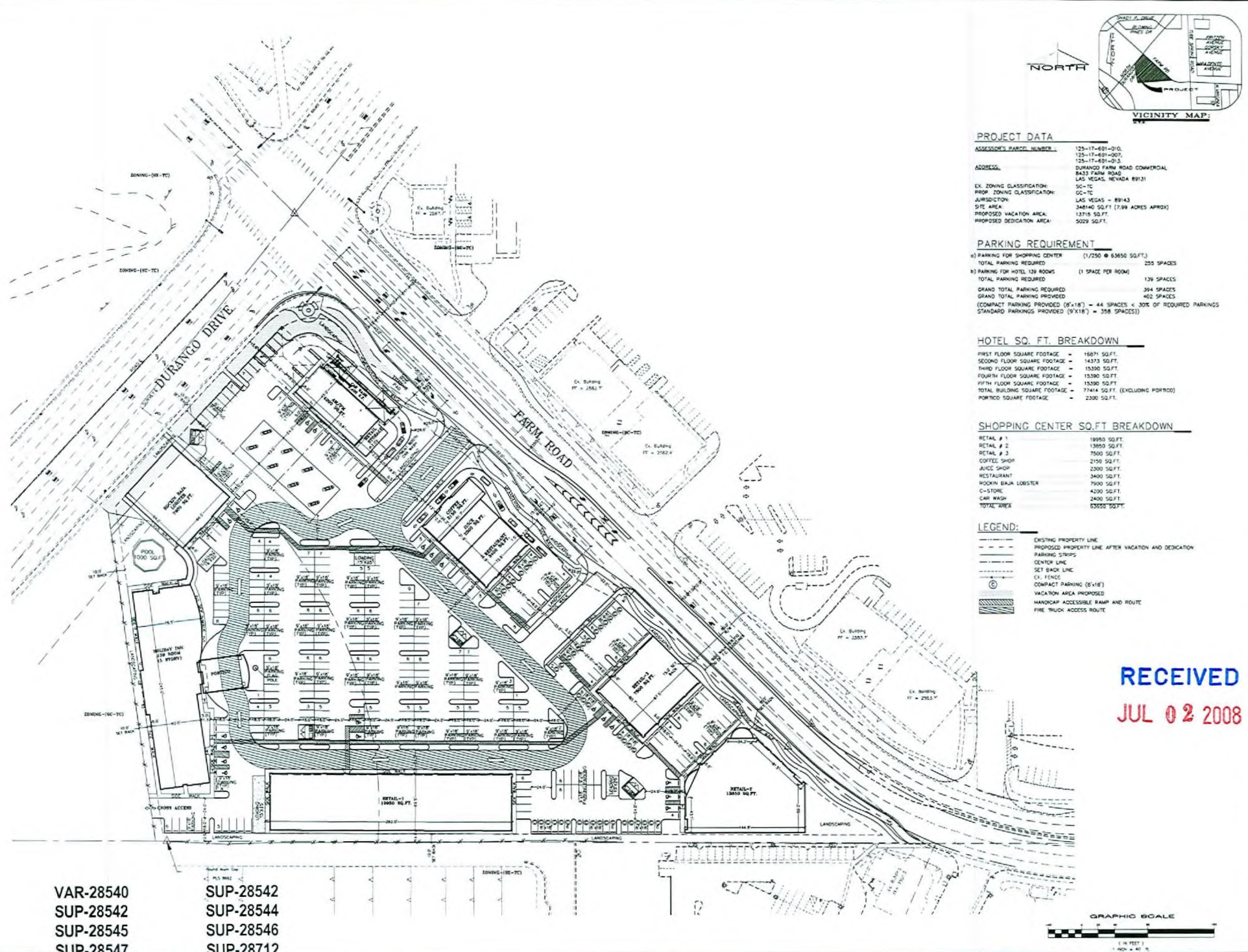

**PROJECT DATA**

ASSESSOR'S PARCEL NUMBER: 125-17-401-010, 125-17-401-007, 125-17-401-015  
 ADDRESS: DURANGO FARM ROAD COMMERCIAL, 8433 FARM ROAD, LAS VEGAS, NEVADA 89131  
 EX. ZONING CLASSIFICATION: GC-TC  
 FROM ZONING CLASSIFICATION: LAS VEGAS - 89143  
 SITE AREA: 13715 SQ. FT.  
 PROPOSED VACATION AREA: 5029 SQ. FT.

**PARKING REQUIREMENT**

a) PARKING FOR SHOPPING CENTER (1/250 @ 63650 SQ. FT.) 255 SPACES  
 TOTAL PARKING REQUIRED 255 SPACES  
 b) PARKING FOR HOTEL 129 ROOMS (1 SPACE PER ROOM) 129 SPACES  
 TOTAL PARKING REQUIRED 129 SPACES  
 GRAND TOTAL PARKING REQUIRED 384 SPACES  
 GRAND TOTAL PARKING PROVIDED 422 SPACES  
 (COMPACT PARKING PROVIDED (8'x18') = 44 SPACES < 30% OF REQUIRED PARKINGS  
 STANDARD PARKINGS PROVIDED (9'x18') = 358 SPACES)

**HOTEL SQ. FT. BREAKDOWN**

FIRST FLOOR SQUARE FOOTAGE - 16871 SQ. FT.  
 SECOND FLOOR SQUARE FOOTAGE - 14373 SQ. FT.  
 THIRD FLOOR SQUARE FOOTAGE - 15390 SQ. FT.  
 FOURTH FLOOR SQUARE FOOTAGE - 15390 SQ. FT.  
 FIFTH FLOOR SQUARE FOOTAGE - 15390 SQ. FT.  
 TOTAL BUILDING SQUARE FOOTAGE - 77414 SQ. FT. (EXCLUDING PORTRCO)  
 PORTRCO SQUARE FOOTAGE - 2300 SQ. FT.

**SHOPPING CENTER SQ. FT. BREAKDOWN**

RETAIL # 1 19950 SQ. FT.  
 RETAIL # 2 13850 SQ. FT.  
 RETAIL # 3 7500 SQ. FT.  
 COFFEE SHOP 2150 SQ. FT.  
 JUICE SHOP 2300 SQ. FT.  
 RESTAURANT 2400 SQ. FT.  
 ROCKIN BAKR LOBSTER 7900 SQ. FT.  
 C-STOKE 4200 SQ. FT.  
 CAR WASH 2400 SQ. FT.  
 TOTAL AREA 63650 SQ. FT.

**LEGEND:**

- EXISTING PROPERTY LINE
- - - PROPOSED PROPERTY LINE AFTER VACATION AND DEDICATION
- PARKING STRIP
- CENTER LINE
- SET BACK LINE
- C.I. FENCE
- ⊙ COMPACT PARKING (8'x18')
- ⊙ VACATION AREA PROPOSED
- HANDICAP ACCESSIBLE RAMP AND ROUTE
- FIRE TRUCK ACCESS ROUTE

**RECEIVED**  
**JUL 02 2008**



VAR-28540 SUP-28542  
 SUP-28542 SUP-28544  
 SUP-28545 SUP-28546  
 SUP-28547 SUP-28712  
 SUP-28713 SDR-28535  
 MOD-28538 08/14/08 PC

REVISIONS:

**ACE ENGINEERING**  
 8995 S DURANGO DRIVE  
 LAS VEGAS, NV 89131  
 PHONE: 702-944-8800 FAX: 702-944-7982  
 CIVIL, PLANNING, LAND DEVELOPMENT & SURVEYING

**SITE PLAN**  
 DURANGO FARM ROAD COMMERCIAL  
 8433 FARM ROAD  
 LAS VEGAS, NEVADA 89131

TITLE: \_\_\_\_\_  
 PRODUCT: \_\_\_\_\_  
 SEAL: \_\_\_\_\_  
 DATE: 06/10/2008  
 JOB: 08-03  
 DWG. REV. NO.:  
 CHK. BY: MH

A1\_PR25  
 SHEET  
 1 OF 12