



**PLANNING & DEVELOPMENT DEPARTMENT**

**STATEMENT OF FINANCIAL INTEREST**

Case Number: **SDR-29870** APN: 139-33-511-007/13933610022

Name of Property Owner: WORLD MARKET CENTER II LLC *J WORLD MARKET CENTER II LLC*

Name of Applicant: WORLD MARKET CENTER II LLC *J PHASE 3 WORLD MARKET CENTER II LLC*

Name of Representative: JAMES DONOFRIA *J PHASE 3*

To the best of your knowledge, does the Mayor or any member of the City Council or Planning Commission have any financial interest in this or any other property with the property owner, applicant, the property owner or applicant's general or limited partners, or an officer of their corporation or limited liability company?

\_\_\_\_\_ Yes                      X No

If yes, please indicate the member of the City Council or Planning Commission who is involved and list the name(s) of the person or persons with whom the City Official holds an interest. Also list the Assessor's Parcel Number if the property in which the interest is held is different from the case parcel.

City Official: \_\_\_\_\_

Partner(s): \_\_\_\_\_

APN: \_\_\_\_\_

Signature of Property Owner: *[Signature]*

Print Name: TON WACKROW

Subscribed and sworn before me

This 21 day of August, 2008

Tamara Pogozelski



Notary Public in and for said County and State- Clark, Nevada

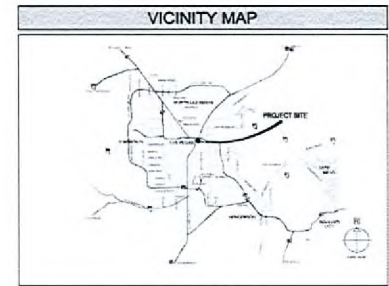
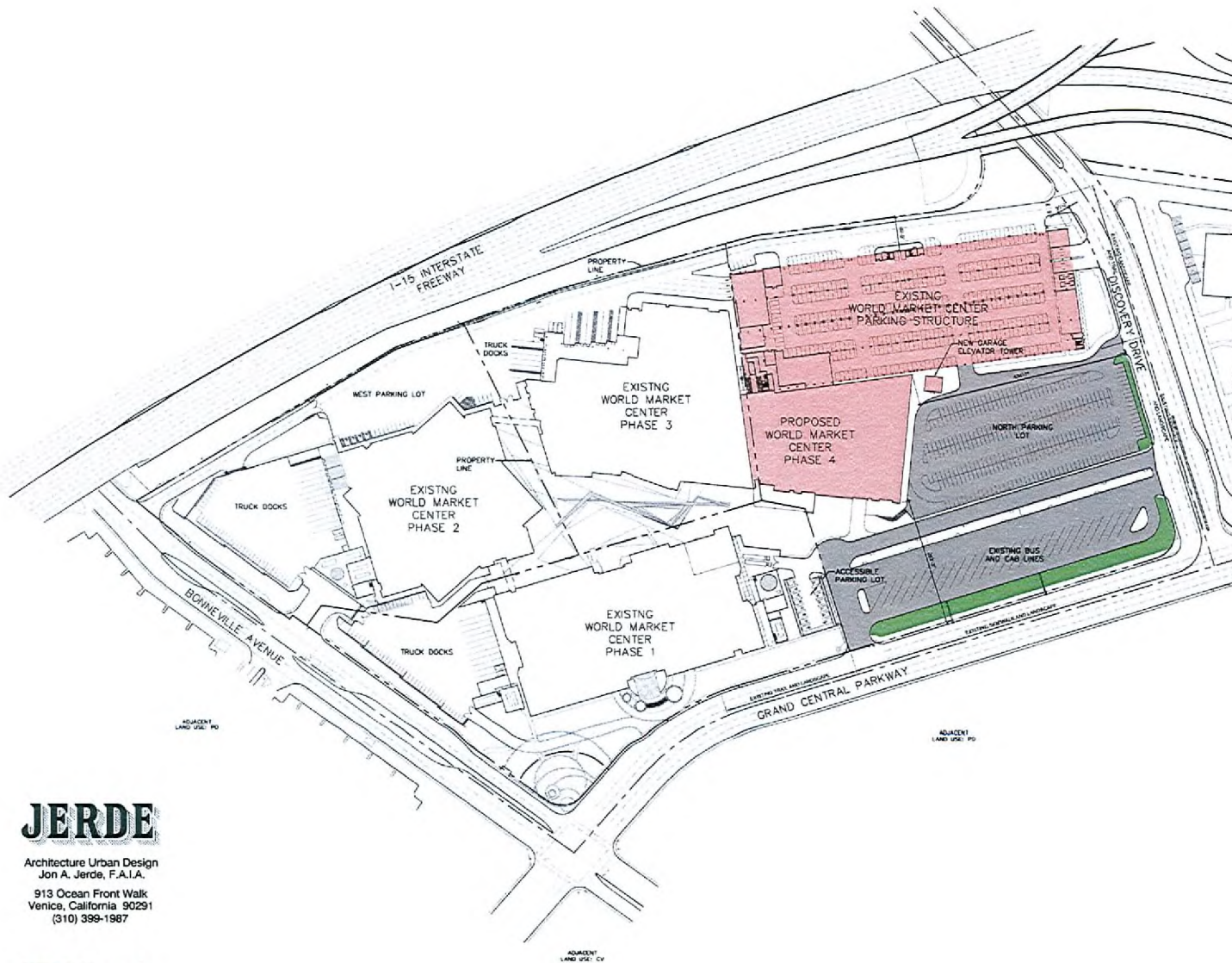

**SITE DATA**

JURISDICTION: City of Las Vegas  
 PARCEL NUMBERS (SOUTH OF DISCOVERY DRIVE): 139-33-511-007, 139-33-510-022  
 PARCEL NUMBERS (NORTH OF DISCOVERY DRIVE): 139-33-511-004, 139-27-410-008

ZONING: Planned Development District (PDD)

**BUILDING COVERAGE**  
 SITE AREA: 839,465 SF (14.68 ACRES)  
 FOOTPRINTS: BUILDING 4: 73,676 SF; PARKING GARAGE: 176,564 SF; GARAGE ELEVATOR: 1,108 SF  
 TOTAL: 251,348 SF  
 TOTAL COVERAGE: 29.3%

**PARKING REQUIREMENTS**

EXISTING BUILDINGS	SQ. FT.	REQUIRED PARKING	PROVIDED PARKING
BUILDING 1	1,285,029	1,090	
BUILDING 2	1,577,731	1,339	
BUILDING 3	1,978,856	1,683	
TEMP. FACILITIES	349,958		
TOTAL	5,191,574	4,112	4,477*
NEW BUILDING	1,182,256	1,183	864
<b>GRAND TOTAL:</b>	<b>6,353,357</b>	<b>6,356</b>	<b>5,341</b>

\*ACTUAL REQUIRED PARKING PER 2002 IBC CONDITIONS

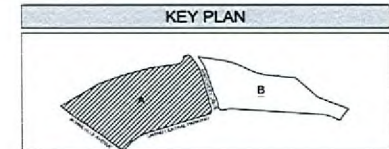

**JERDE**  
 Architecture Urban Design  
 Jon A. Jerde, F.A.I.A.  
 913 Ocean Front Walk  
 Venice, California 90291  
 (310) 399-1987

**EV&A**  
 ARCHITECTS

ED VANCE AND ASSOCIATES  
 900 S. PAVILION CENTER DRIVE SUITE 100  
 LAS VEGAS, NEVADA 89144  
 P: 702.240.8195 F: 702.240.8196  
 www.edvanceassociates.com

**OVERALL SITE PLAN - SITE A**  
**WORLD MARKET CENTER - PHASE 4**

August 26, 2008

LAS VEGAS, NEVADA  
 RECEIVED  
 SCALE: 1" = 100'-0"

**SDR-29870**  
**OCT 08 2008 REVISED**  
**10/23/08 PC**

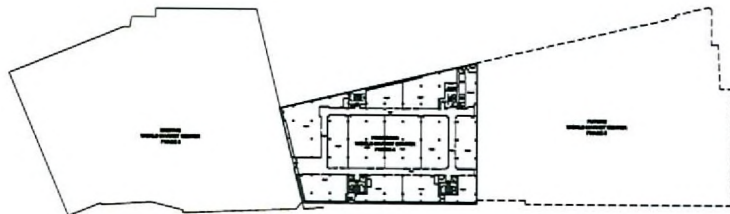

**FLOOR PLAN LEVEL 10 (11-16 SIMILAR)**

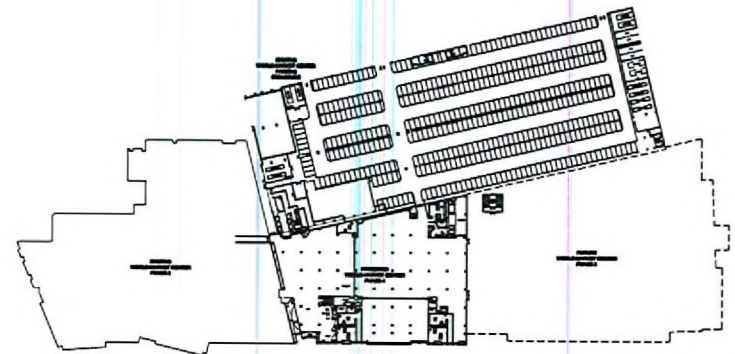

**FLOOR PLAN LEVEL 1**

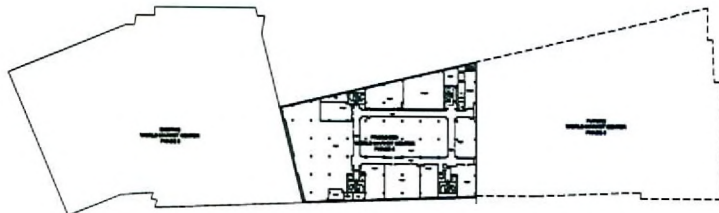

**FLOOR PLAN LEVEL 17**

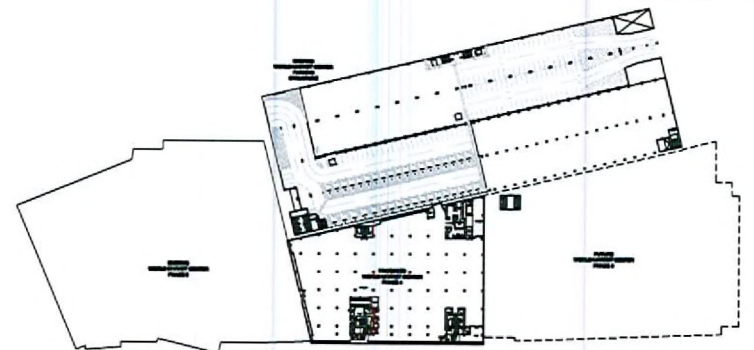

**FLOOR PLAN LEVEL 3**

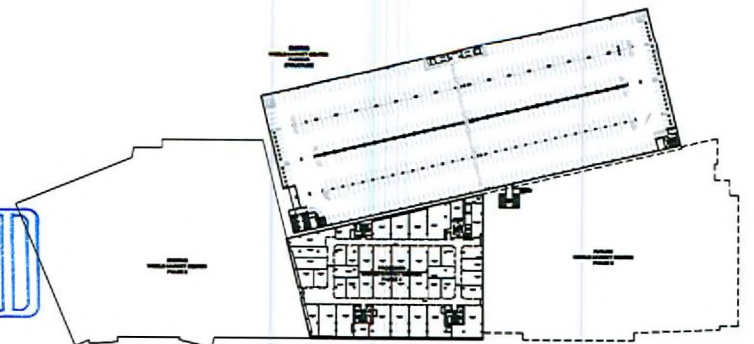

**FLOOR PLAN LEVEL 4 (5-9 SIMILAR)**

**JERDE**

Architecture Urban Design  
Jon A. Jerde, F.A.I.A.  
913 Ocean Front Walk  
Venice, California 90291  
(310) 399-1987

**EVA**  
ARCHITECTS

ED VANCE AND ASSOCIATES  
100 SPANGLER CENTER DRIVE SUITE 100  
LAS VEGAS, NEVADA 89166  
P: 702.946.8100 F: 702.946.8106  
www.edvanceassociates.com

**TYPICAL FLOOR PLANS**

**WORLD MARKET CENTER - PHASE 4**

RECEIVED  
SEP 09 2008

August 26, 2008

LAS VEGAS, NEVADA

SCALE: 1" = 100'-0"



**SDR-29870**  
**10/23/08 PC**



---

WORLD MARKET CENTER – BUILDING 4 COLOR BOARD

---



Metal Panel 1 – Duranar Silversmith  
(uc70092f)



EIFS Panel – Reddish Brown

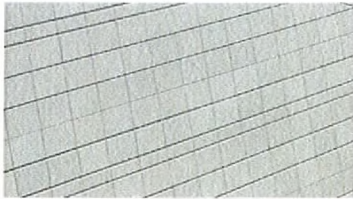

Metal Panel 2 – Duranar  
Champagne Bronze (uc70202f)



Glass Panel – Blue Green Glass

**NOTE:**

All colors to match existing World Market Center Building 3

RECEIVED  
SEP 09 2008



WORLD MARKET CENTER  
LAS VEGAS



**JERDE**

THE JERDE PARTNERSHIP

**SDR-29870**  
**10/23/08 PC**