

1
2
3
4
5
6
7
8
9
10
11
12
13
14
15
16
17
18
19
20
21
22
23
24
25
26
27
28

BILL NO. 2008-37

ORDINANCE NO. _____

AN ORDINANCE TO EXTEND THE BOUNDARIES OF THE CITY, TO PARTICULARLY DESCRIBE THE LAND TO BE ANNEXED, TO MAKE ITS INHABITANTS SUBJECT TO THE LAWS, OBLIGATIONS AND BENEFITS OF THE CITY, AND TO PROVIDE FOR OTHER RELATED MATTERS. (ANX-28046)

Sponsored by: Councilman Larry Brown Summary: Annexes property described generally as located at 4742 Balsam Street.

THE CITY COUNCIL OF THE CITY OF LAS VEGAS DOES HEREBY ORDAIN AS FOLLOWS:

SECTION 1: The corporate limits of the City of Las Vegas, Nevada, are hereby extended to annex, include, and make a part of the City of Las Vegas, Nevada, the following described real property:

That portion of the Northeast Quarter (NE 1/4) of the Northeast Quarter (NE 1/4) of Section 3, Township 20 South, Range 60 East, M.D.M., in the County of Clark, State of Nevada, being Lot 25 in Block 2 of BRIDLE PATH ESTATES recorded in Book 6 of Plats, Page 99 of Clark County, Nevada Records, including the adjacent east half street right of way of BALSAM STREET (30.00 feet wide as measured from centerline thereof) and the adjacent south half of the 20 foot east-west alley and the adjacent west half of the 20 foot north-south alley all as shown on said BRIDLE PATH ESTATES bounded as follows:

Bounded on the west by the centerline of said BALSAM STREET; bounded on the north by the centerline of said 20 foot east-west alley; bounded on the east by the centerline of said 20 foot north-south alley; and bounded on the south by the easterly and westerly prolongation of the south line of said Lot 25.

SECTION 2: The City Council hereby determines that the described territory

1 meets the requirements provided by law for annexation to the City for the following reasons:

- 2 A. The area to be annexed was contiguous to the City's boundaries at the
3 time the annexation proceedings were instituted;
- 4 B. More than one-eighth (1/8) of the aggregate external boundaries of
5 the area are contiguous to the City;
- 6 C. The territory proposed to be annexed is not included within the
7 boundaries of another incorporated city or within the boundaries of
8 any unincorporated town as those boundaries existed as of July 1,
9 1983;
- 10 D. The City is eligible to annex the described territory since the
11 landowners have signed a petition constituting one hundred percent
12 (100%) of the owners of record of individual lots or parcels of land
13 within the annexation area.

14 SECTION 3: The City will provide police protection through the Las Vegas
15 Metropolitan Police Department, fire protection, street maintenance, and library services
16 immediately upon annexation. Garbage collection by the company franchised by the City
17 will also be provided immediately. The City sanitary sewer system will serve the proposed
18 annexation area. Any connection to or extension of this sewer line to serve the annexation
19 area shall be at the expense of the landowners. Other services, such as participation in the
20 City's recreational programs, special education classes and programs, public works planning,
21 building inspections, and other City services will also be available immediately. Utilities
22 such as gas, electricity, telephone, and water are provided by private utility companies and
23 other services to the area will not be affected by annexation. Street paving, curbs and gutters,
24 sidewalks and street lights which are not in place at the time of annexation will be installed
25 in the presently developed areas upon the request of the property owners and at their expense
26 by means of special assessment districts. Such improvements will be extended into the
27 undeveloped areas as development takes place and the need therefor arises, and will be
28 located according to the needs of the area at that time. Such installations will also be made

1 at the expense of the property owners, either by means of special assessment districts or as
2 prerequisites to the approval of subdivision plats, building permits or other land use or
3 development applications.

4 SECTION 4: The annexation of the described territory shall become
5 effective on the 12th day of September, 2008, and on that date the City will have the funds
6 appropriated in sufficient amount to finance the extension into the described territory of
7 police protection, fire protection, street maintenance, street sweeping, and street lighting
8 maintenance.

9 SECTION 5: The described territory, together with the inhabitants and
10 property thereof, shall, from and after the 12th day of September, 2008, be subject to all
11 debts, laws, ordinances and regulations in force in the City and shall be entitled to the same
12 privileges and benefits as other parts of the City, and shall be subject to municipal taxes
13 levied by the City.

14 SECTION 6: The City Engineer is hereby instructed to cause to be prepared
15 an accurate map or plat of the described territory and to record the map or plat, together with
16 a certified copy of this ordinance, in the office of the County Recorder of Clark County,
17 Nevada, which recording shall be done prior to the 12th day of September, 2008.

18 SECTION 7: The described territory, which previously has been zoned R-E
19 (County of Clark classification), is hereby classified as R-E (City of Las Vegas
20 classification), which is deemed to be the City equivalent of the County classification.

21 SECTION 8: If any section, subsection, subdivision, paragraph, sentence,
22 clause or phrase in this ordinance or any part thereof, is for any reason held to be
23 unconstitutional, or invalid or ineffective by any court of competent jurisdiction, such
24 decision shall not affect the validity or effectiveness of the remaining portions of this
25 ordinance or any part thereof. The City Council of the City of Las Vegas hereby declares that
26 it would have passed each section, subsection, subdivision, paragraph, sentence, clause or
27 phrase thereof irrespective of the fact that any one or more sections, subsections,
28 subdivisions, paragraphs, sentences, clauses or phrases be declared unconstitutional, invalid

1 or ineffective.

2 SECTION 9: All ordinances or parts of ordinances, sections, subsections,
3 phrases, sentences, clauses or paragraphs contained in the Municipal Code of the City of Las
4 Vegas, Nevada, 1983 Edition, in conflict herewith are hereby repealed.

5 PASSED, ADOPTED and APPROVED this ____ day of _____,
6 2008.

7 APPROVED:

8
9 By OSCAR B. GOODMAN, Mayor

10 ATTEST:

11
12 BEVERLY K. BRIDGES, CMC
13 City Clerk

14 APPROVED AS TO FORM:
15 Jerry G. Bellis 7-24-08
16 Date

17
18
19
20
21
22
23
24
25
26
27
28

1 The above and foregoing ordinance was first proposed and read by title to the Council on the
2 _____ day of _____, 2008, and referred to the following committee
3 composed of _____ and _____ for recommendation;
4 thereafter the said committee reported favorably on said ordinance on the _____ day of
5 _____, 2008, which was a _____ meeting of said Council; that
6 at said _____ meeting, the proposed ordinance was read by title to the City
7 Council as first introduced and adopted by the following vote:

8 VOTING "AYE": _____

9 VOTING "NAY": _____

10 ABSENT: _____

11 APPROVED:

12
13 By _____
14 OSCAR B. GOODMAN, Mayor

15 ATTEST:

16 _____
17 BEVERLY K. BRIDGES, CMC
18 City Clerk
19
20
21
22
23
24
25
26
27
28

LONE MOUNTAIN RD

U(MLA)
RO
R-PD10

6863

R-E

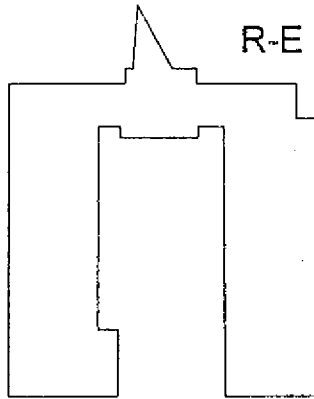

CHILD CARE

6841

OFFICE

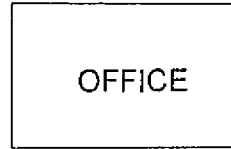

C-V



CITY LIMIT

BALSAM ST
CITY LIMIT

**SUBJECT
PROPERTY**

4742

U(PROS)

CITY LIMIT

CITY LIMIT

R-E

R-E

4722

0 100 Feet



CASE: ANX-28046

