

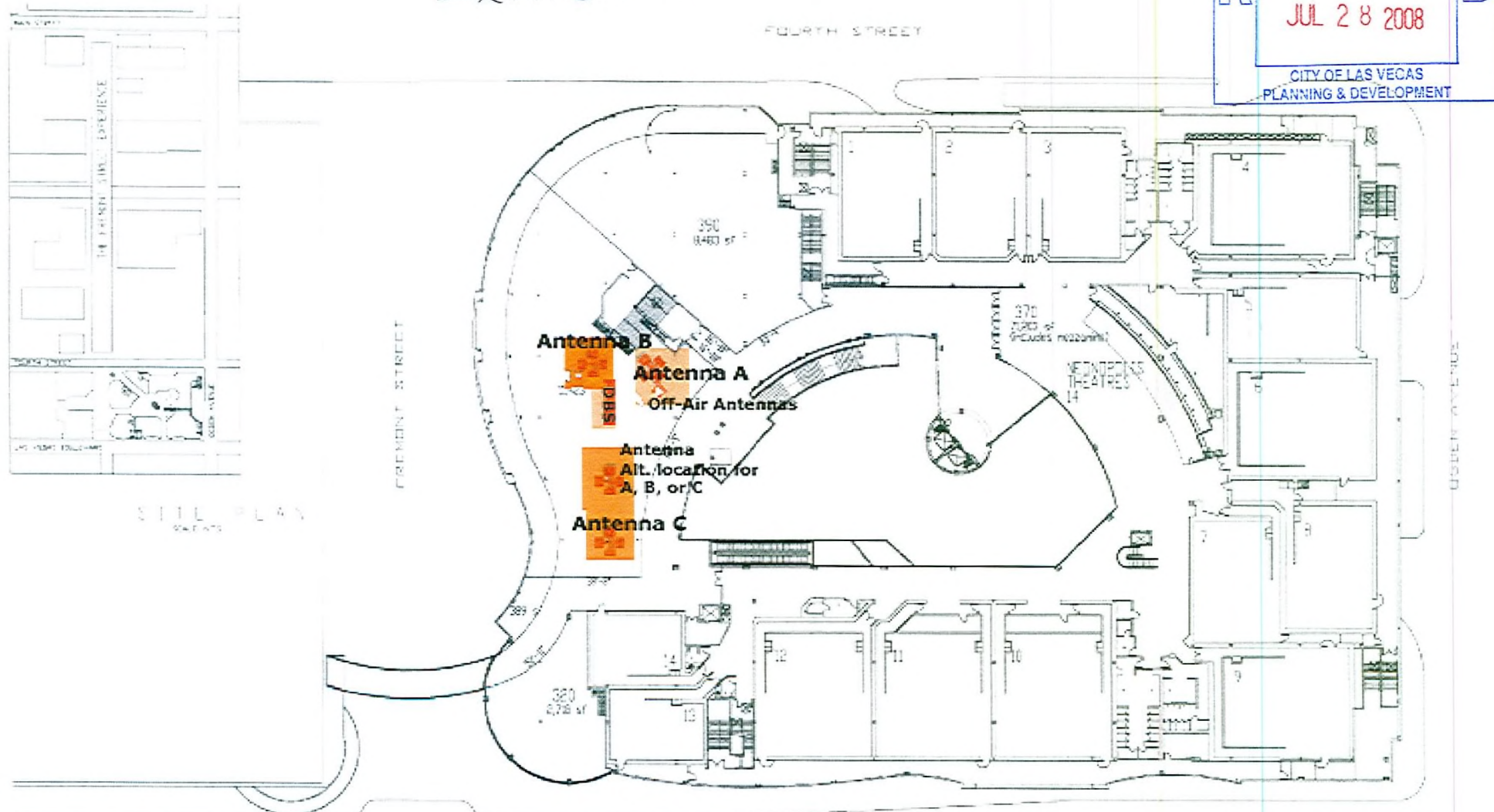

# EXHIBIT A

RECEIVED  
 JUL 28 2008  
 CITY OF LAS VEGAS  
 PLANNING & DEVELOPMENT



SITE PLAN  
 LEVELS

NOTE  
 THIS IS A PRELIMINARY PLAN AND IS INTENDED FOR DISCUSSION PURPOSES ONLY.  
 THE LANDLORD RESERVES THE RIGHT TO MAKE ANY CHANGES TO THE PLAN INCLUDING, WITHOUT LIMITATION, ADDING AND/OR DELETING ANTENNAS AND CONFIGURATION, OR MAKE ANY OTHER CHANGES.  
 THE LANDLORD MAKES NO WARRANTY OR REPRESENTATION CONCERNING THE ACCURACY OF THE INFORMATION CONTAINED ON THIS PLAN AND SHALL NOT BE RESPONSIBLE FOR THE SAME.

EXTERNAL LEASING IS GUARANTEED ONLY AS SHOWN TO HAVE THROUGH EXISTING POWER LINES AND SHALL BE SUBJECT TO THE POWER COMPANY'S DISCRETION TO TURN OFF POWER FOR MAINTENANCE.

LAS VEGAS BOULEVARD

**SUP-29194**  
**09/11/08 PC**

LEVEL THREE LEA

NEONOP  LIS

LEASING AGENT JEN ADVISORS P.O. BOX 2027 LAS VEGAS, NV 89107	DEVELOPER VENTURE ENTERTAINMENT CENTER P.O. BOX 1029	ARCHITECT PFM LAS VEGAS, LLP 300 SOUTH MAIN STREET LAS VEGAS, NV 89101
---	---	---



**RECEIVED**  
**JUL 28 2008**  
 CITY OF LAS VEGAS  
 PLANNING & DEVELOPMENT



**SITE PLAN**  
 2007.07.10

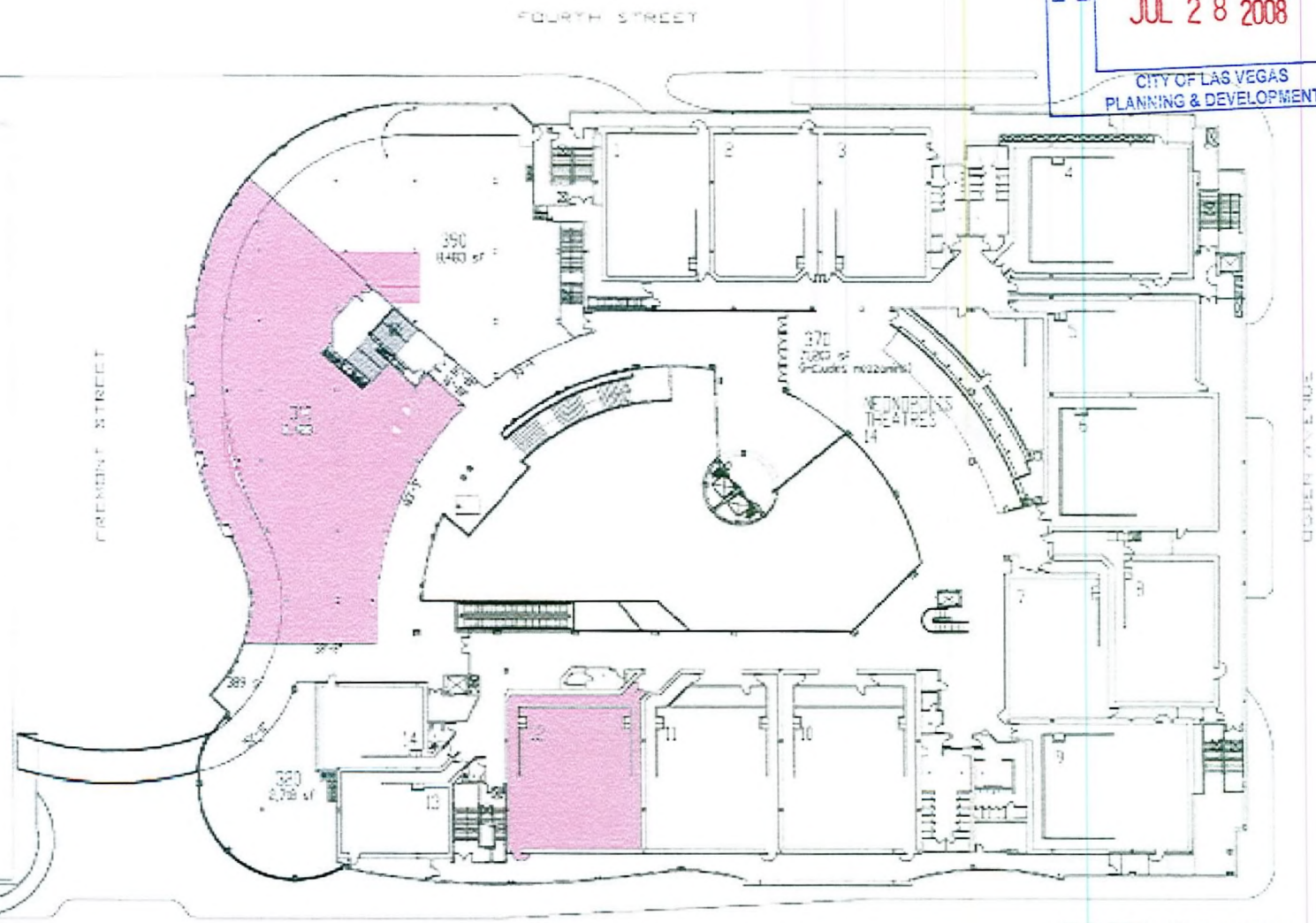

**NOTE**  
 Telemundo Las Vegas Inc. Located at 450 Fremont Street Suite 310 Las Vegas, NV 89101  
 Total space included in Special use permit: 17,500 square feet.  
 1. 12,500 square feet of office and broadcast TV space  
 2. 5,000 square feet of studio space (Theatre 12)

**SUP-29194**  
**09/11/08 PC**

**NEONOPOLIS**

**LEASING AGENT**  
 JES ANDRONE  
 P.O. BOX 2007  
 LAS VEGAS, NV 89101

**DEVELOPER**  
 VEGAS ENTERTAINMENT  
 CENTERS  
 P.O. BOX 1009

**ARCHITECT**  
 STEVENS ARCHITECTS  
 300 SOUTH MAIN STREET  
 LAS VEGAS, NV 89101



LEVEL THREE LEA

