



PLANNING & DEVELOPMENT DEPARTMENT

STATEMENT OF FINANCIAL INTEREST

Case Number: **SDR-29203** APN: 162-02-403-002

Name of Property Owner: Nevada Power

Name of Applicant: Nevada Power

Name of Representative: Scott Ruedy, WRG Design Michelle Baltz, Nevada Power

To the best of your knowledge, does the Mayor or any member of the City Council or Planning Commission have any financial interest in this or any other property with the property owner, applicant, the property owner or applicant's general or limited partners, or an officer of their corporation or limited liability company?

Yes

No

If yes, please indicate the member of the City Council or Planning Commission who is involved and list the name(s) of the person or persons with whom the City Official holds an interest. Also list the Assessor's Parcel Number if the property in which the interest is held is different from the case parcel.

City Official: _____

Partner(s): _____

APN: _____

Signature of Property Owner: *James R. Soavere*

Print Name: James R Soavere

Subscribed and sworn before me

This 25th day of July, 2008

Cathy Mason
Notary Public in and for said County and State



LANDSCAPE MATERIAL SCHEDULE					
SIZE	DESCRIPTION	BOTANICAL NAME	QUANTITY	SYMBOL	COMMENT
4" THICK	COLORED GRANITE CURB	N/A	18,356 SF		4" THICK
4" DIA.	ORNAMENTAL IRIDOP	RAECHARRS XID VITANAL	41 1A		
5" DIA.	FERRY QUINCE	CALLIANDRA PEDICULARIS	77 1A		
5" DIA.	CONTACT TEXAS RANGER	LEUCOPYXNUM	39 1A		
24" DIA.	ARGENTINE MESQUITE	PROSORPIS ALBA	57 1A		

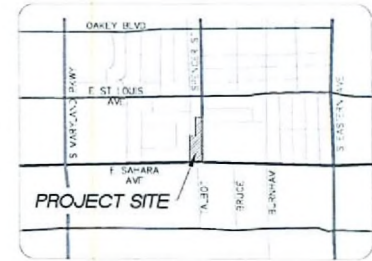

VICINITY MAP
N.T.S.

NOTE:
THESE DRAWINGS ARE CONCEPTUAL BY NATURE AND
DISPECT INFORMATION FOR PLANNING AND LAND-USE
SUBMITTAL PURPOSES ONLY. FINAL ENGINEERING
DESIGN DRAWINGS MAY VARY DUE TO SITE-SPECIFIC
CONSTRAINTS OR CITY OF LAS VEGAS SPECIFICATIONS.

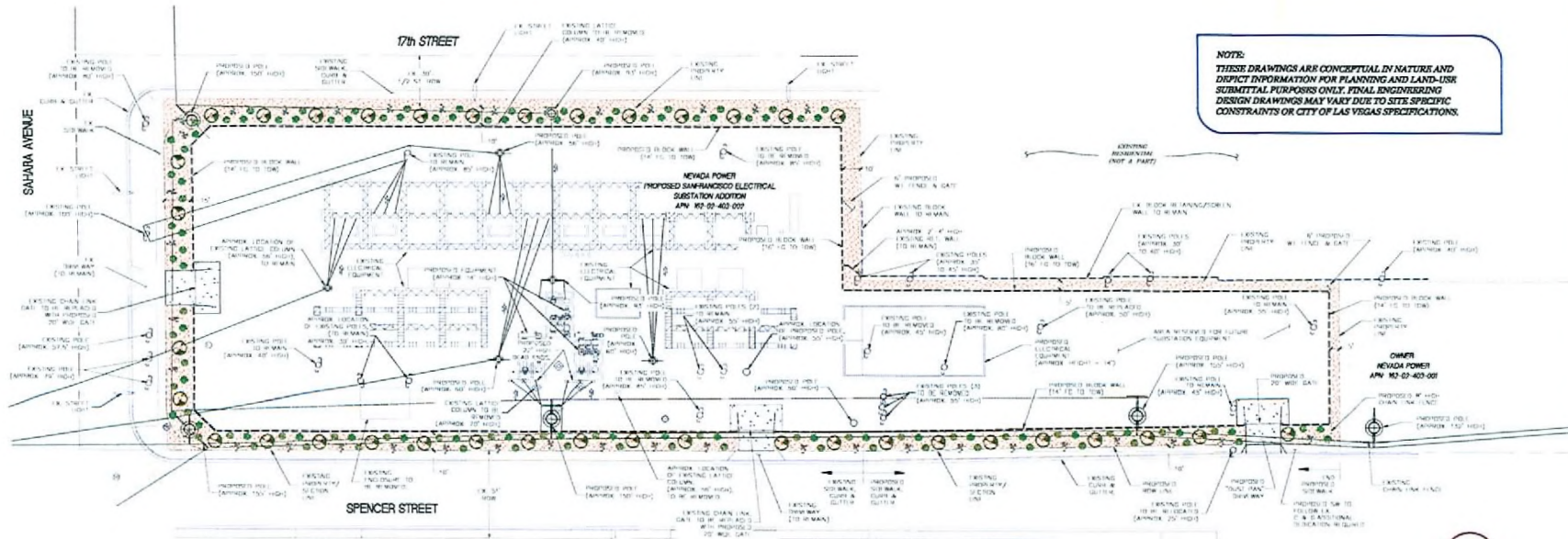

NOTE:
REMOVE EXISTING 4" HIGH CHAIN LINK FENCE
AND LANDSCAPE BLOCK WALL IN AREA OF
RELOCATED AIR STATION IN PLACE WITH 18" BLOCK
WALL AND SYSTEM.

RECEIVED
AUG 20 2008



Fig 1
of 2

SDR-29203
09/11/08 PC
REVISED

REVISED
APPROVAL
DATE
BY

SAN FRANCISCO SUBSTATION
USE PERMIT - SITE PLAN

