



PLANNING & DEVELOPMENT DEPARTMENT

Orig

STATEMENT OF FINANCIAL INTEREST

Case Number: SUP-29227 APN: 139-25-405-009

Name of Property Owner: D.I. Properties Inc

Name of Applicant: D.I. Properties Inc

Name of Representative: Law Offices of Jay Brown

To the best of your knowledge, does the Mayor or any member of the City Council or Planning Commission have any financial interest in this or any other property with the property owner, applicant, the property owner or applicant's general or limited partners, or an officer of their corporation or limited liability company?

[] Yes

[X] No

If yes, please indicate the member of the City Council or Planning Commission who is involved and list the name(s) of the person or persons with whom the City Official holds an interest. Also list the Assessor's Parcel Number if the property in which the interest is held is different from the case parcel.

City Official: _____

Partner(s): _____

APN: _____

Signature of Property Owner: [Signature]

Print Name: SAM E. HAMIKO

Subscribed and sworn before me

This 29 day of July, 2009
Elizabeth Mendoza
Notary Public in and for said County and State

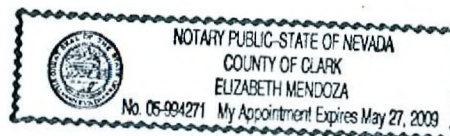

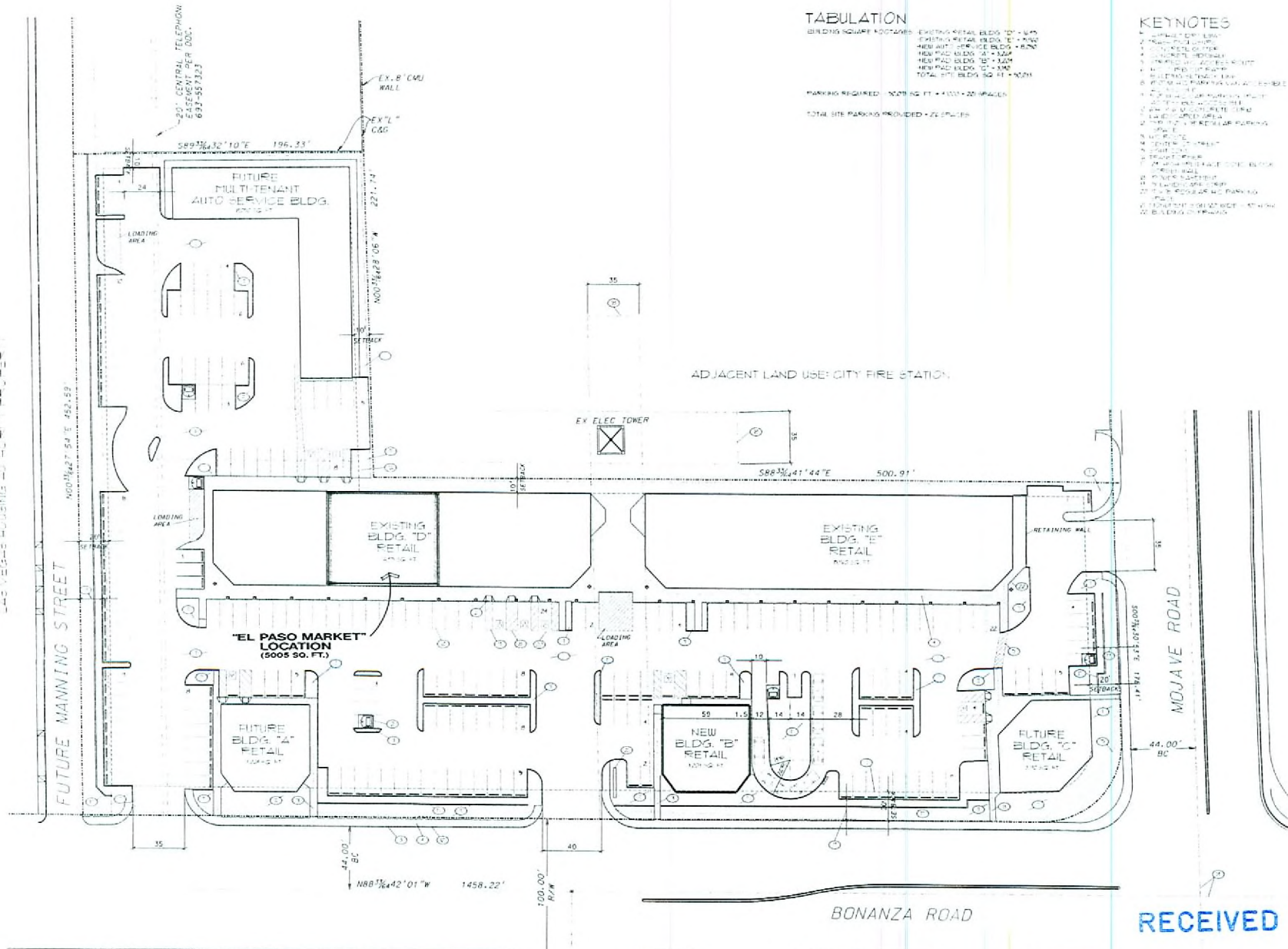

TABULATION

BUILDING SQUARE FOOTAGES: EXISTING RETAIL BLDG. 'D' - 14,000
 EXISTING RETAIL BLDG. 'E' - 14,000
 NEW BLDG. 'B' - 12,000
 NEW PAD BLDG. 'A' - 12,000
 NEW PAD BLDG. 'C' - 12,000
 NEW PAD BLDG. 'D' - 12,000
 TOTAL SITE BLDG. SQ. FT. - 60,000

PARKING REQUIRED - 1,000 (10 FT. x 20 FT.) SPACES
 TOTAL SITE PARKING PROVIDED - 22 SPACES

KEYNOTES

1. EXISTING DRIVEWAY
2. EXISTING DRIVEWAY
3. EXISTING DRIVEWAY
4. EXISTING DRIVEWAY
5. EXISTING DRIVEWAY
6. EXISTING DRIVEWAY
7. EXISTING DRIVEWAY
8. EXISTING DRIVEWAY
9. EXISTING DRIVEWAY
10. EXISTING DRIVEWAY
11. EXISTING DRIVEWAY
12. EXISTING DRIVEWAY
13. EXISTING DRIVEWAY
14. EXISTING DRIVEWAY
15. EXISTING DRIVEWAY
16. EXISTING DRIVEWAY
17. EXISTING DRIVEWAY
18. EXISTING DRIVEWAY
19. EXISTING DRIVEWAY
20. EXISTING DRIVEWAY

REVISIONS	BY

BONANZA / MOJAVE RETAIL CENTER
 NEW RETAIL PAD BLDG. 'B'
 BONANZA ROAD & MOJAVE ROAD



ARCHITECTURE
 DESIGN AND
 DEVELOPMENT

702-382-0427
 fax: 382-0952

200 W. Charleston Blvd. Suite 201
 Las Vegas, NV 89102

SITE PLAN

RECEIVED

JUL 29 2008

SUP-29227
09/11/08 PC

SITE PLAN

07/17/2008

