



PLANNING & DEVELOPMENT DEPARTMENT

STATEMENT OF FINANCIAL INTEREST

Case Number: SUP-28315 APN: 163-05-116-005

Name of Property Owner: Fort Apache Commons Park LLC

Name of Applicant: VIA BRASIL STEAK HOUSE

Name of Representative: Law Offices of Jay Brown: contact Lora Dreja

To the best of your knowledge, does the Mayor or any member of the City Council or Planning Commission have any financial interest in this or any other property with the property owner, applicant, the property owner or applicant's general or limited partners, or an officer of their corporation or limited liability company?

Yes

No

If yes, please indicate the member of the City Council or Planning Commission who is involved and list the name(s) of the person or persons with whom the City Official holds an interest. Also list the Assessor's Parcel Number if the property in which the interest is held is different from the case parcel.

City Official: _____

Partner(s): _____

APN: _____

Signature of Property Owner: [Handwritten Signature]

Print Name: J De Hart

Subscribed and sworn before me

This 5th day of April, 2008

[Handwritten Signature]
Notary Public in and for said County and State

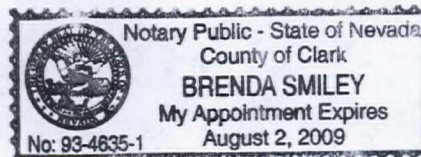

SITE PLAN FOR PECCOLE RANCH - FORT APACHE COMMONS

A PORTION OF THE NORTH WEST QUARTER (1/4) OF SECTION 5, TOWNSHIP 21 SOUTH, RANGE 60 EAST, M.D.M., CITY OF LAS VEGAS, CLARK COUNTY, NEVADA

BASIS OF BEARINGS
 NORTH BEARING EAST, BEING THE BEARING OF THE SOUTH LINE OF THE SOUTHWEST QUARTER (SW 1/4) OF SECTION 5, TOWNSHIP 21 SOUTH, RANGE 60 EAST, SOUTH BEARING MEASURED AS SHOWN ON THAT SECTION PLAT ON FILE IN THE OFFICE OF THE CLARK COUNTY RECORDER IN BOOK 45, PAGE 83 OF PLATS.

BENCHMARK
 NATIONAL GEODETIC VERTICAL BENCHMARK OF 1929 (DATE USED) - UNDESIGNED, METAL PLATE IN TOP OF CURB OF FORT APACHE ROAD, 158' SOUTH OF RED HILLS ROAD, EAST CURB LINE, CITY OF LAS VEGAS, NEVADA. ELEVATION = 3750.521 (FOR CONVERSION TO 1988 DATUM, ADD 2.45')

ASSESSORS PARCEL NUMBER
 163-05-110-003

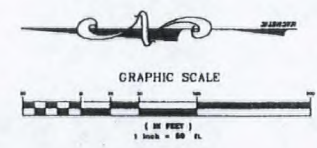

LAND USE TABULATION

PARCEL	EXISTING ZONING	PROPOSED ZONING	GROSS ACRES
	C-1	C-1	8.372

PARKING DATA

BUILDING	SIZE	REQUIRED PARKING	PARKING PROVIDED
OFFICE (1 SPACE PER 300 SF)	22,810 SQ. FT.	100 SPACES	-
TAVERN (1 SPACE PER 50 SF SEATING, PLUS 1 SPACE PER 100 SF REMAINING 1800 SF)	5,000 SQ. FT. PLUS 1800 SF	78 SPACES	-
REST. (1 SPACE PER 250 SF)	28,130 SQ. FT.	97 SPACES	-
TOTAL PARKING		287 SPACES	115 SPACES
MINI GOLF (existing)	8,800 SQ. FT.	100 SPACES	84 SPACES
PIZZA RESTAURANT (existing)	5,000 SQ. FT.	78 SPACES	87 SPACES
BAR/RESTAURANT (existing)	5,000 SQ. FT.	78 SPACES	98 SPACES
TOTAL SITE PARKING		483 SPACES	343 SPACES

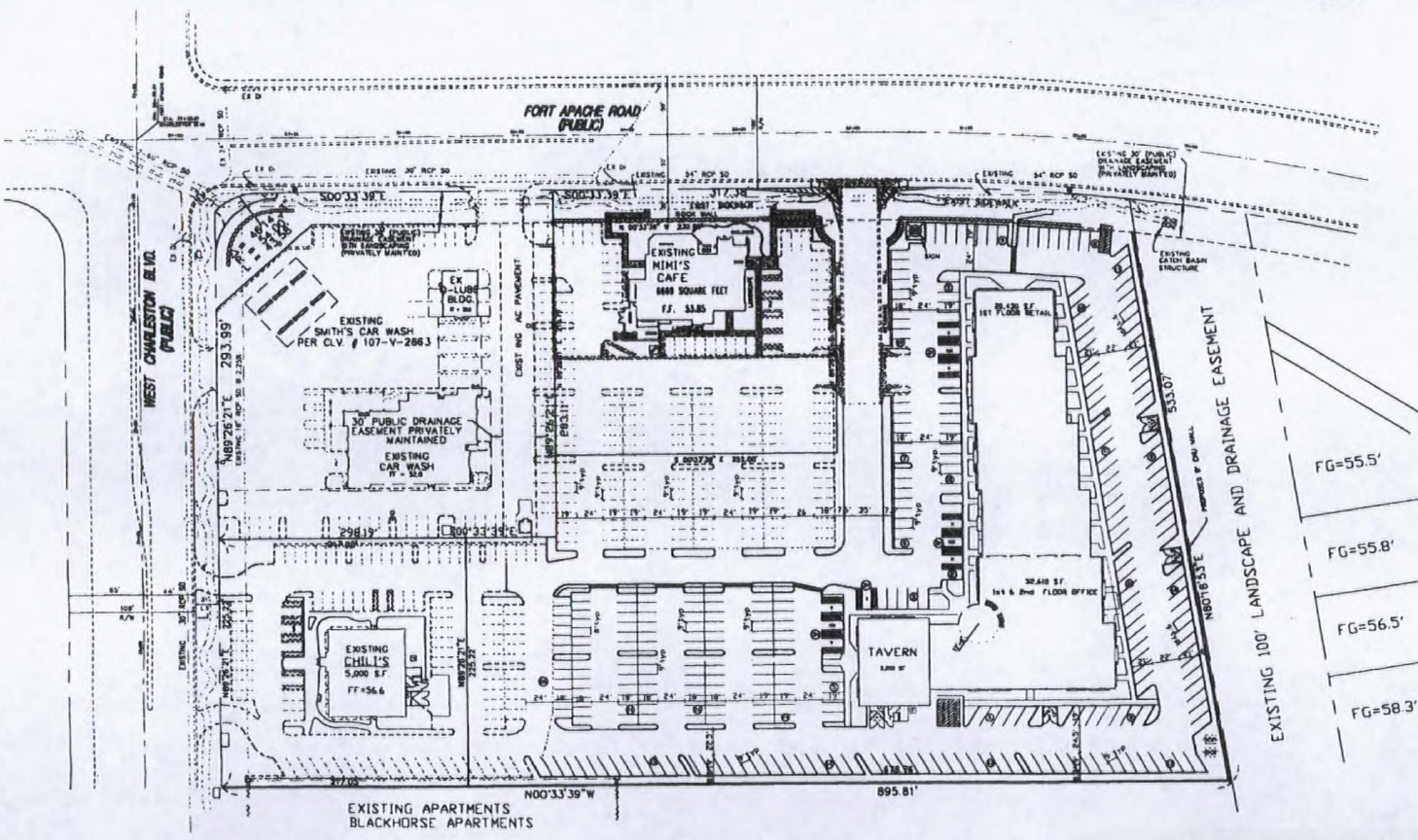

Call before you Dig. 1-800-287-2800
 Call before you OVERHEAD. 1-702-893-8811

GENERAL NOTES

- ALL IMPROVEMENTS SHALL CONFORM TO LATEST REVISED STANDARD SPECIFICATIONS AND ORDINANCES FOR PUBLIC WORKS CONSTRUCTION, CITY OF LAS VEGAS, NEVADA.
- UTILITY EASEMENTS TO BE DEDICATED TO THEIR RESPECTIVE AGENCIES.
- UTILITY SERVICES TO BE PROVIDED BY: LAS VEGAS VALLEY WATER DISTRICT, CITY OF LAS VEGAS - COMMUNITY SERVICES, CENTRAL TELEPHONE COMPANY, SILVER STATE DISPOSAL, BULHIMER GAS SUPPLY/COMPANY, NEVADA POWER COMPANY.

SUP-28315
07/10/08 PC

RECEIVED
 MAY 27 2008

PROJECT: FORT APACHE COMMONS
 DESIGNER: CDS
 DRAWN BY: LGA

JOB NO. 02-2001-601
 SHEET NO. 1 OF 1

PECCOLE NEVADA CORPORATION
 1630 S. FORT APACHE BLVD., SUITE 100
 LAS VEGAS, NEVADA 89119
 PHONE (702) 484-1300 FAX (702) 484-1309

AMEC Infrastructure, Inc.
 1630 S. FORT APACHE BLVD., SUITE 100
 LAS VEGAS, NEVADA 89119
 PHONE (702) 484-1300 FAX (702) 484-1309

P:\2001\601\fort-apache-commons\10-12-40\TAV-55003.dwg, 11/22/2002, 10:55:50 AM, LQA

SEATING COUNT	
BAR	150
BAR	150
TOTAL	300

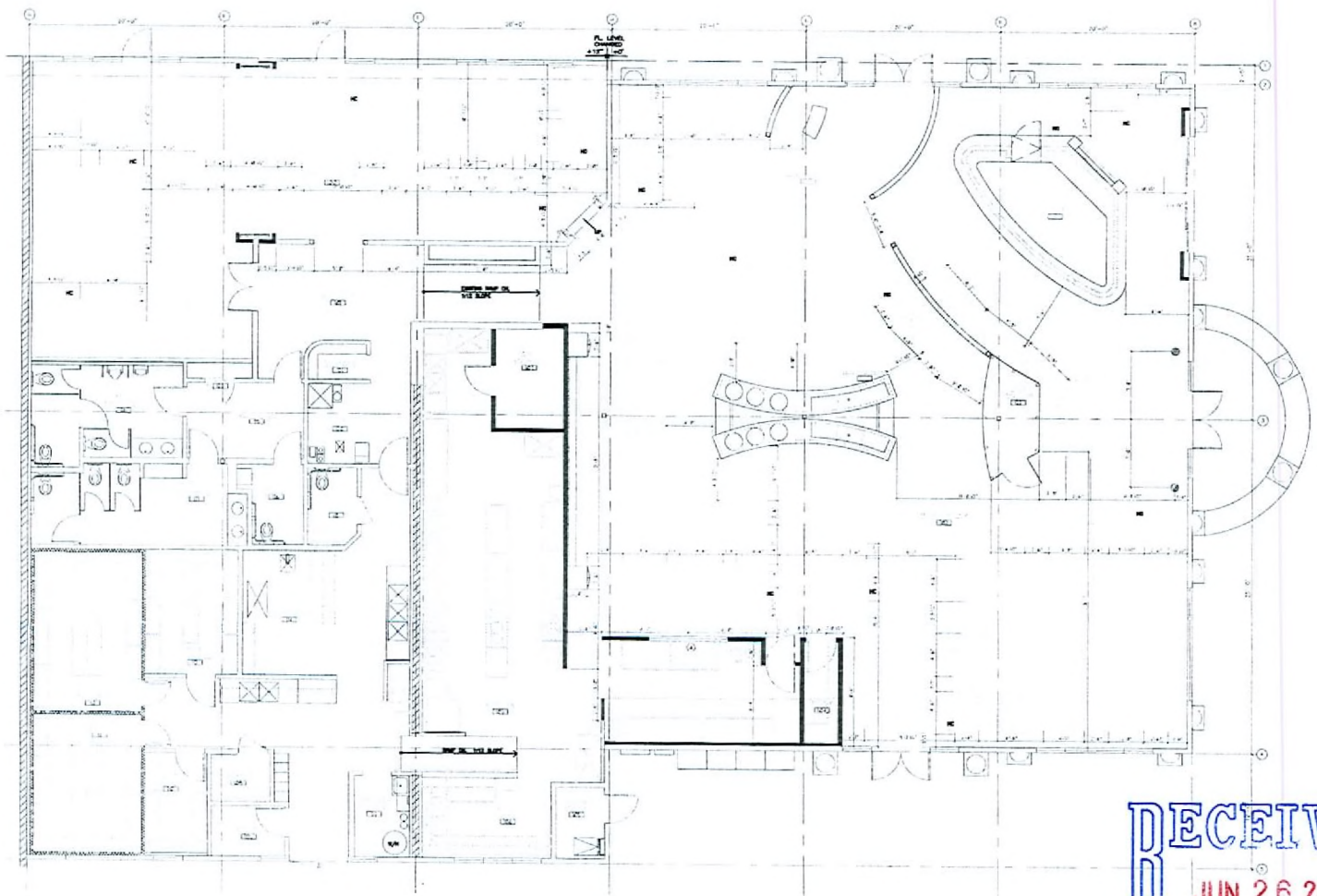

FLOOR PLAN
VIA BRASIL STEAKHOUSE
 1225 FT. APACHE ROAD
 LAS VEGAS, NV

NO.	DATE	BY

RECEIVED
 JUN 26 2008



SUP-28315
07/10/08 PC
REVISED



A1.00S