



# PLANNING & DEVELOPMENT DEPARTMENT

## STATEMENT OF FINANCIAL INTEREST

Case Number: EOT-28697 APN: Please see attached list

Name of Property Owner: Nevada Equities, LLC

Name of Applicant: Nevada Equities, LLC

Name of Representative: Baughman & Turner, Inc. (Gil Nockowitz)

To the best of your knowledge, does the Mayor or any member of the City Council or Planning Commission have any financial interest in this or any other property with the property owner, applicant, the property owner or applicant's general or limited partners, or an officer of their corporation or limited liability company?

Yes

No

If yes, please indicate the member of the City Council or Planning Commission who is involved and list the name(s) of the person or persons with whom the City Official holds an interest. Also list the Assessor's Parcel Number if the property in which the interest is held is different from the case parcel.

City Official: \_\_\_\_\_

Partner(s): \_\_\_\_\_

APN: \_\_\_\_\_

Signature of Property Owner: 

Print Name: Craig Burr

Subscribed and sworn before me

This 18<sup>th</sup> day of JUNE, 2008

Jamie Spring  
Notary Public in and for said County and State



**Existing APN numbers:**

138-35-517-001 thru 006

138-35-517-013 thru 030

138-35-517-059 thru 070

**EOT-28697  
08-06-08 CC**

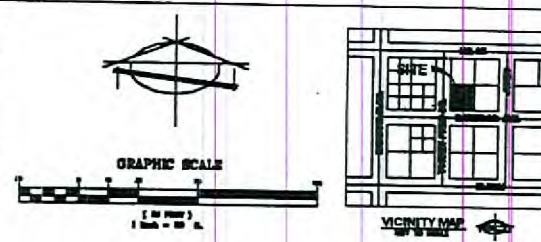
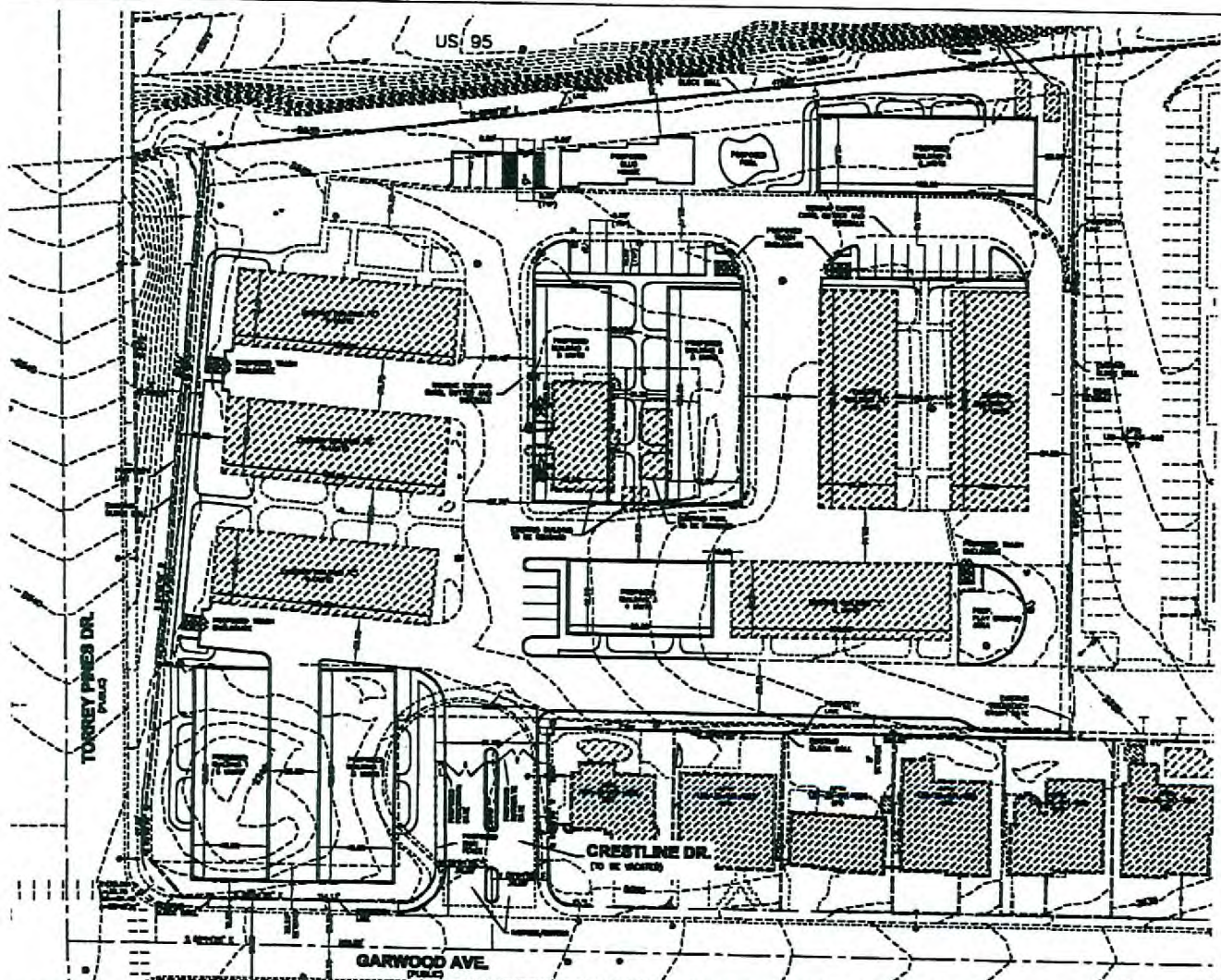

**LEGEND**

--- (dashed line)	PROPERTY LINE
--- (long dashed line)	EXISTING STRUCTURE
--- (short dashed line)	NEW WALL
--- (dash-dot line)	EXISTING STRUCTURE LINE
--- (dotted line)	PROPOSED WALL LINE
--- (dash-dot-dot line)	EXISTING "T" MARK & CURB
--- (solid line)	EXISTING STRUCTURE LINE
--- (thick solid line)	NEW, BUILT WALL

**SITE DATA**

OWNER'S NAME: [REDACTED]      10-15-07-01 TRAY DR  
 ADDRESS: [REDACTED]      1000 201 Y ST DRIVE, # 1000, SAN  
 CITY: [REDACTED]      BERKELEY, CALIFORNIA  
 COUNTY: [REDACTED]      COUNTY OF ALAMEDA, DISTRICT 9-2 & 3-3  
 ZONING: [REDACTED]      1000 201 Y ST DRIVE, # 1000, SAN  
 CITY: [REDACTED]      BERKELEY, CALIFORNIA

**UTILITIES**

WATER: [REDACTED]      SAN PIEDRO WATER CO. WATER  
 SEWER: [REDACTED]      CITY OF SAN PIEDRO  
 GAS: [REDACTED]      BERKELEY GAS COMPANY  
 POWER: [REDACTED]      BERKELEY GAS COMPANY  
 TELEPHONE: [REDACTED]      BERKELEY GAS COMPANY  
 CABLE: [REDACTED]      BERKELEY GAS COMPANY

**REQUIRED PARKING DATA**

TYPE: [REDACTED]      1000 201 Y ST DRIVE, # 1000, SAN  
 CITY: [REDACTED]      BERKELEY, CALIFORNIA  
 COUNTY: [REDACTED]      COUNTY OF ALAMEDA, DISTRICT 9-2 & 3-3  
 ZONING: [REDACTED]      1000 201 Y ST DRIVE, # 1000, SAN  
 CITY: [REDACTED]      BERKELEY, CALIFORNIA

**EXISTING PARKING**

NUMBER OF SPACES: [REDACTED]  
 TYPE: [REDACTED]

**OWNER/DEVELOPER**

NAME: [REDACTED]  
 ADDRESS: [REDACTED]  
 CITY: [REDACTED]  
 STATE: [REDACTED]  
 ZIP: [REDACTED]

**L DESCRIPTION**

THIS PLAN IS A PRELIMINARY PLAN AND IS NOT TO BE USED FOR CONSTRUCTION. IT IS THE RESPONSIBILITY OF THE OWNER TO OBTAIN ALL NECESSARY PERMITS AND APPROVALS FROM THE LOCAL AGENCIES. THE OWNER SHALL BE RESPONSIBLE FOR OBTAINING ALL NECESSARY PERMITS AND APPROVALS FROM THE LOCAL AGENCIES. THE OWNER SHALL BE RESPONSIBLE FOR OBTAINING ALL NECESSARY PERMITS AND APPROVALS FROM THE LOCAL AGENCIES.

**BASE OF BEARING**

THE BEARING IS GIVEN AS IN THE NORTH OF THE LINE UP TO THE POINT OF BEGINNING. THE BEARING IS GIVEN AS IN THE NORTH OF THE LINE UP TO THE POINT OF BEGINNING.

**BENCHMARK**

THE BENCHMARK IS A POINT OF BEGINNING. THE BENCHMARK IS A POINT OF BEGINNING.

**FLOOD ZONE DATA**

THE FLOOD ZONE DATA IS A POINT OF BEGINNING. THE FLOOD ZONE DATA IS A POINT OF BEGINNING.

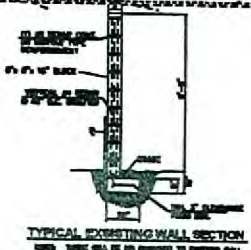

**DISCLAIMER NOTE**

THIS PLAN IS A PRELIMINARY PLAN AND IS NOT TO BE USED FOR CONSTRUCTION. IT IS THE RESPONSIBILITY OF THE OWNER TO OBTAIN ALL NECESSARY PERMITS AND APPROVALS FROM THE LOCAL AGENCIES. THE OWNER SHALL BE RESPONSIBLE FOR OBTAINING ALL NECESSARY PERMITS AND APPROVALS FROM THE LOCAL AGENCIES.

**EOT-28697**  
**08-06-08 CC**

RECEIVED  
 JUN 19 2008

**BAUGHMAN & TURNER, INC.**  
 CIVIL ENGINEERS  
 1710 HIDDEN STREET, SUITE 200  
 BERKELEY, CALIFORNIA 94709  
 PHONE (925) 875-8771 FAX (925) 875-8772

**EMERALD CREST**  
 SITE PLAN  
 SECTION 25, TOWNSHIP 20 NORTH, RANGE 10 EAST, MARIANA N  
 CITY OF SAN PIEDRO, ALAMEDA COUNTY, CALIFORNIA  
 TORREY PINES DR. AND GARWOOD AVE. A/E/10-08-07-000