

CALIFORNIA JURAT WITH AFFIANT STATEMENT

- See Attached Document (Notary to cross out lines 1-6 below)
- See Statement Below (Lines 1-5 to be completed only by document signer[s], *not* Notary)

(Signature lines are crossed out with diagonal lines)

Signature of Document Signer No. 1

Signature of Document Signer No. 2 (if any)

State of California
County of Los Angeles

Subscribed and sworn to (or affirmed) before me on this
15 day of May, 20 08, by

(1) Larisa Pappaort
Name of Signer

proved to me on the basis of satisfactory evidence to be the person who appeared before me (.) (,)

(and

(2) _____
Name of Signer

proved to me on the basis of satisfactory evidence to be the person who appeared before me.)

Signature Nicole Bonfond
Signature of Notary Public



Place Notary Seal Above

OPTIONAL

Though the information below is not required by law, it may prove valuable to persons relying on the document and could prevent fraudulent removal and reattachment of this form to another document.

Further Description of Any Attached Document

Title or Type of Document: _____

Document Date: _____ Number of Pages: _____

Signer(s) Other Than Named Above: _____

RIGHT THUMBPRINT OF SIGNER #1
Top of thumb here

RIGHT THUMBPRINT OF SIGNER #2
Top of thumb here

The A-Mall

SOUTH MARYLAND PARKWAY

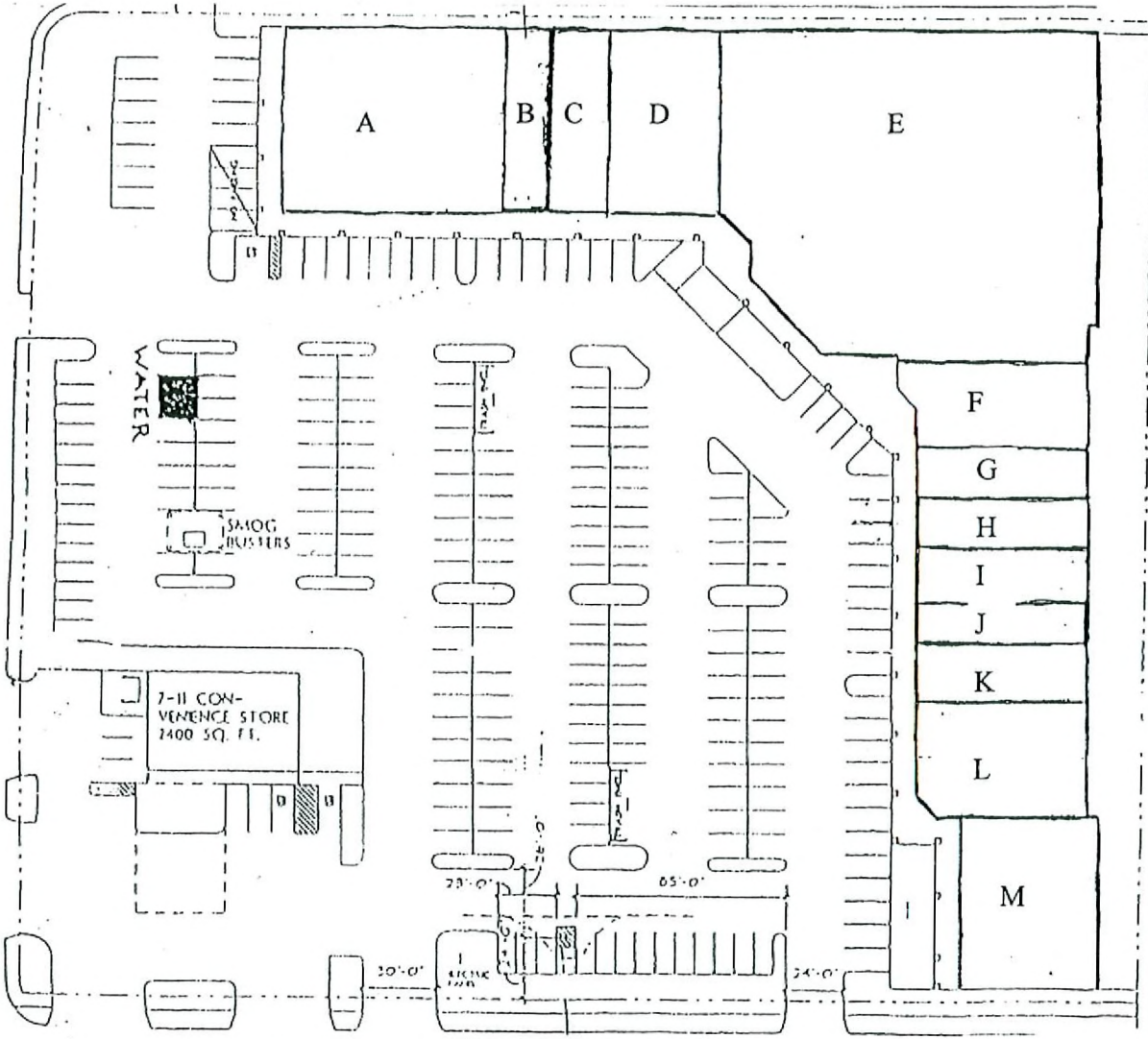

- A—Vacant 5659 SF
- B—Vacant 1680 SF
- C—Tropical Hut 3360 S
- D—Pinoy Pinay 3350 SI
- E—Best Buy Furniture 17,822 SF
- F—Cheerful Chinese 23
- G—Gala Travel 1400 SI
- H—Vacant 1400 SF
- I—On the Wild Side Tatt 1680 SF
- J—Easy Cellular 1100 S
- K—Pet Set 1680 SF
- L—Pawn Plus IV 3880 :
- M—Royal Frog 3750 SI

STAFF

SAHARA AVENUE

1205 East Sahara Ave
Las Vegas, Nevada

RQR-28265
07-02-08 CC