



PLANNING & DEVELOPMENT DEPARTMENT

STATEMENT OF FINANCIAL INTEREST

Case Number: **SUP-29439** APN: 163-02-415-014

Name of Property Owner: Fanny NG / NG Family Trust

Name of Applicant: SUJATHA MOCHERLA

Name of Representative: _____

To the best of your knowledge, does the Mayor or any member of the City Council or Planning Commission have any financial interest in this or any other property with the property owner, applicant, the property owner or applicant's general or limited partners, or an officer of their corporation or limited liability company?

Yes

No

If yes, please indicate the member of the City Council or Planning Commission who is involved and list the name(s) of the person or persons with whom the City Official holds an interest. Also list the Assessor's Parcel Number if the property in which the interest is held is different from the case parcel.

City Official: _____

Partner(s): _____

APN: _____

Signature of Property Owner: [Handwritten Signature]

Print Name: FANNY NG

Subscribed and sworn before me

This 11 day of August, 2008

Brian Soo

Notary Public in and for said County and State
Los Angeles, California



SITE INFOR

ZONING - City of Las Vegas
 C-1 Commercial District
 PARCEL AREA
 ADJ. AREA
 F.A.R. (max)

PARKING REQUIREMENTS:
 Minimum
 Code Minimum: 1 per 50 of
 Service 1 per 200 ft.
 Provided:
 Ratio Provided: 1 per 7
 Total Parking Required:
 Total Parking Provided:

Handicapped Spaces
 Required:
 Provided:
SETBACKS
 Front:
 Rear:
 Side:
 Corner Street Side:
BUILDING HEIGHT
 Allowed:
 Provided:
LOT COVERAGE
 Allowed:
 Provided:

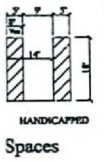

RAINBOW

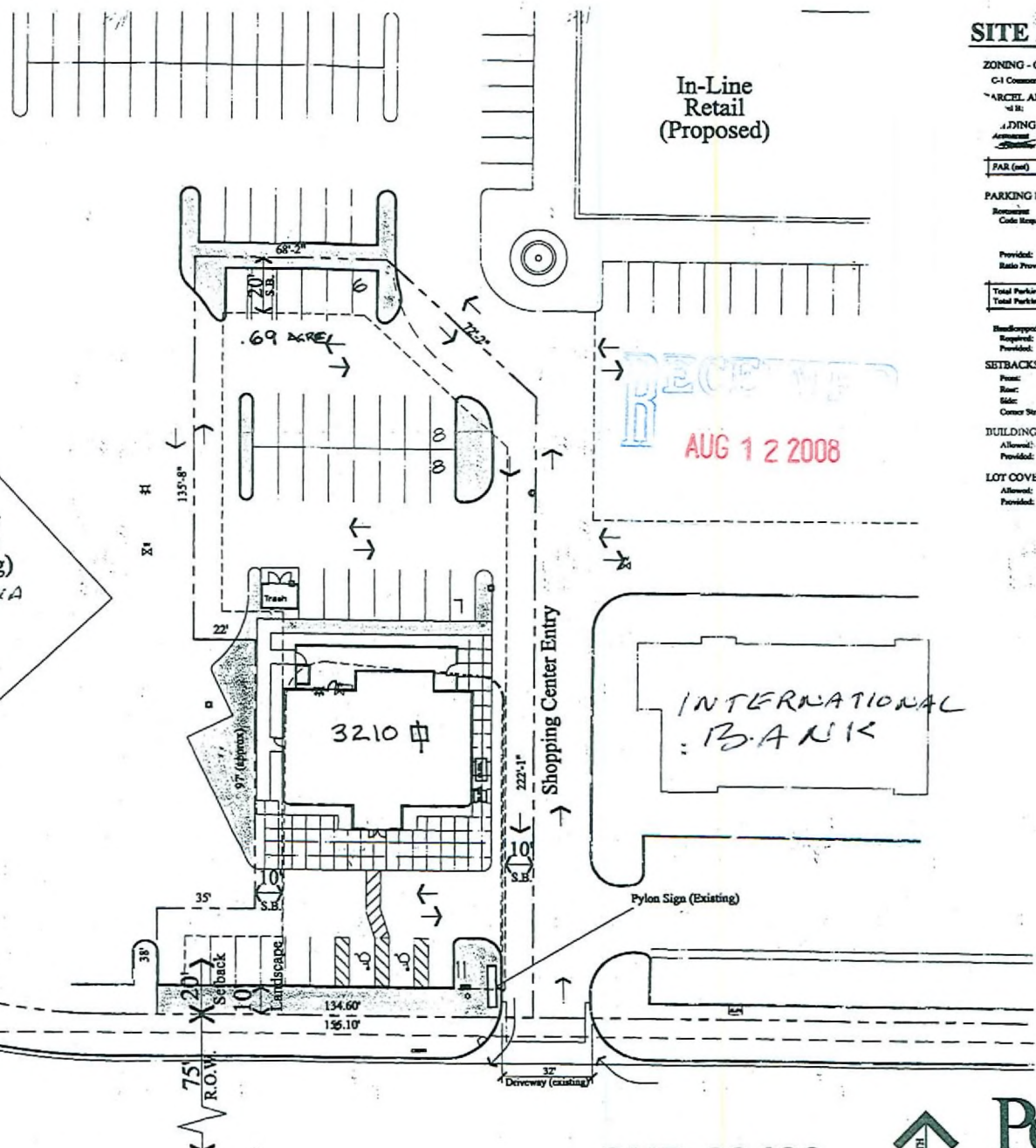

In-Line Retail (Proposed)

WEST SAHARA AVE

SUP-29439
09/25/08 PC

Perlr ARCH
 2450 Chandler Ave., Sui
 Las Vegas, NV 89120
 702.261.0511

© COPYRIGHT 1997, PERLMAN ARCH

