



PLANNING & DEVELOPMENT DEPARTMENT

STATEMENT OF FINANCIAL INTEREST

Case Number: GPA-28312 APN: 140-29-801-001

Name of Property Owner: City of Las Vegas

Name of Applicant: City of Las Vegas

Name of Representative: Michael Vlaovich

To the best of your knowledge, does the Mayor or any member of the City Council or Planning Commission have any financial interest in this or any other property with the property owner, applicant, the property owner or applicant's general or limited partners, or an officer of their corporation or limited liability company?

Yes

No

If yes, please indicate the member of the City Council or Planning Commission who is involved and list the name(s) of the person or persons with whom the City Official holds an interest. Also list the Assessor's Parcel Number if the property in which the interest is held is different from the case parcel.

City Official: _____

Partner(s): _____

APN: _____

Signature of Property Owner: *[Handwritten Signature]*

Print Name: MICHAEL J. VLAOVICH
PROJECT MANAGER

Subscribed and sworn before me

This 21st day of May, 2008

Rosana G. Cogle

Notary Public in and for said County and State

RECEIVED
MAY 27 2008

City of Las Vegas Vicinity Map

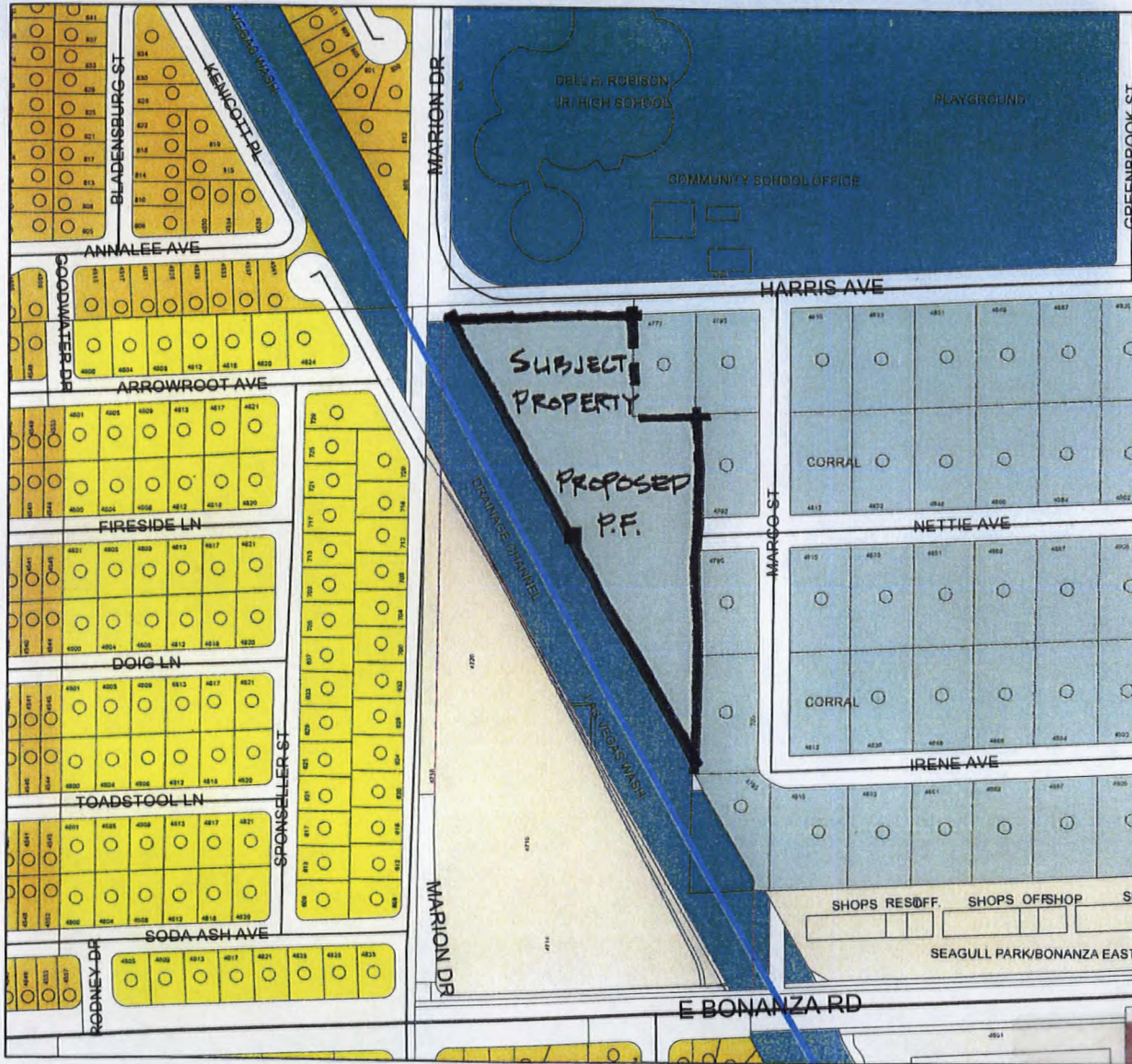

General Plan Designations

- Rural Neighborhood Preservation
- Rural Estates
- Desert Rural
- Rural
- Low
- Medium - Low
- Medium - Low Attached
- Medium
- High
- Office
- Service Commercial
- General Commercial
- Tourist Commercial
- Las Vegas Medical District
- Light Industrial / Research
- Planned Community Development
- Traditional Neighborhood Development
- Downtown Redevelopment Area
- Parks/Recreation/Open Space
- Public Facility
- Public Facility - School
- Public Facility - Clark County
- Town Center
- Resource Conservation
- Downtown - Commercial
- Downtown - Mixed Use
- Not in City
- Right - of - Way



RECEIVED
MAY 27 2008

**SDR-28313
GPA-28312
ZON-28311
07/10/08 PC**

LAS VEGAS WASH PARK PHASE 2

OFFICE OF ARCHITECTURAL SERVICES

LAS VEGAS

NEVADA

JUNE, 2008



PLANT LEGEND

KEY	BOTANICAL NAME / COMMON NAME	SIZE
TREES		
	OLEIFERA FRAXINIFOLIA / MORAME HONEY LOCUST	24' BOX
	SOPHORA SECONDFLORA / TEXAS MOUNTAIN LAUREL	24' BOX
	X. DENTATA / TEXAS REDWOOD	24' BOX
	ACACIA ANEURA / MILDSA TREE	24' BOX
	PINUS EDULIS / MONDEL PINE	24' BOX
SHRUBS		
	BACCHARIS SAROTHROIDES / DESERT BROOM	5 GAL.
	CAESALPINIA PULCHERRIMA / RED BIRD OF PARADISE	5 GAL.
	HESPERALOE PARVIFLORA / RED YUCCA	5 GAL.
	LEUCOPRYLLA CANDOLLEI / TEXAS RANGER	5 GAL.
	SALVIA GREGGII / AUTUMN SAGE	5 GAL.
	YUCCA RECURVIFOLIA / WEEPING YUCCA	5 GAL.
GROUND COVER		
	ACACIA REDOLENS / CREEPING ACACIA	1 GAL. AT 8" OC
	LANTANA MONTEVIDENSIS / TRAILING LANTANA	1 GAL. AT 2" OC
	MYOPORUM PARVIFOLIUM / PROSTRATE MYOPORUM	1 GAL. AT 8" OC
DECOMPOSED GRANITE BY SHADE COLOR TO BE APACHE GOLD		

RECEIVED

JUN 18 2008

PAGE OF

GPA-28312 ZON-28311
 WVR-28569 SDR-28313
 07/10/08 PC REVISED



