



PLANNING & DEVELOPMENT DEPARTMENT

STATEMENT OF FINANCIAL INTEREST

Case Number: ROC-27304 APN: 125-05-510-002

Name of Property Owner: D.R. Horton

Name of Applicant: D.R. Horton

Name of Representative: _____

To the best of your knowledge, does the Mayor or any member of the City Council or Planning Commission have any financial interest in this or any other property with the property owner, applicant, the property owner or applicant's general or limited partners, or an officer of their corporation or limited liability company?

Yes

No

If yes, please indicate the member of the City Council or Planning Commission who is involved and list the name(s) of the person or persons with whom the City Official holds an interest. Also list the Assessor's Parcel Number if the property in which the interest is held is different from the case parcel.

City Official: _____

Partner(s): _____

APN: _____

Signature of Property Owner: 

Print Name: JAMES FRASURE

Subscribed and sworn before me

This 11th day of March, 2008

Barbara A. Bross

Notary Public in and for said County and State

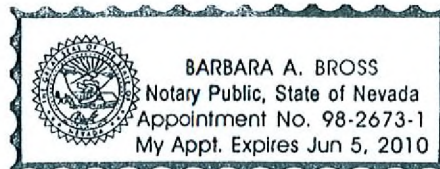

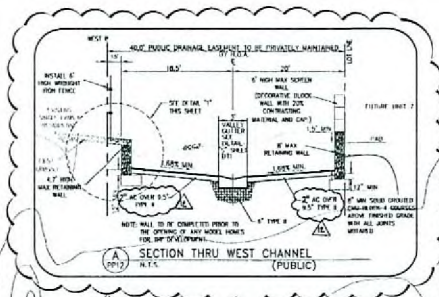
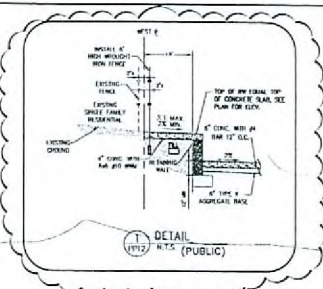

NOTE:
CONTRACTOR TO VERIFY THE HORIZONTAL AND VERTICAL LOCATION OF EXISTING UTILITIES PRIOR TO CONSTRUCTION. REPORT ANY DISCREPANCIES TO ENGINEER IMMEDIATELY.

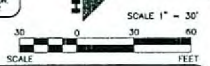

BENCHMARK
CITY OF LAS VEGAS VERTICAL CONTROL
CITY OF LAS VEGAS PIN REFLECTION
1/4" CONCRETE PIN 1000 0 MOCCAMM AND CHAMBERLAIN
ELEVATION: 726.870 METERS (2417.00 FEET)

BASS OF BEARINGS
NORTH 00°27'00" WEST BEING THE BEARING OF THE WEST LINE OF THE NORTHWEST QUARTER (NW 1/4) OF SECTION 4, TOWNSHIP 36 NORTH, RANGE 12 EAST, MERIDIAN OF LAS VEGAS, CLARK COUNTY, NEVADA, AND SOUTHWEST CORNER THEREOF ON FILE IN FILE 100, PAGE 09 OF PARCEL MAPS IN THE CLARK COUNTY RECORDER'S OFFICE, CLARK COUNTY, NEVADA.



Call before you Dig
Under Ground
1-800-227-2600
1-702-452-7611
1-702-220-6611

WEST CHANNEL
(PUBLIC DRAINAGE EASEMENT TO BE PRIVATELY MAINTAINED)

PLAN AND PROFILE
SCALE
HORIZ 1" = 30'
VERT 1" = 3'

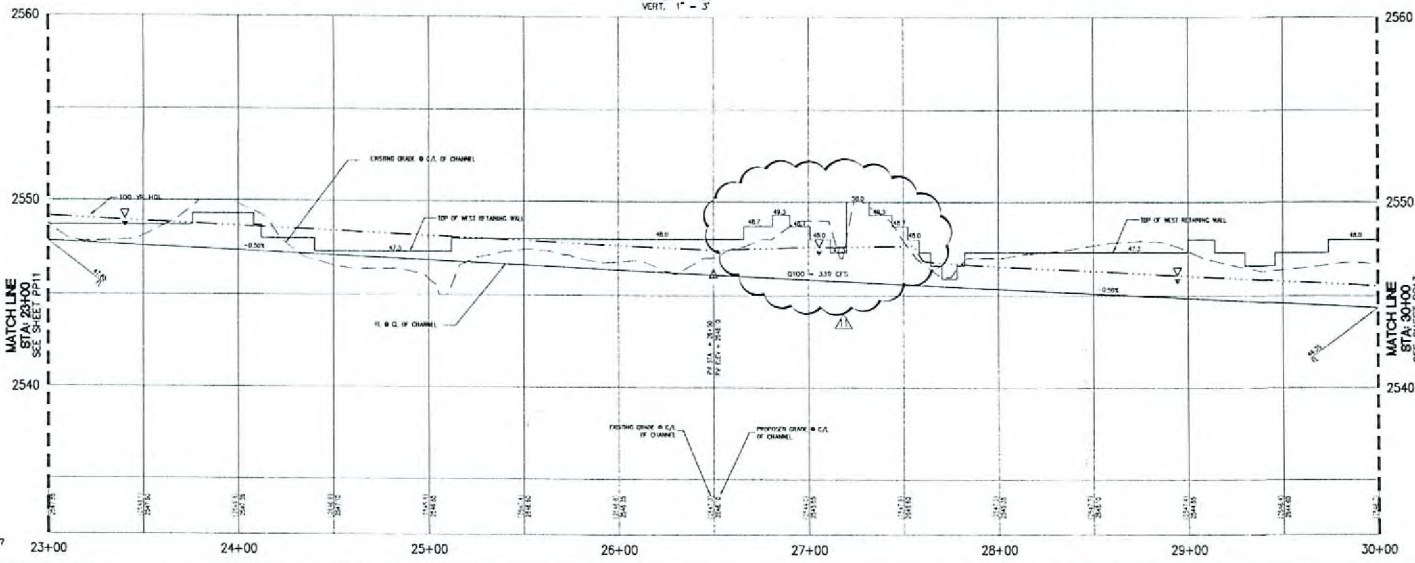

- CONSTRUCTION NOTES
1. CONSTRUCT 12" DIA. DRAIN PER UDDCA DMC 202.
 2. CONSTRUCT 12" DIA. DRAIN PER UDDCA DMC 202.
 3. CONSTRUCT 12" DIA. DRAIN PER UDDCA DMC 202.
 4. CONSTRUCT 12" DIA. DRAIN PER UDDCA DMC 202.
 5. CONSTRUCT 12" DIA. DRAIN PER UDDCA DMC 202.
 6. CONSTRUCT 12" DIA. DRAIN PER UDDCA DMC 202.
 7. CONSTRUCT 12" DIA. DRAIN PER UDDCA DMC 202.
 8. CONSTRUCT 12" DIA. DRAIN PER UDDCA DMC 202.
 9. CONSTRUCT 12" DIA. DRAIN PER UDDCA DMC 202.
 10. CONSTRUCT 12" DIA. DRAIN PER UDDCA DMC 202.
 11. CONSTRUCT 12" DIA. DRAIN PER UDDCA DMC 202.
 12. CONSTRUCT 12" DIA. DRAIN PER UDDCA DMC 202.
 13. CONSTRUCT 12" DIA. DRAIN PER UDDCA DMC 202.
 14. CONSTRUCT 12" DIA. DRAIN PER UDDCA DMC 202.
 15. CONSTRUCT 12" DIA. DRAIN PER UDDCA DMC 202.
 16. CONSTRUCT 12" DIA. DRAIN PER UDDCA DMC 202.
 17. CONSTRUCT 12" DIA. DRAIN PER UDDCA DMC 202.
 18. CONSTRUCT 12" DIA. DRAIN PER UDDCA DMC 202.
 19. CONSTRUCT 12" DIA. DRAIN PER UDDCA DMC 202.
 20. CONSTRUCT 12" DIA. DRAIN PER UDDCA DMC 202.

RECEIVED
MAR 11 2008

DRAINAGE CERTIFICATION
I CERTIFY THIS DRAINAGE PLAN IS IN CONFORMANCE WITH THE APPROVED DRAINAGE STUDY ON FILE WITH THE CITY OF LAS VEGAS FOR THIS PROJECT.
BENJAMIN C. SMITH
12/1/06
1.07 Y 4.234



C.C. WALLACE, INC.
DR. HORTON, INC.
LOG CREEK RANCH - INFRASTRUCTURE
WEST CHANNEL - PLAN AND PROFILE
STA 23+00 - STA 30+00

ROC-27304
06-18-08 CC

MATCH LINE
STA 30+00
SEE SHEET PP12

MATCH LINE
STA 30+00
SEE SHEET PP12

WEST CHANNEL (PUBLIC DRAINAGE EASEMENT TO BE PRIVATELY MAINTAINED)

PLAN AND PROFILE
SCALE
HORIZ. 1" = 30'
VERT. 1" = 3'

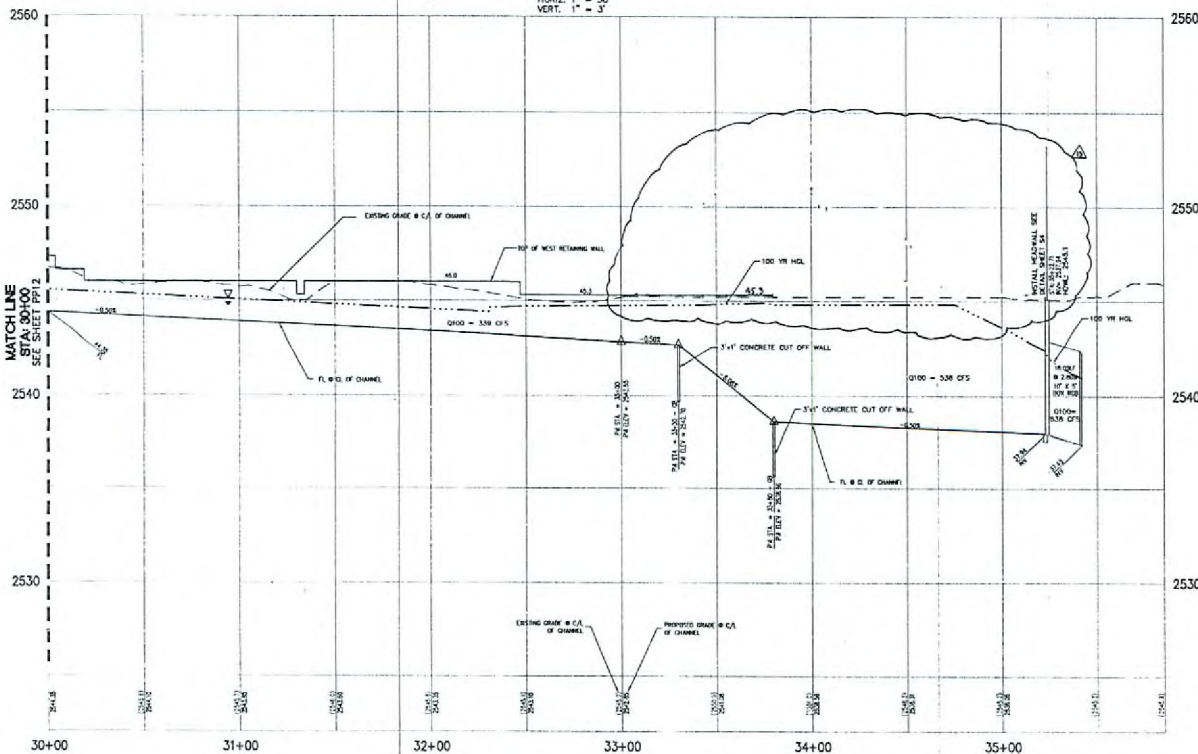

APN 125-05-503-001
BOULEVARD CITY PROPERTIES LLC

MOCCASIN
(PUBLIC)
SEE SHEET PP17



SCALE 1" = 30'
0 30 60
FEET

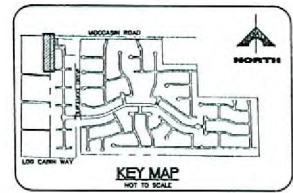

BENCHMARK
CITY OF LAS VEGAS VERTICAL CONTROL,
CORNER OF 1/4 CORNER, BLK 1990 D WOODGATE
AND CHANDLER
ELEVATION: 2483.75 METERS (8148.0)
2483.75 FEET

BASIS OF BEARINGS
NORTH POINTS TO WEST BEING THE BEARING
OF THE WEST LINE OF THE NORTHWEST
QUARTER (SW/4) OF SECTION 4, TOWNSHIP
10 NORTH, RANGE 90 EAST, S.04, CITY OF
LAS VEGAS, CLARK COUNTY, NEVADA, AS
SHOWN BY MAP THEREOF ON FILE IN FILE
NO. PAGE 08 OF PARCEL MAPS IN THE
CLARK COUNTY RECORDER'S OFFICE, CLARK
COUNTY, NEVADA.

NOTE:
CONTRACTOR TO VERIFY THE HORIZONTAL AND VERTICAL
LOCATION OF EXISTING UTILITIES PRIOR TO CONSTRUCTION.
REPORT ANY DISCREPANCIES TO ENGINEER IMMEDIATELY.

- CONSTRUCTION NOTES**
1. CONSTRUCT 1" MIN. DRAIN COVER PER SUDCO DMC #278.
 2. CONSTRUCT 1" PVC DRAIN PER SUDCO DMC #278.
 3. CONSTRUCT 2" MIN. DRAIN PER SUDCO DMC #278.
 4. CONSTRUCT 3" MIN. DRAIN PER SUDCO DMC #278.
 5. CONSTRUCT 4" MIN. DRAIN PER SUDCO DMC #278.
 6. CONSTRUCT 6" MIN. DRAIN PER SUDCO DMC #278.
 7. CONSTRUCT 8" MIN. DRAIN PER SUDCO DMC #278.
 8. CONSTRUCT 10" MIN. DRAIN PER SUDCO DMC #278.
 9. CONSTRUCT 12" MIN. DRAIN PER SUDCO DMC #278.
 10. CONSTRUCT 14" MIN. DRAIN PER SUDCO DMC #278.
 11. CONSTRUCT 16" MIN. DRAIN PER SUDCO DMC #278.
 12. CONSTRUCT 18" MIN. DRAIN PER SUDCO DMC #278.
 13. CONSTRUCT 20" MIN. DRAIN PER SUDCO DMC #278.
 14. CONSTRUCT 22" MIN. DRAIN PER SUDCO DMC #278.
 15. CONSTRUCT 24" MIN. DRAIN PER SUDCO DMC #278.
 16. CONSTRUCT 26" MIN. DRAIN PER SUDCO DMC #278.
 17. CONSTRUCT 28" MIN. DRAIN PER SUDCO DMC #278.
 18. CONSTRUCT 30" MIN. DRAIN PER SUDCO DMC #278.
 19. CONSTRUCT 32" MIN. DRAIN PER SUDCO DMC #278.
 20. CONSTRUCT 34" MIN. DRAIN PER SUDCO DMC #278.
 21. CONSTRUCT 36" MIN. DRAIN PER SUDCO DMC #278.
 22. CONSTRUCT 38" MIN. DRAIN PER SUDCO DMC #278.
 23. CONSTRUCT 40" MIN. DRAIN PER SUDCO DMC #278.
 24. CONSTRUCT 42" MIN. DRAIN PER SUDCO DMC #278.
 25. CONSTRUCT 44" MIN. DRAIN PER SUDCO DMC #278.
 26. CONSTRUCT 46" MIN. DRAIN PER SUDCO DMC #278.
 27. CONSTRUCT 48" MIN. DRAIN PER SUDCO DMC #278.
 28. CONSTRUCT 50" MIN. DRAIN PER SUDCO DMC #278.
 29. CONSTRUCT 52" MIN. DRAIN PER SUDCO DMC #278.
 30. CONSTRUCT 54" MIN. DRAIN PER SUDCO DMC #278.
 31. CONSTRUCT 56" MIN. DRAIN PER SUDCO DMC #278.
 32. CONSTRUCT 58" MIN. DRAIN PER SUDCO DMC #278.
 33. CONSTRUCT 60" MIN. DRAIN PER SUDCO DMC #278.
 34. CONSTRUCT 62" MIN. DRAIN PER SUDCO DMC #278.
 35. CONSTRUCT 64" MIN. DRAIN PER SUDCO DMC #278.
 36. CONSTRUCT 66" MIN. DRAIN PER SUDCO DMC #278.
 37. CONSTRUCT 68" MIN. DRAIN PER SUDCO DMC #278.
 38. CONSTRUCT 70" MIN. DRAIN PER SUDCO DMC #278.
 39. CONSTRUCT 72" MIN. DRAIN PER SUDCO DMC #278.
 40. CONSTRUCT 74" MIN. DRAIN PER SUDCO DMC #278.
 41. CONSTRUCT 76" MIN. DRAIN PER SUDCO DMC #278.
 42. CONSTRUCT 78" MIN. DRAIN PER SUDCO DMC #278.
 43. CONSTRUCT 80" MIN. DRAIN PER SUDCO DMC #278.
 44. CONSTRUCT 82" MIN. DRAIN PER SUDCO DMC #278.
 45. CONSTRUCT 84" MIN. DRAIN PER SUDCO DMC #278.
 46. CONSTRUCT 86" MIN. DRAIN PER SUDCO DMC #278.
 47. CONSTRUCT 88" MIN. DRAIN PER SUDCO DMC #278.
 48. CONSTRUCT 90" MIN. DRAIN PER SUDCO DMC #278.
 49. CONSTRUCT 92" MIN. DRAIN PER SUDCO DMC #278.
 50. CONSTRUCT 94" MIN. DRAIN PER SUDCO DMC #278.
 51. CONSTRUCT 96" MIN. DRAIN PER SUDCO DMC #278.
 52. CONSTRUCT 98" MIN. DRAIN PER SUDCO DMC #278.
 53. CONSTRUCT 100" MIN. DRAIN PER SUDCO DMC #278.

DRAINAGE CERTIFICATION
I CERTIFY THIS DRAINAGE PLAN IS IN CONFORMANCE WITH THE APPROVED
DRAINAGE STUDY ON FILE WITH THE CITY OF LAS VEGAS FOR THIS PROJECT.
Benjamin C. Smith 8141 4/8/05
BENJAMIN C. SMITH P.E. NO. DATE

Call before you Dig
800-227-2800
1-702-229-8611

Call UnderGround
1-702-229-8611

Call before you Dig
800-227-2800
1-702-229-8611

ROC-27304
06-18-08 CC

MAR 11 2008



NO.	DATE	DESCRIPTION
1	06/18/08	ISSUED FOR PERMIT
2	06/18/08	ISSUED FOR PERMIT
3	06/18/08	ISSUED FOR PERMIT
4	06/18/08	ISSUED FOR PERMIT
5	06/18/08	ISSUED FOR PERMIT
6	06/18/08	ISSUED FOR PERMIT
7	06/18/08	ISSUED FOR PERMIT
8	06/18/08	ISSUED FOR PERMIT
9	06/18/08	ISSUED FOR PERMIT
10	06/18/08	ISSUED FOR PERMIT
11	06/18/08	ISSUED FOR PERMIT
12	06/18/08	ISSUED FOR PERMIT
13	06/18/08	ISSUED FOR PERMIT
14	06/18/08	ISSUED FOR PERMIT
15	06/18/08	ISSUED FOR PERMIT
16	06/18/08	ISSUED FOR PERMIT
17	06/18/08	ISSUED FOR PERMIT
18	06/18/08	ISSUED FOR PERMIT
19	06/18/08	ISSUED FOR PERMIT
20	06/18/08	ISSUED FOR PERMIT
21	06/18/08	ISSUED FOR PERMIT
22	06/18/08	ISSUED FOR PERMIT
23	06/18/08	ISSUED FOR PERMIT
24	06/18/08	ISSUED FOR PERMIT
25	06/18/08	ISSUED FOR PERMIT
26	06/18/08	ISSUED FOR PERMIT
27	06/18/08	ISSUED FOR PERMIT
28	06/18/08	ISSUED FOR PERMIT
29	06/18/08	ISSUED FOR PERMIT
30	06/18/08	ISSUED FOR PERMIT
31	06/18/08	ISSUED FOR PERMIT
32	06/18/08	ISSUED FOR PERMIT
33	06/18/08	ISSUED FOR PERMIT
34	06/18/08	ISSUED FOR PERMIT
35	06/18/08	ISSUED FOR PERMIT
36	06/18/08	ISSUED FOR PERMIT
37	06/18/08	ISSUED FOR PERMIT
38	06/18/08	ISSUED FOR PERMIT
39	06/18/08	ISSUED FOR PERMIT
40	06/18/08	ISSUED FOR PERMIT
41	06/18/08	ISSUED FOR PERMIT
42	06/18/08	ISSUED FOR PERMIT
43	06/18/08	ISSUED FOR PERMIT
44	06/18/08	ISSUED FOR PERMIT
45	06/18/08	ISSUED FOR PERMIT
46	06/18/08	ISSUED FOR PERMIT
47	06/18/08	ISSUED FOR PERMIT
48	06/18/08	ISSUED FOR PERMIT
49	06/18/08	ISSUED FOR PERMIT
50	06/18/08	ISSUED FOR PERMIT
51	06/18/08	ISSUED FOR PERMIT
52	06/18/08	ISSUED FOR PERMIT
53	06/18/08	ISSUED FOR PERMIT
54	06/18/08	ISSUED FOR PERMIT
55	06/18/08	ISSUED FOR PERMIT
56	06/18/08	ISSUED FOR PERMIT
57	06/18/08	ISSUED FOR PERMIT
58	06/18/08	ISSUED FOR PERMIT
59	06/18/08	ISSUED FOR PERMIT
60	06/18/08	ISSUED FOR PERMIT
61	06/18/08	ISSUED FOR PERMIT
62	06/18/08	ISSUED FOR PERMIT
63	06/18/08	ISSUED FOR PERMIT
64	06/18/08	ISSUED FOR PERMIT
65	06/18/08	ISSUED FOR PERMIT
66	06/18/08	ISSUED FOR PERMIT
67	06/18/08	ISSUED FOR PERMIT
68	06/18/08	ISSUED FOR PERMIT
69	06/18/08	ISSUED FOR PERMIT
70	06/18/08	ISSUED FOR PERMIT
71	06/18/08	ISSUED FOR PERMIT
72	06/18/08	ISSUED FOR PERMIT
73	06/18/08	ISSUED FOR PERMIT
74	06/18/08	ISSUED FOR PERMIT
75	06/18/08	ISSUED FOR PERMIT
76	06/18/08	ISSUED FOR PERMIT
77	06/18/08	ISSUED FOR PERMIT
78	06/18/08	ISSUED FOR PERMIT
79	06/18/08	ISSUED FOR PERMIT
80	06/18/08	ISSUED FOR PERMIT
81	06/18/08	ISSUED FOR PERMIT
82	06/18/08	ISSUED FOR PERMIT
83	06/18/08	ISSUED FOR PERMIT
84	06/18/08	ISSUED FOR PERMIT
85	06/18/08	ISSUED FOR PERMIT
86	06/18/08	ISSUED FOR PERMIT
87	06/18/08	ISSUED FOR PERMIT
88	06/18/08	ISSUED FOR PERMIT
89	06/18/08	ISSUED FOR PERMIT
90	06/18/08	ISSUED FOR PERMIT
91	06/18/08	ISSUED FOR PERMIT
92	06/18/08	ISSUED FOR PERMIT
93	06/18/08	ISSUED FOR PERMIT
94	06/18/08	ISSUED FOR PERMIT
95	06/18/08	ISSUED FOR PERMIT
96	06/18/08	ISSUED FOR PERMIT
97	06/18/08	ISSUED FOR PERMIT
98	06/18/08	ISSUED FOR PERMIT
99	06/18/08	ISSUED FOR PERMIT
100	06/18/08	ISSUED FOR PERMIT

G.C. WALLACE, INC.
DR. HORTON, INC.
WEST CHANNEL - PLAN AND PROFILE
STA 30+00 - STA 35+22.71

LOG CABIN RANCH - INFRASTRUCTURE
DR. HORTON, INC.
WEST CHANNEL - PLAN AND PROFILE
STA 30+00 - STA 35+22.71

SHEET
PP13
15 OF 69 SHEETS

