

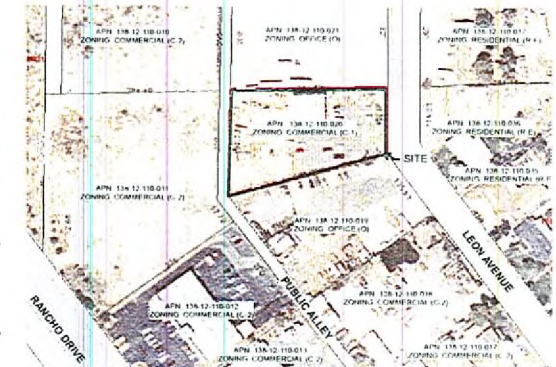

**RECEIVED**  
 JUL 10 2008



Location Map



VICINITY MAP

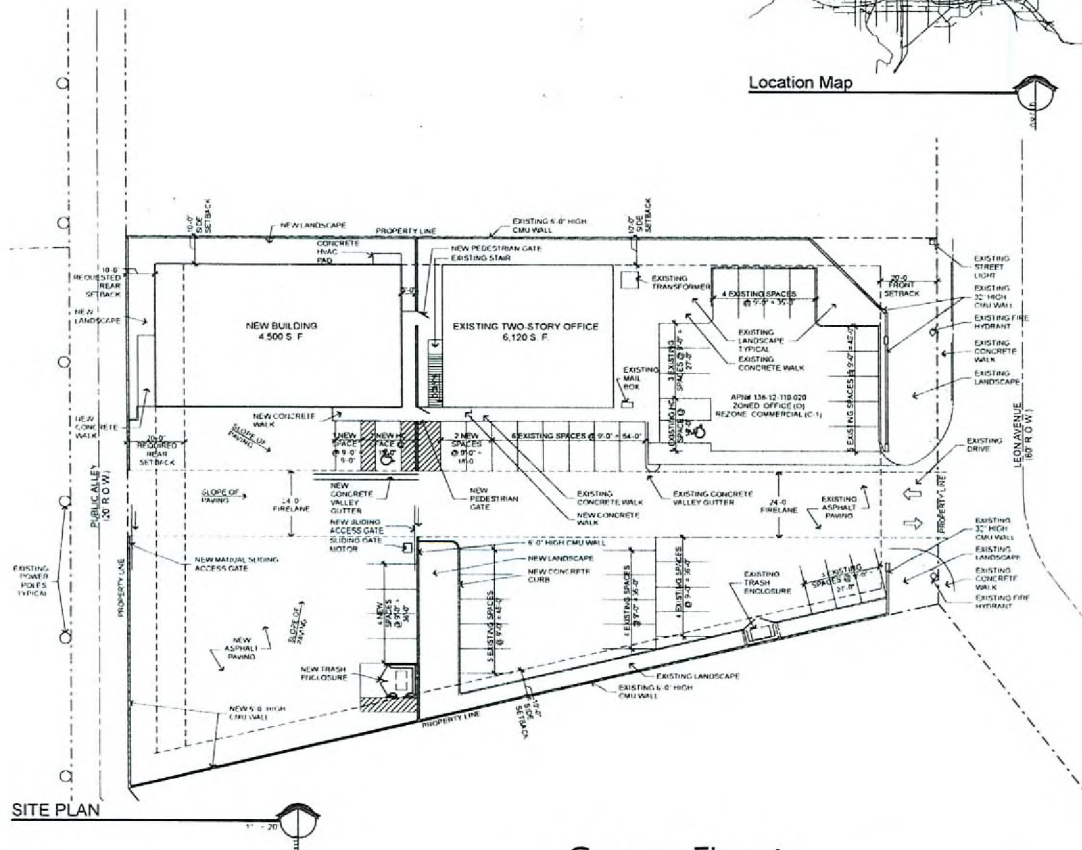

SITE PLAN

**Site and Project Information**

SITE DATA		
PARCEL NUMBER		138-12-118-020
APPLICATOR		138-12-118-020
EXISTING ZONING		COMMERCIAL (C-2)
PROPOSED ZONING		COMMERCIAL (C-2)
PROPOSED USE		COMMERCIAL OFFICE
SITE AREA		1.68 ACRES
SETBACKS (FEET)	REQUIRED	PREMIER
FRONT	25'	25'
REAR	15'	15'
CORNER	25'	25'
SIDE	25'	25'
MAX HEIGHT		75'
ACTUAL HEIGHT		75'
LOT COVERAGE ALLOWED		25%
ACTUAL LOT COVERAGE		27.5%
BUILDING INFORMATION		
USE		COMMERCIAL OFFICE
CONSTRUCTION TYPE		CMU
CONCRETE		Y
FIRE RISK		Y
BUILDING AREA		
EXISTING OFFICE (2 STORY)		6,120 S.F.
NEW OFFICE		4,500 S.F.
BUILDING MAINTENANCE SERVICE AND SALES		1,500 S.F.
TOTAL SQUARE FOOTAGE		12,120 S.F.
PARKING AREA		
BUILDING AREA		
EXISTING OFFICE	(REQUIRED)	PREMIER
NEW OFFICE	120 S.F. @ 1:250 = 48	48
BUILDING MAINTENANCE	1,500 S.F. @ 1:250 = 6	6
STANDARD PARKING SPACES PROVIDED	42 @ 1:250 = 168	168
REMARKS: SPACES PROVIDED		
TOTAL PARKING		174

Site Plan

Copyright 2008 © by APTUS Architecture  
**APTUS Architecture**  
 1100 South Main Street  
 Suite 104  
 Las Vegas, Nevada 89101  
 P: 702.574.1200  
 F: 702.574.1212

**Century Electric**  
 Site Development Review  
 3920 Leon Avenue  
 Las Vegas, Nevada 89130

City of Las Vegas, GPR, SR, SUP & SDH Submittal # 08-09-00

**ZON-28511**  
**REVISED**  
**07/24/08 PC**

10/15/08 Century Electric