

DESIGN DATA	
LOT AREA	305,091.95 SQUARE FEET: TOTAL (4.71 ACRES)
WALGREEN'S DRUG STORE	14,400 SQUARE FEET
RESTAURANT WITH DRIVE-THRU	3,200 SQUARE FEET
RETAIL/TAVERN	10,378 SQUARE FEET
CONVENIENCE STORE	3,278 SQUARE FEET
OFFICE	15,400 SQUARE FEET
TOTAL BUILDING AREA	41,741 SQUARE FEET TOTAL AREA
LOT COVERAGE	18.84%
OPENSOURCE COVERAGE	22.39% ± INCLUDING LANDSCAPE AREAS, FINGER ISLANDS, PATHS AND WALK AREAS, COURTYARDS, ETC. PER TODSM
PARKING REQUIRED (CITY OF LAS VEGAS - TITLE 18A)	
SHOPPING CENTER >25,000 S.F.	41,741 SQUARE FEET/11,250 = 186.98 STALLS
TOTAL STALLS REQUIRED	187 STALLS REQUIRED
PARKING PROVIDED	
REGULAR STALLS	214 STALLS (9.0% TYP.)
ACCESSIBLE STALL	5 VAN AND 4 REGULAR STALL
TOTAL SPACES	223 STALLS PROVIDED

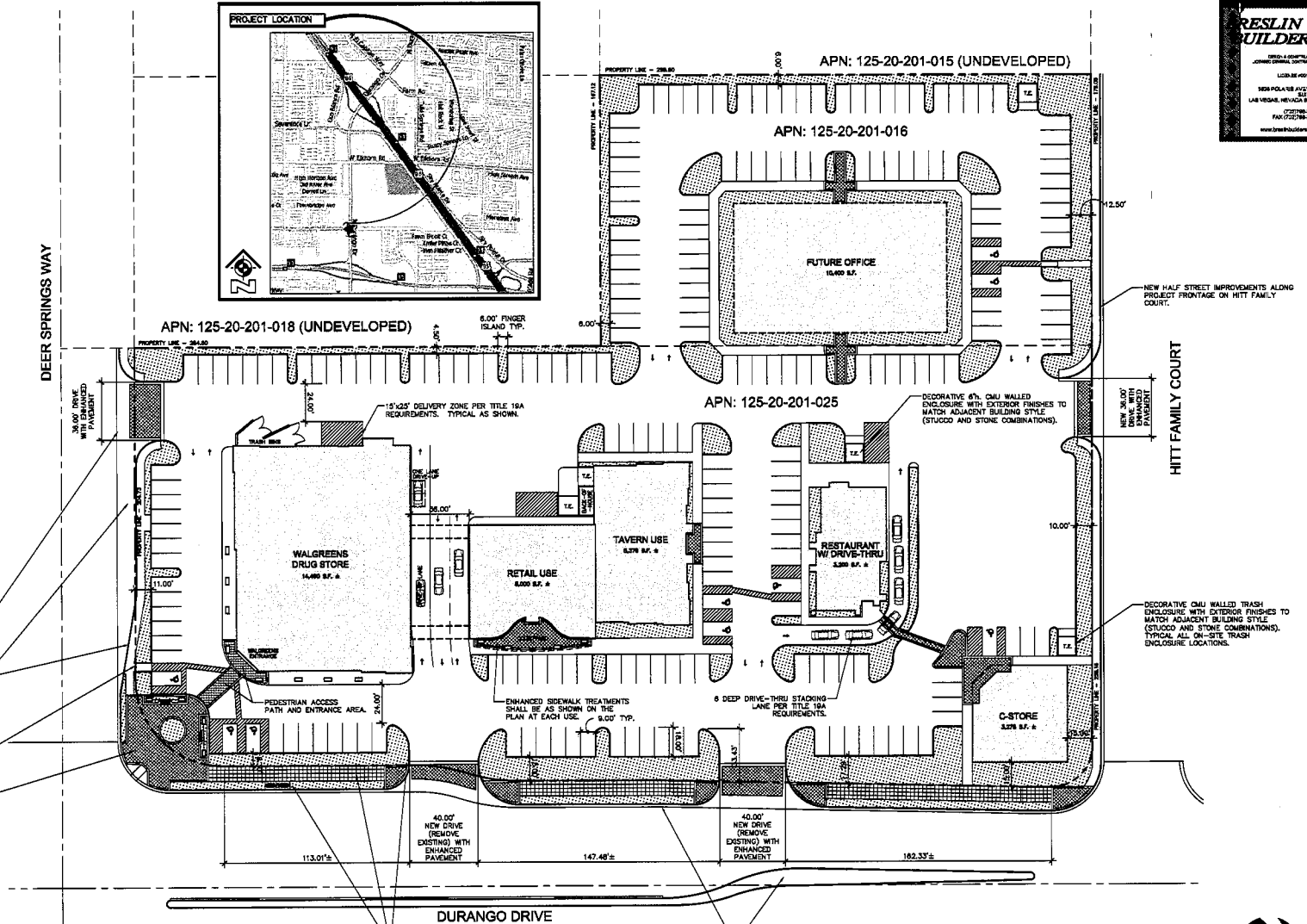
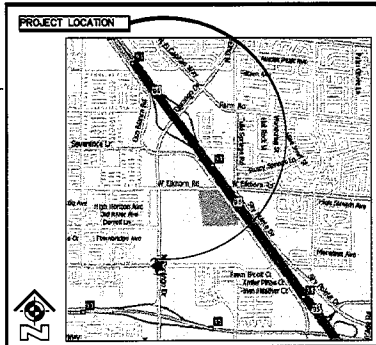

Submitted at City Council
 Date 6-4-08 Item 72-77

Overall Site Plan

Scale: 1" = 30'-0"
 BDDG Project No.: 6307A.01 (Without Gasoline Canopy)
 Version 14g w gas pumps

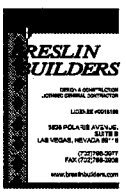

Land-Use Submittal
 May 5, 2008

Town Center Commons

Northwest Corner of Durango and Deer Springs, Las Vegas, Nevada

BDDG, BDDG and its affiliates are not responsible for the accuracy of the information contained in this drawing. The user of this drawing is advised to verify the accuracy of the information contained in this drawing. BDDG, BDDG and its affiliates are not responsible for the accuracy of the information contained in this drawing. BDDG, BDDG and its affiliates are not responsible for the accuracy of the information contained in this drawing.