



**PLANNING & DEVELOPMENT DEPARTMENT**

**STATEMENT OF FINANCIAL INTEREST**

Case Number: **SUP-28101** APN: 138-25-503-006

Name of Property Owner: City of Las Vegas Redevelopment

Name of Applicant: Alpha Omega Strategies

Name of Representative: DRC Engineering

To the best of your knowledge, does the Mayor or any member of the City Council or Planning Commission have any financial interest in this or any other property with the property owner, applicant, the property owner or applicant's general or limited partners, or an officer of their corporation or limited liability company?

Yes

No

If yes, please indicate the member of the City Council or Planning Commission who is involved and list the name(s) of the person or persons with whom the City Official holds an interest. Also list the Assessor's Parcel Number if the property in which the interest is held is different from the case parcel.

City Official: N/A

Partner(s): \_\_\_\_\_

APN: \_\_\_\_\_

Signature of Property Owner: *Douglas Selby*

Print Name: Douglas Selby

Subscribed and sworn before me

This 8 day of May, 2009

*Kim Barrera*  
Notary Public in and for said County and State

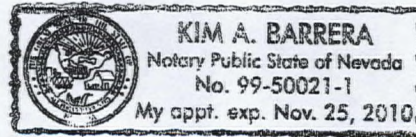



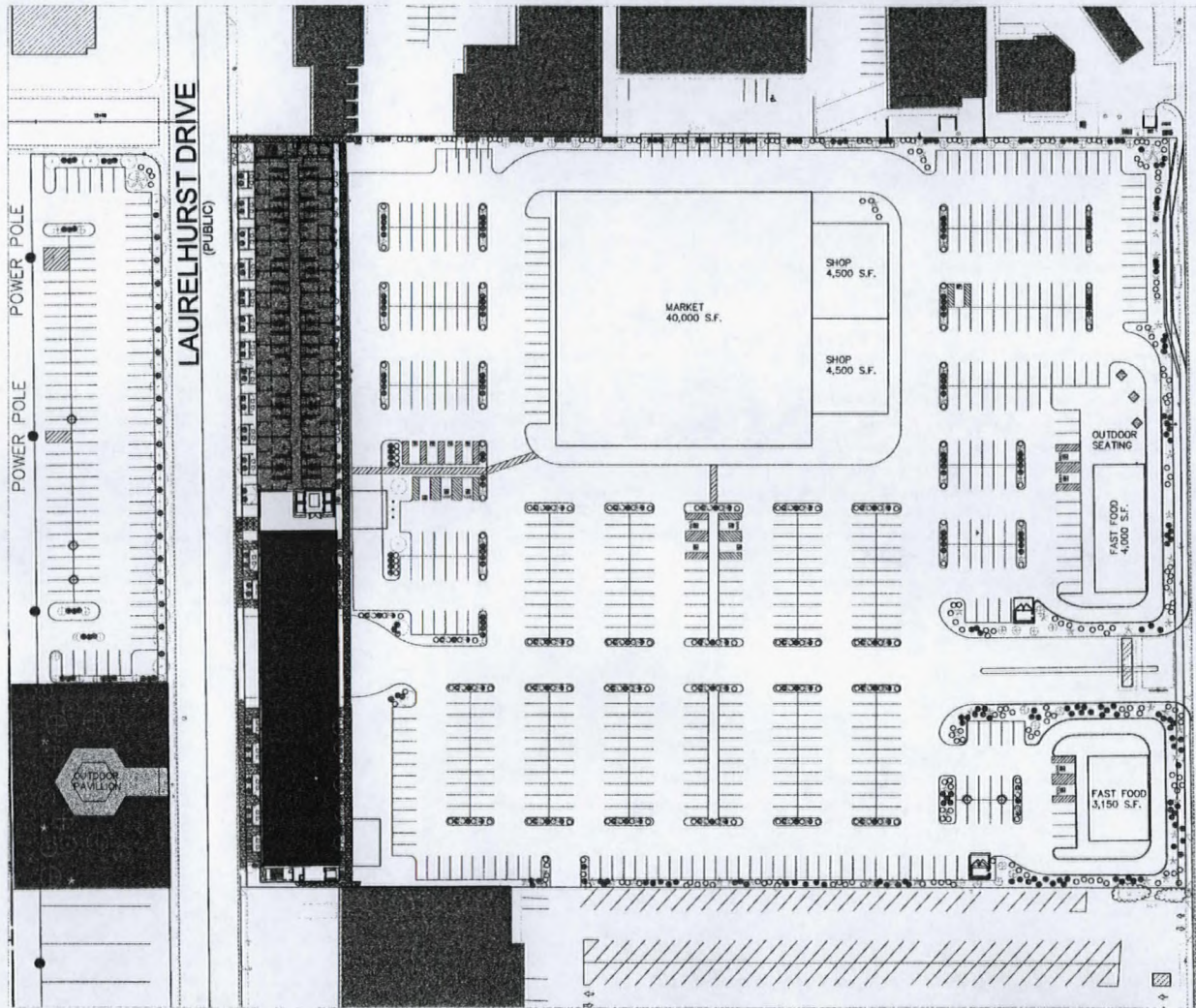

A LANDSCAPE PLAN



The  
Residences  
@  
Centurian  
Park

LANDSCAPE LEGEND

SYMBOL	LANDSCAPE TREE	TYPE	SIZE
	MEXICAN FAN PALM	LANDSCAPE	12' HIGH
	CANARY ISLAND PALM Phoenix International	LANDSCAPE	12' HIGH
	CALIFORNIA POWER TREE California Redwood	LANDSCAPE	24" BOX
	EUCALYPTUS	LANDSCAPE	24" BOX
	DESERTING ACACIA Desert Acacia	LANDSCAPE	24" BOX
	YUCCA TREE	LANDSCAPE	24" BOX
	ALEPPO PINE Aleppo Pine	LANDSCAPE	24" BOX
	SHRUBS and GROUND COVER		
	ORNAMENTAL LANDSCAPE		18 GAL.
	SHRUB		18 GAL.
	EVERGREEN SHRUB		18 GAL.
	DECIDUOUS SHRUB		18 GAL.
	SHRUB		9 GAL.
	SHRUB		9 GAL.
	SHRUB		9 GAL.
	SHRUB		9 GAL.

- ALL INDICATED LANDSCAPE GROUND COVER TO BE 5% GRADE AND 95% GRASS.
- ALL PLANTS ON SITE MUST CONFORM WITH TITLE 19 REG.
- 24" BOX TREES A MAXIMUM OF 24" OF O.C. IN NORTH PROPERTY LINE.
- 24" BOX TREES A MAXIMUM OF 24" OF O.C. IN EAST PROPERTY LINE & IN THE CENTER OF THE AREA ADJACENT TO POP BAYS.
- PROVIDE (4) 1/2" GALLON BRUSH SPA. FOR EACH TREE.
- ALEPPO PINE 8 1/2" O.C. ALSO WEST PROPERTY LINE.

RECEIVED  
MAY 19 2008

VAR-27964 SUP-28101  
SUP-28102 SDR-27965  
06/12/08 PC REVISED

David L.  
Downey P.C.  
ARCHITECT



ALL COPYRIGHT SPECIFICATIONS AND COPIES THEREOF FURNISHED BY THE ARCHITECT ARE AND SHALL REMAIN THE SOLE PROPERTY. THEY ARE TO BE USED ONLY WITH RESPECT TO THIS PROJECT, AND NOT TO BE REPRODUCED OR USED IN ANY OTHER PROJECT WITHOUT THE WRITTEN CONSENT OF THE ARCHITECT. ANY REPRODUCTION OR USE OF THIS DOCUMENT OR ANY PART THEREOF FOR ANY OTHER PROJECT, IN WHOLE OR IN PART, WITHOUT THE WRITTEN CONSENT OF THE ARCHITECT, IS STRICTLY PROHIBITED. EXCEPT WHERE SHOWN OTHERWISE, ALL DIMENSIONS ARE IN FEET AND INCHES.