

City of Las Vegas  
 Office Of The City Clerk  
 400 Stewart Avenue  
 Las Vegas, Nevada 89101

RECEIVED  
 CITY CLERK

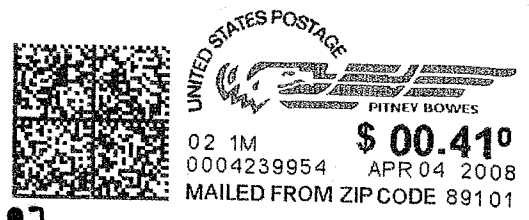

**Return Service Requested**  
**Official Notice of Public Hearing** 2008 APR 17 A 11:07

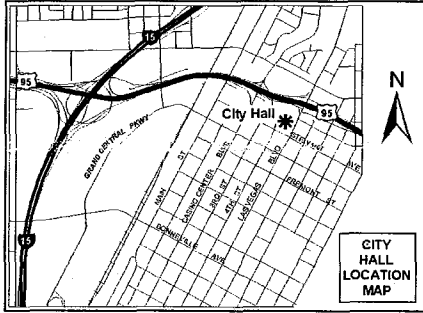

If you wish to file your protest or support on this request, check the appropriate box below and return this card in an envelope with postage to the Office Of The City Clerk at the address listed above or fax this side of this card to (702) 382-4803. If you would like to contact your Council Representative, please call (702) 229-6405.

AFTON MEADOWS L L C  
 %AFTON PPTY INVEST CORP/S BOSS  
 1635 CHELSEA RD #A  
 SAN MARINO CA 91108-2456

I SUPPORT this Request       I OPPOSE this Request

Please use available blank space on card for your comments.  
 SUP-26619

91108+2456 0019

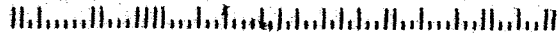

**Application Information**

SUP-26619 - APPLICANT: DOLLAR LOAN CENTER - OWNER: DECATUR CROSSING CENTER, LLC - Request for a Special Use Permit FOR A PROPOSED FINANCIAL INSTITUTION, SPECIFIED AND A WAIVER TO ALLOW AN 81-FOOT RESIDENTIAL SEPARATION WHERE 200 FEET IS REQUIRED at 280 South Decatur Boulevard (APN, 138-36-516-004), C-1 (Limited Commercial) Zone, Ward 1 (Tarkanian)

**Application Location**

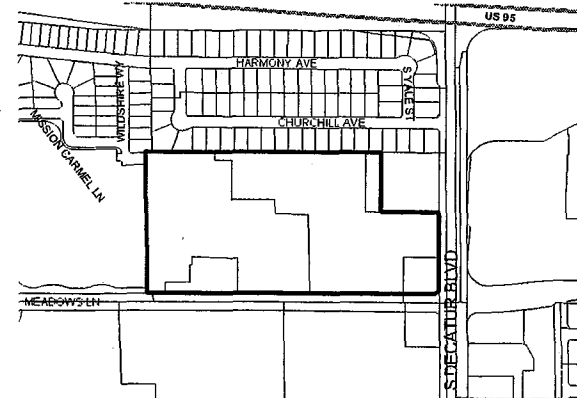

The proposed project may not pertain to the entire highlighted project site.

*There are plenty of locations available in this market where a waiver would not be required.*

**Public Hearing Information**

Meeting: City Council  
 Date: April 16, 2008  
 Time: 1:00 P.M.  
 Location: City Council Chambers  
 400 Stewart Avenue  
 Las Vegas, Nevada

Any and all interested persons may appear and be heard at said meeting, or may, prior thereto, file written objections thereto or approvals thereof with the City Clerk, 1st Floor, City Hall, 400 Stewart Avenue, Las Vegas, Nevada, 89101. For further information, please call (702) 229-6311 (TDD 386-9108).

Submitted after meeting  
 Date 4/17/08 Item #111

City of Las Vegas  
Office Of The City Clerk  
400 Stewart Avenue  
Las Vegas, Nevada 89101

RECEIVED  
CITY CLERK

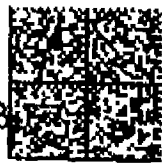

UNITED STATES POSTAGE  
FIRST CLASS  
\$ 00.41<sup>0</sup>  
02 1M  
0004239954 APR 04 2008  
MAILED FROM ZIP CODE 89101

APR 28 P 4:38

# Return Service Requested Official Notice of Public Hearing

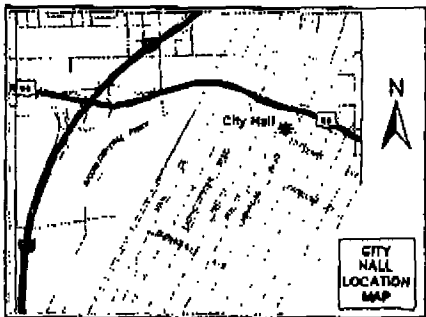

If you wish to file your protest or support on this request, check the appropriate box below and return this card in an envelope with postage to the Office Of The City Clerk at the address listed above or fax this side of this card to (702) 382-4803. If you would like to contact your Council Representative, please call (702) 229-6405.

I SUPPORT  
this Request

I OPPOSE  
this Request

MYERS LIVING TRUST  
MYERS B J & CAROL ANN CO-TRS  
129 WILDSHIRE WY  
LAS VEGAS NV 89107-2700

Please use available blank space on card for your comments.  
SUP-26619

89107+2700 0079



Submitted after meeting  
Date 4/28/08 Item 111

2

20080618-0000809

APN(s) 138-36-516-004

Fee: \$15.00  
N/C Fee: \$0.00

06/18/2008 09:36:36  
T20080119037

**CITY OF LAS VEGAS NOTICE OF ZONING ACTION**

Requestor:  
LAS VEGAS CITY

TO: ALL INTERESTED PARTIES

Debbie Conway KXC  
Clark County Recorder Pgs: 2

Assessor's Parcel No(s): 138-36-516-004

**Legal Description:** A PORTION OF THE NORTHEAST QUARTER (NE ¼) OF THE NORTHEAST QUARTER (NE ¼) OF SECTION 36, TOWNSHIP 20 SOUTH, RANGE 60 EAST, M.D.M., CITY OF LAS VEGAS, CLARK COUNTY, NEVADA, DESCRIBED AS FOLLOWS: COMMENCING AT THE SOUTHEAST CORNER (SE COR) OF THE NORTHEAST QUARTER (NE ¼) OF THE NORTHEAST QUARTER (NE ¼) OF SAID SECTION 36; THENCE SOUTH 89° 58' 17" WEST, ALONG THE SOUTH LINE OF THE NORTHEAST QUARTER (NE ¼) OF THE NORTHEAST QUARTER (NE ¼) OF SAID SECTION 36, A DISTANCE OF 95.24 FEET; THENCE NORTH 00° 01' 43" WEST, 40.00 FEET TO A POINT ON THE NORTHERLY RIGHT OF WAY LINE OF MEADOWS LANE (80.00 FEET WIDE); THENCE SOUTH 89° 58' 17" WEST, ALONG SAID RIGHT OF WAY LINE, 870.32 FEET TO THE POINT OF BEGINNING; THENCE CONTINUING SOUTH 89° 58' 17" WEST, ALONG SAID RIGHT OF WAY LINE, 316.51 FEET; THENCE NORTH 00° 06' 51" EAST, 52.83 FEET; THENCE SOUTH 89° 53' 09" EAST, 109.51 FEET; THENCE NORTH 00° 06' 51" EAST, 73.00 FEET; THENCE SOUTH 89° 53' 09" EAST, 11.00 FEET; THENCE NORTH 00° 06' 51" EAST, 34.00 FEET; THENCE SOUTH 89° 53' 09" EAST, 152.00 FEET; THENCE SOUTH 00° 06' 51" WEST, 5.00 FEET; THENCE SOUTH 89° 53' 09" EAST, 44.00 FEET; THENCE SOUTH 00° 06' 51" WEST, 154.04 FEET TO THE POINT OF BEGINNING.

PLEASE BE ADVISED that the Las Vegas City Council, at a duly-noticed hearing held on **April 16, 2008**, approved the following: **Case Number: SUP-26619** together with various conditions, limitations and restrictions which may affect your occupancy and/or use, and any other successor property owner(s) occupancy and/or use, of the above-referenced real property in the City of Las Vegas. YOU ARE HEREBY ADVISED AND DIRECTED to contact the

**ORIGINAL**

City of Las Vegas' Department of Planning and Development and/or the Las Vegas City Clerk's Office to request a copy of any and all such conditions, limitations or restrictions.

May 29, 2008



---

Angela Crolli, Deputy City Clerk II  
City of Las Vegas  
400 Stewart Avenue  
Las Vegas, NV 89101 - (702) 229-6311

**WHEN RECORDED, RETURN TO:  
CITY OF LAS VEGAS, CITY CLERK  
400 STEWART AVENUE, 1<sup>ST</sup> FLOOR  
LAS VEGAS, NV 89101**