



PLANNING & DEVELOPMENT DEPARTMENT

STATEMENT OF FINANCIAL INTEREST

Case Number: **VAR-26228** APN: 138-03-510-001, 002, 003, 023, 024, 031 ⁰²⁵

Name of Property Owner: SF INVESTMENTS, LLC

Name of Applicant: WATERLING S. DEVELOPMENT

Name of Representative: BILL ROBERTS

To the best of your knowledge, does the Mayor or any member of the City Council or Planning Commission have any financial interest in this or any other property with the property owner, applicant, the property owner or applicant's general or limited partners, or an officer of their corporation or limited liability company?

Yes No

If yes, please indicate the member of the City Council or Planning Commission who is involved and list the name(s) of the person or persons with whom the City Official holds an interest. Also list the Assessor's Parcel Number if the property in which the interest is held is different from the case parcel.

City Official: _____

Partner(s): _____

APN: _____

Signature of Property Owner: *Fred Lessman*

Print Name: FRED LESSMAN

Subscribed and sworn before me

This 26 day of December 2007
Deborah J. Mundell
Notary Public in and for said County and State

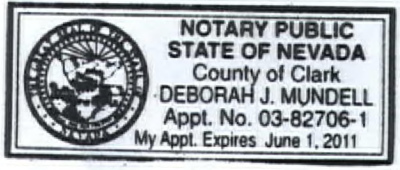

TABULATION

AREA TO BE DEVELOPED 100,000 SQ. FT.
 EXISTING AREA 100,000 SQ. FT.
 EXISTING ZONING
 NUMBER OF 1-BEDROOM UNITS 100
 NUMBER OF 2-BEDROOM UNITS 100
 NUMBER OF 3-BEDROOM UNITS 100
 TOTAL NUMBER OF UNITS 300

PARKING ANALYSIS

100 - 1-BEDROOM UNITS @ 1.25 PER UNIT = 125
 100 - 2-BEDROOM UNITS @ 1.75 PER UNIT = 175
 100 - 3-BEDROOM UNITS @ 2.25 PER UNIT = 225
 TOTAL PARKING SPACES REQUIRED 525
 TOTAL PARKING SPACES PROVIDED 525
 RESERVATION CENTER 500

PLANT LIST

- COMMON NAME** QUANTITY
- TREES:**
 MONTEZUMA CYPRESS 100
 SAGE BRUSH 100
 PINE LEAF YUCCA 100
 BLUE CHERRY
- SHRUBS:**
 SAGE BRUSH 100
 YUCCA
 N. CALIFORNIA HORSE TAIL
 RED TIP PHOENIX
 TEXAS BURNING BUSH
 DWARF MOCK ORANGE
 HOSE LARY CREEPING
 CATS CLAW
 DAY LILY

GROUND COVER:

ISOLATED SOIL PROFILES WITH LOCAL SAND
 AREAS AND DECOMPOSED CHERTS FOUND TO
 BE USED IN LANDSCAPE AREAS TO THE RIGHT



LONE MOUNTAIN ROAD

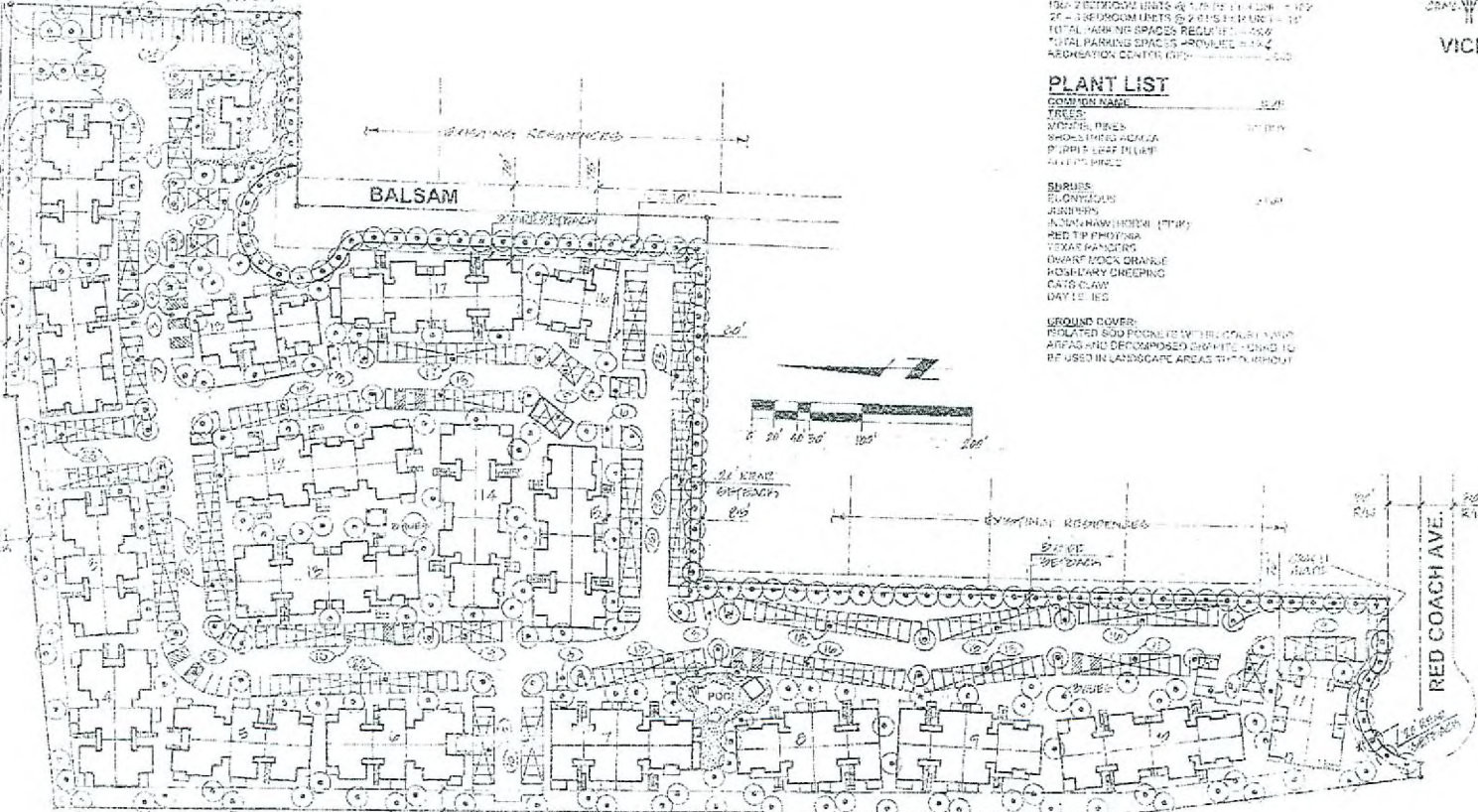

ORAN K. GRAGSON HIGHWAY

NOT TO SCALE
 THIS PLAN IS A CONCEPTUAL SITE PLAN AND IS NOT TO BE USED FOR CONSTRUCTION. IT IS SUBJECT TO APPROVAL BY THE LOCAL GOVERNMENT AND MAY BE MODIFIED WITHOUT NOTICE.

REVISED 1/24/08

LOWE MOUNTAIN / US 95 HWY.	
DATE	1/24/08
CONCEPTUAL SITE PLAN	
WJR CONSULTING SERVICES, LLC	

RECEIVED
 FEB 05 2008

VAR-26228
REVISED
02/28/08 PC



BUILDING A - SIDE ELEVATION



BUILDING B - SIDE ELEVATION



END ELEVATION



BUILDING C - SIDE ELEVATION



END ELEVATION

RECEIVED
DEC 27 2007



SCOTT L. BAKER,
ARCHITECT, INC.

LONE MOUNTAIN / 95 APTS

SCALE = 1/4" = 1'-0" PROJECT NO. #07-196 12.06.07

0' 2' 4' 8' 16' ELEVATIONS

VAR-26228
01/24/08 PC