



**PLANNING & DEVELOPMENT DEPARTMENT**

**STATEMENT OF FINANCIAL INTEREST**

Case Number: ZON-25893 APN: 138-03-510-001,002,003,023,024,031 <sup>025</sup>

Name of Property Owner: UF INVESTMENTS, LLC

Name of Applicant: STERLING W. DEVELOPMENT

Name of Representative: BILL ROBERTS

To the best of your knowledge, does the Mayor or any member of the City Council or Planning Commission have any financial interest in this or any other property with the property owner, applicant, the property owner or applicant's general or limited partners, or an officer of their corporation or limited liability company?

Yes

No

If yes, please indicate the member of the City Council or Planning Commission who is involved and list the name(s) of the person or persons with whom the City Official holds an interest. Also list the Assessor's Parcel Number if the property in which the interest is held is different from the case parcel.

City Official: \_\_\_\_\_

Partner(s): \_\_\_\_\_

APN: \_\_\_\_\_

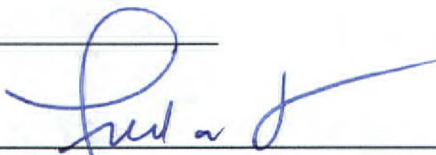
Signature of Property Owner: 

Print Name: FRED LESSMAN

Subscribed and sworn before me

This 30 day of November, 2007  
Suzanne Anderson  
Notary Public in and for said County and State

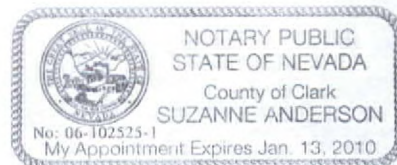

LONE MOUNTAIN ROAD

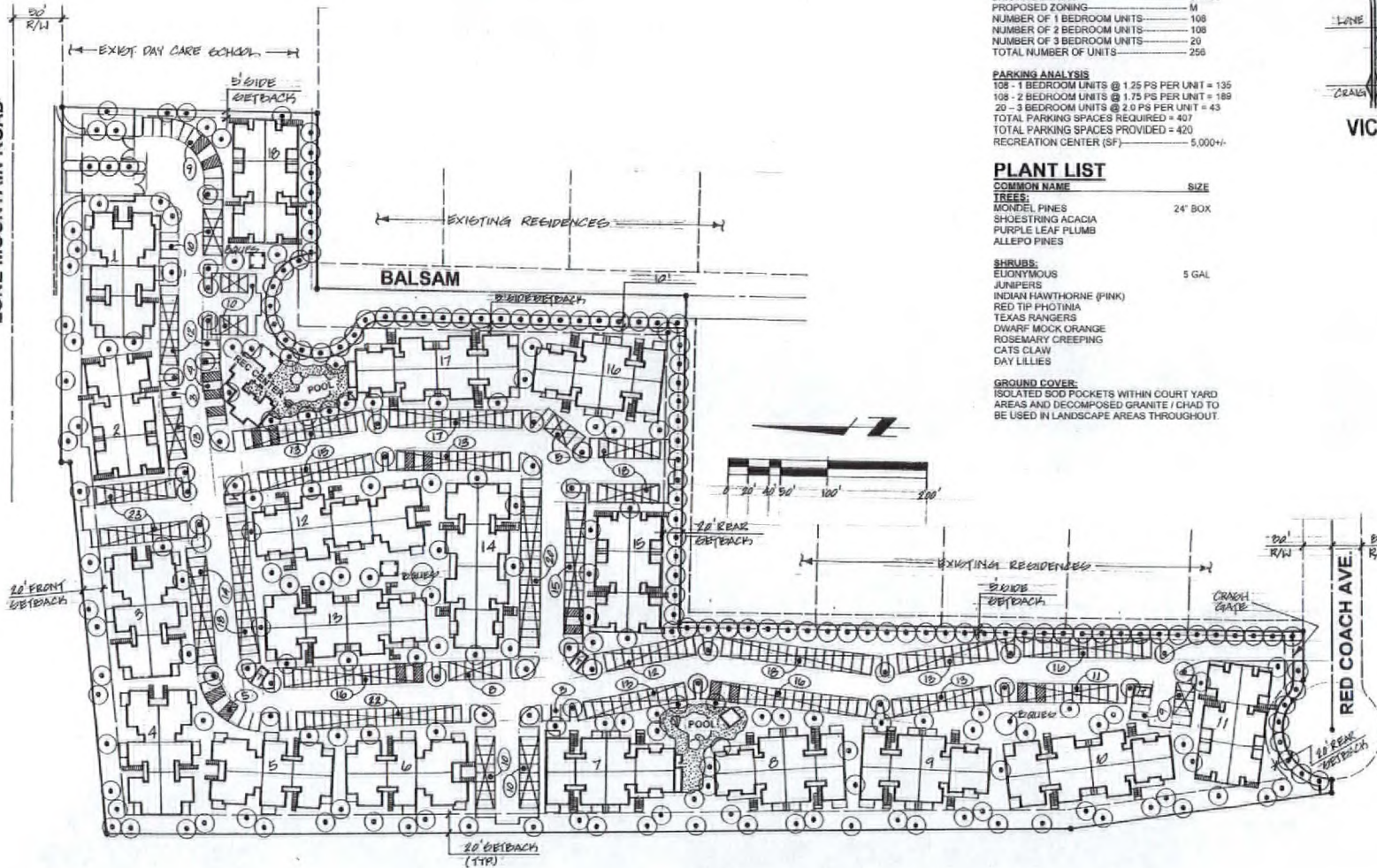

ORAN K. GRAGSON HIGHWAY

**TABULATION**

|  |       |
|--|-------|
| APN 138 03 510-001, 002, 003, 023, 024, 025, 031 |       |
| GROSS ACREAGE                                    | 11.45 |
| EXISTING ZONING                                  | UM/LA |
| PROPOSED ZONING                                  | M     |
| NUMBER OF 1 BEDROOM UNITS                        | 108   |
| NUMBER OF 2 BEDROOM UNITS                        | 108   |
| NUMBER OF 3 BEDROOM UNITS                        | 20    |
| TOTAL NUMBER OF UNITS                            | 256   |

**PARKING ANALYSIS**

|  |          |
|--|----------|
| 108 - 1 BEDROOM UNITS @ 1.25 PS PER UNIT | = 135    |
| 108 - 2 BEDROOM UNITS @ 1.75 PS PER UNIT | = 189    |
| 20 - 3 BEDROOM UNITS @ 2.0 PS PER UNIT   | = 40     |
| TOTAL PARKING SPACES REQUIRED            | = 407    |
| TOTAL PARKING SPACES PROVIDED            | = 420    |
| RECREATION CENTER (SF)                   | = 5,000+ |

**PLANT LIST**

| COMMON NAME   | SIZE    |
|---|---------|
| <b>TREES:</b>   |         |
| MONDEL PINES  | 24" BOX |
| SHOESTRING ACACIA   |         |
| PURPLE LEAF PLUMB   |         |
| ALLEPO PINES  |         |
| <b>SHRUBS:</b>  |         |
| ELIANTHUS   | 5 GAL   |
| JUNIPERS  |         |
| INDIAN HAWTHORNE (PINK)   |         |
| RED TIP PHOTINIA  |         |
| TEXAS RANGERS   |         |
| DWARF MOCK ORANGE   |         |
| ROSEMARY CREEPING   |         |
| CATS CLAW   |         |
| DAY LILLIES   |         |
| <b>GROUND COVER:</b>  |         |
| ISOLATED SOOD POCKETS WITHIN COURT YARD AREAS AND DECOMPOSED GRANITE / CHAD TO BE USED IN LANDSCAPE AREAS THROUGHOUT. |         |



RECEIVED

DEC 06 2007

ZON-25893  
01/24/08 PC

|                              |                |
|------------------------------|----------------|
| LONE MOUNTAIN / US 95 HWY.   |                |
| SCALE 1"=50'                 | DATE 11/2/07   |
| CONCEPTUAL SITE PLAN         | DRAWING NUMBER |
| WJR CONSULTING SERVICES, LLC |                |