

CASE: EOT-26930

ZONING OF SUBJECT PROPERTY:

R-PD18 (RESIDENTIAL PLANNED DEVELOPMENT - 18 UNITS PER ACRE)

0 100 Feet



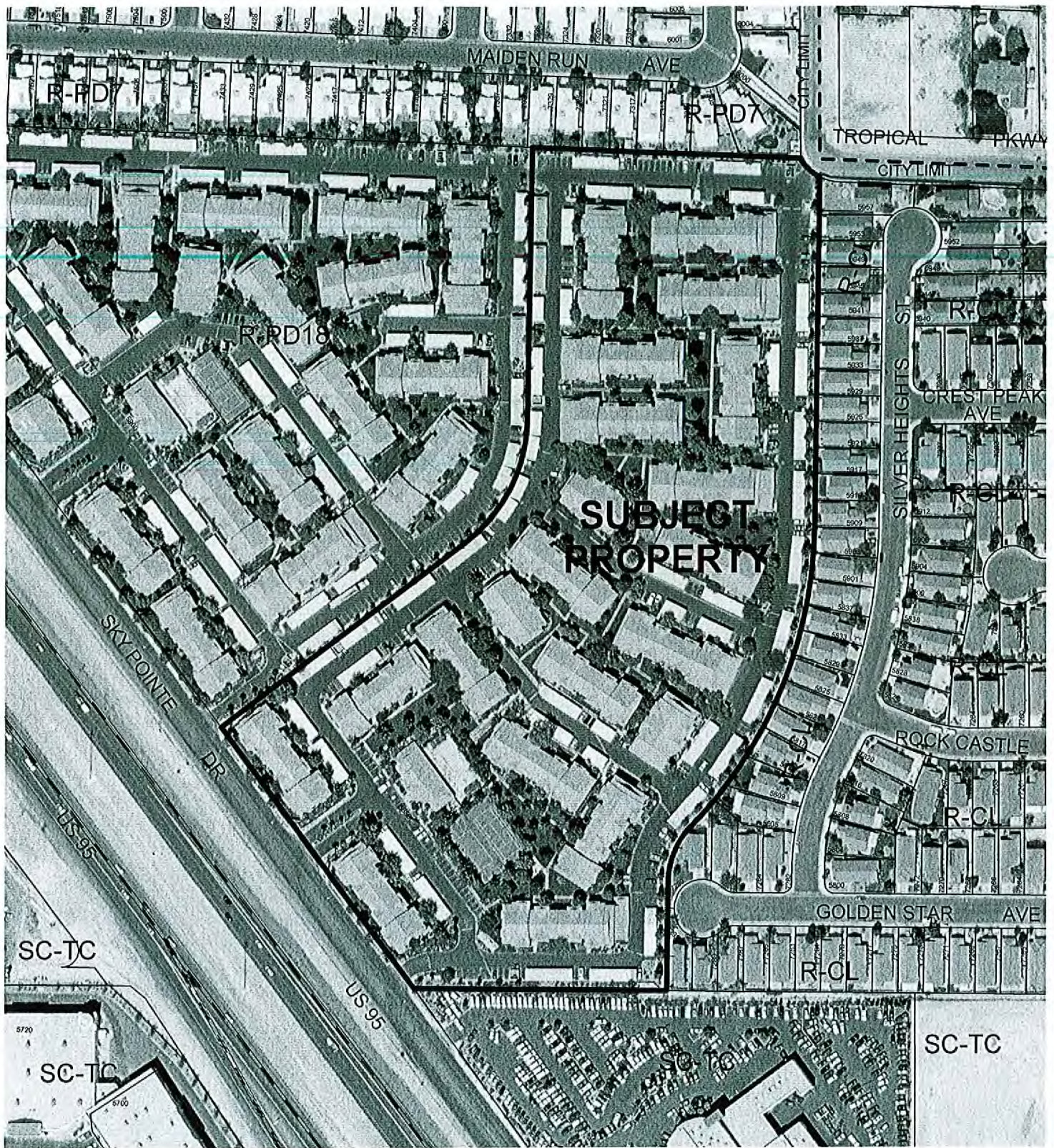

0 100 Feet

CASE: EOT-26930

ZONING OF SUBJECT PROPERTY:

R-PD18 (RESIDENTIAL PLANNED DEVELOPMENT - 18 UNITS PER ACRE)

