



**PLANNING & DEVELOPMENT DEPARTMENT**

**STATEMENT OF FINANCIAL INTEREST**

Case Number: **GPA-26741** APN: 125-29-502-030

Name of Property Owner: City of Las Vegas

Name of Applicant: City of Las Vegas

Name of Representative: \_\_\_\_\_

To the best of your knowledge, does the Mayor or any member of the City Council or Planning Commission have any financial interest in this or any other property with the property owner, applicant, the property owner or applicant's general or limited partners, or an officer of their corporation or limited liability company?

Yes

No

If yes, please indicate the member of the City Council or Planning Commission who is involved and list the name(s) of the person or persons with whom the City Official holds an interest. Also list the Assessor's Parcel Number if the property in which the interest is held is different from the case parcel.

City Official: \_\_\_\_\_

Partner(s): \_\_\_\_\_

APN: \_\_\_\_\_

Signature of Property Owner: 

Print Name: Margo Wheeler

Subscribed and sworn before me

This \_\_\_\_\_ day of \_\_\_\_\_, 20\_\_\_\_\_

\_\_\_\_\_  
Notary Public in and for said County and State



**GPA - 26741**

-  Rural Neighborhood Preservation
-  Rural Estates
-  Desert Rural
-  Rural
-  Low
-  Medium - Low
-  Medium - Low Attached
-  Medium
-  High
-  Office
-  Service Commercial
-  General Commercial
-  Tourist Commercial
-  Las Vegas Medical District
-  Light Industrial / Research
-  Planned Community Development
-  Downtown Redevelopment Area
-  Park / Recreation / Open Space
-  Public Facility
-  Public Facility - School
-  Public Facility - Clark County
-  Town Center
-  Resource Conservation
-  Downtown - Commercial
-  Downtown - Mixed Use
-  Not in City
-  Right - of - Way

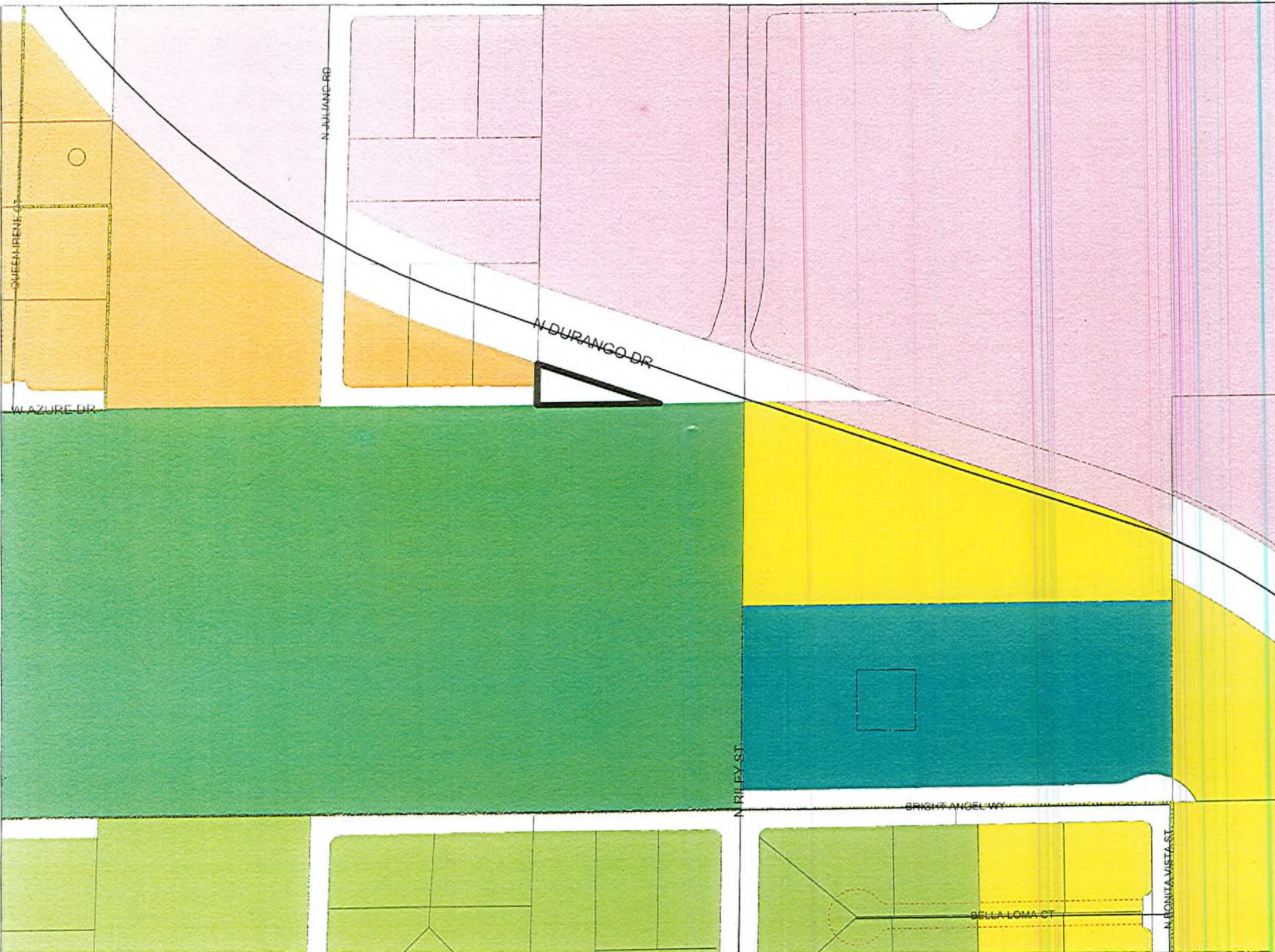

GIS maps are routinely produced only to meet the needs of the City. Due to continuous development activity this map is for reference only. Geographic Information System Planning & Development Dept 702.229.6361 Printed: March 04, 2008



**GPA-26741  
04/24/08 PC**

**RECEIVED**  
MAR 11 2008

