

CASE: WVR-27425

RADIUS: 1500 FT

ZONING OF SUBJECT PROPERTY:

U (UNDEVELOPED) ZONE [TC (TOWN CENTER)] AND GC-TC (GENERAL COMMERCIAL TOWN CENTER)

PROPOSED ZONING OF SUBJECT PROPERTY:

T-C (TOWN CENTER)



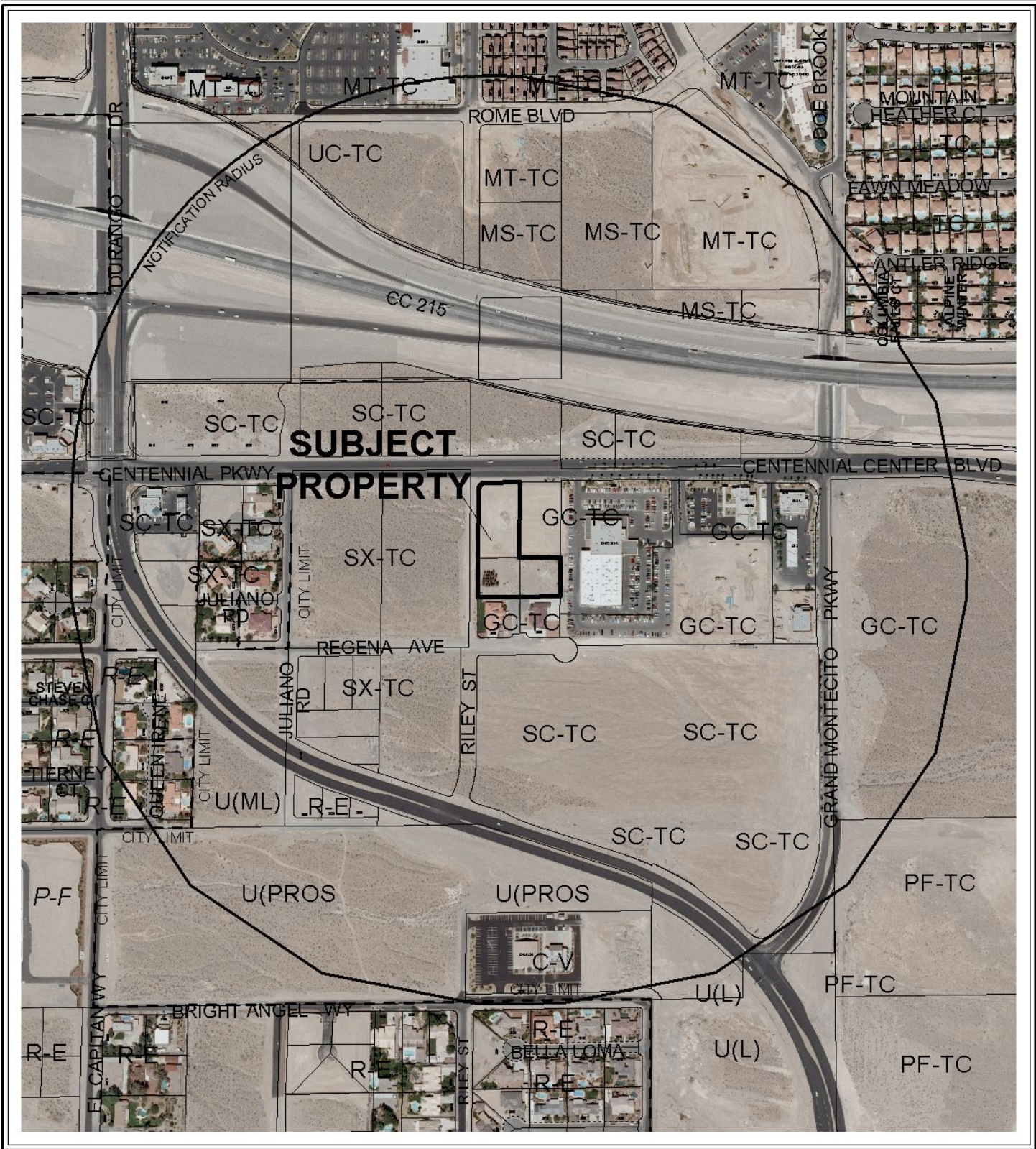

CASE: WVR-27425

RADIUS: 1500 FT

ZONING OF SUBJECT PROPERTY:

U (UNDEVELOPED) ZONE [TC (TOWN CENTER)] AND GC-TC (GENERAL COMMERCIAL TOWN CENTER)

PROPOSED ZONING OF SUBJECT PROPERTY:

T-C (TOWN CENTER)

