

140-32-114-045 to



PLANNING & DEVELOPMENT DEPARTMENT

RECEIVED

STATEMENT OF FINANCIAL INTEREST

OCT 18 2007

Case Number: **VAR-25220** APN: _____

Name of Property Owner: HECTOR CAMACHO

Name of Applicant: HECTOR CAMACHO

Name of Representative: SAUL

To the best of your knowledge, does the Mayor or any member of the City Council or Planning Commission have any financial interest in this or any other property with the property owner, applicant, the property owner or applicant's general or limited partners, or an officer of their corporation or limited liability company?

_____ Yes X _____ No

If yes, please indicate the member of the City Council or Planning Commission who is involved and list the name(s) of the person or persons with whom the City Official holds an interest. Also list the Assessor's Parcel Number if the property in which the interest is held is different from the case parcel.

City Official: _____

Partner(s): _____

APN: _____

Signature of Property Owner: [Handwritten Signature]

Print Name: HECTOR CAMACHO

Subscribed and sworn before me

This 18 day of OCTOBER 2007

Notary Public in and for said County and State

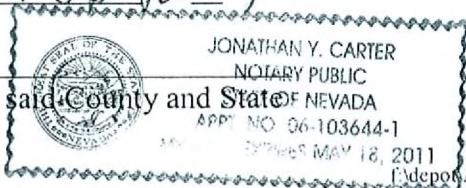

RECEIVED

OCT 18 2007

LEGAL DESCRIPTION
 BEING A PORTION OF THE NE¼ AT THE NW¼
 OF SECTION 32, TOWNSHIP 20 S, RANGE 62 E
 AS RECORDED AT THE CLARK COUNTY, NV,
 RECORDER'S OFFICE.
 A.P.N.: 140-32-114-048

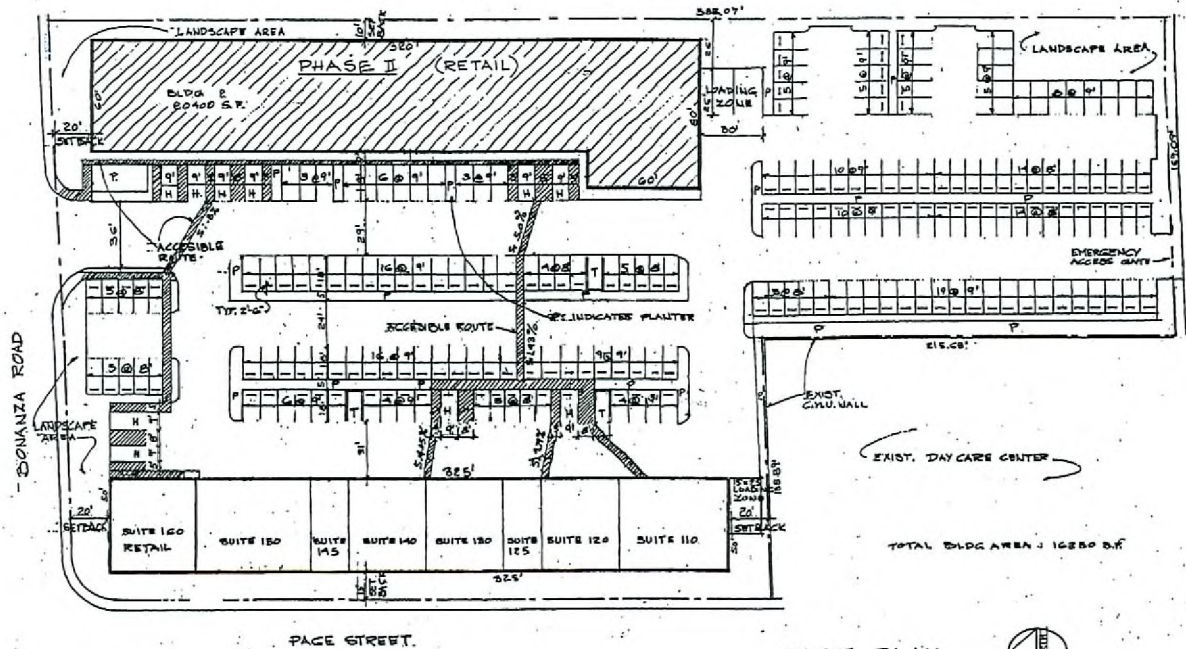
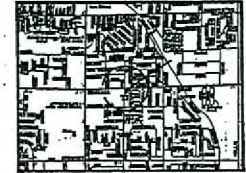

PLOT PLAN
 1" = 30'

BUILDING ANALYSIS

Furniture Store	8740 S.F.
Furniture warehouse	2810 S.F.
Subtotal	11550 S.F.
Fast Food Eatery, Seating	3823 S.F.
* Kitchens	2100 S.F.
* Rest rooms	484 S.F.
Subtotal	6207 S.F.
Meat Market	2038 S.F.
Sprinklers riser room	44 S.F.
Exterior walls	828 S.F.
Interior 8" wall	38 S.F.
Subtotal	3445 S.F.
TOTAL BUILDING AREA	20400 S.F.

PARKING ANALYSIS

PHASE 1 (EXISTING)	
Auto repair garage: 8 spaces = 1 per 200 S.F.	
8 * (10200 S.F. / 200) = 88.25 spaces.	
PHASE 2 (PROPOSED)	
Furniture Store	8470 S.F. / 175 = 48.4 spaces.
Furniture warehouse	2810 S.F. / 175 = 16.05 spaces.
Subtotal:	64.45 spaces.
Fast Food Eatery	3823 S.F. / 50 = 72.46 spaces.
* * Kitchens	2684 S.F. / 200 = 13.42 spaces.
Subtotal:	85.88 spaces.
Meat Market	2038 S.F. / 175 = 11.62 spaces.
TOTAL PARKING REQUIRED: 247.70 SPACES.	
TOTAL PARKING PROVIDED: 201 SPACES plus 3 loading.	

NORA H. MASANA
 ARCHITECT
 2207 WEST GOWAN ROAD
 NORTH LAS VEGAS NV 89032
 (702) 366-0727

CAMACHO AUTO CENTER, PHASE 2
 4161 EAST BONANZA
 Las Vegas NV 89110
 Owner: Hector Camacho
 (702) 460-1775

SITE PLAN
VAR-25220
SDR-25148
12/06/07 PC

DRAWN : N.H.M.
 DATE : 10-16-07
 SCALE : 1" = 30'