



**PLANNING & DEVELOPMENT DEPARTMENT**

**STATEMENT OF FINANCIAL INTEREST**

Case Number: **ZON-26010** APN: 125-22-801-011

Name of Property Owner: Bilpar-Tenaya Investments LLC

Name of Applicant: Bilpar-Tenaya Investments LLC

Name of Representative: Michael Andersen

To the best of your knowledge, does the Mayor or any member of the City Council or Planning Commission have any financial interest in this or any other property with the property owner, applicant, the property owner or applicant's general or limited partners, or an officer of their corporation or limited liability company?

Yes

No

If yes, please indicate the member of the City Council or Planning Commission who is involved and list the name(s) of the person or persons with whom the City Official holds an interest. Also list the Assessor's Parcel Number if the property in which the interest is held is different from the case parcel.

City Official: \_\_\_\_\_

Partner(s): \_\_\_\_\_

APN: \_\_\_\_\_

Signature of Property Owner: *Farus Farmanali*

Print Name: FARUS FARMANALI

Subscribed and sworn before me

This 11<sup>th</sup> day of Dec, 2007

*Beatrice Wallace*  
Notary Public in and for said County and State

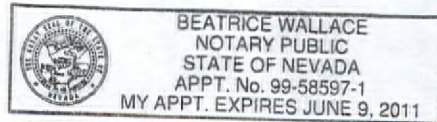

**LOT INFO**

APN - 125-22-801-011  
 ZONING: U-R                      PROPOSED - O  
 SITE AREA:                              86,684 S.F. = 1.99 ACRES  
 % OF LOT COVERED BY BUILDING:    18.18% MAX ALLOWED 30%  
 SETBACKS              REQ'D.              PROVIDED  
 FRONT:                25'-0"              20'-0"  
 SIDES:                 10'-0"              69'-8"  
 CORNER  
 SIDE:                 15'-0"              15'-0"  
 REAR:                15'-0"              167'-11"  
 HEIGHT:    MAX: 2 STORES OR 35', WHICH EVER IS LESS  
               PROPOSED: 1 STORY, 28'-3" HEIGHT

**SQ. FTG. / PARKING CALCULATION**

**DAYCARE**  
 SQUARE FOOTAGE:                      9410'-0" ±  
 PROPOSED BUILDING CAPACITY:      160  
     PARKING REQUIRED: (DAYCARE ONLY)  
     1/10 CHILDREN, 1/1 STAFF = 41 SPACES  
     41 SPACES PROVIDED  
**OFFICE**  
 SQUARE FOOTAGE:                      6400'-0" ±  
     PARKING REQUIRED: (OFFICE USE ONLY)  
     1 SPACE PER 300 S.F.  
     6,400 S.F. / 300 = 22  
     PARKING REQUIRED: (OFFICE AND MEDICAL USE)  
     1 SPACE PER 300 S.F. OFFICE- 3,200 S.F. / 300 = 11 SPACES REQUIRED  
     1 SPACE PER 200 S.F. MEDICAL- 3,200 S.F. / 200 = 16 SPACES REQUIRED  
     27 SPACES PROVIDED  
ACCESSIBLE SPACES PROVIDED:  
 1 PER 25 TOTAL SPACES UP TO 100 = 1 ACCESSIBLE SPACES  
 3 ACCESSIBLE SPACES PROVIDED

**VICINITY MAP**

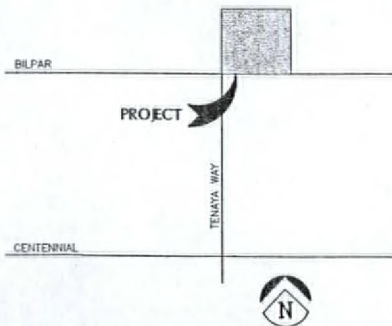

125-22-801-009  
 MCINNIS BILL  
 ZONING: R-E (CC)

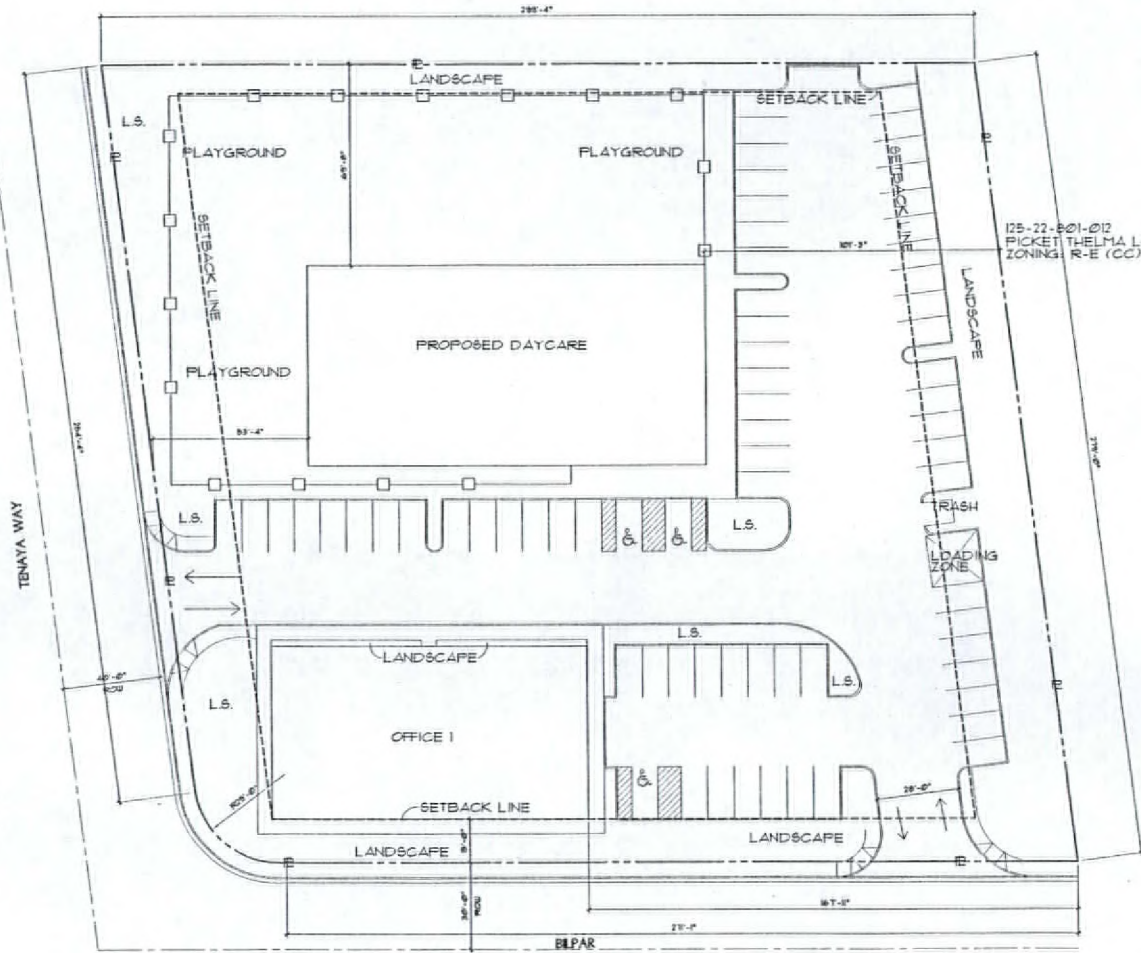

**SITE PLAN**



Sheet 1 of 3      Tenaya & Bilpar Daycare / Office      12-11-07

**ZON-26010**  
**01/24/08 PC**

**RECEIVED**  
 DEC 11 2007