



PLANNING & DEVELOPMENT DEPARTMENT

STATEMENT OF FINANCIAL INTEREST

Case Number: ROC-17721 APN: 163-028-01-005

Name of Property Owner: CARS DB4, L.P.

Name of Applicant: Bob Olufs, Autonation

To the best of your knowledge, does the Mayor or any member of the City Council or Planning Commission have any financial interest in this or any other property with the property owner, applicant, the property owner or applicant's general or limited partners, or an officer of their corporation or limited liability company?

Yes

No

If yes, please indicate the member of the City Council or Planning Commission who is involved and list the name(s) of the person or persons with whom the City Official holds an interest. Also list the Assessor's Parcel Number if the property in which the interest is held is different from the case parcel.

City Official: n/a

Partner(s): n/a

APN: n/a

Signature of Property Owner: *[Handwritten Signature]*

Print Name: *Christine Sweeney*

*CARS - DB4, L.P.
BY: CARS - DISPE 4, INC
BY: CAPITAL AUTOMOTIVE REAL ESTATE SERVICE INC*

Subscribed and sworn before me

This 20 day of October, 2006

[Handwritten Signature]
Notary Public in and for said County and State

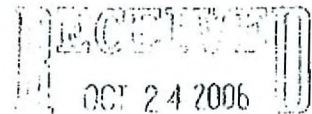

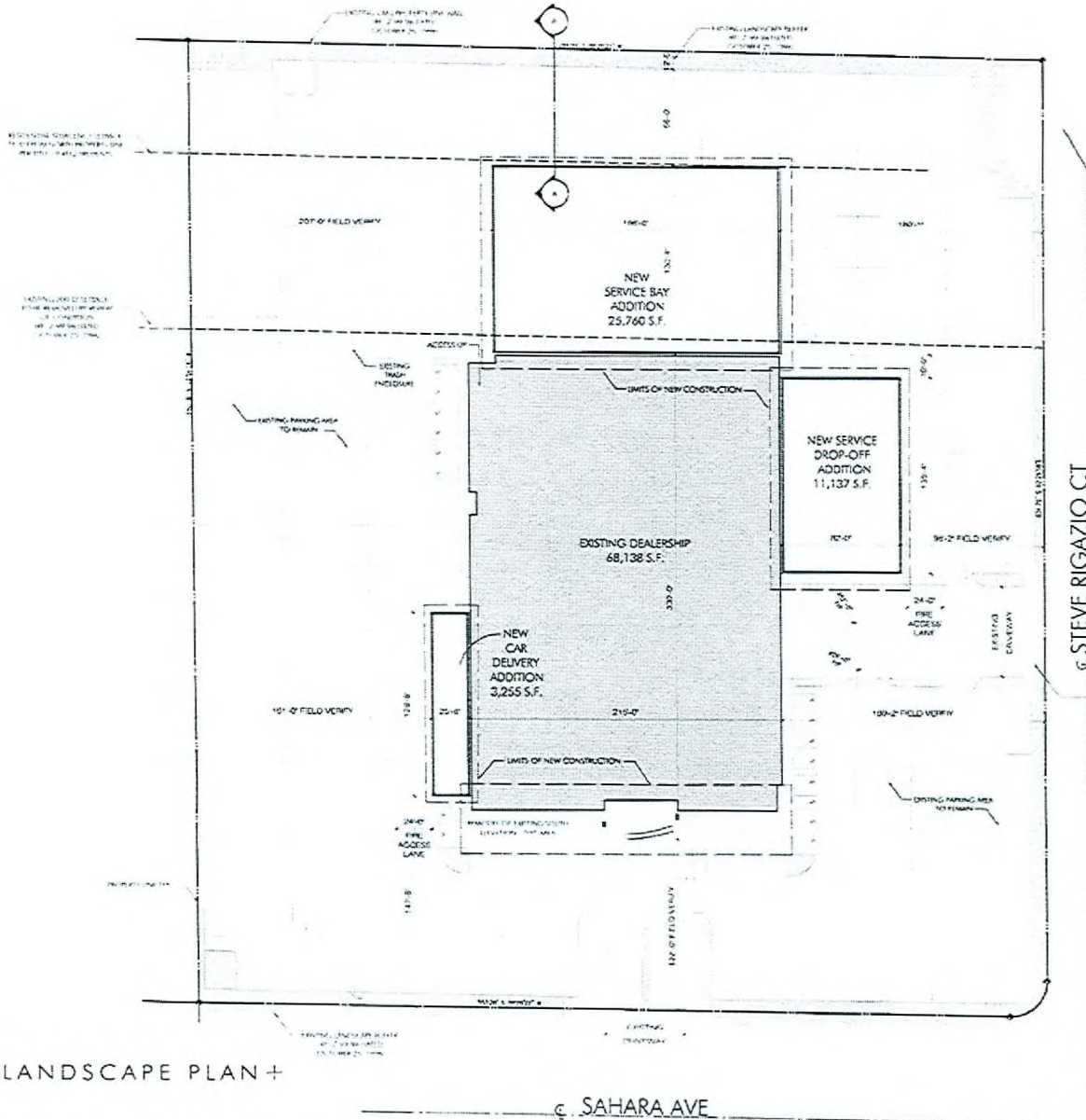

SITE DATA

DESCRIPTION	QUANTITY	REMARKS
EXISTING BUILDING	68,138 S.F.	
NEW SERVICE BAY ADDITION	25,760 S.F.	
NEW SERVICE DROP-OFF ADDITION	11,137 S.F.	
NEW CAR DELIVERY ADDITION	3,255 S.F.	
TOTAL NEW CONSTRUCTION	40,152 S.F.	
TOTAL EXISTING CONSTRUCTION	68,138 S.F.	
TOTAL CONSTRUCTION	108,290 S.F.	
EXISTING PARKING	100 SPACES	
NEW PARKING	100 SPACES	
TOTAL PARKING	200 SPACES	

SITE/LANDSCAPE PLAN +

VICINITY MAP 1" = 100'

DESERT TOYOTA ADDITION
6300 WEST SAHARA AVENUE

ROC-17721
SDR-17720
12/07/06 PC

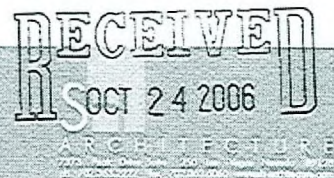

SAHARA AVE

STEVE RIGAZIO CT



SOUTH ELEVATION

ROC-17721
SDR-17720
12/07/06 PC

DESERT TOYOTA ADDITION
6300 WEST SAHARA AVENUE
CONCEPT DESIGN

RECEIVED
OCT 24 2006
CONCEPT DESIGN



NORTH

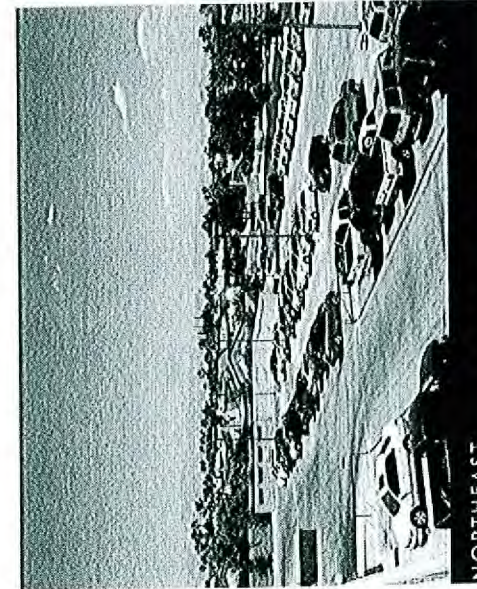

NORTHEAST

EXISTING LANDSCAPE BUFFER



NORTHWEST



SOUTHEAST

RECEIVED
OCT 24 2006
DESIGN CENTER

ROC-17721
SDR-17720
12/07/06 PC

DESERT TOYOTA ADDITION
8300 WEST SAFARA AVENUE
CONCEPT DESIGN



ELEVATION PHOTOS OF EXISTING BUILDING

DESERT TOYOTA ADDITION
6300 WEST SAHARA AVENUE
CONCEPT DESIGN

ROC-17721
SDR-17720
12/07/06 PC



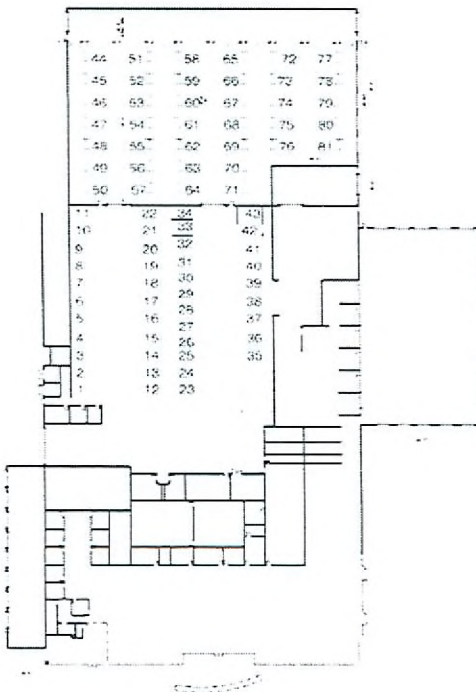

FLOOR PLAN

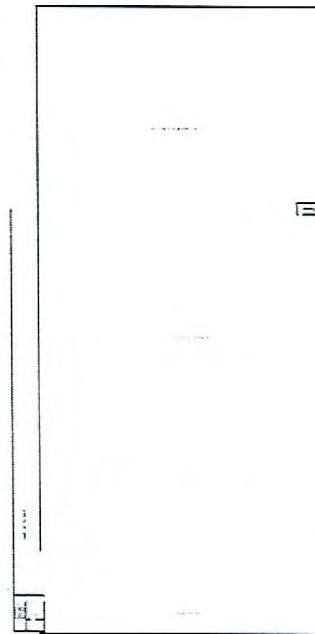

ROOF PLAN

DESERT TOYOTA ADDITION
6300 WEST SARARA AVENUE

ROC-17721
SDR-17720
12/07/06 PC

RECEIVED
OCT 24 2006

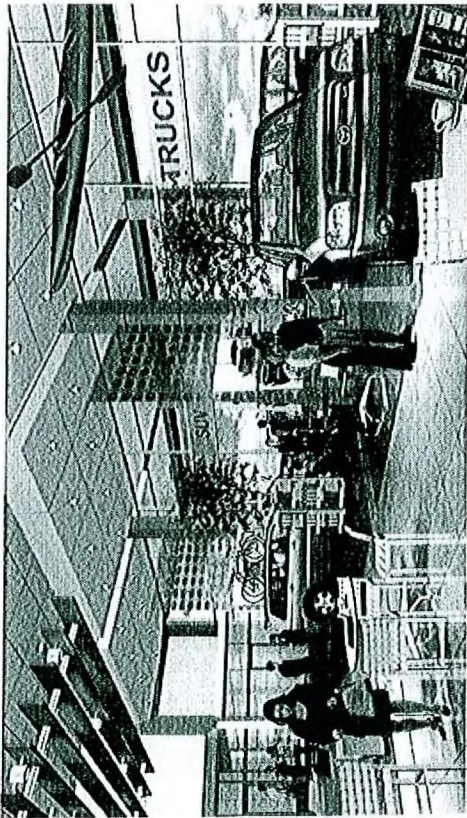

INTERIOR SHOWROOM

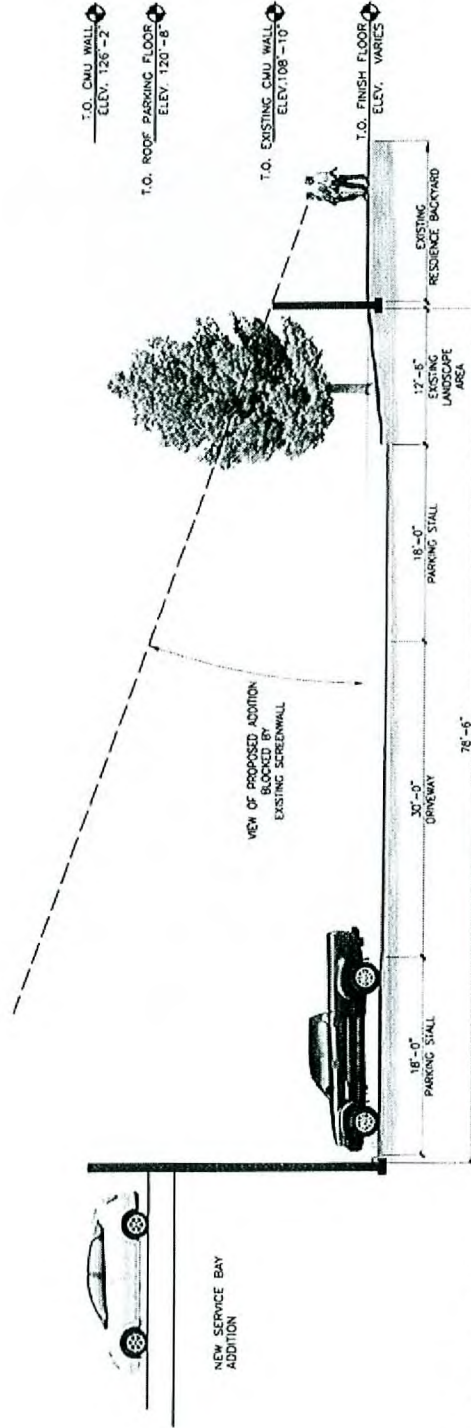

SITE SECTION

RECEIVED
 OCT 24 2006
 ARCHITECTURE

ROC-17721
 SDR-17720
 12/07/06 PC

DESERT TOYOTA ADDITION
 6300 WEST SAHARA AVENUE
 CONCEPT DESIGN