





ROR-23798, SDR 12175

**PLANNING & DEVELOPMENT DEPARTMENT**

**STATEMENT OF FINANCIAL INTEREST**

Case Number: ROR-25665 APN: 125-17-802-011

Name of Property Owner: American Gear Reduction, Inc.

Name of Applicant: Moon Valley Nursery

Name of Representative: Mark Nusall

To the best of your knowledge, does the Mayor or any member of the City Council or Planning Commission have any financial interest in this or any other property with the property owner, applicant, the property owner or applicant's general or limited partners, or an officer of their corporation or limited liability company?

           Yes       ✓       No

If yes, please indicate the member of the City Council or Planning Commission who is involved and list the name(s) of the person or persons with whom the City Official holds an interest. Also list the Assessor's Parcel Number if the property in which the interest is held is different from the case parcel.

City Official: \_\_\_\_\_

Partner(s): \_\_\_\_\_

APN: \_\_\_\_\_

Signature of Property Owner: E. Nelson

Print Name: E. Nelson

Subscribed and sworn before me

This 9<sup>TH</sup> day of November, 2007

Susan Houck

Notary Public in and for said County and State

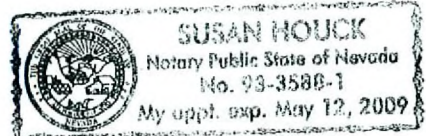

NOV 19 2007



RQR-25665  
12-19-07 CC

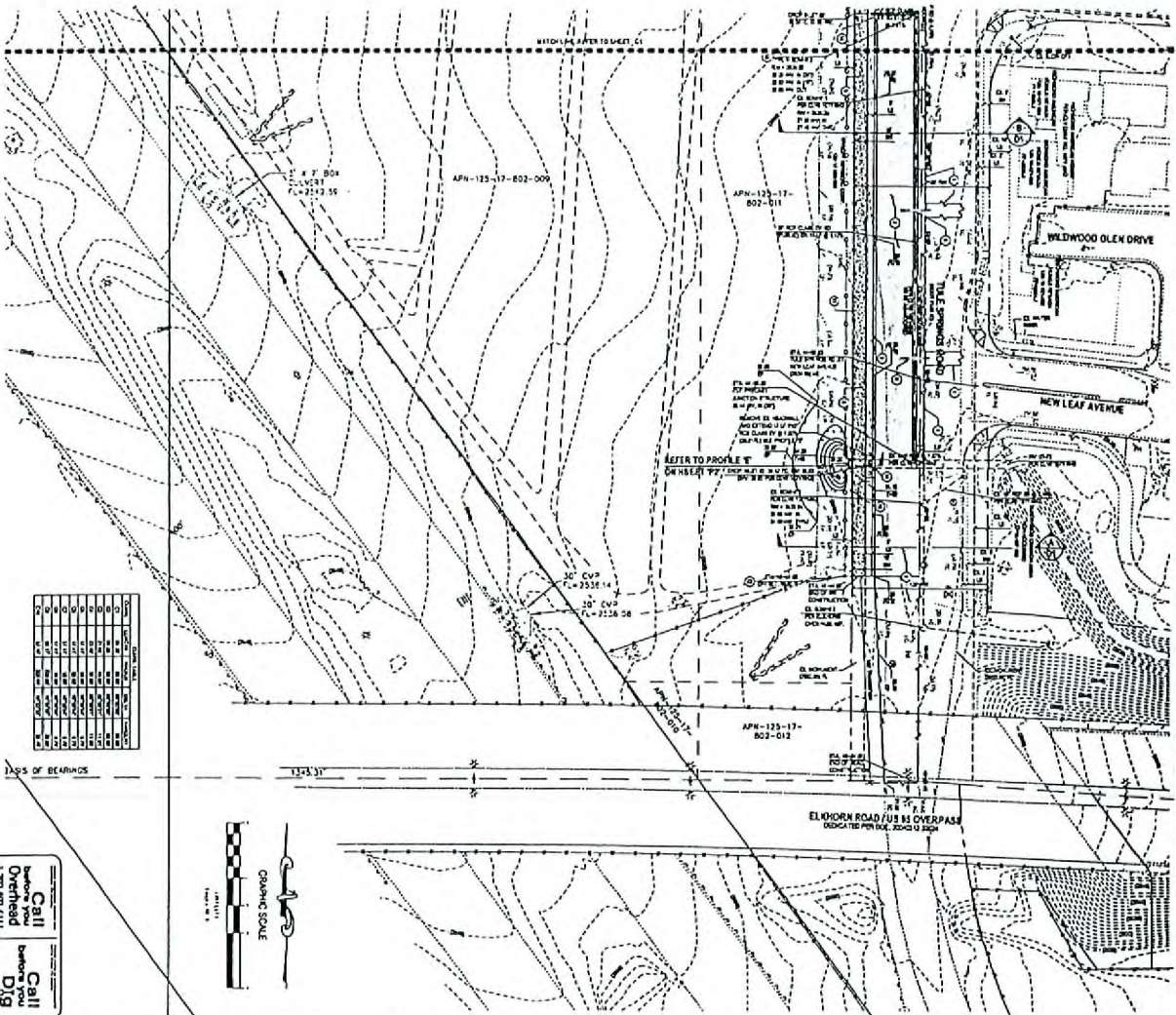

Station	1+00	1+20	1+40	1+60	1+80	2+00	2+20	2+40	2+60	2+80	3+00	3+20	3+40	3+60	3+80	4+00	4+20	4+40	4+60	4+80	5+00		
Prop. Elev.	2555.14	2555.14	2555.14	2555.14	2555.14	2555.14	2555.14	2555.14	2555.14	2555.14	2555.14	2555.14	2555.14	2555.14	2555.14	2555.14	2555.14	2555.14	2555.14	2555.14	2555.14	2555.14	
Grd. Elev.	2555.14	2555.14	2555.14	2555.14	2555.14	2555.14	2555.14	2555.14	2555.14	2555.14	2555.14	2555.14	2555.14	2555.14	2555.14	2555.14	2555.14	2555.14	2555.14	2555.14	2555.14	2555.14	2555.14

Call before you dig  
1-800-271-3589

**LEGEND**

- Proposed Road
- Proposed Utility
- Proposed Structure
- Proposed Fencing
- Proposed Landscaping
- Proposed Signage
- Proposed Lighting
- Proposed Storm Drain
- Proposed Sewer
- Proposed Water
- Proposed Gas
- Proposed Electric
- Proposed Telephone
- Proposed Cable
- Proposed Fiber Optic
- Proposed Other

**CONSTRUCTION NOTES**

1. ALL CONSTRUCTION SHALL BE IN ACCORDANCE WITH THE LATEST EDITIONS OF THE STANDARD SPECIFICATIONS FOR PUBLIC WORKS, AS APPLICABLE.
2. THE CONTRACTOR SHALL BE RESPONSIBLE FOR OBTAINING ALL NECESSARY PERMITS AND APPROVALS FROM THE APPROPRIATE AGENCIES.
3. THE CONTRACTOR SHALL MAINTAIN ACCESS TO ALL ADJACENT PROPERTIES AND UTILITIES AT ALL TIMES.
4. THE CONTRACTOR SHALL BE RESPONSIBLE FOR PROTECTING ALL EXISTING UTILITIES AND STRUCTURES.
5. THE CONTRACTOR SHALL MAINTAIN ADEQUATE DRAINAGE AND EROSION CONTROL MEASURES THROUGHOUT THE PROJECT.
6. THE CONTRACTOR SHALL BE RESPONSIBLE FOR THE PROTECTION AND RESTORATION OF ALL NATURAL RESOURCES.
7. THE CONTRACTOR SHALL MAINTAIN ADEQUATE SAFETY MEASURES THROUGHOUT THE PROJECT.
8. THE CONTRACTOR SHALL BE RESPONSIBLE FOR THE PROTECTION AND RESTORATION OF ALL EXISTING LANDSCAPING AND SIGNAGE.
9. THE CONTRACTOR SHALL MAINTAIN ADEQUATE RECORD DRAWINGS AND AS-BUILT DRAWINGS.
10. THE CONTRACTOR SHALL BE RESPONSIBLE FOR THE PROTECTION AND RESTORATION OF ALL EXISTING UTILITIES AND STRUCTURES.

**BASIS OF BEARING**

THE BASIS OF BEARING FOR ALL CONSTRUCTION SHALL BE THE NORTH SIGHT LINE OF THE BENCHMARK SHOWN ON THIS PLAN. THE BENCHMARK IS A 1.5" DIA. IRON PIN SET IN A CONCRETE PAD AT THE INTERSECTION OF WILLOWWOOD GLEN DRIVE AND NEW LEAF AVENUE. THE BENCHMARK IS 10.00 FEET ABOVE THE MEAN SEA LEVEL DATUM.

**KEY MAP**

<p><b>PROJECT</b></p> <p>MOON VALLEY NURSERIES TULE SPRINGS ROAD IMPROVEMENTS</p>	<p><b>OWNER</b></p> <p>MOON VALLEY NURSERIES 7200 NORTH RANCHO DRIVE LAS VEGAS, NV, 89131 TEL: (702) 735-8733</p>	<p><b>CONSULTING CIVIL ENGINEERS</b></p> <p>318 South Valley Blvd. Suite 110 • Las Vegas, NV 89102 (702) 735-8733 • Fax (702) 735-8734</p>	<p><b>DATE</b></p> <p>JANUARY 18, 2007</p>	<p><b>SCALE</b></p> <p>SCALE - HORIZ SCALE - VERT</p>	<p><b>DESIGNED BY</b></p> <p>EDDENDON</p>	<p><b>CHECKED BY</b></p> <p>EDDENDON</p>			
<p><b>PROJECT NUMBER</b></p> <p>4106.023</p>		<p><b>DATE</b></p> <p>JANUARY 18, 2007</p>		<p><b>SCALE</b></p> <p>SCALE - HORIZ SCALE - VERT</p>		<p><b>DESIGNED BY</b></p> <p>EDDENDON</p>		<p><b>CHECKED BY</b></p> <p>EDDENDON</p>	

NOV 19 2007

