



PLANNING & DEVELOPMENT DEPARTMENT

STATEMENT OF FINANCIAL INTEREST

Case Number: ZON-25893 APN: 138-03-510-001,002,003,023,024,031⁰²⁵

Name of Property Owner: VF INVESTMENTS, LLC

Name of Applicant: STERLING W. DEVELOPMENT

Name of Representative: BILL ROBERTS

To the best of your knowledge, does the Mayor or any member of the City Council or Planning Commission have any financial interest in this or any other property with the property owner, applicant, the property owner or applicant's general or limited partners, or an officer of their corporation or limited liability company?

Yes

No

If yes, please indicate the member of the City Council or Planning Commission who is involved and list the name(s) of the person or persons with whom the City Official holds an interest. Also list the Assessor's Parcel Number if the property in which the interest is held is different from the case parcel.

City Official: _____

Partner(s): _____

APN: _____

Signature of Property Owner: *Fred Lessman*

Print Name: FRED LESSMAN

Subscribed and sworn before me

This 30 day of November, 2007
Suzanne Anderson
Notary Public in and for said County and State

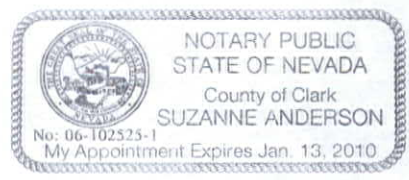

TABULATION

APN 138-03-510, 001, 002, 003, 024, 025, 031
 GROSS ACREAGE 11.45
 EXISTING ZONING UMILLA
 PROPOSED ZONING M
 NUMBER OF BEDROOM UNITS 108
 NUMBER OF 2 BEDROOM UNITS 108
 NUMBER OF 3 BEDROOM UNITS 20
 TOTAL NUMBER OF UNITS 255

PARKING ANALYSIS

108 - 1 BEDROOM UNITS @ 1.25 PS PER UNIT = 135
 108 - 2 BEDROOM UNITS @ 1.75 PS PER UNIT = 189
 20 - 3 BEDROOM UNITS @ 2.0 PS PER UNIT = 40
 TOTAL PARKING SPACES REQUIRED = 407
 TOTAL PARKING SPACES PROVIDED = 420
 RECREATION CENTER (S7) = 5,000+/-

PLANT LIST

COMMON NAME	SIZE
TREES:	24" BOX
MONDEL PINES	
SHOESTRING ACACIA	
PHOENIX PALM	
ALLEPO PINES	
SHRUBS:	5 GAL
STONINGTON	
INDIAN HAWTHORNE (PINK)	
RED TIP PHOTINIA	
TEXAS RANGERS	
ORANGE	
ROSEMARY CREEPING	
CATS CLAW	
DAY LILLIES	

GROUND COVER:
 ISOLATED SOD POCKETS WITHIN COURT YARD
 AREAS AND DECOMPOSED GRANITE / CHAD TO
 BE USED IN LANDSCAPE AREAS THROUGHOUT

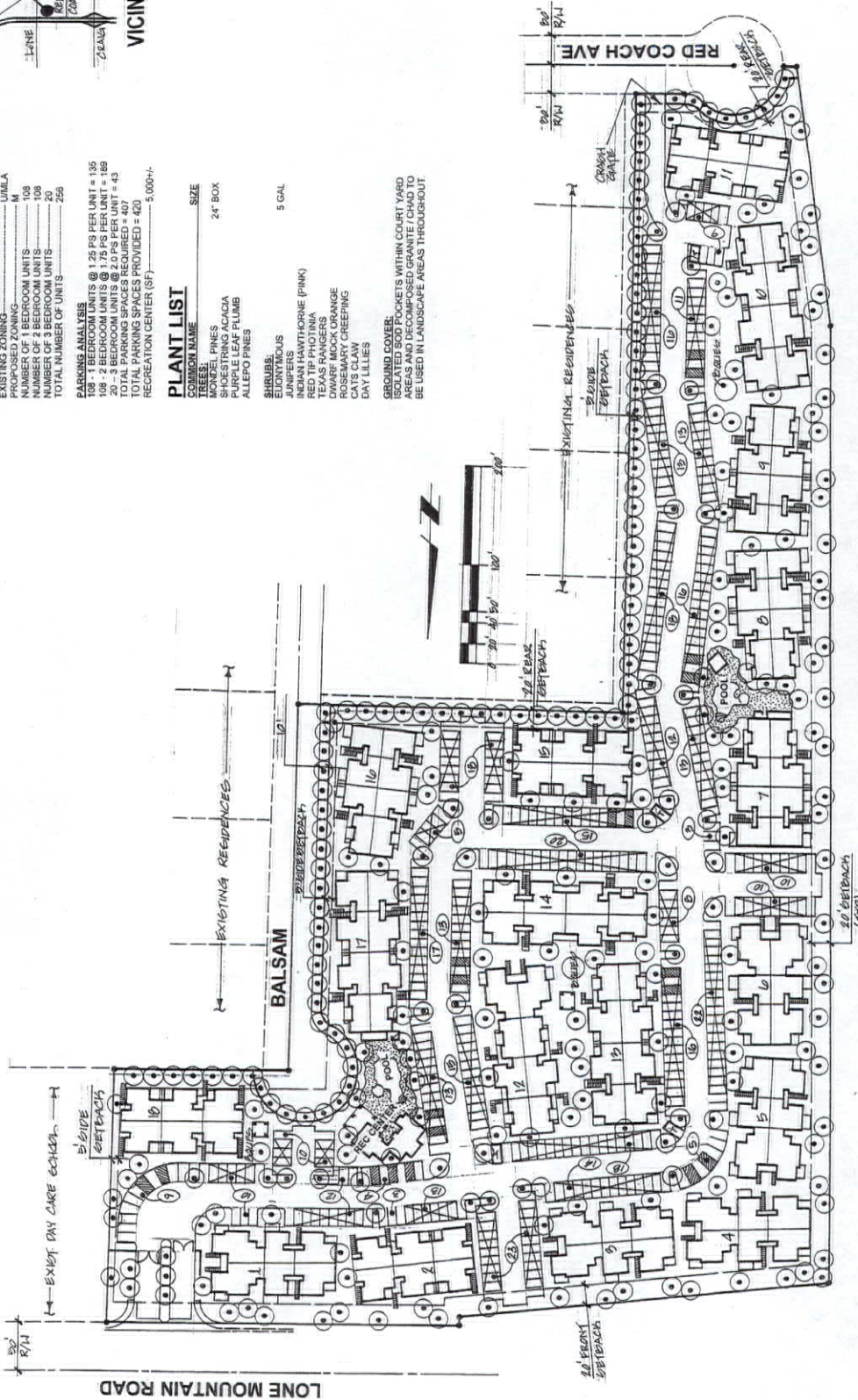
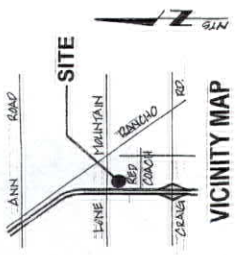

RECEIVED
 DEC 06 2007
 ZON-25893
 01/24/08 PC

ORAN K. GRAGSON HIGHWAY

LONE MOUNTAIN / US 95 HWY.
 SCALE: 1/8" = 1'-0"
 DATE: 11/20/07
 DRAWN BY: LJR
 CHECKED BY: LJR
 PROJECT: CONCEPTUAL SITE PLAN
 DRAWING NUMBER: WJR CONSULTING SERVICES, LLC