



PLANNING & DEVELOPMENT DEPARTMENT

STATEMENT OF FINANCIAL INTEREST

Case Number: **VAR-25642** APN: 163-01-102-038

Name of Property Owner: Charleston & Jones LLC

Name of Applicant: Charleston & Jones LLC

Name of Representative: Steve Amico

To the best of your knowledge, does the Mayor or any member of the City Council or Planning Commission have any financial interest in this or any other property with the property owner, applicant, the property owner or applicant's general or limited partners, or an officer of their corporation or limited liability company?

 Yes No

If yes, please indicate the member of the City Council or Planning Commission who is involved and list the name(s) of the person or persons with whom the City Official holds an interest. Also list the Assessor's Parcel Number if the property in which the interest is held is different from the case parcel.

City Official: _____

Partner(s): _____

APN: _____

Signature of Property Owner: Amanda K Hahn

Print Name: Amanda K Hahn

Subscribed and sworn before me

This 15 day of Nov, 2007

Sarah Rincon-Mendoza
Notary Public in and for said County and State



Site Information

ZONING - City of Las Vegas
R-3 Medium Density Residential
AREA (650)-102-038

309,476 sq ft
311,678 sq ft
Net Area

56,38' x
1-14' x
48' x
24' x
24' x

43.7%
BLDG I
BLDG II
BLDG III

Total
Density
PARKING REQUIREMENTS (approx)
1-1 Bedroom
2-1 Bedroom
Total

192 units/ 8102 spaces
23.94 du/dft
1.25 * 84
1.75 * 108
192 units/ 32 spaces
30 spaces
192 spaces
105 spaces
Total 328 spaces
8 spaces

Handicapped (84)
Handicapped (Provided)

SETBACKS
Front: 20 ft
Side: 5 ft
Corner and Side: 5 ft
Accessory Structure: 5 ft
Buildings Over 35 ft (6'-5")

LANDSCAPE AREA (approximate)
3 acres - 65 ft
3 acres - 31 ft

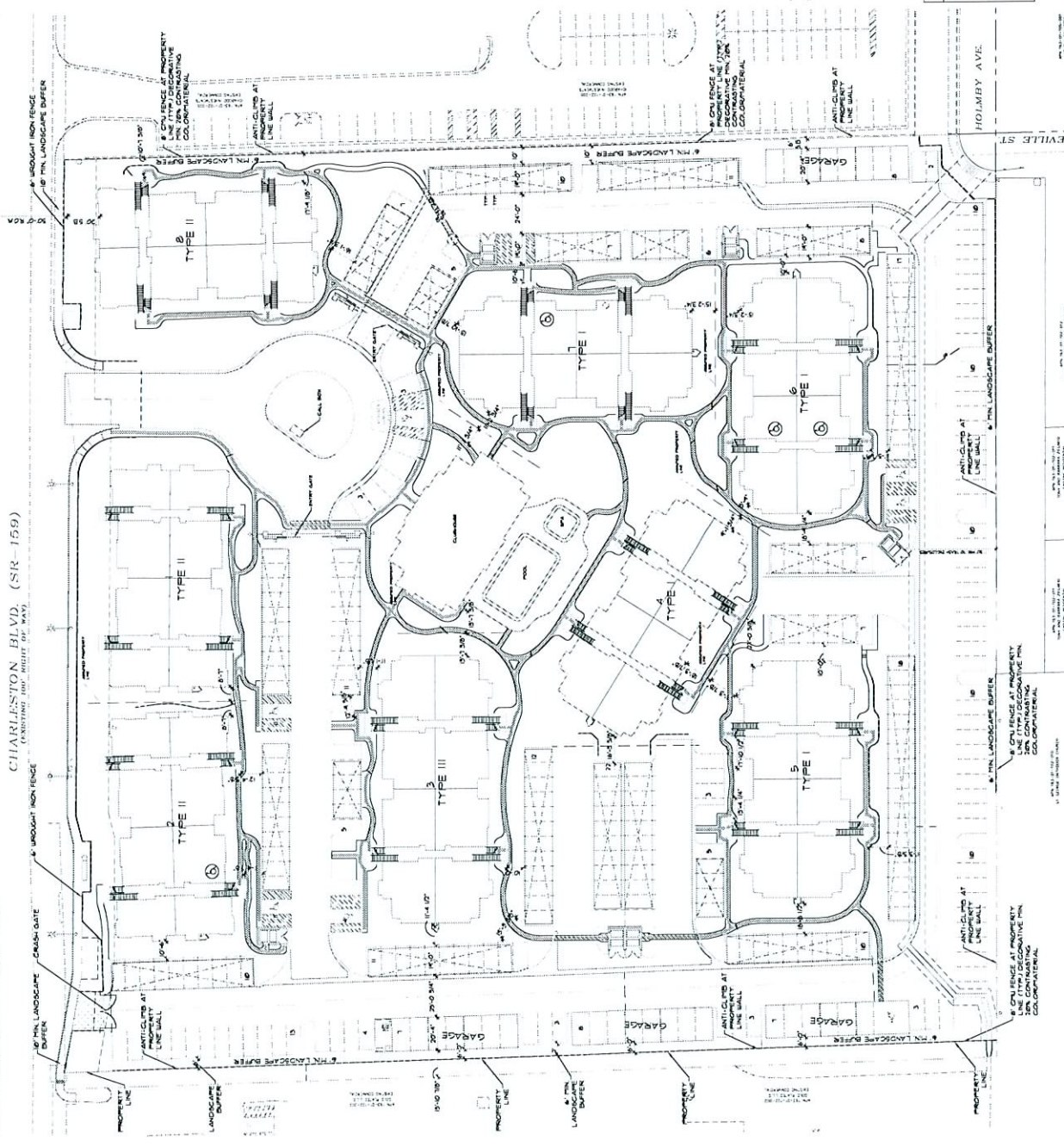

DESERT SHADOWS APARTMENTS
EXECUTIVE DEVELOPMENT
LAS VEGAS, NEVADA

ARCHITECTURAL
SITE PLAN

Drawn/Checked By
AJ/ARS
Date
NOVEMBER 15, 2007
Project Number
102035
Sheet Number
AS.1

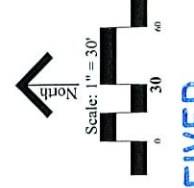
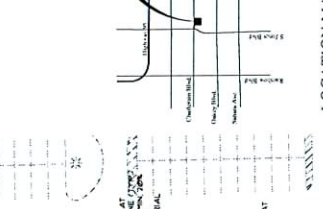
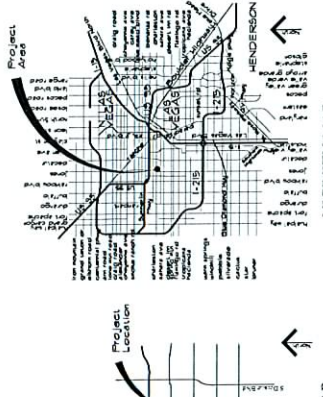
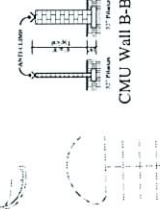
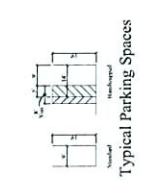

LEGEND
Accessible Route
Accessible Element
Designates Accessible Element, (Parking space, Living unit, Garage, ETC.)
See Section AS.1, R.C.N., AND/ or additional information.

RECEIVED
VAR-25642
01/10/08 PC
NOV 16 2007